

UNITED STATES
DEPARTMENT OF THE INTERIOR
BUREAU OF LAND MANAGEMENT

SECRETARY'S POTASH
OCD Artesia

ATS-10-498
FORM APPROVED
OMB No. 1004-0136
Expires January 31, 2004

APPLICATION FOR PERMIT TO DRILL OR REENTER

1a. Type of Work: <input checked="" type="checkbox"/> DRILL <input type="checkbox"/> REENTER		5. Lease Serial No. LC068719 -A (SL) NM27280 (BHL)
1b. Type of Well: <input checked="" type="checkbox"/> Oil Well <input type="checkbox"/> Gas Well <input type="checkbox"/> Other <input type="checkbox"/> Single Zone <input type="checkbox"/> Multiple Zone		6. If Indian, Allottee or Tribe Name
2. Name of Operator Mewbourne Oil Company (14744)		7. If Unit or CA Agreement, Name and No.
3a. Address PO Box 5270 Hobbs, NM 88241		8. Lease Name and Well No. Bradley 29 Federal Com #2H (37976)
3b. Phone No. (include area code) 575-393-5905		9. API Well No. 30-015-38336
4. Location of Well (Report location clearly and in accordance with any State requirements) At surface 2150' FSL & 260' FEL (Unit I) At proposed prod. zone 2450' FSL & 330' FWL Unit L		10. Field and Pool, or Exploratory Santo Nino Bone Springs (54600)
14. Distance in miles and direction from nearest town or post office* 7 miles S of Loco Hills, NM		11. Sec., T., R., M., or Blk. and Survey or Area Sec 29 - T18S - R30E
15. Distance from proposed* location to nearest property or lease line, ft. (Also to nearest drig. unit line, if any) 260'	16. No. of Acres in lease 40	12. County or Parish Eddy
17. Spacing Unit dedicated to this well 160	13. State NM	
18. Distance from proposed location* to nearest well, drilling, completed, applied for, on this lease, ft. N/A	19. Proposed Depth 12674' MD 8221' TVD 12750	20. BLM/BIA Bond No. on file NM1693, Nationwide
21. Elevations (Show whether DF, KDB, RT, GL, etc.) 3403' GL	22. Approximate date work will start* ASAP	23. Estimated duration 45

24. Attachments

The following, completed in accordance with the requirements of Onshore Oil and Gas Order No.1, shall be attached to this form:

- | | |
|---|--|
| 1. Well plat certified by a registered surveyor. | 4. Bond to cover the operations unless covered by an existing bond on file (see Item 20 above). |
| 2. A Drilling Plan. | 5. Operator certification. |
| 3. A Surface Use Plan (if the location is on National Forest System Lands, the SUPO shall be filed with the appropriate Forest Service Office). | 6. Such other site specific information and/or plans as may be required by the authorized officer. |

25. Signature 	Name (Printed/Typed) Jackie Lathan	Date 06/30/10
Title Hobbs Regulatory		
Approved by (Signature) /s/ Linda S. C. Rundell	Name (Printed/Typed) /s/ Linda S. C. Rundell	Date SEP 27 2010
Title STATE DIRECTOR		
Office NM STATE OFFICE		

Application approval does not warrant or certify that the applicant holds legal or equitable title to those rights in the subject lease which would entitle the applicant to conduct operations thereon.

Conditions of approval, if any, are attached.

APPROVAL FOR TWO YEARS

Title 18 U.S.C. Section 1001 and Title 43 U.S.C. Section 1212, make it a crime for any person knowingly and willfully to make to any department or agency of the United States any false, fictitious or fraudulent statements or representations as to any matter within its jurisdiction.

*(Instructions on reverse)

Capitan Controlled Water Basin

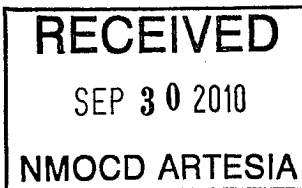

SEE ATTACHED FOR
CONDITIONS OF APPROVAL

APPROVAL SUBJECT TO
GENERAL REQUIREMENTS
AND SPECIAL STIPULATIONS
ATTACHED

DISTRICT I
1625 N. French Dr., Hobbs, NM 88240

DISTRICT II
1301 W. Grand Avenue, Artesia, NM 88210

DISTRICT III
1000 Rio Brazos Rd., Aztec, NM 87410

DISTRICT IV
1220 S. St. Francis Dr., Santa Fe, NM 87505

State of New Mexico
Energy, Minerals and Natural Resources Department

Form C-102
Revised October 15, 2009

Submit one copy to appropriate
District Office

OIL CONSERVATION DIVISION

1220 South St. Francis Dr.
Santa Fe, New Mexico 87505

WELL LOCATION AND ACREAGE DEDICATION PLAT

☐ AMENDED REPORT

API Number 30-015-38336	Pool Code 54600	Pool Name Santo Nino Bone Springs
Property Code 37976	Property Name BRADLEY "29" FEDERAL COM	Well Number 2H
OGRID No. 14744	Operator Name MEWBOURNE OIL COMPANY	Elevation 3403'

Surface Location

UL or lot No. 1	Section 29	Township 18 S	Range 30 E	Lot Idn	Feet from the 2150	North/South line SOUTH	Feet from the 260	East/West line EAST	County EDDY
--------------------	---------------	------------------	---------------	---------	-----------------------	---------------------------	----------------------	------------------------	----------------

Bottom Hole Location If Different From Surface

UL or lot No. L	Section 29	Township 18 S	Range 30 E	Lot Idn	Feet from the 2450	North/South line South	Feet from the 330	East/West line West	County Eddy
Dedicated Acres 160	Joint or Infill	Consolidation Code	Order No. MSL-6285						

NO ALLOWABLE WILL BE ASSIGNED TO THIS COMPLETION UNTIL ALL INTERESTS HAVE BEEN CONSOLIDATED
OR A NON-STANDARD UNIT HAS BEEN APPROVED BY THE DIVISION

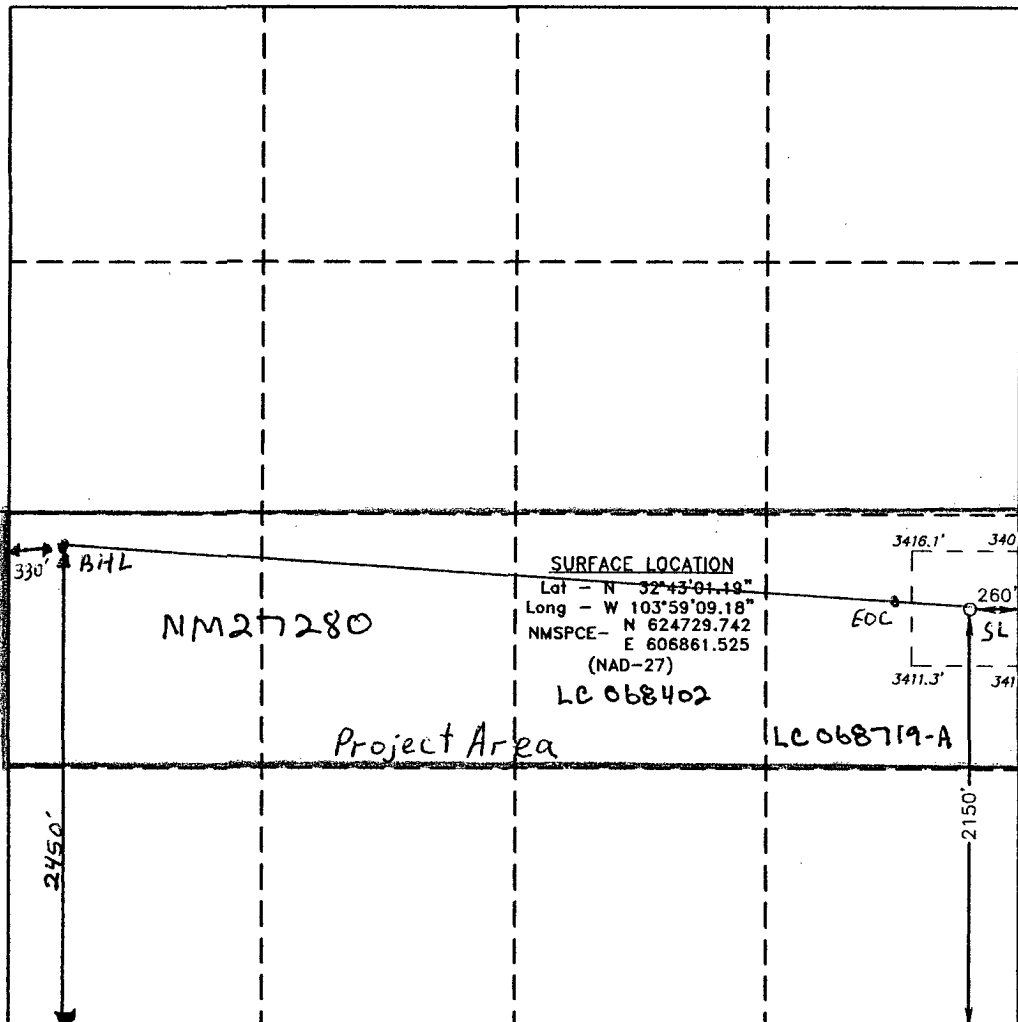
		<p>OPERATOR CERTIFICATION</p> <p>I hereby certify that the information contained herein is true and complete to the best of my knowledge and belief, and that this organization either owns a working interest or unleased mineral interest in the land including the proposed bottom hole location or has a right to drill this well at this location pursuant to a contract with an owner of such a mineral or working interest, or to a voluntary pooling agreement or a compulsory pooling order heretofore entered by the division.</p> <p>Signature: Jackie Lathan Date: 6/9/10</p> <p>Printed Name: Jackie Lathan</p>
<p>SURVEYOR CERTIFICATION</p> <p>I hereby certify that the well location shown on this plat was plotted from field notes of actual surveys made by me or under my supervision, and that the same is true and correct to the best of my belief.</p> <p>Date Surveyed: APR 30, 2010</p> <p>Signature & Seal of Professional Surveyor: [Signature]</p> <p>Certificate No. Gary L. Jones 7977</p> <p>Basin SURVEYS</p>		

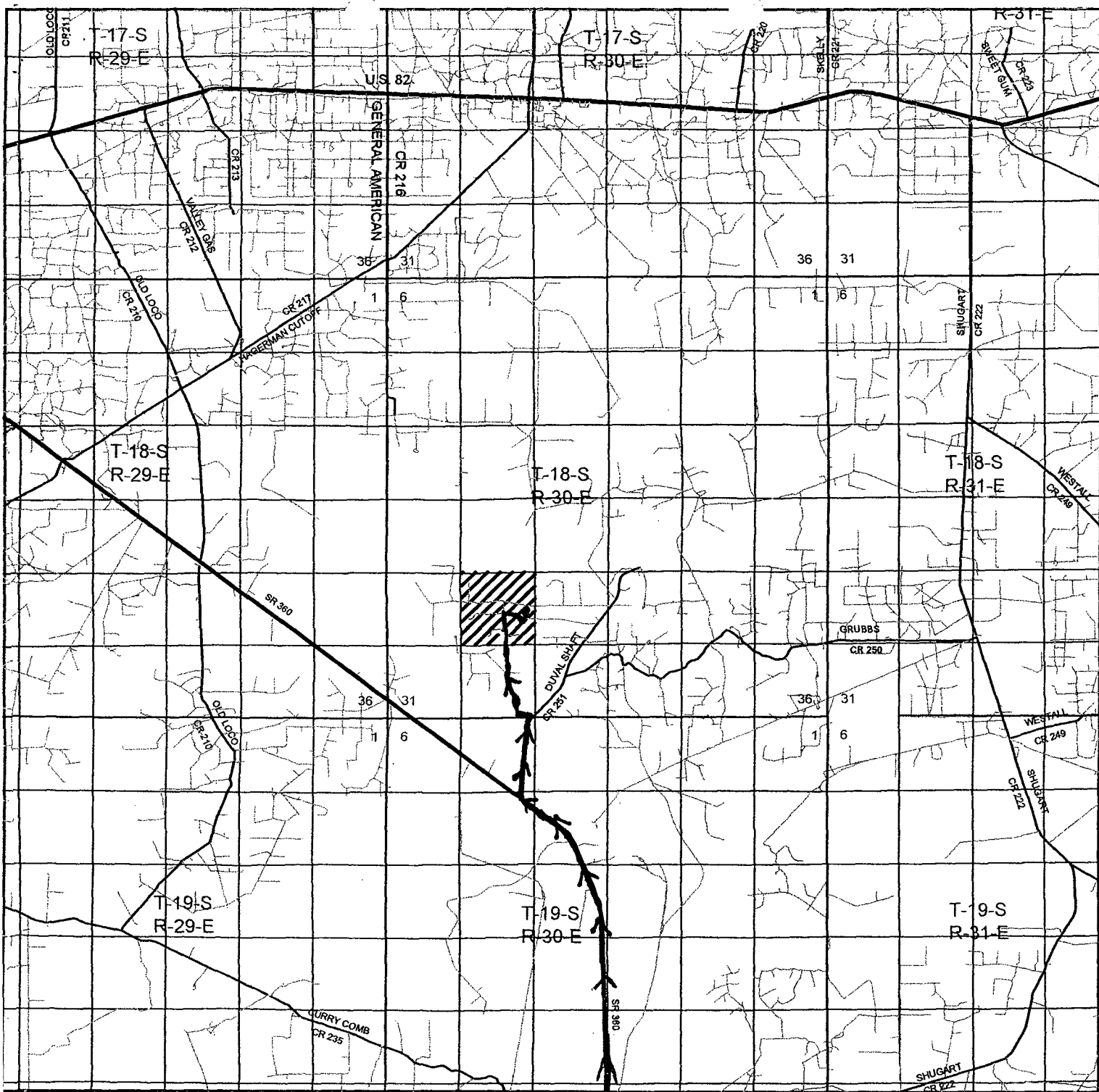

BRADLEY "29" FEDERAL COM #2H *Exhibit #3*
 Located 2150' FSL and 260' FEL
 Section 29, Township 18 South, Range 30 East,
 N.M.P.M., Eddy County, New Mexico.

basin
surveys
 focused on excellence
 in the oilfield

P.O. Box 1786
 1120 N. West County Rd.
 Hobbs, New Mexico 88241
 (575) 393-7316 - Office
 (575) 392-2206 - Fax
 basinsurveys.com

W.O. Number: JMS 22651

Survey Date: 04-30-2010

Scale: 1" = 2 Miles

Date: 05-03-2010



MEWBOURNE
 OIL COMPANY

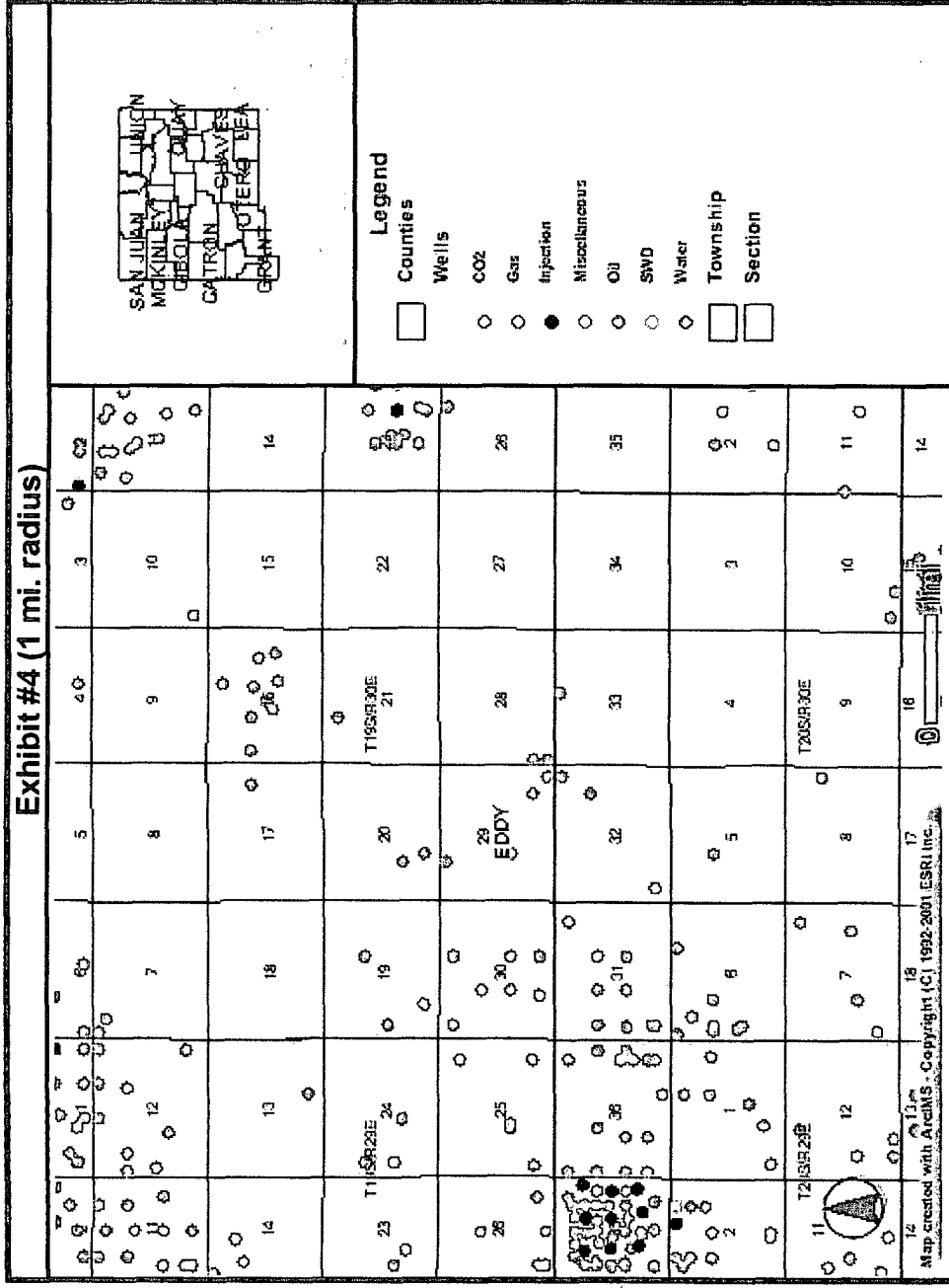

Exhibit 4

Drilling Program
Mewbourne Oil Company
Bradley 29 Federal Com #2H
2150' FSL & 260' FEL (SL)
2450' FSL & 330' FWL (BHL)
Sec 29-T18S-R30E
Eddy County, New Mexico

1. The estimated tops of geological markers are as follows:

Ruster	400'
Yates	1400'
*Queen	2515'
Delware	3810'
*Bone Springs	4850'

2. Estimated depths of anticipated fresh water, oil, or gas:

Water	Fresh water will be protected by setting surface casing at 400' and cementing to surface.
Hydrocarbons	Oil and gas are anticipated in the above (*) formations. These zones will be protected by casing as necessary.

3. Pressure control equipment:

A 3000# WP Double Ram BOP and a 3000# WP Annular will be installed after running 9 5/8" surface casing. A 3000# WP Double Ram BOP and a 3000# WP Annular will be installed after running 7" casing. Pressure tests will be conducted prior to drilling out under all casing strings. BOP controls will be installed prior to drilling under surface casing and will remain in use until completion of drilling operations. BOP's will be inspected and operated daily to insure mechanical integrity and the inspection will be recorded on the daily drilling report.

Kelly cock and a sub equipped with a full opening valve sized to fit the drill pipe and collars will be available on the rig floor in the open position when the kelly is not in use.

***4. Proposed casing and cementing program:**

A. Casing Program:

<u>Hole Size</u>	<u>Casing</u>	<u>Wt/Ft</u>	<u>Grade</u>	<u>Depth</u>	<u>Jt Type</u>
12 1/4"	9 5/8" (new)	36#	J55	0'- 400 '	ST&C
8 3/4"	7" (new)	26#	P110	0'-8560'	B&L/TC
6 1/8"	4 1/2" Liner (new)	11.6#	P110	0'-12750'	LT&C

See COA

Minimum casing design factors: Collapse 1.125, Burst 1.0, Tensile strength 1.8.

*Subject to availability of casing.

B. Cementing Program

- i. Surface Casing: 200 sks Class C cement containing 2% CaCl. Yield at 1.34 cuft/sk. Cmt circulated to surface.
- ii. Intermediate Casing: 700 sacks Class H light cement with additives. Yield at 1.98 cuft/sk. 400 sacks Class H cement Containing FLA. Yield at 1.18 cuft/sk. Cmt circulated to surface.
- iii. Production Liner: This will be a Packer/Port completion from TD up inside 7" casing with packer type liner hanger.

See
COA

5. Mud Program:

See COA

Interval	Type System	Weight	Viscosity	Fluid Loss
0'-400'	FW spud mud	8.6-9.4	32-34	NA
400'-8560'	Brine water	10.0-10.2	28-30	NA
8560'-TD	FW mud w/ polymer	8.5-8.7	30-32	15

See
COA

6. Evaluation Program:

Samples: 10' samples from surface casing to TD
Logging: Gyro & GR only
Coring: As needed for evaluation
Drill Stem Tests: As needed for evaluation

7. Downhole Conditions

Zones of abnormal pressure: None anticipated
Zones of lost circulation: Anticipated in surface hole
Maximum bottom hole temperature: 125 degree F
Maximum bottom hole pressure: 8.34 lbs/gal gradient or less

8. Anticipated Starting Date:

Mewbourne Oil Company intends to drill this well as soon as possible after receiving approval with approximately 45 days involved in drilling operations and an additional 10 days involved in completion operations on the project.

Mewbourne Oil Company

Location: Eddy County, NM
Field: (Bradley) Sec 29, T18S, R30E
Facility: Bradley 29 Fed Com No. 2H

Slot: No. 2H SHL
Well: No. 2H
Wellbore: No. 2H PWB



Well Profile Data

Design Comment	MD (ft)	Inc (°)	Az (°)	TVD (ft)	Local N (ft)	Local E (ft)	DLS (°100ft)	VS (ft)
Tie On	0.00	0.000	273.606	0.00	0.00	0.00	0.00	0.00
EST. KOP	7648.00	0.000	273.606	7648.00	0.00	0.00	0.00	0.00
END OF CURVE	8553.85	90.558	273.606	8221.10	36.39	-577.56	10.00	578.71
No. 2H PBHL	12673.84	90.558	273.606	8181.00	295.48	-4689.20	0.00	4698.50

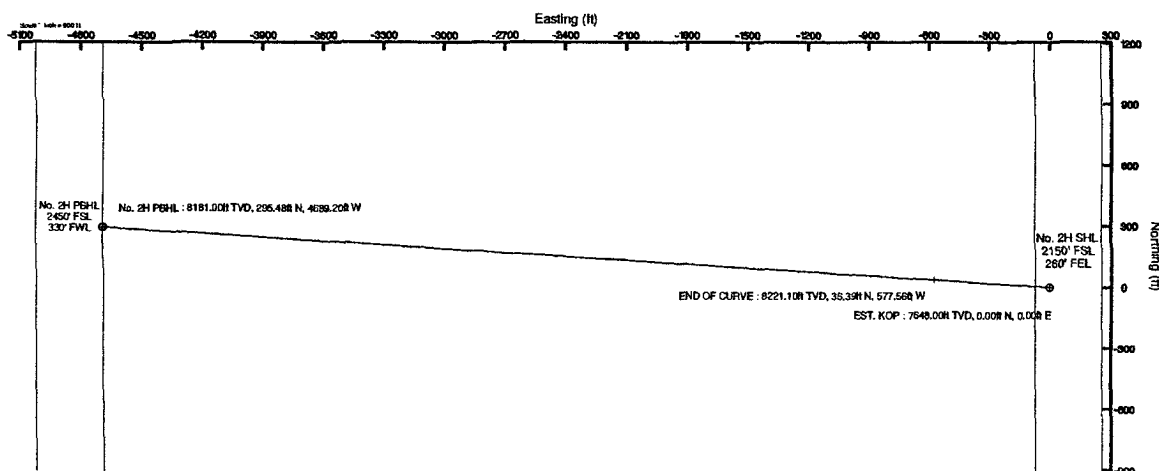

Plot reference wellpath is Plan #2	
True vertical depths are referenced to Rig on No. 2H SHL (KB)	Grid System: NAD27 / TM New Mexico State Planes, Eastern Zone (3001), US feet
Measured depths are referenced to Rig on No. 2H SHL (KB)	North Reference: Grid north
Rig on No. 2H SHL (KB) to Mean Sea Level: 3421 feet	Scale: True distance
Mean Sea Level to Mud line (Facility: Bradley 29 Fed Com No. 2H): -3403 feet	Depths are in feet
Coordinates are in feet referenced to Slot	Created by: Victor Hernandez on 6/3/2010

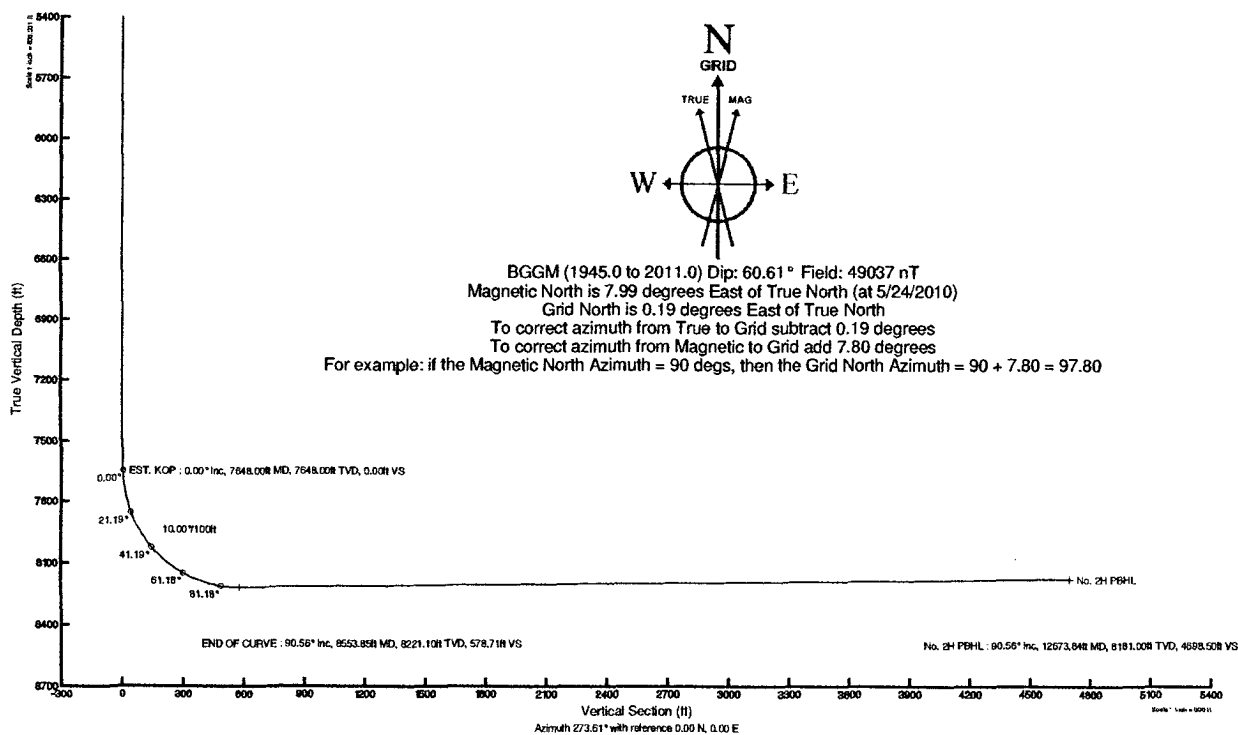

Planned Wellpath Report

 Mewbourne Oil Company

Plan #2
Page 1 of 4



REFERENCE WELLPATH IDENTIFICATION			
Operator	Mewbourne Oil Company	Slot	No. 2H SHL
Area	Eddy County, NM	Well	No. 2H
Field	(Bradley) Sec 29, T18S, R30E	Wellbore	No. 2H PWB
Facility	Bradley 29 Fed Com No. 2H		

REPORT SETUP INFORMATION			
Projection System	NAD27 / TM New Mexico State Planes, Eastern Zone (3001), US feet	Software System	WellArchitect® 2.0
North Reference	Grid	User	Victor Hernandez
Scale	0.999922	Report Generated	6/3/2010 at 2:25:01 PM
Convergence at slot	0.19° East	Database/Source file	WA_Midland/No. 2H_PWB.xml

WELLPATH LOCATION						
	Local coordinates		Grid coordinates		Geographic coordinates	
	North[ft]	East[ft]	Easting[USft]	Northing[USft]	Latitude	Longitude
Slot Location	0.00	0.00	606861.53	624729.74	32°43'01.191"N	103°59'09.178"W
Facility Reference Pt			606861.53	624729.74	32°43'01.191"N	103°59'09.178"W
Field Reference Pt			605219.71	623628.40	32°42'50.345"N	103°59'28.437"W

WELLPATH DATUM			
Calculation method	Minimum curvature	Rig on No. 2H SHL (KB) to GL	18.00ft
Horizontal Reference Pt	Slot	Rig on No. 2H SHL (KB) to Mean Sea Level	3421.00ft
Vertical Reference Pt	Rig on No. 2H SHL (KB)	GL to Mud Line (Facility)	0.00ft
MD Reference Pt	Rig on No. 2H SHL (KB)	Section Origin	N 0.00, E 0.00 ft
Field Vertical Reference	Mean Sea Level	Section Azimuth	273.61°

Planned Wellpath Report

Plan #2

Page 2 of 4



REFERENCE WELLPATH IDENTIFICATION

Operator	Mewbourne Oil Company	Slot	No. 2H SHL
Area	Eddy County, NM	Well	No. 2H
Field	(Bradley) Sec 29, T18S, R30E	Wellbore	No. 2H PWB
Facility	Bradley 29 Fed Com No. 2H		

WELLPATH DATA (54 stations) † = interpolated/extrapolated station

MD [ft]	Inclination [°]	Azimuth [°]	TVD [ft]	Vert Sect [ft]	North [ft]	East [ft]	Grid East [srv ft]	Grid North [srv ft]	Latitude	Longitude	DLS [°/100ft]	Comments
0.00	0.000	273.606	0.00	0.00	0.00	0.00	606861.53	624729.74	32°43'01.191"N	103°59'09.178"W	0.00	Tie On
7648.00	0.000	273.606	7648.00	0.00	0.00	0.00	606861.53	624729.74	32°43'01.191"N	103°59'09.178"W	0.00	EST. KOP
7748.00†	9.997	273.606	7747.49	8.70	0.55	-8.68	606852.84	624730.29	32°43'01.196"N	103°59'09.280"W	10.00	
7848.00†	19.994	273.606	7843.97	34.54	2.17	-34.48	606827.05	624731.91	32°43'01.213"N	103°59'09.582"W	10.00	
7948.00†	29.991	273.606	7934.49	76.74	4.83	-76.59	606784.94	624734.57	32°43'01.241"N	103°59'10.075"W	10.00	
8048.00†	39.988	273.606	8016.31	134.01	8.43	-133.74	606727.79	624738.17	32°43'01.278"N	103°59'10.743"W	10.00	
8148.00†	49.985	273.606	8086.95	204.61	12.87	-204.21	606657.33	624742.61	32°43'01.325"N	103°59'11.568"W	10.00	
8248.00†	59.982	273.606	8144.25	286.41	18.01	-285.84	606575.71	624747.75	32°43'01.378"N	103°59'12.523"W	10.00	
8348.00†	69.979	273.606	8186.49	376.91	23.70	-376.16	606485.39	624753.44	32°43'01.437"N	103°59'13.580"W	10.00	
8448.00†	79.976	273.606	8212.38	473.37	29.77	-472.43	606389.13	624759.51	32°43'01.500"N	103°59'14.707"W	10.00	
8548.00†	89.973	273.606	8221.13	572.86	36.03	-571.73	606289.84	624765.77	32°43'01.566"N	103°59'15.868"W	10.00	
8553.85	90.558	273.606	8221.10	578.71	36.39	-577.56	606284.01	624766.13	32°43'01.569"N	103°59'15.937"W	10.00	END OF CURVE
8648.00†	90.558	273.606	8220.19	672.86	42.31	-671.52	606190.06	624772.05	32°43'01.631"N	103°59'17.036"W	0.00	
8748.00†	90.558	273.606	8219.21	772.85	48.60	-771.32	606090.27	624778.34	32°43'01.696"N	103°59'18.204"W	0.00	
8848.00†	90.558	273.606	8218.24	872.85	54.89	-871.12	605990.48	624784.63	32°43'01.762"N	103°59'19.372"W	0.00	
8948.00†	90.558	273.606	8217.27	972.84	61.18	-970.92	605890.69	624790.92	32°43'01.827"N	103°59'20.540"W	0.00	
9048.00†	90.558	273.606	8216.29	1072.84	67.47	-1070.71	605790.90	624797.21	32°43'01.893"N	103°59'21.707"W	0.00	
9148.00†	90.558	273.606	8215.32	1172.83	73.76	-1170.51	605691.11	624803.49	32°43'01.958"N	103°59'22.875"W	0.00	
9248.00†	90.558	273.606	8214.35	1272.83	80.05	-1270.31	605591.32	624809.78	32°43'02.024"N	103°59'24.043"W	0.00	
9348.00†	90.558	273.606	8213.37	1372.82	86.33	-1370.10	605491.53	624816.07	32°43'02.089"N	103°59'25.211"W	0.00	
9448.00†	90.558	273.606	8212.40	1472.82	92.62	-1469.90	605391.74	624822.36	32°43'02.154"N	103°59'26.379"W	0.00	
9548.00†	90.558	273.606	8211.43	1572.81	98.91	-1569.70	605291.95	624828.65	32°43'02.220"N	103°59'27.546"W	0.00	
9648.00†	90.558	273.606	8210.45	1672.81	105.20	-1669.50	605192.16	624834.93	32°43'02.285"N	103°59'28.714"W	0.00	
9748.00†	90.558	273.606	8209.48	1772.80	111.49	-1769.29	605092.37	624841.22	32°43'02.351"N	103°59'29.882"W	0.00	
9848.00†	90.558	273.606	8208.51	1872.80	117.78	-1869.09	604992.58	624847.51	32°43'02.416"N	103°59'31.050"W	0.00	
9948.00†	90.558	273.606	8207.53	1972.79	124.07	-1968.89	604892.79	624853.80	32°43'02.481"N	103°59'32.217"W	0.00	
10048.00†	90.558	273.606	8206.56	2072.79	130.35	-2068.69	604793.00	624860.09	32°43'02.547"N	103°59'33.385"W	0.00	
10148.00†	90.558	273.606	8205.59	2172.78	136.64	-2168.48	604693.21	624866.37	32°43'02.612"N	103°59'34.553"W	0.00	
10248.00†	90.558	273.606	8204.61	2272.78	142.93	-2268.28	604593.43	624872.66	32°43'02.678"N	103°59'35.721"W	0.00	
10348.00†	90.558	273.606	8203.64	2372.77	149.22	-2368.08	604493.64	624878.95	32°43'02.743"N	103°59'36.889"W	0.00	

Planned Wellpath Report

Mewbourne Oil Company

Plan #2
Page 3 of 4



REFERENCE WELLPATH IDENTIFICATION			
Operator	Mewbourne Oil Company	Slot	No. 2H SHL
Area	Eddy County, NM	Well	No. 2H
Field	(Bradley) Sec 29, T18S, R30E	Wellbore	No. 2H PWB
Facility	Bradley 29 Fed Com No. 2H		

WELLPATH DATA (54 stations) † = interpolated/extrapolated station												
MD [ft]	Inclination [°]	Azimuth [°]	TVD [ft]	Vert Sect [ft]	North [ft]	East [ft]	Grid East [srv ft]	Grid North [srv ft]	Latitude	Longitude	DLS [°/100ft]	Comments
10448.00†	90.558	273.606	8202.67	2472.77	155.51	-2467.88	604393.85	624885.24	32°43'02.808"N	103°59'38.056"W	0.00	
10548.00†	90.558	273.606	8201.69	2572.77	161.80	-2567.67	604294.06	624891.53	32°43'02.874"N	103°59'39.224"W	0.00	
10648.00†	90.558	273.606	8200.72	2672.76	168.09	-2667.47	604194.27	624897.81	32°43'02.939"N	103°59'40.392"W	0.00	
10748.00†	90.558	273.606	8199.75	2772.76	174.37	-2767.27	604094.48	624904.10	32°43'03.005"N	103°59'41.560"W	0.00	
10848.00†	90.558	273.606	8198.77	2872.75	180.66	-2867.06	603994.69	624910.39	32°43'03.070"N	103°59'42.728"W	0.00	
10948.00†	90.558	273.606	8197.80	2972.75	186.95	-2966.86	603894.90	624916.68	32°43'03.135"N	103°59'43.895"W	0.00	
11048.00†	90.558	273.606	8196.83	3072.74	193.24	-3066.66	603795.11	624922.97	32°43'03.201"N	103°59'45.063"W	0.00	
11148.00†	90.558	273.606	8195.85	3172.74	199.53	-3166.46	603695.32	624929.25	32°43'03.266"N	103°59'46.231"W	0.00	
11248.00†	90.558	273.606	8194.88	3272.73	205.82	-3266.25	603595.53	624935.54	32°43'03.331"N	103°59'47.399"W	0.00	
11348.00†	90.558	273.606	8193.91	3372.73	212.11	-3366.05	603495.74	624941.83	32°43'03.397"N	103°59'48.567"W	0.00	
11448.00†	90.558	273.606	8192.93	3472.72	218.39	-3465.85	603395.95	624948.12	32°43'03.462"N	103°59'49.734"W	0.00	
11548.00†	90.558	273.606	8191.96	3572.72	224.68	-3565.65	603296.16	624954.41	32°43'03.527"N	103°59'50.902"W	0.00	
11648.00†	90.558	273.606	8190.99	3672.71	230.97	-3665.44	603196.37	624960.69	32°43'03.593"N	103°59'52.070"W	0.00	
11748.00†	90.558	273.606	8190.01	3772.71	237.26	-3765.24	603096.59	624966.98	32°43'03.658"N	103°59'53.238"W	0.00	
11848.00†	90.558	273.606	8189.04	3872.70	243.55	-3865.04	602996.80	624973.27	32°43'03.723"N	103°59'54.406"W	0.00	
11948.00†	90.558	273.606	8188.07	3972.70	249.84	-3964.84	602897.01	624979.56	32°43'03.789"N	103°59'55.573"W	0.00	
12048.00†	90.558	273.606	8187.09	4072.69	256.13	-4064.63	602797.22	624985.85	32°43'03.854"N	103°59'56.741"W	0.00	
12148.00†	90.558	273.606	8186.12	4172.69	262.41	-4164.43	602697.43	624992.14	32°43'03.919"N	103°59'57.909"W	0.00	
12248.00†	90.558	273.606	8185.14	4272.68	268.70	-4264.23	602597.64	624998.42	32°43'03.985"N	103°59'59.077"W	0.00	
12348.00†	90.558	273.606	8184.17	4372.68	274.99	-4364.02	602497.85	625004.71	32°43'04.050"N	104°00'00.245"W	0.00	
12448.00†	90.558	273.606	8183.20	4472.68	281.28	-4463.82	602398.06	625011.00	32°43'04.115"N	104°00'01.412"W	0.00	
12548.00†	90.558	273.606	8182.22	4572.67	287.57	-4563.62	602298.27	625017.29	32°43'04.181"N	104°00'02.580"W	0.00	
12648.00†	90.558	273.606	8181.25	4672.67	293.86	-4663.42	602198.48	625023.58	32°43'04.246"N	104°00'03.748"W	0.00	
12673.84	90.558	273.606	8181.00†	4698.50	295.48	-4689.20	602172.70	625025.20	32°43'04.263"N	104°00'04.050"W	0.00	No. 2H PBHL

Planned Wellpath Report

 Mewbourne Oil Company

Plan #2
Page 4 of 4



REFERENCE WELLPATH IDENTIFICATION			
Operator	Mewbourne Oil Company	Slot	No. 2H SHL
Area	Eddy County, NM	Well	No. 2H
Field	(Bradley) Sec 29, T18S, R30E	Wellbore	No. 2H PWB
Facility	Bradley 29 Fed Com No. 2H		

TARGETS									
Name	MD [ft]	TVD [ft]	North [ft]	East [ft]	Grid East [srv ft]	Grid North [srv ft]	Latitude	Longitude	Shape
1) No. 2H PBHL	12673.84	8181.00	295.48	-4689.20	602172.70	625025.20	32°43'04.263"N	104°00'04.050"W	point

SURVEY PROGRAM Ref Wellbore: No. 2H PWB Ref Wellpath: Plan #2				
Start MD [ft]	End MD [ft]	Positional Uncertainty Model	Log Name/Comment	Wellbore
18.00	12673.84	NaviTrak (Standard)		No. 2H PWB

Mewbourne Oil Company

Bradley 29 Federal Com #2H

2150' FSL & 260' FEL

Sec 29, T18S, R30E

Eddy Co., NM

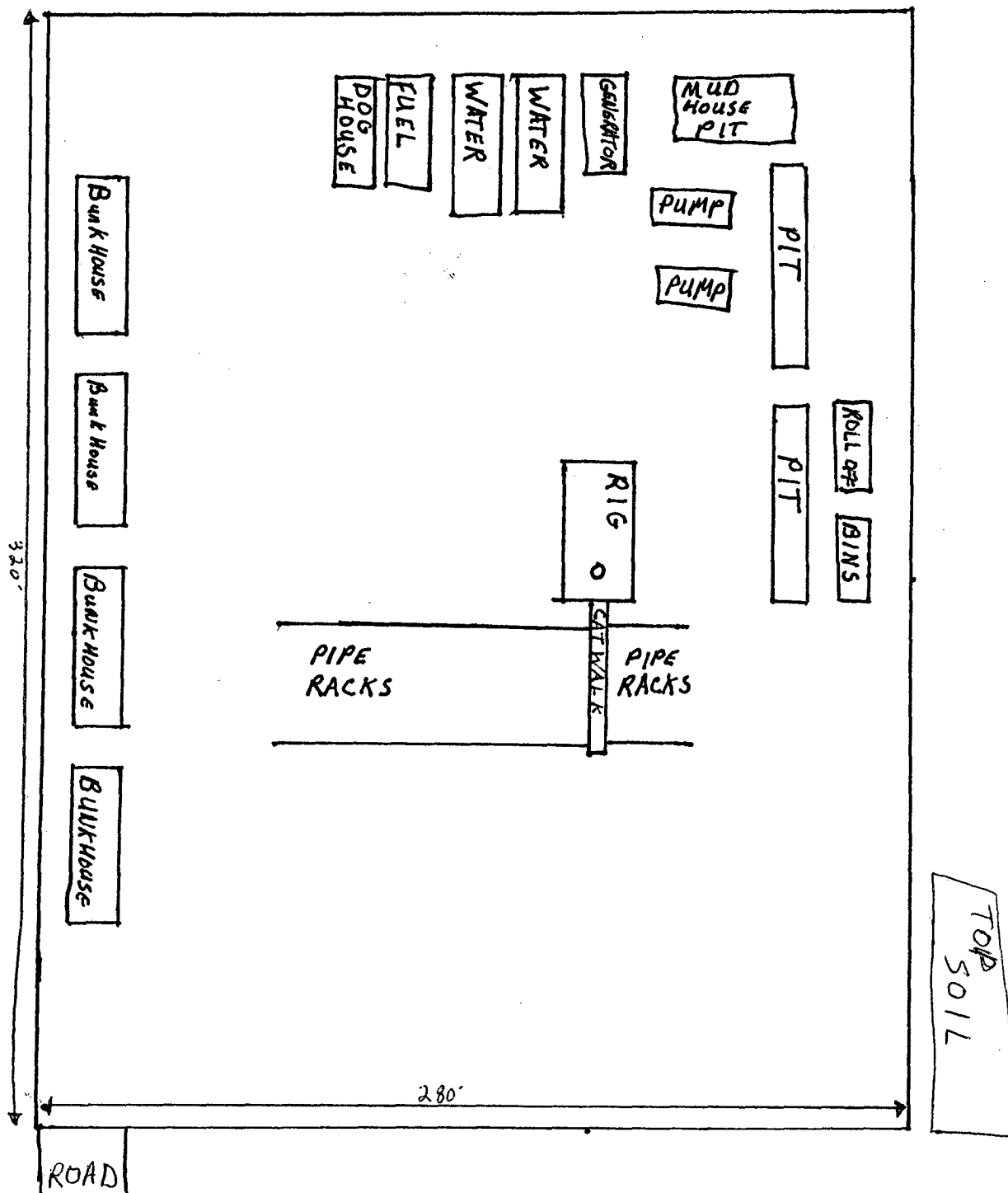
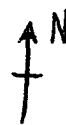

1" = 50'

Exhibit #5

Mewbourne Oil Company
Bradley 29 Federal Com #2H
2150' FSL & 260' FEL
Sec 29, T18S, R30E
Eddy Co., NM

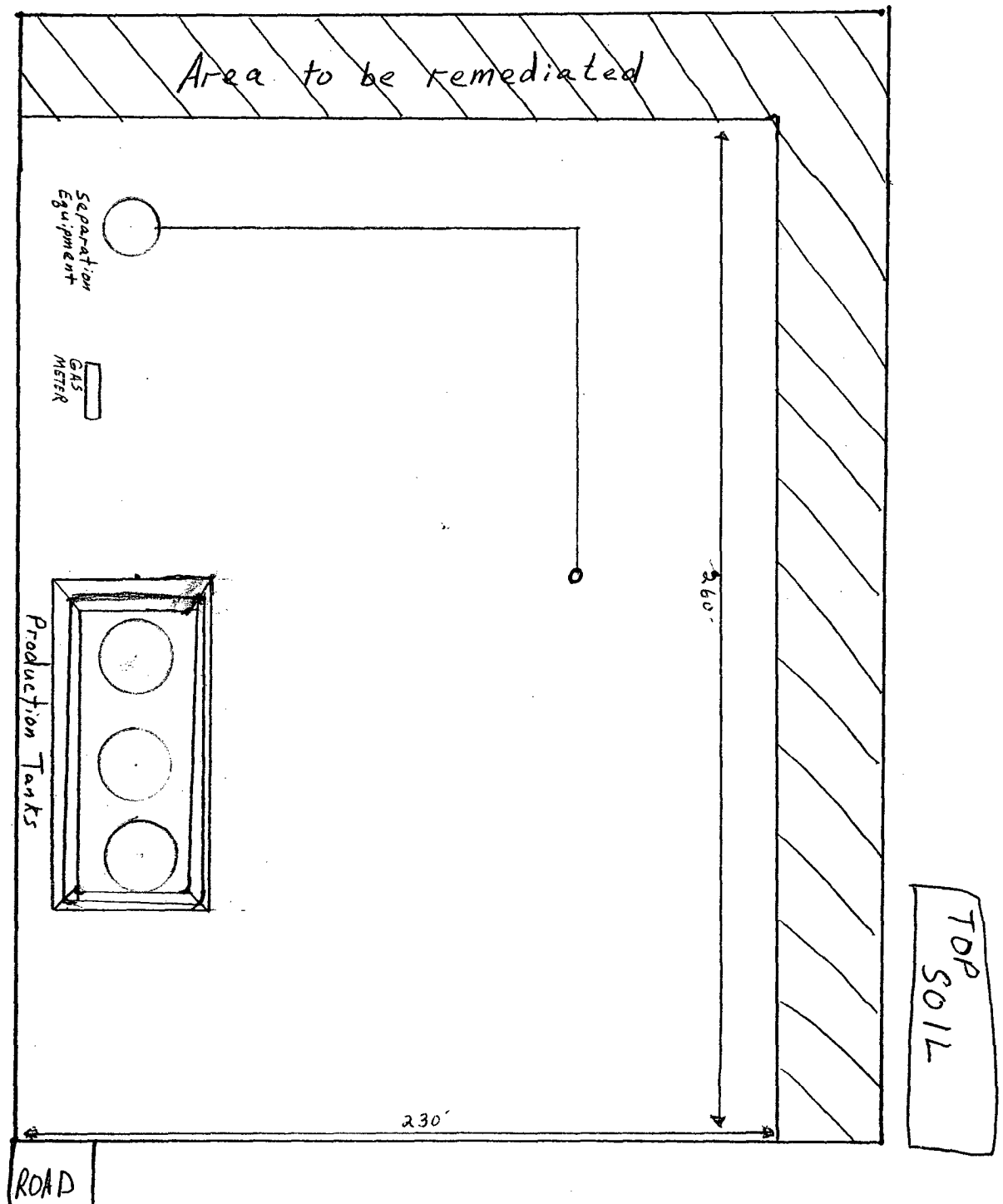

Exhibit #6

Notes Regarding Blowout Preventer

Mewbourne Oil Company

Bradley 29 Federal Com #2H

2150' FSL & 260' F~~E~~ L (SL)

Sec 29-T18S-R30E

Eddy County, New Mexico

- I. Drilling nipple (bell nipple) to be constructed so that it can be removed without the use of a welder through the opening of the rotary table, with minimum internal diameter equal to blowout preventer bore.
- II. Blowout preventer and all fittings must be in good condition with a minimum 3000 psi working pressure on 9 5/8" casing and 3000 psi working pressure on 7" casing.
- III. Safety valve must be available on the rig floor at all times with proper connections to install in the drill string. Valve must be full bore with minimum 3000 psi working pressure.
- IV. Equipment through which bit must pass shall be at least as large as internal diameter of the casing.
- V. A kelly cock shall be installed on the kelly at all times.

Blowout preventer closing equipment to include and accumulator of at least 40 gallon capacity, two independent sources of pressure on closing unit, and meet all other API specifications.

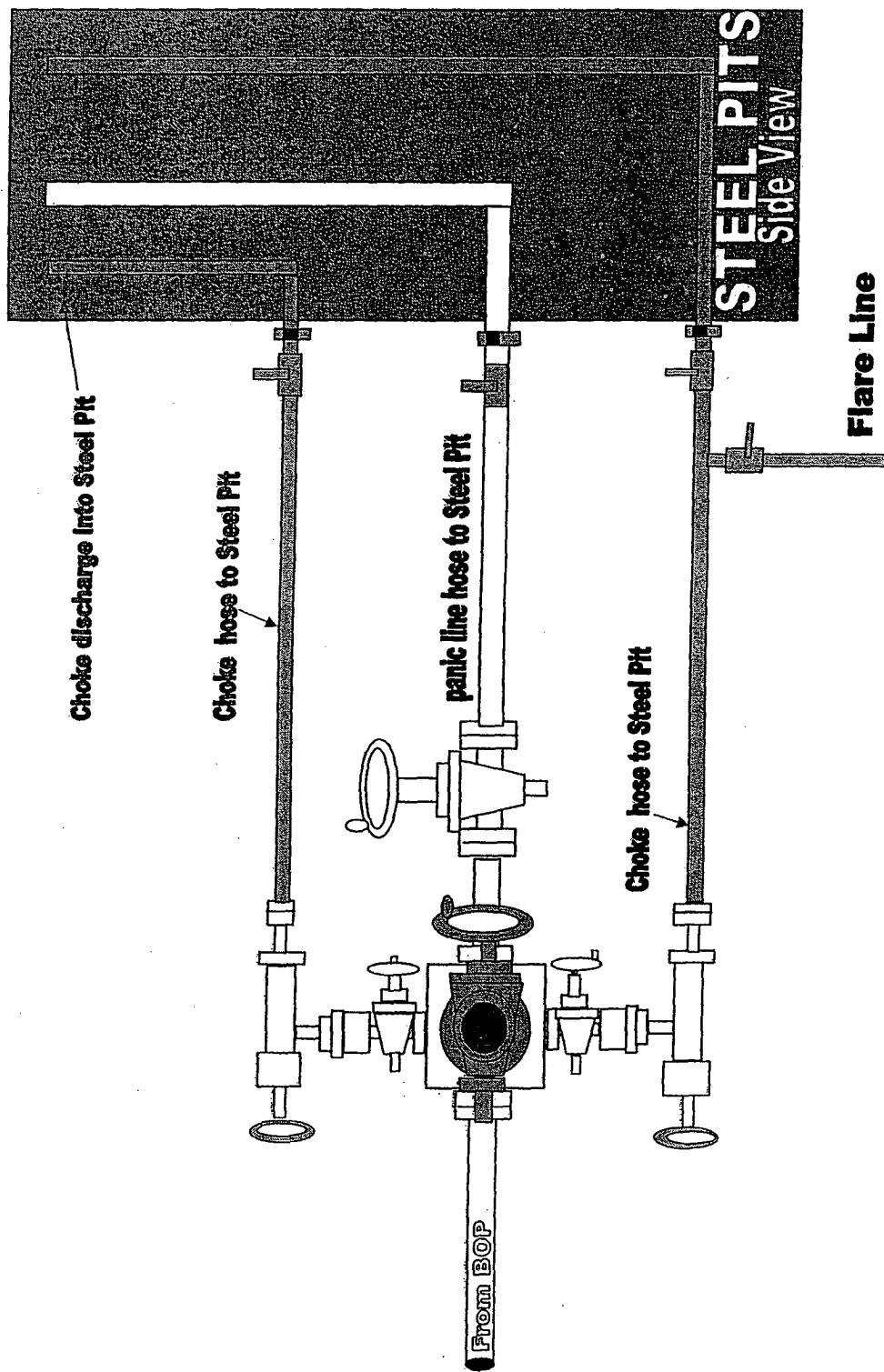

2000#/3000#BOP manifold system

For Exhibit 2 + 2A

Mewbourne Oil Company
BOP Schematic for
8 3/4" or 7 7/8" Hole

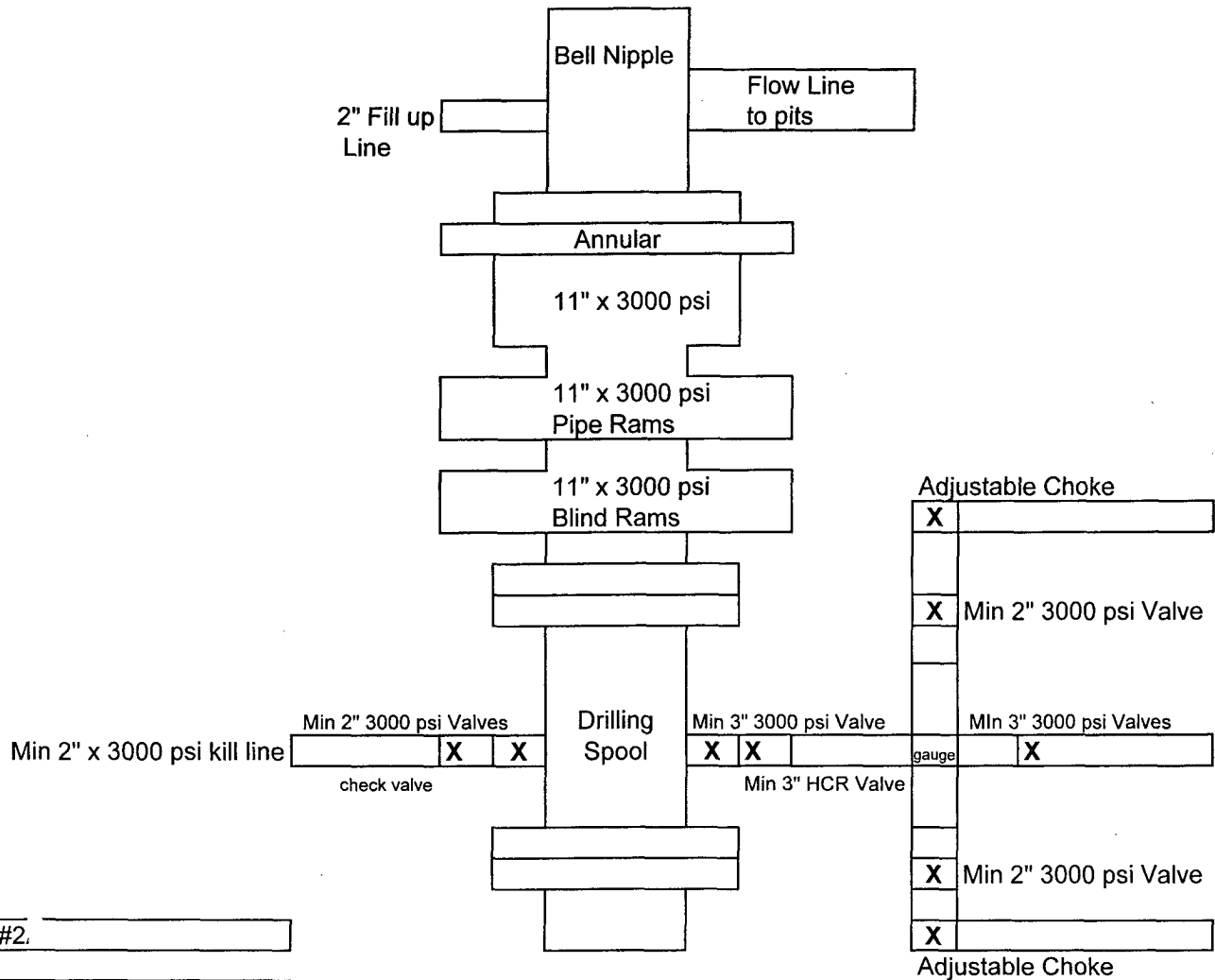

Exhibit #2.

Bradley 29 Federal Com #2H
2150' FSL & 260' F.E.L
Sec 29-T18S-R30E
Eddy, County
New Mexico

Mewbourne Oil Company
BOP Schematic for
6 1/8" Hole

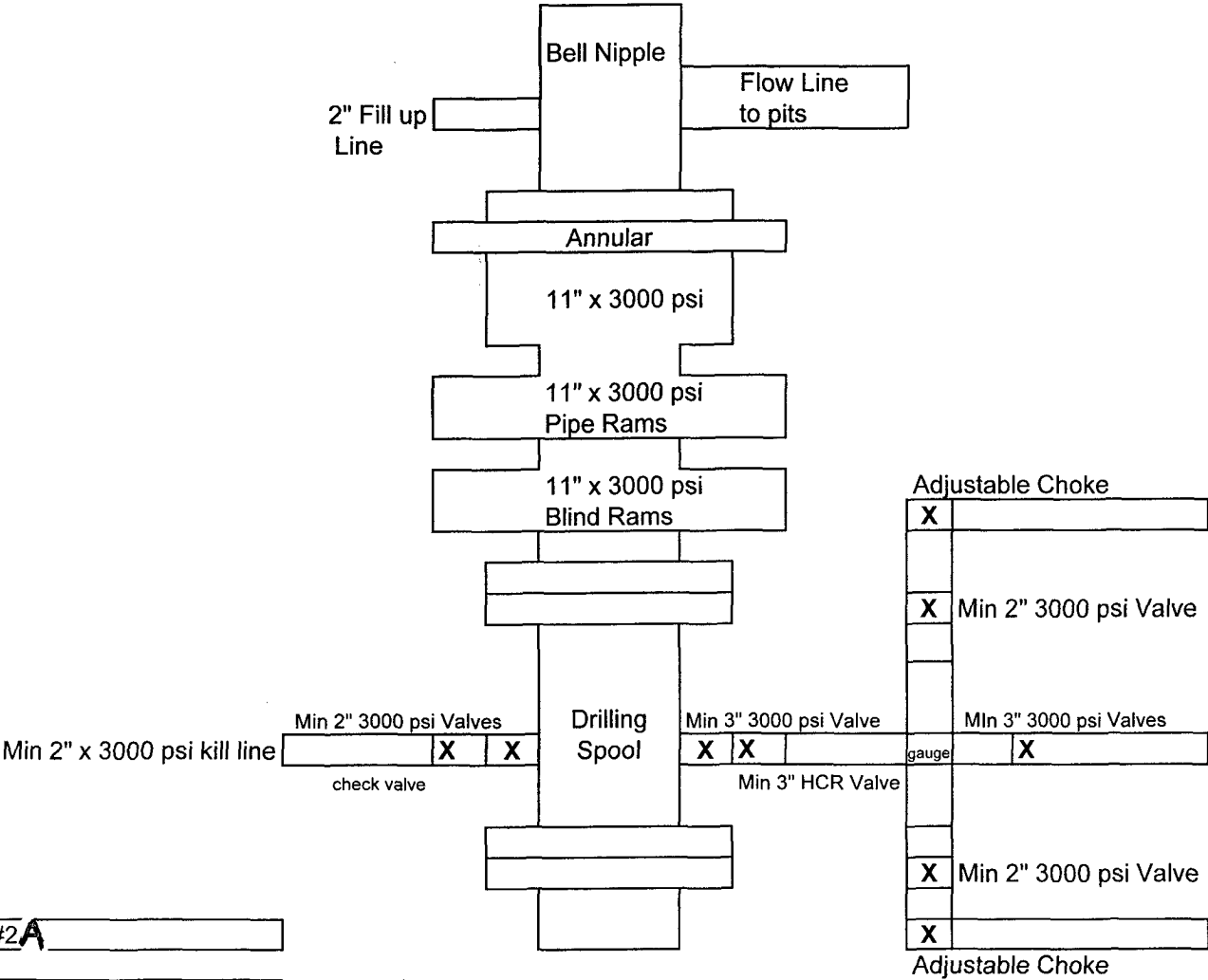

Exhibit #2A

Bradley 29 Federal Com #2H
2150' FSL & 260' FEL
Sec 29-T18S-R30E
Eddy, County
New Mexico

Hydrogen Sulfide Drilling Operations Plan

Mewbourne Oil Company
Bradley 29 Federal Com #2H
2150' FSL & 260' FEL
Sec 29-T18S-R30E
Eddy County, New Mexico

1. General Requirements

Rule 118 does not apply to this well because MOC has researched this area and no high concentrations of H₂S were found. MOC will have on location and working all H₂S safety equipment before the Yates formation for purposes of safety and insurance requirements.

2. Hydrogen Sulfide Training

All personnel, whether regularly assigned, contracted, or employed on an unscheduled basis, will have received training from a qualified instructor in the following areas prior to entering the drilling pad area of the well:

1. The hazards and characteristics of hydrogen sulfide gas.
2. The proper use of personal protective equipment and life support systems.
3. The proper use of hydrogen sulfide detectors, alarms, warning systems, briefing areas, evacuation procedures.
4. The proper techniques for first aid and rescue operations.

Additionally, supervisory personnel will be trained in the following areas:

- 1 The effects of hydrogen sulfide on metal components. If high tensile tubular systems are utilized, supervisory personnel will be trained in their special maintenance requirements.
- 2 Corrective action and shut in procedures, blowout prevention, and well control procedures while drilling a well.
- 3 The contents of the Hydrogen Sulfide Drilling Operations Plan.

There will be an initial training session prior to encountering a known hydrogen sulfide source. The initial training session shall include a review of the site specific Hydrogen Sulfide Drilling Operations Plan.

3. Hydrogen Sulfide Safety Equipment and Systems

All hydrogen sulfide safety equipment and systems will be installed, tested, and operational prior to drilling below the intermediate casing.

1. Well Control Equipment
 - A. Flare line with automatic igniter or continuous ignition source.
 - B. Choke manifold with minimum of one adjustable choke.
 - C. Blowout preventers equipped with blind rams and pipe rams to accommodate all pipe sizes with properly sized closing unit
 - D. Auxiliary equipment including annular type blowout preventer.
2. Protective Equipment for Essential Personnel

Thirty minute self contained work unit located at briefing area as indicated on wellsite diagram.

3. Hydrogen Sulfide Protection and Monitoring Equipment

Two portable hydrogen sulfide monitors positioned on location for optimum coverage and detection. The units shall have audible sirens to notify personnel when hydrogen sulfide levels exceed 20 PPM.

4. Visual Warning Systems

A. Wind direction indicators as indicated on the wellsite diagram.

B. Caution signs shall be posted on roads providing access to location. Signs shall be painted a high visibility color with lettering of sufficient size to be readable at reasonable distances from potentially contaminated areas.

4. **Mud Program**

The mud program has been designed to minimize the amount of hydrogen sulfide entrained in the mud system. Proper mud weight, safe drilling practices, and the use of hydrogen sulfide scavengers will minimize hazards while drilling the well.

5. **Metallurgy**

All tubular systems, wellheads, blowout preventers, drilling spools, kill lines, choke manifolds, and valves shall be suitable for service in a hydrogen sulfide environment when chemically treated.

6. **Communications**

State & County Officials phone numbers are posted on rig floor and supervisors trailer. Communications in company vehicles and toolpushers are either two way radios or cellular phones.

7. **Well Testing**

Drill stem testing is not an anticipated requirement for evaluation of this well. A drill stem test is required, it will be conducted with a minimum number of personnel in the immediate vicinity. The test will be conducted during daylight hours only.

8. **Emergency Phone Numbers**

Eddy County Sheriff's Office	911 or 575-887-7551
Ambulance Service	911 or 575-885-2111
Carlsbad Fire Dept	911 or 575-885-2111
Loco Hills Volunteer Fire Dept.	911 or 575-677-3266
Closest Medical Facility - Columbia Medical Center of Carlsbad	575-492-5000

Mewbourne Oil Company	Hobbs District Office	575-393-5905
	Fax	575-397-6252
	2 nd Fax	575-393-7259

District Manager	Micky Young	575-390-0999
Drilling Superintendent	Frosty Lathan	575-390-4103
Drilling Foreman	Wesley Noseff	575-441-0729
Drilling Foreman	George Smith	575-390-4365

MULTI-POINT SURFACE USE AND OPERATIONS PLAN

MEWBOURNE OIL COMPANY

Bradley 29 Federal Com #2H

2150' FSL & 260' FEL (SHL)

Sec 29-T18S-R30E

Eddy County, New Mexico

This plan is submitted with Form 3160-3, Application for Permit to Drill, Covering the above described well. The purpose of this plan is to describe the location of the proposed well, the proposed construction activities and operations plan, the magnitude of the surface disturbance involved, and the procedures to be followed in restoring the surface so that a complete appraisal can be made of the environmental impact associated with the proposed operations.

1. Existing Roads:

- A. Exhibit #3 is a road map showing the location of the proposed well. Existing roads are highlighted in black and proposed road is highlighted in blue. Exhibit #3A is a topographic map showing the location of the proposed well and access road. Existing and proposed roads are highlighted in black.
- B. Directions to location from Carlsbad, NM: Go NE on Hwy 62/180 for 15 miles to Hwy 360. Turn North and go 13 miles to Grubbs Rd (CR 250). Turn right and go 1 mile. Turn left (West) on lease Road 0.2 mile. Turn right (North) and go 1.5 miles. Turn right (East) and go .3 mile. Turn left (North) 110' to location.

2. Proposed Access Road:

- A. Approx 110' of new road will be needed.
- B. The maximum width of the driving surface will be 14 feet. The road will be crowned and ditched with a 2% slope from the tip of the crown to the edge of the driving surface. The ditches will be 1 foot deep with 3:1 slopes. The road will be surfaced with rolled and compacted caliche.
- C. Mewbourne Oil Co. will cooperate with other operators in the maintenance of lease roads.

3. Location of Existing Wells:

There are producing wells within the immediate vicinity of the well site. Exhibit #4 shows the proposed well and existing wells within a one mile radius.

4. Location of Existing and/or Proposed Facilities:

- A. There are no production facilities on this lease at the present time.
- B. In the event that the well is productive, production facilities will be located on the NE side of well pad. Gas purchaser will build pipeline to this location.
- C. All production vessels left on location will be painted to conform with BLM painting stipulations within 180 days of installation.

5. Location and Type of Water Supply

The well will be drilled with a combination of fresh water and brine water based mud systems. The water will be obtained from commercial suppliers in the area and/or hauled to the location by transport trucks over existing and proposed roads as indicated in Exhibit #3.

6. Source of Construction Materials

All material required for construction of the drill pad and access roads will be obtained from private, state, or federal pits. The construction contractor will be solely responsible for securing construction materials required for this operation and paying any royalties that may be required on those materials.

7. Methods of Handling Waste Disposal:

- A. Drill cuttings not retained for evaluation purposed will be hauled to CRI permit# NM-010006.
- B. Water produced during operations will be hauled to Loco Hills Water Disposal permit# R-3221, or another permitted SWD in the area.
- C. If any liquid hydrocarbons are produced during operations, those liquids will be stored in suitable tanks until sold.
- D. Current regulations regarding the proper disposal of human waste will be followed.
- E. All trash, junk, and other waste materials will be stored in proper containers to prevent dispersal and will be removed to an appropriate facility within one week of cessation of drilling and completion activities.

8. Ancillary Facilities

There are no ancillary facilities within the immediate vicinity of the proposed well site.

9. Well Site Layout

- A. A diagram of the drill pad is shown in Exhibit #5. Dimensions of the pad and location of major rig components are shown.
- B. The pad dimension of 280' x 320' has been staked and flagged.
- C. An archaeological survey is in the process of being conducted on the proposed location pad.

10. Plans for Restoration of Surface

- A. Upon cessation of the proposed operations, if the well is abandoned, the location and road surfacing material will be removed. The entire location will be restored to the original contour as much as reasonable possible using stockpiled top soil. All trash and garbage will be hauled to appropriate disposal to assure the location is aesthetically pleasing as reasonable possible. All restoration work will be completed within 180 days of cessation of activities.
- B. The disturbed area will be restored by re-seeding during the proper growing season.
- C. Any additional caliche required for production facilities will be obtained from the area shown in exhibit #6 as interim reclamation.
- D. Within 90 days of cessation of drilling and completion operations, all equipment not necessary for production operations will be removed. The location will be cleaned of all trash and junk to assure the well site is left as aesthetically pleasing as reasonably possible.

11. Surface Ownership:

The surface is owned by BLM.

12. Other Information:

- A. Topography: Refer to the archaeological report for a detailed description of flora, fauna, soil characteristics, dwellings, and historical or cultural sites.
- B. The primary use of the surface at the location is for grazing of livestock.

13. Operator's Representative:

- A. Through APD approval, drilling, completion and production operations:

N.M. Young, District Manager
Mewbourne Oil Company
PO Box 5270
Hobbs, NM 88241
575-393-5905

Mewbourne Oil Company

PO Box 5270
Hobbs, NM 88241
(575) 393-5905

I hereby certify that I, or someone under my direct supervision, have inspected the drill site and access route proposed herein; that I am familiar with the conditions which currently exist; that I have full knowledge of State and Federal laws applicable to this operation; that the statements made in this APD package are, to the best of my knowledge, true and correct; and that the work associated with the operations proposed herein will be performed in conformity with this APD package and the terms and conditions under which it is approved. I also certify that I, or the company I represent, am responsible for the operations conducted under this application. These statements are subject to the provisions of 18 U.S.C. 1001 for the filing of false statements.

Executed this 29 day of May, 2010.

Name: NM Young

Signature: 

Position Title: Hobbs District Manager

Address: PO Box 5270, Hobbs NM 88241

Telephone: 575-393-5905

E-mail: myoung@mewbourne.com

PECOS DISTRICT CONDITIONS OF APPROVAL

OPERATOR'S NAME:	MEWBOURNE OIL CO.
LEASE NO.:	NM-27280
WELL NAME & NO.:	2H-BRADLEY 29 FED COM
SURFACE HOLE FOOTAGE:	2260' FSL & 0150' FWL
BOTTOM HOLE FOOTAGE	2450' FSL & 0330' FWL
LOCATION:	Section 29, T. 18 S., R. 30 E., NMPM
COUNTY:	Eddy County, New Mexico

TABLE OF CONTENTS

Standard Conditions of Approval (COA) apply to this APD. If any deviations to these standards exist or special COAs are required, the section with the deviation or requirement will be checked below.

- ☐ **General Provisions**
- ☐ **Permit Expiration**
- ☐ **Archaeology, Paleontology, and Historical Sites**
- ☐ **Noxious Weeds**
- ☒ **Special Requirements**
 - Lesser Prairie-Chicken Timing Stipulations
 - Ground-level Abandoned Well Marker
 - Communitization Agreement
- ☒ **Construction**
 - Notification
 - Topsoil
 - Closed Loop System
 - Federal Mineral Material Pits
 - Well Pads
 - Roads
- ☐ **Road Section Diagram**
- ☒ **Drilling**
 - Secretary's Potash
 - H2S – Onshore Order 6 Requirements
 - Capitan Water Basin
 - Logging Requirements
 - Waste Material and Fluids
- ☐ **Production (Post Drilling)**
 - Well Structures & Facilities
- ☐ **Interim Reclamation**
- ☒ **Final Abandonment & Reclamation**

I. GENERAL PROVISIONS

The approval of the Application For Permit To Drill (APD) is in compliance with all applicable laws and regulations: 43 Code of Federal Regulations 3160, the lease terms, Onshore Oil and Gas Orders, Notices To Lessees, New Mexico Oil Conservation Division (NMOCD) Rules, National Historical Preservation Act As Amended, and instructions and orders of the Authorized Officer. Any request for a variance shall be submitted to the Authorized Officer on Form 3160-5, Sundry Notices and Report on Wells.

II. PERMIT EXPIRATION

If the permit terminates prior to drilling and drilling cannot be commenced within 60 days after expiration, an operator is required to submit Form 3160-5, Sundry Notices and Reports on Wells, requesting surface reclamation requirements for any surface disturbance. However, if the operator will be able to initiate drilling within 60 days after the expiration of the permit, the operator must have set the conductor pipe in order to allow for an extension of 60 days beyond the expiration date of the APD. (Filing of a Sundry Notice is required for this 60 day extension.)

III. ARCHAEOLOGICAL, PALEONTOLOGY & HISTORICAL SITES

Any cultural and/or paleontological resource discovered by the operator or by any person working on the operator's behalf shall immediately report such findings to the Authorized Officer. The operator is fully accountable for the actions of their contractors and subcontractors. The operator shall suspend all operations in the immediate area of such discovery until written authorization to proceed is issued by the Authorized Officer. An evaluation of the discovery shall be made by the Authorized Officer to determine the appropriate actions that shall be required to prevent the loss of significant cultural or scientific values of the discovery. The operator shall be held responsible for the cost of the proper mitigation measures that the Authorized Officer assesses after consultation with the operator on the evaluation and decisions of the discovery. Any unauthorized collection or disturbance of cultural or paleontological resources may result in a shutdown order by the Authorized Officer.

IV. NOXIOUS WEEDS

The operator shall be held responsible if noxious weeds become established within the areas of operations. Weed control shall be required on the disturbed land where noxious weeds exist, which includes the roads, pads, associated pipeline corridor, and adjacent land affected by the establishment of weeds due to this action. The operator shall consult with the Authorized Officer for acceptable weed control methods, which include following EPA and BLM requirements and policies.

V. SPECIAL REQUIREMENT(S)

Timing Limitation Stipulation / Condition of Approval for lesser prairie-chicken: Oil and gas activities including 3-D geophysical exploration, and drilling will not be allowed in lesser prairie-chicken habitat during the period from March 1st through June 15th annually. During that period, other activities that produce noise or involve human activity, such as the maintenance of oil and gas facilities, pipeline, road, and well pad construction, will be allowed except between 3:00 am and 9:00 am. The 3:00 am to 9:00 am restriction will not apply to normal, around-the-clock operations, such as venting, flaring, or pumping, which do not require a human presence during this period. Additionally, no new drilling will be allowed within up to 200 meters of leks known at the time of permitting. Normal vehicle use on existing roads will not be restricted. Exhaust noise from pump jack engines must be muffled or otherwise controlled so as not to exceed 75 db measured at 30 feet from the source of the noise.

Ground-level Abandoned Well Marker to avoid raptor perching: Upon the plugging and subsequent abandonment of the well, the well marker will be installed at ground level on a plate containing the pertinent information for the plugged well. For more installation details, contact the Carlsbad Field Office at 575-234-5972.

Communitization Agreement

A Communitization Agreement covering the acreage dedicated to this well must be filed for approval with the BLM. The effective date of the agreement shall be prior to any sales.

VI. CONSTRUCTION

A. NOTIFICATION

The BLM shall administer compliance and monitor construction of the access road and well pad. Notify the Carlsbad Field Office at (575) 234-5972 at least 3 working days prior to commencing construction of the access road and/or well pad.

When construction operations are being conducted on this well, the operator shall have the approved APD and Conditions of Approval (COA) on the well site and they shall be made available upon request by the Authorized Officer.

B. TOPSOIL

The operator shall stockpile the topsoil in a low profile manner in order to prevent wind/water erosion of the topsoil. The topsoil to be stripped is approximately 6 inches in depth. The topsoil will be used for interim and final reclamation.

C. CLOSED LOOP SYSTEM

Tanks are required for drilling operations: No Pits.

The operator shall properly dispose of drilling contents at an authorized disposal site.

D. FEDERAL MINERAL MATERIALS PIT

Payment shall be made to the BLM prior to removal of any federal mineral materials. Call the Carlsbad Field Office at (575) 234-5972.

E. WELL PAD SURFACING

Surfacing of the well pad is not required.

If the operator elects to surface the well pad, the surfacing material may be required to be removed at the time of reclamation.

The well pad shall be constructed in a manner which creates the smallest possible surface disturbance, consistent with safety and operational needs.

F. ON LEASE ACCESS ROADS

Road Width

The access road shall have a driving surface that creates the smallest possible surface disturbance and does not exceed fourteen (14) feet in width. The maximum width of surface disturbance, when constructing the access road, shall not exceed thirty (30) feet.

Surfacing

Surfacing material is not required on the new access road driving surface. If the operator elects to surface the new access road or pad, the surfacing material may be required to be removed at the time of reclamation.

Where possible, no improvements should be made on the unsurfaced access road other than to remove vegetation as necessary, road irregularities, safety issues, or to fill low areas that may sustain standing water.

The Authorized Officer reserves the right to require surfacing of any portion of the access road at any time deemed necessary. Surfacing may be required in the event the road deteriorates, erodes, road traffic increases, or it is determined to be beneficial for future field development. The surfacing depth and type of material will be determined at the time of notification.

Crowning

Crowning shall be done on the access road driving surface. The road crown shall have a grade of approximately 2% (i.e., a 1" crown on a 14' wide road). The road shall conform to Figure 1; cross section and plans for typical road construction.

Ditching

Ditching shall be required on both sides of the road.

Turnouts

Vehicle turnouts shall be constructed on the road. Turnouts shall be intervisible with interval spacing distance less than 1000 feet. Turnouts shall be constructed on all blind curves. Turnouts shall conform to the following diagram:

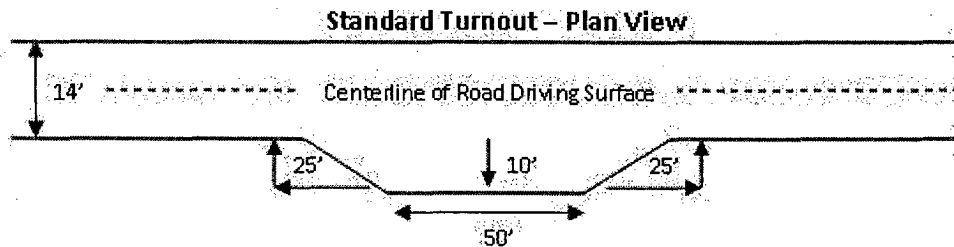

Drainage

Drainage control systems shall be constructed on the entire length of road (e.g. ditches, sidehill outsloping and insloping, lead-off ditches, culvert installation, and low water crossings).

A typical lead-off ditch has a minimum depth of 1 foot below and a berm of 6 inches above natural ground level. The berm shall be on the down-slope side of the lead-off ditch.

Cross Section of a Typical Lead-off Ditch

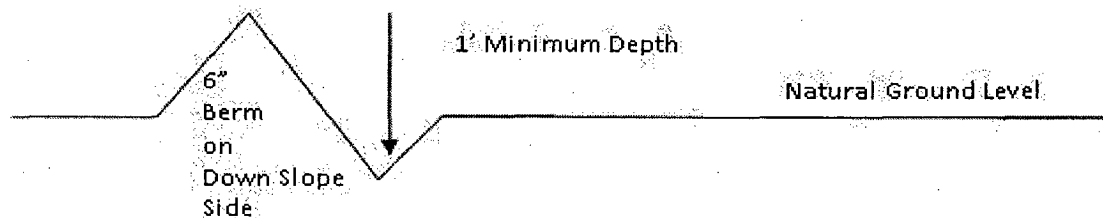

All lead-off ditches shall be graded to drain water with a 1 percent minimum to 3 percent maximum ditch slope. The spacing interval are variable for lead-off ditches and shall be determined according to the formula for spacing intervals of lead-off ditches, but may be amended depending upon existing soil types and centerline road slope (in %);

Formula for Spacing Interval of Lead-off Ditches

Example - On a 4% road slope that is 400 feet long, the water flow shall drain water into a lead-off ditch. Spacing interval shall be determined by the following formula:

$$400 \text{ foot road with } 4\% \text{ road slope: } \frac{400'}{4\%} + 100' = 200' \text{ lead-off ditch interval}$$

Culvert Installations

Appropriately sized culvert(s) shall be installed at the deep waterway channel flow crossing.

Cattleguards

An appropriately sized cattleguard(s) sufficient to carry out the project shall be installed and maintained at fence crossing(s).

Any existing cattleguard(s) on the access road shall be repaired or replaced if they are damaged or have deteriorated beyond practical use. The operator shall be responsible for the condition of the existing cattleguard(s) that are in place and are utilized during lease operations.

A gate shall be constructed and fastened securely to H-braces.

Fence Requirement

Where entry is required across a fence line, the fence shall be braced and tied off on both sides of the passageway prior to cutting.

The operator shall notify the private surface landowner or the grazing allotment holder prior to crossing any fence(s).

Public Access

Public access on this road shall not be restricted by the operator without specific written approval granted by the Authorized Officer.

Figure 1 – Cross Sections and Plans For Typical Road Sections

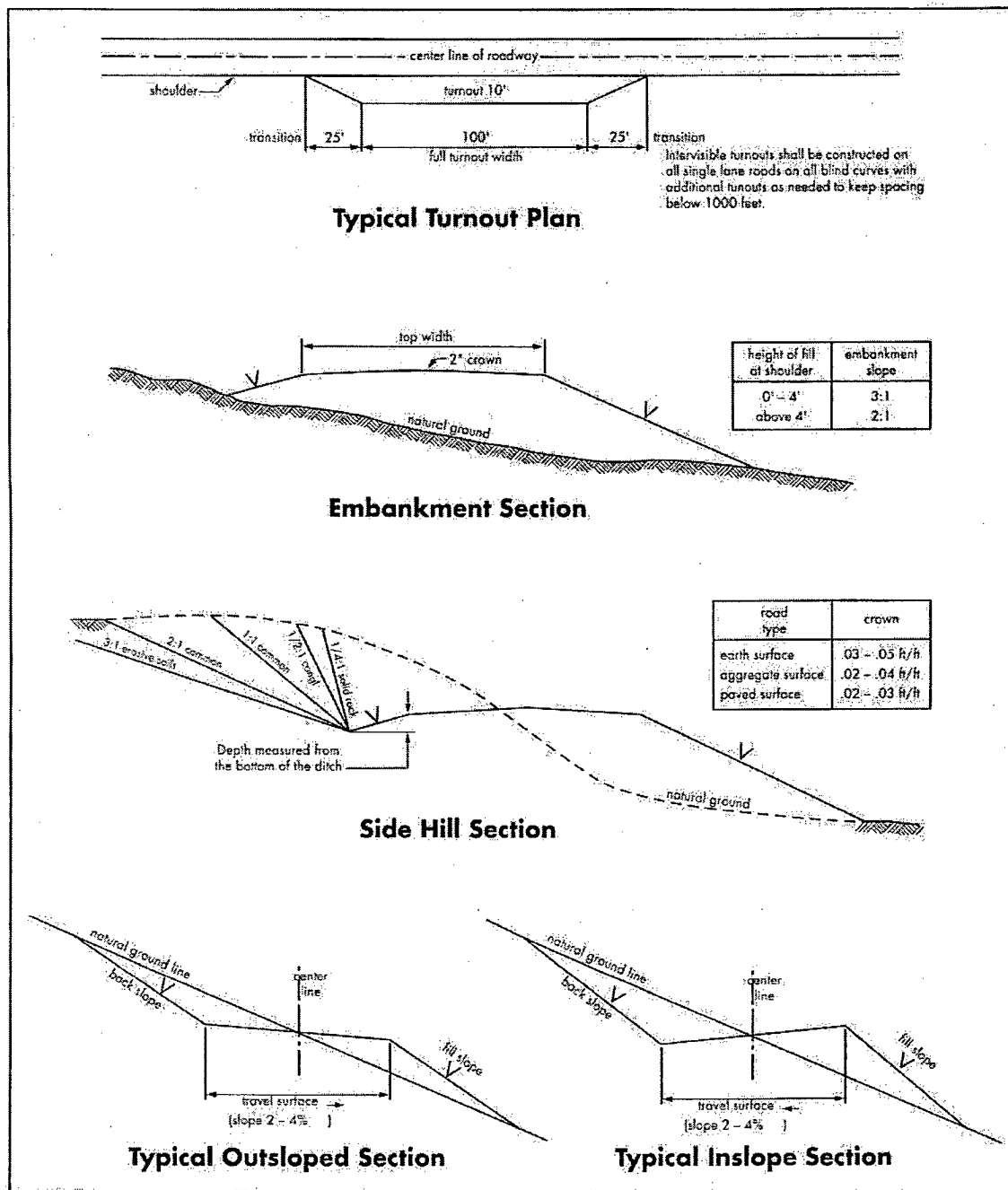

VII. DRILLING

A. DRILLING OPERATIONS REQUIREMENTS

The BLM is to be notified a minimum of 4 hours in advance for a representative to witness:

- a. Spudding well
- b. Setting and/or Cementing of all casing strings
- c. BOPE tests

☒ **Eddy County**

Call the Carlsbad Field Office, 620 East Greene St., Carlsbad, NM 88220,
(575) 361-2822

1. A Hydrogen Sulfide (H₂S) Drilling Plan should be activated 500 feet prior to drilling into the Grayburg formation. **As a result, the Hydrogen Sulfide area must meet Onshore Order 6 requirements, which includes equipment and personnel/public protection items. If Hydrogen Sulfide is encountered, please provide measured values and formations to the BLM.**
2. Unless the production casing has been run and cemented or the well has been properly plugged, the drilling rig shall not be removed from over the hole without prior approval. **If the drilling rig is removed without approval – an Incident of Non-Compliance will be written and will be a “Major” violation.**
3. Floor controls are required for 3M or Greater systems. These controls will be on the rig floor, unobstructed, readily accessible to the driller and will be operational at all times during drilling and/or completion activities. Rig floor is defined as the area immediately around the rotary table; the area immediately above the substructure on which the draw works are located, this does not include the dog house or stairway area.
4. **The record of the drilling rate along with the GR/N well log run from TD to surface (horizontal well – vertical portion of hole) will be submitted to the BLM office as well as all other logs run on the borehole 30 days from completion. If available, a digital copy of the logs is to be submitted in addition to the paper copies. The Rustler top and top and bottom of Salt are to be recorded on the Completion Report.**

B. CASING

Changes to the approved APD casing and cement program require submitting a sundry and receiving approval prior to work. Failure to obtain approval prior to work will result in an Incident of Non-Compliance being issued.

Centralizers required on surface casing per Onshore Order 2.III.B.1.f.

Wait on cement (WOC) time prior to drilling out for a primary cement job will be a minimum 18 hours for a water basin, 24 hours in the potash area, or 500 pounds compressive strength, whichever is greater for all casing strings. DURING THIS WOC TIME, NO DRILL PIPE, ETC. SHALL BE RUN IN THE HOLE. Provide compressive strengths including hours to reach required 500 pounds compressive strength prior to cementing each casing string. See individual casing strings for details regarding lead cement slurry requirements.

No pea gravel permitted for remedial or fall back remedial without prior authorization from the BLM engineer.

Secretary's Potash area.

Capitan Water Basin.

Possible water/brine flows in the Artesia and Salado Group.

Possible lost circulation in the Artesia Group.

1. The 9-5/8 inch surface casing shall be set at approximately **325 feet** (a minimum of 25 feet into the Rustler Anhydrite and above the salt) and cemented to the surface.
 - a. If cement does not circulate to the surface, the appropriate BLM office shall be notified and a temperature survey utilizing an electronic type temperature survey with surface log readout will be used or a cement bond log shall be run to verify the top of the cement. Temperature survey will be run a minimum of six hours after pumping cement and ideally between 8-10 hours after completing the cement job.
 - b. **Wait on cement (WOC) time for a primary cement job is to include the lead cement slurry.**
 - c. Wait on cement (WOC) time for a remedial job will be a minimum of 4 hours after bringing cement to surface or 500 pounds compressive strength, whichever is greater.
 - d. If cement falls back, remedial cementing will be done prior to drilling out that string.
2. The minimum required fill of cement behind the 7 inch production casing is:
 - ☒ Cement to surface. If cement does not circulate see B.1.a, c-d above. **Wait on cement (WOC) time for a primary cement job is to include the lead cement slurry due to Secretary's potash area.**

3. The minimum required fill of cement behind the 4-1/2 inch production liner is:

☒ Cement is not required; operator is using the Packer-Plus completion system.
Production Liner to tie back 100 feet into 7 inch production casing.

4. If hardband drill pipe is rotated inside casing, returns will be monitored for metal. If metal is found in samples, drill pipe will be pulled and rubber protectors which have a larger diameter than the tool joints of the drill pipe will be installed prior to continuing drilling operations.

C. PRESSURE CONTROL

1. All blowout preventer (BOP) and related equipment (BOPE) shall comply with well control requirements as described in Onshore Oil and Gas Order No. 2 and API RP 53 Sec. 17.
2. Minimum working pressure of the blowout preventer (BOP) and related equipment (BOPE) required for drilling below the surface casing shoe shall be **3000 (3M) psi**.
 - a. **For surface casing only:** If the BOP/BOPE is to be tested against casing, the wait on cement (WOC) time for that casing is to be met (see WOC statement at start of casing section). Independent service company required.
3. The appropriate BLM office shall be notified a minimum of 4 hours in advance for a representative to witness the tests.
 - a. In potash areas, for all casing strings utilizing slips, these are to be set as soon as the crew and rig are ready and any fallback cement remediation has been done. For all casing strings, casing cut-off and BOP installation can be initiated at twelve hours after bumping the plug. However, **no tests** shall commence until the cement has had a minimum of 24 hours setup time.
 - b. The tests shall be done by an independent service company utilizing a test plug **not a cup or J-packer**. The operator also has the option of utilizing an independent tester to test without a plug (i.e. against the casing) pursuant to Onshore Order 2 with the pressure not to exceed 70% of the burst rating for the casing. Any test against the casing must meet the WOC time for water basin (18 hours) or potash (24 hours) prior to initiating the test.
 - c. The results of the test shall be reported to the appropriate BLM office.
 - d. All tests are required to be recorded on a calibrated test chart. **A copy of the BOP/BOPE test chart and a copy of independent service company test will be submitted to the appropriate BLM office.**

- e. The BOP/BOPE test shall include a low pressure test from 250 to 300 psi. The test will be held for a minimum of 10 minutes if test is done with a test plug and 30 minutes without a test plug.

D. DRILL STEM TEST

If drill stem tests are performed, Onshore Order 2.III.D shall be followed.

E. WASTE MATERIAL AND FLUIDS

All waste (i.e. drilling fluids, trash, salts, chemicals, sewage, gray water, etc.) created as a result of drilling operations and completion operations shall be safely contained and disposed of properly at a waste disposal facility. No waste material or fluid shall be disposed of on the well location or surrounding area.

EGF 090310

VIII. PRODUCTION (POST DRILLING)

A. WELL STRUCTURES & FACILITIES

Placement of Production Facilities

Production facilities should be placed on the well pad to allow for maximum interim recontouring and revegetation of the well location.

Containment Structures

The containment structure shall be constructed to hold the capacity of the entire contents of the largest tank, plus 24 hour production, unless more stringent protective requirements are deemed necessary by the Authorized Officer.

Painting Requirement

All above-ground structures including meter housing that are not subject to safety requirements shall be painted a flat non-reflective paint color
Shale Green, Munsell Soil Color Chart # 5Y 4/2

IX. INTERIM RECLAMATION

During the life of the development, all disturbed areas not needed for active support of production operations should undergo interim reclamation in order to minimize the environmental impacts of development on other resources and uses.

Within six (6) months of well completion, operators should work with BLM surface management specialists (Jim Amos: 575-234-5909) to devise the best strategies to reduce the size of the location. Interim reclamation should allow for remedial well operations, as well as safe and efficient removal of oil and gas.

During reclamation, the removal of caliche is important to increasing the success of revegetating the site. Removed caliche that is free of contaminants may be used for road repairs, fire walls or for building other roads and locations. In order to operate the well or complete workover operations, it may be necessary to drive, park and operate on restored interim vegetation within the previously disturbed area. Disturbing revegetated areas for production or workover operations will be allowed. If there is significant disturbance and loss of vegetation, the area will need to be revegetated. Communicate with the appropriate BLM office for any exceptions/exemptions if needed.

All disturbed areas after they have been satisfactorily prepared need to be reseeded with the seed mixture provided below.

Upon completion of interim reclamation, the operator shall submit a Sundry Notices and Reports on Wells, Subsequent Report of Reclamation (Form 3160-5).

X. FINAL ABANDONMENT & RECLAMATION

At final abandonment, well locations, production facilities, and access roads must undergo "final" reclamation so that the character and productivity of the land are restored.

Earthwork for final reclamation must be completed within six (6) months of well plugging. All pads, pits, facility locations and roads must be reclaimed to a satisfactory revegetated, safe, and stable condition, unless an agreement is made with the landowner or BLM to keep the road and/or pad intact.

After all disturbed areas have been satisfactorily prepared, these areas need to be revegetated with the seed mixture provided below. Seeding should be accomplished by drilling on the contour whenever practical or by other approved methods. Seeding may need to be repeated until revegetation is successful, as determined by the BLM.

Operators shall contact a BLM surface protection specialist prior to surface abandonment operations for site specific objectives (Jim Amos: 575-234-5909).

Ground-level Abandoned Well Marker to avoid raptor perching: Upon the plugging and subsequent abandonment of the well, the well marker will be installed at ground level on a plate containing the pertinent information for the plugged well.

Seed Mixture for LPC Sand/Shinnery Sites

The holder shall seed all disturbed areas with the seed mixture listed below. The seed mixture shall be planted in the amounts specified in pounds of pure live seed (PLS)* per acre. There shall be no primary or secondary noxious weeds in the seed mixture. Seed will be tested and the viability testing of seed will be done in accordance with State law(s) and within nine (9) months prior to purchase. Commercial seed will be either certified or registered seed. The seed container will be tagged in accordance with State law(s) and available for inspection by the authorized officer.

Seed will be planted using a drill equipped with a depth regulator to ensure proper depth of planting where drilling is possible. The seed mixture will be evenly and uniformly planted over the disturbed area (smaller/heavier seeds have a tendency to drop the bottom of the drill and are planted first). The holder shall take appropriate measures to ensure this does not occur. Where drilling is not possible, seed will be broadcast and the area shall be raked or chained to cover the seed. When broadcasting the seed, the pounds per acre are to be doubled. The seeding will be repeated until a satisfactory stand is established as determined by the authorized officer. Evaluation of growth will not be made before completion of at least one full growing season after seeding.

Species to be planted in pounds of pure live seed* per acre:

<u>Species</u>	<u>lb/acre</u>
Plains Bristlegrass	5lbs/A
Sand Bluestem	5lbs/A
Little Bluestem	3lbs/A
Big Bluestem	6lbs/A
Plains Coreopsis	2lbs/A
Sand Dropseed	1lbs/A

**Four-winged Saltbush 5lbs/A

* This can be used around well pads and other areas where caliche cannot be removed.

*Pounds of pure live seed:

Pounds of seed x percent purity x percent germination = pounds pure live seed