

30-015-38375

COG Operating LLC

Hydrogen Sulfide Drilling Operation Plan

I. HYDROGEN SULFIDE TRAINING

All personnel, whether regularly assigned, contracted, or employed on an unscheduled basis, will receive training from a qualified instructor in the following areas prior to commencing drilling operations on this well:

1. The hazards and characteristics of hydrogen sulfide (H₂S)
2. The proper use and maintenance of personal protective equipment and life support systems.
3. The proper use of H₂S detectors, alarms, warning systems, briefing areas, evacuation procedures, and prevailing winds.
4. The proper techniques for first aid and rescue procedures.

In addition, supervisory personnel will be trained in the following areas:

1. The effects of H₂S on metal components. If high tensile tubular are to be used, personnel will be trained in their special maintenance requirements.
2. Corrective action and shut-in procedures when drilling or reworking a well and blowout prevention and well control procedures.
3. The contents and requirements of the H₂S Drilling Operations Plan and Public Protection Plan.

There will be an initial training session just prior to encountering a known or probable H₂S zone (within 3 days or 500 feet) and weekly H₂S and well control drills for all personnel in each crew. The initial training session shall include a review of the site specific H₂S Drilling Operations Plan and the Public Protection Plan. **The concentrations of H₂S of wells in this area from surface to TD are low enough that a contingency plan is not required.**

II. H2S SAFETY EQUIPMENT AND SYSTEMS

Note: All H2S safety equipment and systems will be installed, tested, and operational when drilling reaches a depth of 500 feet above, or three days prior to penetrating the first zone containing or reasonable expected to contain H2S.

1. Well Control Equipment:

- A. Flare line.
- B. Choke manifold.
- C. Blind rams and pipe rams to accommodate all pipe sizes with properly sized closing unit.
- D. Auxiliary equipment may include if applicable: annular preventer & rotating head.

2. Protective equipment for essential personnel:

- A. Mark II Survive air 30-minute units located in the doghouse and at briefing areas, as indicated on well site diagram.

3. H2S detection and monitoring equipment:

- A. 1 portable H2S monitors positioned on location for best coverage and response. These units have warning lights and audible sirens when H2S levels of 20 PPM are reached.

4. Visual warning systems:

- A. Wind direction indicators as shown on well site diagram (Exhibit #8).
- B. Caution/Danger signs (Exhibit #7) shall be posted on roads providing direct access to location. Signs will be painted a high visibility yellow with black lettering of sufficient size to be readable at a reasonable distance from the immediate location. Bilingual signs will be used, when appropriate. See example attached.

5. Mud program:

- A. The mud program has been designed to minimize the volume of H2S circulated to surface. Proper mud weight, safe drilling practices, and the use of H2S scavengers will minimize hazards when penetrating H2S bearing zones.

6. Metallurgy:

- A. All drill strings, casings, tubing, wellhead, blowout preventer, drilling spool, kill lines, choke manifold and lines, and valves shall be suitable for H₂S service.
- B. All elastomers used for packing and seals shall be H₂S trim.

7. Communication:

- A. Radio communications in company vehicles including cellular telephone and 2-way radio.
- B. Land line (telephone) communication at Office.

8. Well testing:

- A. Drill stem testing will be performed with a minimum number of personnel in the immediate vicinity, which are necessary to safely and adequately conduct the test. The drill stem testing will be conducted during daylight hours and formation fluids will not be flowed to the surface. All drill-stem-testing operations conducted in an H₂S environment will use the closed chamber method of testing.
- B. There will be no drill stem testing.

EXHIBIT #7

WARNING
YOU ARE ENTERING AN H₂S
AUTHORIZED PERSONNEL ONLY

- 1. BEARDS OR CONTACT LENSES NOT ALLOWED
- 2. HARD HATS REQUIRED
- 3. SMOKING IN DESIGNATED AREAS ONLY
- 4. BE WIND CONSCIOUS AT ALL TIMES
- 5. CHECK WITH COG OPERATING FOREMAN AT

COG OPERATING LLC
1-432-683-7443
1-575-746-2010

EDDY COUNTY EMERGENCY NUMBERS

ARTESIA FIRE DEPT. 575-746-5050
ARTESIA POLICE DEPT. 575-746-5000
EDDY CO. SHERIFF DEPT. 575-746-9888

LEA COUNTY EMERGENCY NUMBERS

HOBBS FIRE DEPT. 575-397-9308
HOBBS POLICE DEPT. 575-397-9285
LEA CO. SHERIFF DEPT. 575-396-1196

DRILLING LOCATION H₂S SAFETY EQUIPMENT Exhibit # 8

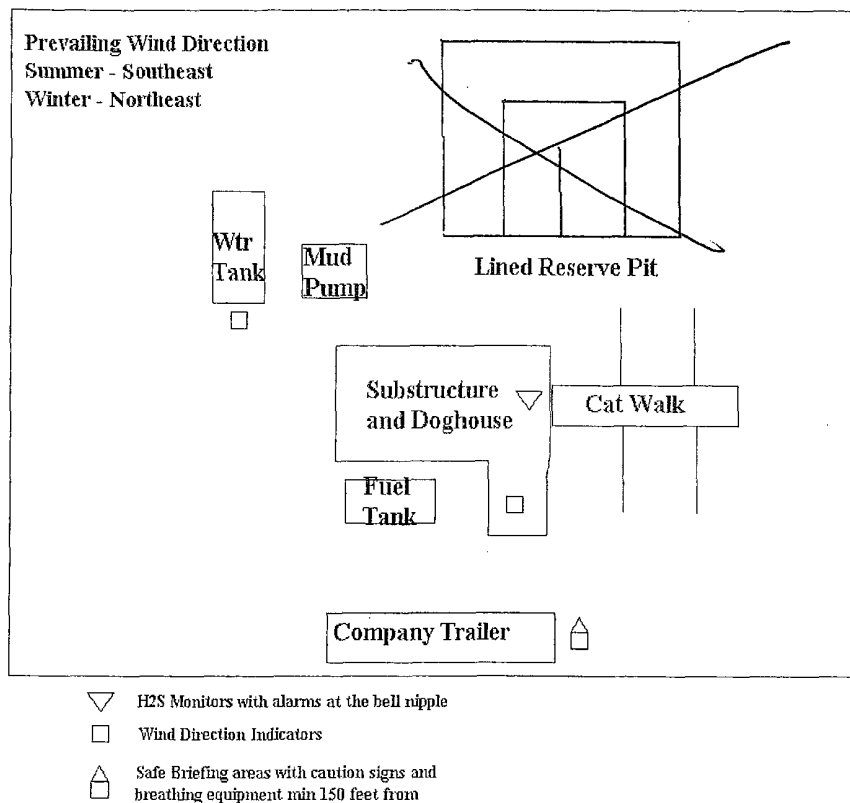

COG Operating LLC

EXHIBIT 8

Drilling Location - H2S Safety Equipment Diagram

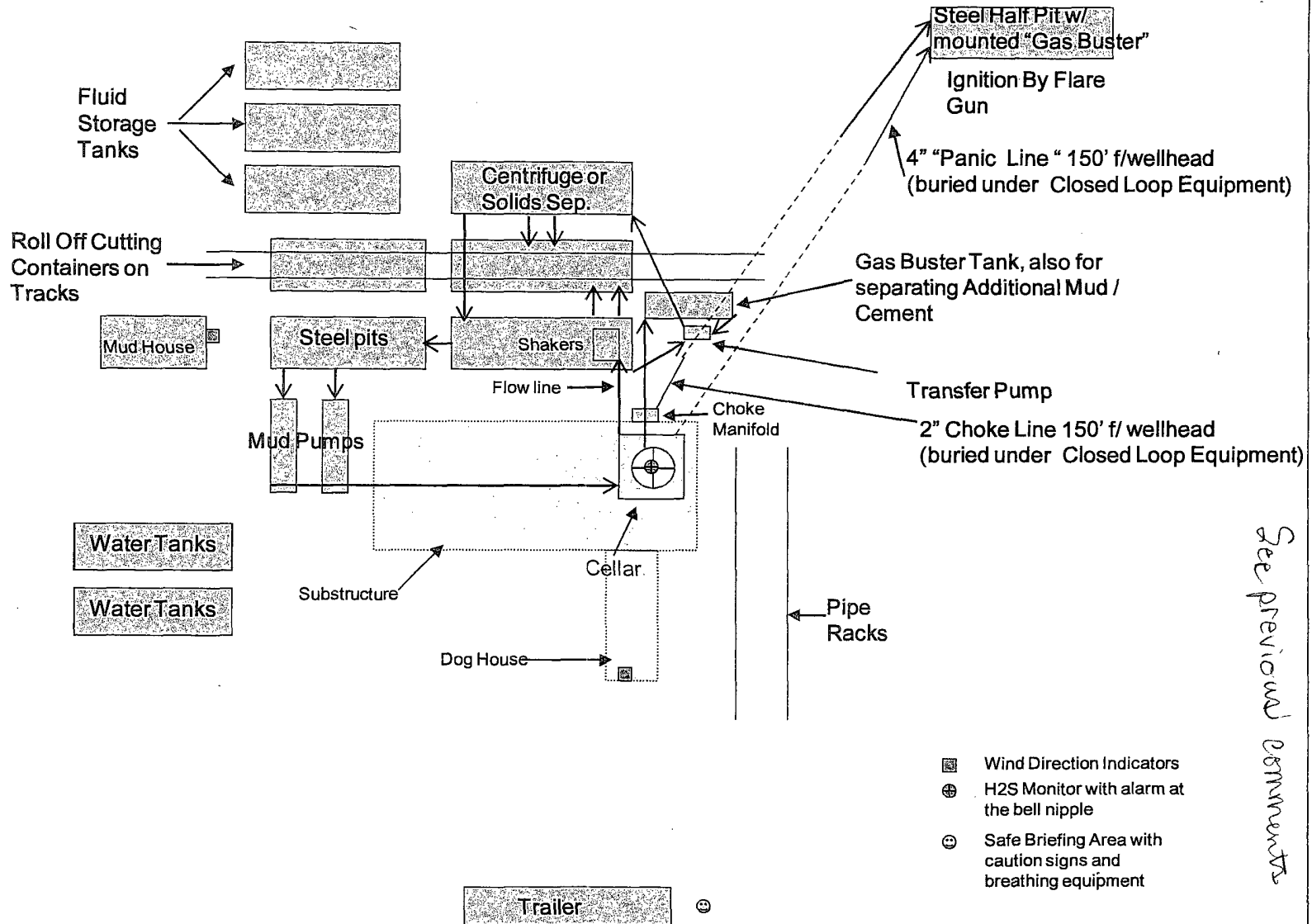

SURFACE USE AND OPERATING PLAN

1. Existing & Proposed Access Roads

- A. The well site survey and elevation plat for the proposed well is shown in Exhibit #1. It was staked by John West Engineering, Hobbs, NM.
- B. All roads to the location are shown in the topographic map Exhibit #2. The existing lease roads are illustrated and are adequate for travel during drilling and production operations. Upgrading existing roads prior to drilling the well will be done where necessary.
- C. Directions to location: From the intersection US Highway 82 and Co. Rd. 224 (Ripple Road), Go Southwest on US Highway 82 apprx 1.2 miles. Turn Right and go Northwest apprx 0.3 mile. Turn Right & Go North apprx 0.3 mile. Veer Right & Go Northeast apprx 0.5 mile. Veer Left & Go North apprx 1.6 miles. The location stake is apprx 450 feet West of Lease Road. See Vicinity Map, Exhibit #3
- D. Routine grading and maintenance of existing roads will be conducted as necessary to maintain their condition as long as any operations continue on this lease. Roads will be maintained according to specifications in section 2A of this Surface Use and Operating Plan.

2. Proposed Access Road:

Exhibit #4 shows that 237' of new access road will be required for this location. If any road is required it will be constructed as follows:

- A. The maximum width of the running surface will be 14'. The road will be crowned, ditched and constructed of 6" rolled and compacted caliche. Ditches will be at 3:1 slope and 4 feet wide. Water will be diverted where necessary to avoid ponding, prevent erosion, maintain good drainage, and to be consistent with local drainage patterns.
- B. The average grade will be less than 1%.
- C. No turnouts are planned.
- D. No culverts, cattleguard, gates, low water crossings or fence cuts are necessary.
- E. Surfacing material will consist of native caliche. Caliche will be obtained from the actual well site if available. If not available onsite, caliche will be hauled from the nearest BLM caliche pit.

3. Location of Existing Well:

Exhibit #5 shows all existing wells within a one-mile radius of this well.

As shown on this plat there are numerous wells producing from the San Andres and Yeso formations.

4. Location of Existing and/or Proposed Facilities:

- A. COG Operating LLC does operate a production facility on this lease.
- B. If the well is productive, contemplated facilities will be as follows:
 - 1) Production will be sent to the Tex Mack 11 Federal Tank Battery located at the Tex Mack 11 Federal #3 well location @ 330 FNL & 330 FWL, Section 11, T17S, R31E, UL D. The facility location is shown in Exhibit #5.
 - 2) The tank battery and facilities including all flow lines and piping will be installed according to API specifications.
 - 3) Any additional caliche will be obtained from the actual well site. If caliche does not exist or is not plentiful from the well site, the caliche will be hauled from a BLM approved caliche pit. Any additional construction materials will be purchased from contractors.
 - 4) Proposed flow lines, will follow an archaeologically approved route to the Tex Mack 11 Federal Tank Battery located at the Tex Mack 11 Federal #3 well location @ 330 FNL & 330 FWL, Section 11, T17S, R31E, UL D. The flowline will be SDR 7 3" poly line laid on the surface and will be approximately 2370' in length with max pressure 100 psi. Flowlines will be no more than 11' from the paralleling road. The facility location is shown in Exhibit #5.
 - 5) It will be necessary to run electric power if this well is productive. Power will be provided by CVE and they will submit a separate plan and ROW for service to the well location.
 - 6) If the well is productive, rehabilitation plans will include the following:
 - a) The original topsoil from the well site will be returned to the location, and the site will be re-contoured as close as possible to the original site.

5. Location and Type of Water Supply:

The well will be drilled with combination brine and fresh water mud system as outlined in the drilling program. The water will be obtained from commercial water stations in the area and hauled to location by transport truck over the existing and proposed access roads shown in Exhibit #2. If a commercial fresh water source is nearby, fast line may be laid along existing road ROW's and fresh water pumped to the well. No water well will be drilled on the location.

6. Source of Construction Materials and Location "Turn-Over" Procedure:

Obtaining caliche: The primary way of obtaining caliche to build locations and roads will be by "turning over" the location. This means, caliche will be obtained from the actual well sight. A caliche permit will be obtained from BLM prior to pushing up any caliche. 2400 cu. Yards is max amount of caliche needed for pad and roads. Amount will vary for each pad. The procedure below has been approved by BLM personnel:

- A. The top 6 inches of topsoil is pushed off and stockpiled along the side of the location.
- B. An approximate 120' X 120' area is used within the proposed well site to remove caliche.
- C. Subsoil is removed and piled along side the 120' by 120' area within the pad site.
- D. When caliche is found, material will be stock piled within the pad site to build the location and road.
- E. Then subsoil is pushed back in the hole and caliche is spread accordingly across entire location and road.
- F. Once well is drilled, the stock piled top soil will be used for interim reclamation and spread along areas where caliche is picked up and the location size is reduced. Neither caliche or subsoil will be stock piled outside of the well pad. Topsoil will be stockpiled along the edge of the pad as depicted in attached plat.

In the event that no caliche is found onsite, caliche will be hauled in from a BLM approved caliche pit.

7. Methods of Handling Water Disposal:

- A. The well will be drilled utilizing a closed loop mud system. Drill cuttings will be held in roll-off style mud boxes and taken to an NMOCD approved disposal site.
- B. Drilling fluids will be contained in steel mud pits.

- C. Water produced from the well during completion will be held temporarily in steel tanks and then taken to an NMOC approved commercial disposal facility.
- D. Garbage and trash produced during drilling or completion operations will be collected in a trash bin and hauled to an approved landfill. No toxic waste or hazardous chemicals will be produced by this operation.
- E. After the rig is moved out and the well is either completed or abandoned, all waste materials will be cleaned up within 30 days. In the event of a dry hole only a dry hole marker will remain.

8. Ancillary Facilities:

No airstrip, campsite or other facilities will be built as a result of the operation on this well.

9. Well Site Layout:

- A. The drill pad layout, with elevations staked by John West Engineering, is shown in Exhibit #4. Dimensions of the pad and pits are shown on Exhibit #6. V door direction is West. Topsoil, if available, will be stockpiled per BLM specifications. Because the pad is almost level no major cuts will be required.
- B. Exhibit #6 also shows the proposed orientation of closed loop system and access road. No permanent living facilities are planned, but a temporary foreman/toolpusher's trailer will be on location during the drilling operations.

10. Plans for Restoration of the Surface:

- A. Interim Reclamation will take place after the well has been completed. The pad will be downsized by reclaiming the areas not needed for production operations. The portions of the pad that are not needed for production operations will be recontoured to its original state as much as possible. The caliche that is removed will be reused to either build another pad site or for road repairs within the lease. The stockpiled topsoil will then be spread out reclaimed area and reseeded with a BLM approved seed mixture. In the event that the well must be worked over or maintained, it may be necessary to drive, park, and/or operate machinery on reclaimed land. This area will be repaired or reclaimed after work is complete.

- B. Final Reclamation: Upon plugging and abandoning the well, All caliche for well pad and lease road will be removed and surface will be recountoured to reflect its surroundings as much as possible. Caliche will be recycled for road repair or reused for another well pad within the lease. If any topsoil remains, it will be spread out and the area will be re-seeded with a BLM approved mixture and revegetated as per BLM orders.

11. Surface Ownership:

- A. The surface is owned by the U.S. Government and is administered by the Bureau of Land Management. The surface is multiple uses with the primary uses of the region for grazing of livestock and the production of oil and gas.
- B. The surface tenant for this site is Olane Caswell, 1702 Gillham, Brownfield, TX 79316.
- C. The proposed road routes and surface location will be restored as directed by the BLM

12. Other Information:

- A. The area around the well site is grassland and the topsoil is sandy. The vegetation is moderately sparse with native prairie grasses, some mesquite and shinnery oak. No wildlife was observed but it is likely that mule deer, rabbits, coyotes and rodents traverse the area.
- B. There is no permanent or live water in the immediate area.
- C. There are no dwellings within 2 miles of this location.
- D. If needed, a Cultural Resources Examination is being prepared by Southern New Mexico Archaeological Services, Inc. P.O. Box 1, Bent New Mexico, 88314, phone # 505-671-4797 and the results will be forwarded to your office in the near future. Otherwise, **COG will be participating in the Permian Basin MOA Program.**

*Surface Use Plan
COG Operating, LLC
Tex Mack 11 Federal 15
330' FNL & 1650' FWL
Section 11, T-17-S, R-31-E, UL C
Eddy County, New Mexico*

13. Bond Coverage:

Bond Coverage is Nationwide Bond # 000215

14. Lessee's and Operator's Representative:

The COG Operating LLC representative responsible for assuring compliance with the surface use plan is as follows:

John Coffman,	Erick Nelson.
Drilling Superintendent	Division Operations Manager
COG Operating LLC	COG Operating LLC
550 W. Texas, Suite 1300	550 W. Texas, Suite 1300
Midland, TX 79701	Midland, TX 79701
Phone (432) 683-7443 (office)	Phone (505) 746-2210 (office)
(432) 631-9762 (cell)	(432) 238-7591 (cell)

Surface Use Plan
COG Operating, LLC
Tex Mack 11 Federal 15
330' FNL & 1650' FWL
Section 11, T-17-S, R-31-E, UL C
Eddy County, New Mexico

I hereby certify that I, or persons under my direct supervision, have inspected the drill site and access road proposed herein; that I am familiar with the conditions that presently exist; that I have full knowledge of State and Federal laws applicable to this operation; that the statements made in this APD package are, to the best of my knowledge, true and correct; and that the work associated with the operations proposed herein will be performed in conformity with this APD package and the terms and conditions under which it is approved. I also certify that I, or COG Operating, LLC, am responsible for the operations conducted under this application. These statements are subject to the provisions of 18 U.S.C. 1001 for the filing of false statements. Executed this 19th day of August, 2010.

Signed: Carl Bird

Printed Name: Carl Bird

Position: Drilling Engineer

Address: 550 W. Texas, Suite 1300, Midland, Texas 79701

Telephone: (432) 683-7443

Field Representative (if not above signatory): Same

E-mail: cbird@conchoresources.com

SECTION 11, TOWNSHIP 17 SOUTH, RANGE 31 EAST, N.M.P.M.,
 EDDY COUNTY, NEW MEXICO

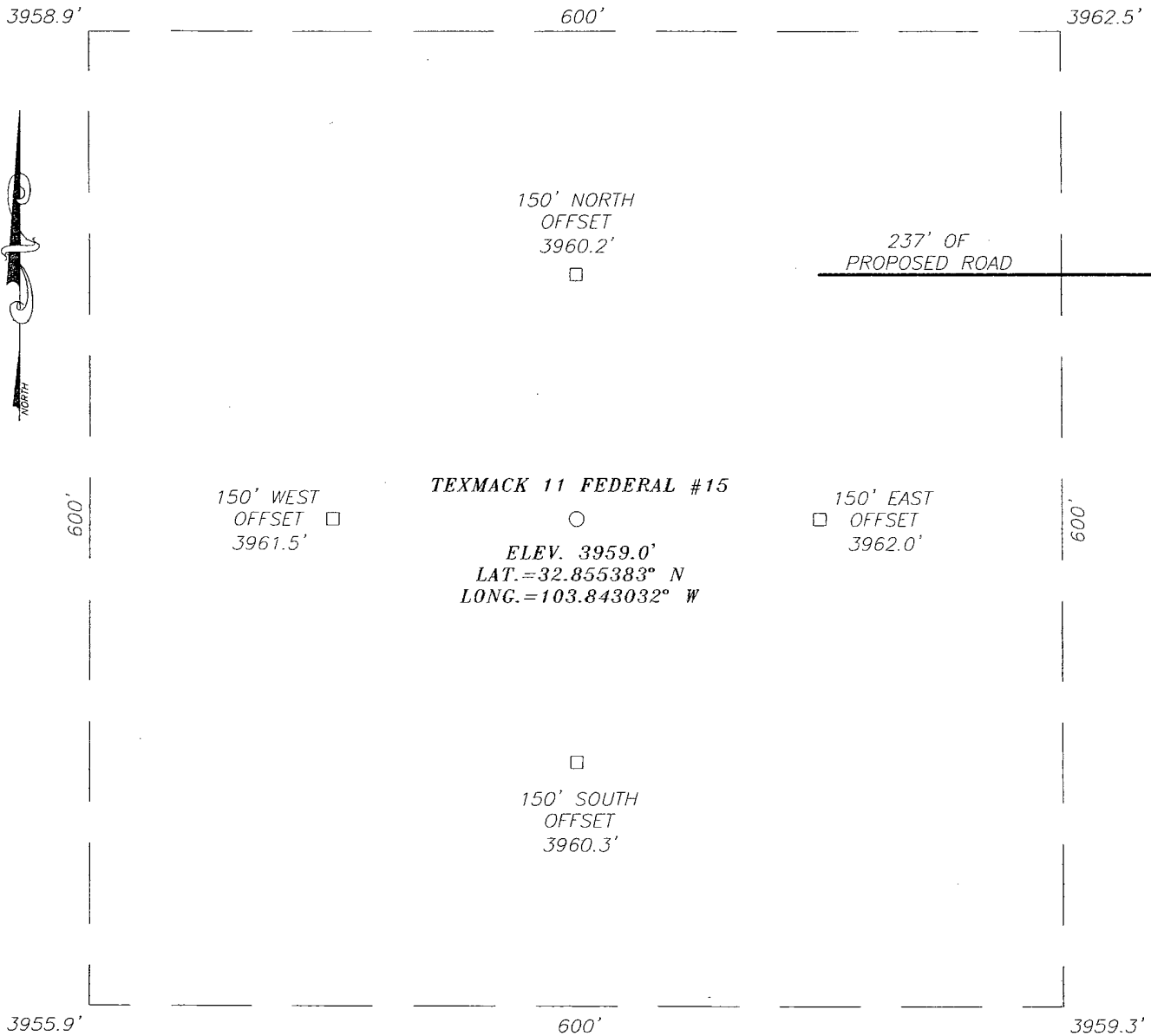

DIRECTIONS TO LOCATION

FROM THE INTERSECTION OF U.S. HWY. #82 AND CO. RD. #224 (RIPPLE RD) GO SOUTHWEST ON U.S. HWY. #82. APPROX. 1.2 MILES. TURN RIGHT AND GO NORTHWEST APPROX. 0.3 MILES. TURN RIGHT AND GO NORTH APPROX. 0.3 MILES. VEER RIGHT AND GO NORTHEAST APPROX. 0.5 MILES. VEER LEFT AND GO NORTH APPROX. 1.6 MILES. THE LOCATION STAKE IS APPROX. 450 FEET WEST OF LEASE ROAD.

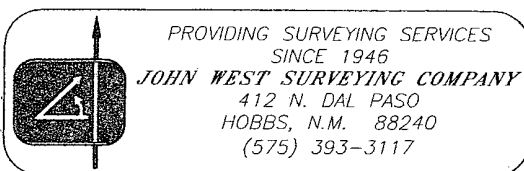
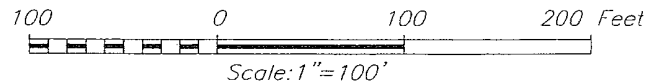

COG OPERATING, LLC

TEXMACK 11 FEDERAL #15 WELL
 LOCATED 330 FEET FROM THE NORTH LINE
 AND 1650 FEET FROM THE WEST LINE OF SECTION 11,
 TOWNSHIP 17 SOUTH, RANGE 31 EAST, N.M.P.M.,
 EDDY COUNTY, NEW MEXICO.

Survey Date: 8/10/10	Sheet 1 of 1 Sheets
W.O. Number: 10.11.1020	Dr By: LA
Date: 8/18/10	10111020
	Scale: 1"=100'

VICINITY MAP

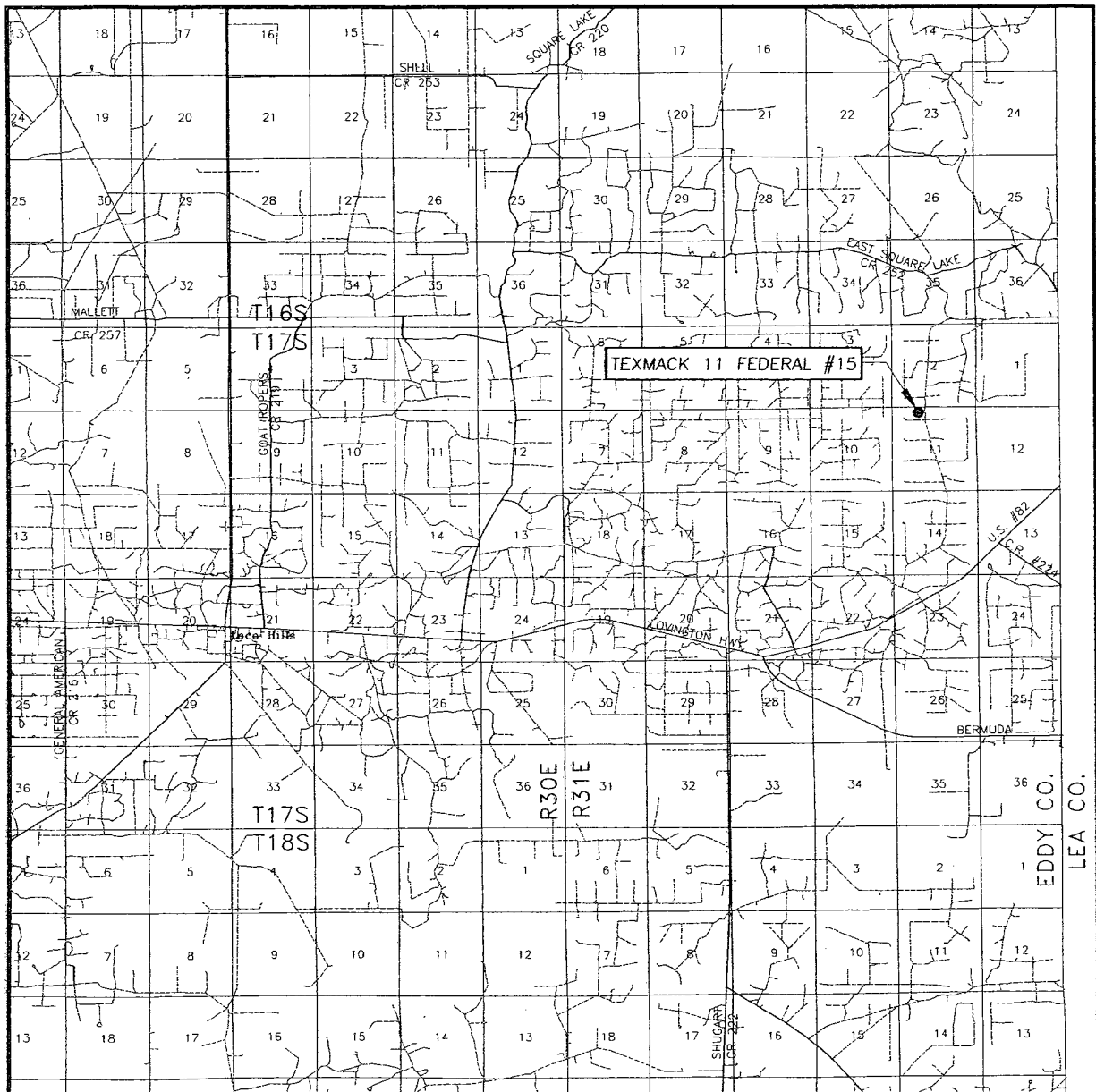

SCALE: 1" = 2 MILES

SEC. 11 TWP. 17-S RGE. 31-E

SURVEY N.M.P.M.

COUNTY EDDY STATE NEW MEXICO

DESCRIPTION 330' FNL & 1650' FWL

ELEVATION 3959'

OPERATOR COG OPERATING, LLC

LEASE TEXMACK 11 FEDERAL

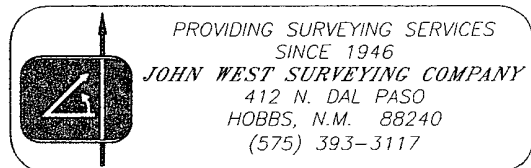

LOCATION VERIFICATION MAP

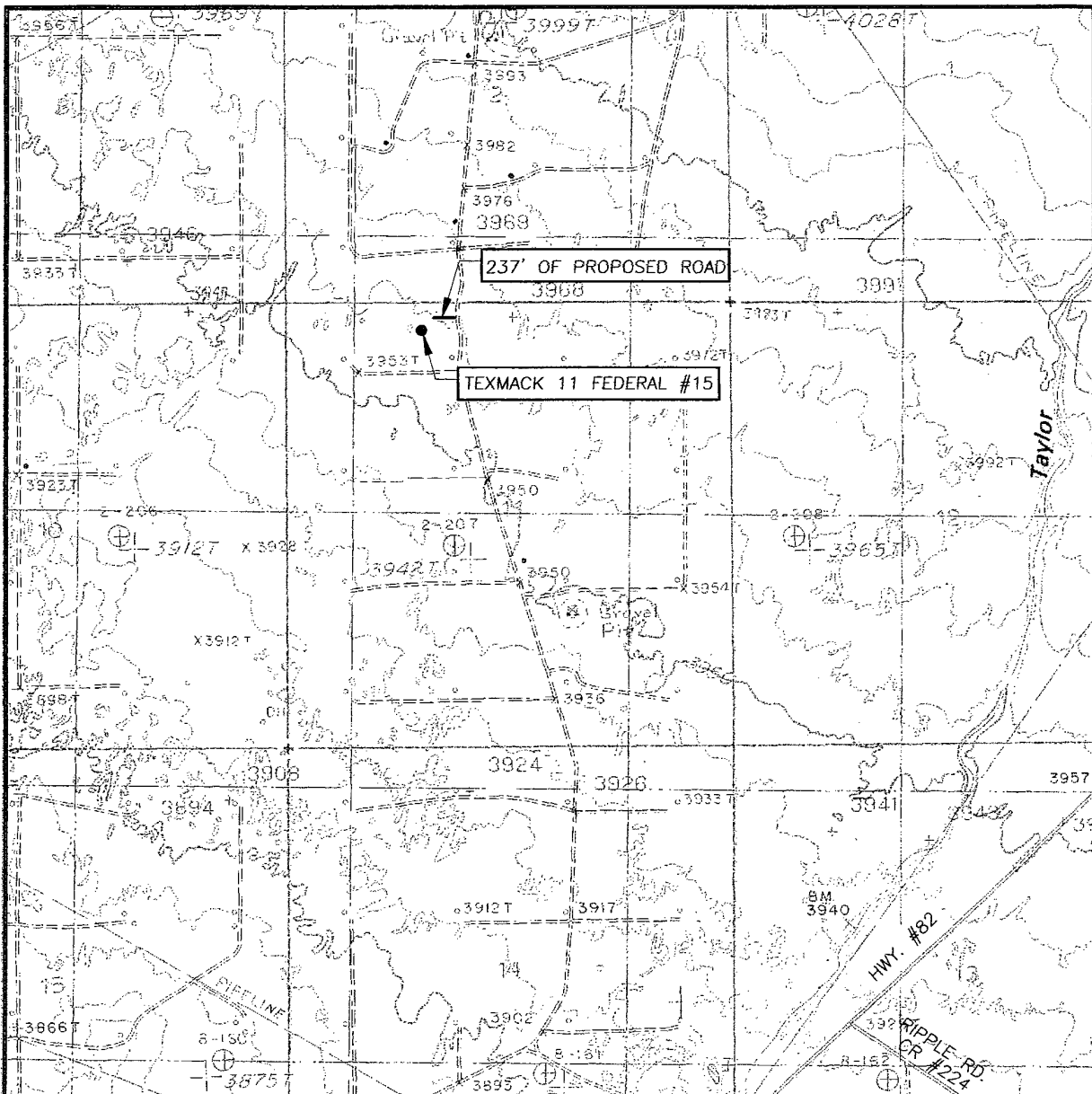

SCALE: 1" = 2000'

CONTOUR INTERVAL:
MALJAMAR, N.M. - 10'

SEC. 11 TWP. 17-S RGE. 31-E

SURVEY N.M.P.M.

COUNTY EDDY STATE NEW MEXICO

DESCRIPTION 330' FNL & 1650' FWL

ELEVATION 3959'

OPERATOR COG OPERATING, LLC

LEASE TEXMACK 11 FEDERAL

U.S.G.S. TOPOGRAPHIC MAP
MALJAMAR, N.M.

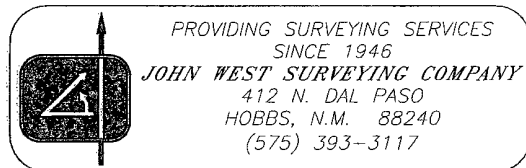

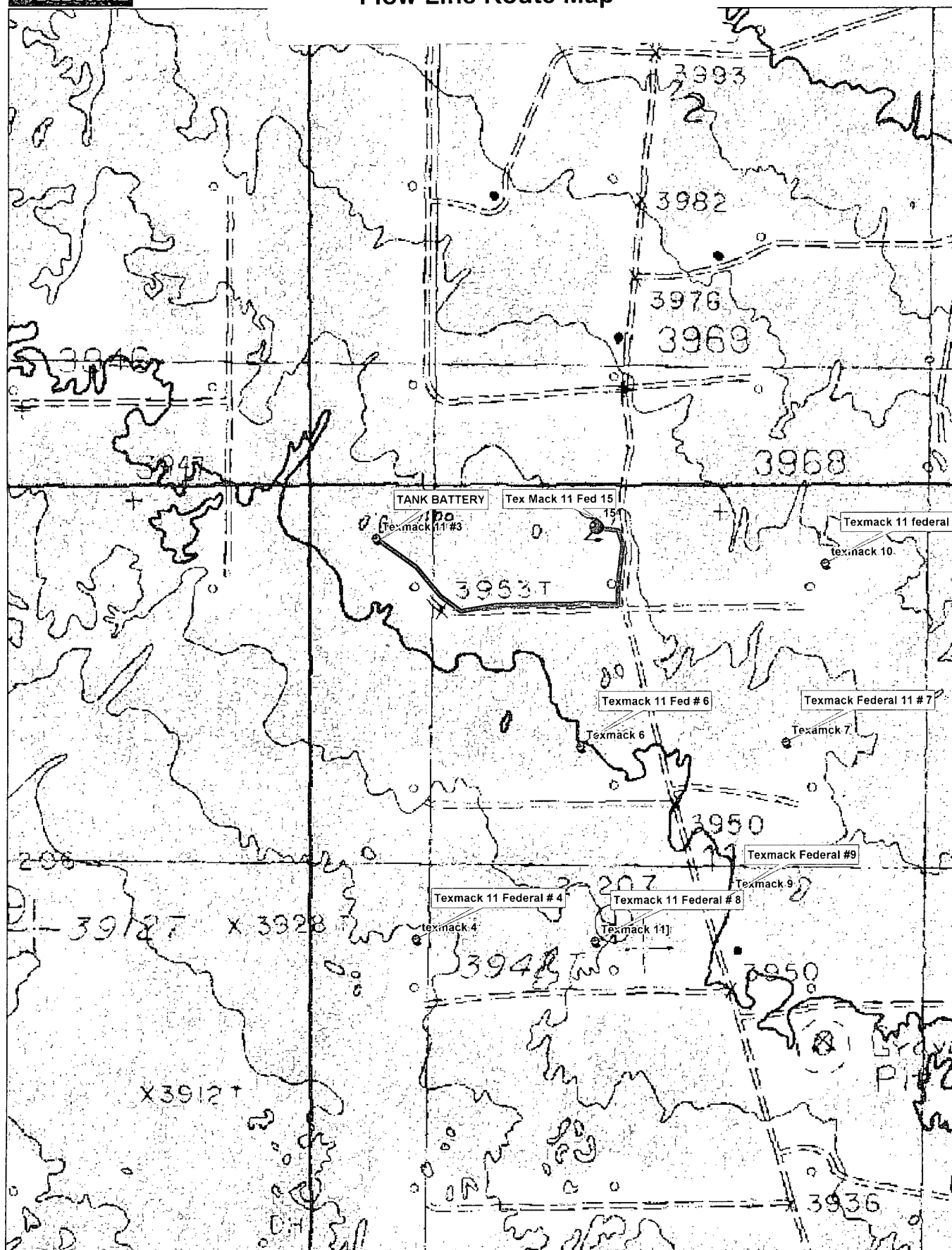

Data use subject to license.

© DeLorme. XMap® 7.

www.delorme.com

Scale 1 : 10,400

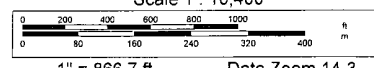
$$1'' = 866.7 \text{ ft}$$

Data Zoom 14-3

Wells in 1 Mile Radius to Tex Mack 11 Federal 15

API#	Operator	County	Legal	Lease	Well#	Date Issued	Permitted Depth	Permit TVD	Images	Doc	Total Depth	Well Type	Well Status	Target Formation
30-015-37822	COG OPERATING LLC	EDDY	S:11, T:17S, R:31E	TEX MACK 11 FEDERAL	27	5/13/2010	7,000		Yes	link	7,000	PO	Active Permit	
30-015-37823	COG OPERATING LLC	EDDY	S:11, T:17S, R:31E	TEX MACK 11 FEDERAL	39	5/13/2010	7,000		Yes	link	7,000	PO	Active Permit	
30-015-37667	COG OPERATING LLC	EDDY	S:11, T:17S, R:31E	TEX-MACK 11 FEDERAL	35	2/24/2010	7,000		Yes	link	7,000	PO	Active Permit	
30-015-37419	COG OPERATING LLC	EDDY	S:2, T:17S, R:31E	TEX-MACK	239	12/15/2009	7,000		Yes	link	7,000	PO	Active Permit	YESO FORMATION
30-015-37420	COG OPERATING LLC	EDDY	S:2, T:17S, R:31E	TEX-MACK	240	12/15/2009	7,000		Yes	link	7,000	PO	Active Permit	YESO FORMATION
30-015-37421	COG OPERATING LLC	EDDY	S:2, T:17S, R:31E	TEX-MACK	260	12/15/2009	7,000		Yes	link	7,000	PO	Active Permit	YESO FORMATION
30-015-37444	COG OPERATING LLC	EDDY	S:11, T:17S, R:31E	TEX MACK 11 FEDERAL	11	12/11/2009	6,800		Yes	link	6,800	PO	Active Permit	
30-015-37445	COG OPERATING LLC	EDDY	S:11, T:17S, R:31E	TEX MACK 11 FEDERAL	54	12/11/2009	6,800		Yes	link	6,800	PO	Active Permit	
30-015-37346	COG OPERATING LLC	EDDY	S:2, T:17S, R:31E	TEX-MACK	221	10/20/2009	6,800		Yes	link	6,832	O	Active Permit	YESO FORMATION
30-015-37160	HUDSON OIL COMPANY OF TEXAS	EDDY	S:12, T:17S, R:31E	PUCKETT NORTH	6	7/10/2009	4,300		Yes	link	4,290	O	Active Permit	
30-015-37104	COG OPERATING LLC	EDDY	S:2, T:17S, R:31E	TEX-MACK	211H	5/28/2009	8,000		Yes	link	8,000	PO	Active Permit	YESO FORMATION
30-015-36848	COG OPERATING LLC	EDDY	S:11, T:17S, R:31E	TEX MACK 11 FEDERAL	6	12/12/2008	6,600		Yes	link	6,852	O	Active Permit	
30-015-36847	COG OPERATING LLC AGENT or COG OPERATING LLC	EDDY	S:11, T:17S, R:31E	TEX MACK 11 FEDERAL	5	12/12/2008	6,631	6,600	Yes	link	6,845	O	Active Permit	
30-015-36849	COG OPERATING LLC	EDDY	S:11, T:17S, R:31E	TEX MACK 11 FEDERAL	7	12/12/2008	6,600		Yes	link	6,600	O	Active Permit	
30-015-36850	COG OPERATING LLC	EDDY	S:11, T:17S, R:31E	TEX MACK 11 FEDERAL	8	12/12/2008	6,650		Yes	link	6,655	O	Active Permit	
30-015-36851	COG OPERATING LLC	EDDY	S:11, T:17S, R:31E	TEX MACK 11 FEDERAL	10	12/12/2008	6,618	6,600	Yes	link	6,618	PO	Active Permit	
30-015-36945	COG OPERATING LLC AGENT or COG OPERATING LLC	EDDY	S:11, T:17S, R:31E	TEX MACK 11 FEDERAL	9	12/12/2008	6,543	6,500	Yes	link	6,840	O	Active Permit	
30-015-36835	COG OPERATING LLC	EDDY	S:11, T:17S, R:31E	TEX MACK 11 FEDERAL	3	12/5/2008	6,600		Yes	link	6,805	O	Active Permit	

30-015-36833	COG OPERATING LLC	EDDY	S:14, T:17S, R:31E	SKELLY UNIT	623	12/5/2008	6,642	6,600	Yes	link	6,857	O	Active Permit	
30-015-36836	COG OPERATING LLC AGENT or COG OPERATING LLC	EDDY	S:11, T:17S, R:31E	TEX MACK 11 FEDERAL	4	12/5/2008	6,600		Yes	link	6,822	O	Active Permit	
30-015-36780	COG OPERATING LLC	EDDY	S:14, T:17S, R:31E	SKELLY UNIT	624	11/21/2008	6,600		Yes	link	6,620	O	Active Permit	
30-015-36251	COG OPERATING LLC	EDDY	S:2, T:17S, R:31E	TEX-MACK	205	4/7/2008	6,600		Yes	link	6,600	PO	Active Permit	YESO FORMATION
30-015-36250	COG OPERATING LLC	EDDY	S:2, T:17S, R:31E	TEX-MACK	204	4/7/2008	6,600		Yes	link	6,594	O	Active Permit	YESO FORMATION
30-015-35914	COG OPERATING LLC	EDDY	S:2, T:17S, R:31E	TEX-MACK	202	11/9/2007	6,700		Yes	link	12,581	O	Unknown	YESO FORMATION
30-015-35913	COG OPERATING LLC	EDDY	S:2, T:17S, R:31E	TEX-MACK	201	11/9/2007	6,700		Yes	link	6,700	PO	Active	YESO FORMATION
30-015-34746	HUDSON OIL COMPANY OF TEXAS	EDDY	S:12, T:17S, R:31E	PUCKETT NORTH	1	3/28/2006	4,300		No	link	4,268	O	Active Permit	
30-015-34747	HUDSON OIL COMPANY OF TEXAS	EDDY	S:12, T:17S, R:31E	PUCKETT NORTH	2	3/28/2006	4,300		No	link	4,300	PO	Active Permit	
30-015-34748	HUDSON OIL COMPANY OF TEXAS	EDDY	S:12, T:17S, R:31E	PUCKETT NORTH	3	3/28/2006	4,300		No	link	4,300	PO	Active Permit	
30-015-33257	OXY USA WTP LIMITED PARTNERSHIP	EDDY	S:3, T:17S, R:31E	OXY BIG RED TRUCK FEDERAL	1	1/8/2004	12,400		No	link	12,400	G	Active	
30-015-32982	OXY USA WTP LIMITED PARTNERSHIP	EDDY	S:3, T:17S, R:31E	OXY PRALINES & CREAM FEDERAL	001	8/15/2003	12,400		No	link	12,400	PG	Active	FREN MORROW
30-015-32982	OXY USA WTP LIMITED PARTNERSHIP	EDDY	S:3, T:17S, R:31E	OXY PRALINES & CREAM FEDERAL	001Q	7/31/2003			No	link	12,400	PG	Active	FREN MORROW
30-015-05049	HANSON ENERGY	EDDY	S:2, T:17S, R:31E	TIDEWATER K STATE	004	5/1/2003	0		No	link	3,850	O	Active	
30-015-22585	HANSON ENERGY	EDDY	S:2, T:17S, R:31E	STATE BGK	002	5/1/2003	0		No	link	3,867	O	Active	
30-015-05033	HANSON ENERGY	EDDY	S:1, T:17S, R:31E	HONDO K FEDERAL	001	5/1/2003	0		No	link	3,856	O	Pumping	
30-015-05042	HANSON ENERGY	EDDY	S:2, T:17S, R:31E	STATE BKC	009	5/1/2003	0		No	link	3,760	O	Pumping	
30-015-05043	HANSON ENERGY	EDDY	S:2, T:17S, R:31E	STATE BKC	010	5/1/2003	0		No	link	3,655	O	Pumping	
30-015-05045	HANSON ENERGY	EDDY	S:2, T:17S, R:31E	TIDEWATER K STATE	005	5/1/2003	0		No	link	3,851	O	Active	
30-015-05046	HANSON ENERGY	EDDY	S:2, T:17S, R:31E	TIDEWATER K STATE	001	5/1/2003	0		No	link	3,755	O	Pumping	
30-015-05047	HANSON ENERGY	EDDY	S:2, T:17S, R:31E	TIDEWATER K STATE	002	5/1/2003	0		No	link	3,775	O	Pumping	
30-015-05048	HANSON ENERGY	EDDY	S:2, T:17S, R:31E	TIDEWATER K STATE	003	5/1/2003	0		No	link	3,795	O	Pumping	
30-015-10185	HANSON ENERGY	EDDY	S:1, T:17S, R:31E	HONDO K FEDERAL	002	5/1/2003	0		No	link	3,846	O	Active	
30-015-22641	HANSON ENERGY	EDDY	S:2, T:17S, R:31E	TIDEWATER K STATE	006	5/1/2003	0		No	link	3,910	O	Active	

30-015-22981	HANSON ENERGY	EDDY	S:2, T:17S, R:31E	STATE BGK	003	5/1/2003	0	No	link	0	O	Active	
30-015-23375	HANSON ENERGY	EDDY	S:2, T:17S, R:31E	STATE BGK	004	5/1/2003	0	No	link	3,875	O	Pumping	
30-015-23376	HANSON ENERGY	EDDY	S:2, T:17S, R:31E	STATE BGK	005	5/1/2003	0	No	link	3,856	O	Active	
30-015-05034	CBS OPERATING CORPORATION or CBS OPERATING CORP	EDDY	S:2, T:17S, R:31E	FEATHERSTONE	005	9/1/2002		No	link		PI	Temporarily Abandoned	
30-015-05037	CBS OPERATING CORPORATION or CBS OPERATING CORP	EDDY	S:2, T:17S, R:31E	FEATHERSTONE	002	9/1/2002		No	link	3,650	O	Shut-in	
30-015-05038	CBS OPERATING CORPORATION or CBS OPERATING CORP	EDDY	S:2, T:17S, R:31E	FEATHERSTONE	003	9/1/2002		No	link	3,825	O	Active	
30-015-05039	CBS OPERATING CORPORATION or CBS OPERATING CORP	EDDY	S:2, T:17S, R:31E	FEATHERSTONE	004	9/1/2002		No	link	3,650	O	Shut-in	
30-015-05040	CBS OPERATING CORPORATION or CBS OPERATING CORP	EDDY	S:2, T:17S, R:31E	WILSON	001	9/1/2002		No	link	3,824	O	Active	
30-015-05041	CBS OPERATING CORPORATION or CBS OPERATING CORP	EDDY	S:2, T:17S, R:31E	WILSON	002	9/1/2002		No	link	3,774	O	Shut-in	
30-015-31409	HUDSON OIL COMPANY OF TEXAS	EDDY	S:12, T:17S, R:31E	PUCKETT B 12	001	8/8/2002	12,500	No	link	12,500	G	Active	
30-015-31740	HUDSON OIL COMPANY OF TEXAS	EDDY	S:12, T:17S, R:31E	PUCKETT B 12	002	8/8/2002		No	link	12,500	G	Active	
30-015-31409	HUDSON OIL COMPANY OF TEXAS	EDDY	S:12, T:17S, R:31E	PUCKETT B 12	001	7/31/2002		No	link	12,500	G	Active	FREN MORROW
30-015-31740	HUDSON OIL COMPANY OF TEXAS	EDDY	S:12, T:17S, R:31E	PUCKETT B 12	002	7/31/2002		No	link	12,500	G	Active	FREN MORROW
30-015-05054	MERIT ENERGY CO or MERIT ENERGY COMPANY, LLC	EDDY	S:3, T:17S, R:31E	H E WEST A	011	7/1/2002		No	link	3,988	I	Injection Well	
30-015-05057	MERIT ENERGY CO or MERIT ENERGY COMPANY, LLC	EDDY	S:3, T:17S, R:31E	H E WEST B	018	7/1/2002		No	link	3,996	I	Injection Well	
30-015-05059	MERIT ENERGY CO or MERIT ENERGY COMPANY, LLC	EDDY	S:3, T:17S, R:31E	H E WEST B	025	7/1/2002	0	No	link	0	O	Pumping	

30-015-05060	MERIT ENERGY CO or MERIT ENERGY COMPANY, LLC	EDDY	S:3, T:17S, R:31E	H E WEST B	026	7/1/2002	0	No	link	3,947	I	Injection Well	
30-015-05124	MERIT ENERGY CO	EDDY	S:10, T:17S, R:31E	H E WEST B	015	7/1/2002		No	link	3,952	I	Plugged	
30-015-05126	MERIT ENERGY CO or MERIT ENERGY COMPANY, LLC	EDDY	S:10, T:17S, R:31E	H E WEST B	020	7/1/2002		No	link	3,971	I	Injection Well	
30-015-05128	MERIT ENERGY CO or MERIT ENERGY COMPANY, LLC	EDDY	S:10, T:17S, R:31E	H E WEST B	024	7/1/2002		No	link	3,916	PI	Injection Well	
30-015-25921	MERIT ENERGY CO or MERIT ENERGY COMPANY, LLC	EDDY	S:10, T:17S, R:31E	H E WEST B	031	7/1/2002		No	link	4,218	O	Pumping	
30-015-25989	MERIT ENERGY CO or MERIT ENERGY COMPANY, LLC	EDDY	S:10, T:17S, R:31E	H E WEST B	034	7/1/2002		No	link	3,885	O	Pumping	
30-015-26000	MERIT ENERGY CO or MERIT ENERGY COMPANY, LLC	EDDY	S:3, T:17S, R:31E	H E WEST B	037	7/1/2002		No	link		I	Injection Well	
30-015-26015	MERIT ENERGY CO or MERIT ENERGY COMPANY, LLC	EDDY	S:3, T:17S, R:31E	H E WEST A	015	7/1/2002		No	link	4,090	O	Pumping	
30-015-26044	MERIT ENERGY CO or MERIT ENERGY COMPANY, LLC	EDDY	S:10, T:17S, R:31E	H E WEST B	042	7/1/2002		No	link	4,004	O	Pumping	
30-015-26572	MERIT ENERGY CO or MERIT ENERGY COMPANY, LLC	EDDY	S:10, T:17S, R:31E	H E WEST B	048	7/1/2002		No	link	4,370	I	Injection Well	QUEEN
30-015-26573	MERIT ENERGY CO or MERIT ENERGY COMPANY, LLC	EDDY	S:3, T:17S, R:31E	H E WEST A	018	7/1/2002		No	link	4,362	O	Pumping	QUEEN
30-015-27311	MERIT ENERGY CO or MERIT ENERGY COMPANY, LLC	EDDY	S:10, T:17S, R:31E	H E WEST B	058	7/1/2002		No	link	4,480	O	Pumping	SAN ANDRES
30-015-27317	MERIT ENERGY CO or MERIT ENERGY COMPANY, LLC	EDDY	S:3, T:17S, R:31E	H E WEST B	057	7/1/2002		No	link	4,400	O	Pumping	GRAYBURG
30-015-27318	MERIT ENERGY CO or MERIT ENERGY COMPANY, LLC	EDDY	S:10, T:17S, R:31E	H E WEST B	059	7/1/2002		No	link	4,370	O	Pumping	GRAYBURG
30-015-27353	MERIT ENERGY CO or MERIT ENERGY COMPANY, LLC	EDDY	S:3, T:17S, R:31E	H E WEST B	056	7/1/2002		No	link	4,385	O	Pumping	GRAYBURG
30-015-27354	MERIT ENERGY CO or MERIT ENERGY COMPANY, LLC	EDDY	S:10, T:17S, R:31E	H E WEST B	067	7/1/2002		No	link	4,395	O	Pumping	GRAYBURG
30-015-27785	MERIT ENERGY CO or MERIT ENERGY COMPANY, LLC	EDDY	S:10, T:17S, R:31E	H E WEST B	066	7/1/2002	0	No	link	4,190	O	Pumping	GB-JACKSON POOL

30-015-28318	MERIT ENERGY CO or MERIT ENERGY COMPANY, LLC	EDDY	S:3, T:17S, R:31E	H E WEST A	028	7/1/2002		No	link	4,300	O	Pumping	GRAYBURG-JACKSON
30-015-28323	MERIT ENERGY CO or MERIT ENERGY COMPANY, LLC	EDDY	S:3, T:17S, R:31E	H E WEST A	031	7/1/2002		No	link	4,505	O	Pumping	GRAYBURG-JACKSON
30-015-28324	MERIT ENERGY CO or MERIT ENERGY COMPANY, LLC	EDDY	S:3, T:17S, R:31E	H E WEST A	032	7/1/2002		No	link	4,425	O	Pumping	GRAYBURG-JACKSON
30-015-28387	MERIT ENERGY CO or MERIT ENERGY COMPANY, LLC	EDDY	S:3, T:17S, R:31E	H E WEST B	085	7/1/2002		No	link	4,470	O	Pumping	GRAYBURG-JACKSON
30-015-28465	MERIT ENERGY CO or MERIT ENERGY COMPANY, LLC	EDDY	S:3, T:17S, R:31E	H E WEST A	030	7/1/2002		No	link	4,475	O	Pumping	GRAYBURG JACKSON
30-015-28466	MERIT ENERGY CO or MERIT ENERGY COMPANY, LLC	EDDY	S:3, T:17S, R:31E	H E WEST B	076	7/1/2002		No	link	4,100	O	Pumping	GRAYBURG JACKSON
30-015-28535	MERIT ENERGY CO or MERIT ENERGY COMPANY, LLC	EDDY	S:10, T:17S, R:31E	H E WEST B	069	7/1/2002		No	link	4,040	O	Pumping	SAN ANDRES
30-015-28575	MERIT ENERGY CO or MERIT ENERGY COMPANY, LLC	EDDY	S:10, T:17S, R:31E	H E WEST B	068	7/1/2002		No	link	4,055	O	Pumping	SAN ANDRES
30-015-28634	MERIT ENERGY CO or MERIT ENERGY COMPANY, LLC	EDDY	S:3, T:17S, R:31E	H E WEST B	065	7/1/2002		No	link	4,000	O	Pumping	GRAYBURG JACKSON
30-015-29349	MERIT ENERGY CO or MERIT ENERGY COMPANY, LLC	EDDY	S:10, T:17S, R:31E	H E WEST B	094	7/1/2002		No	link	4,150	I	Injection Well	SAN ANDRES
30-015-29720	CHEVRON USA, INC. or CHEVRON U S A INC	EDDY	S:11, T:17S, R:31E	TEXMACK 11 FEDERAL	001	5/1/2002		No	link		G	Flowing	MORROW
30-015-30162	CHEVRON USA, INC. or CHEVRON U S A INC	EDDY	S:2, T:17S, R:31E	TEXMACK 2 STATE COM	001	5/1/2002		No	link	12,430	G	Flowing	MORROW
30-015-30512	CHEVRON USA, INC. or CHEVRON U S A INC	EDDY	S:1, T:17S, R:31E	TEXMACK 1 FEDERAL COM	001	5/1/2002		No	link	12,651	PG	Unknown	MORROW
30-015-30799	CHEVRON USA, INC. or CHEVRON U S A INC	EDDY	S:2, T:17S, R:31E	TEXMACK 2 STATE COM	002	5/1/2002		No	link	12,500	G	Flowing	MORROW
30-015-05129	WESTBROOK OIL CORP	EDDY	S:11, T:17S, R:31E	LEA C	001	3/1/2002		No	link		O	Pumping	
30-015-05130	WESTBROOK OIL CORP	EDDY	S:11, T:17S, R:31E	LEA C	002	3/1/2002		No	link		O	Active	
30-015-05131	WESTBROOK OIL CORP	EDDY	S:11, T:17S, R:31E	LEA C	003	3/1/2002		No	link	3,953	O	Temporarily Abandoned	
30-015-05132	WESTBROOK OIL CORP	EDDY	S:11, T:17S, R:31E	LEA C	004	3/1/2002		No	link	3,798	O	Temporarily Abandoned	
	WESTBROOK												

30-015-05133	OIL CORP	EDDY	S:11, T:17S, R:31E	LEA C	005	3/1/2002		No	link		O	Active	
30-015-05134	WESTBROOK OIL CORP	EDDY	S:11, T:17S, R:31E	LEA C	006	3/1/2002		No	link		O	Active	
30-015-20627	WESTBROOK OIL CORP	EDDY	S:11, T:17S, R:31E	LEA C	007	3/1/2002		No	link	3,970	I	Temporarily Abandoned	
30-015-20641	WESTBROOK OIL CORP	EDDY	S:11, T:17S, R:31E	LEA C	008	3/1/2002		No	link	3,920	O	Temporarily Abandoned	
30-015-20648	WESTBROOK OIL CORP	EDDY	S:11, T:17S, R:31E	LEA C	009	3/1/2002		No	link		I	Temporarily Abandoned	
30-015-20678	WESTBROOK OIL CORP	EDDY	S:11, T:17S, R:31E	LEA C	010	3/1/2002		No	link	3,954	O	Active	
30-015-20679	WESTBROOK OIL CORP	EDDY	S:11, T:17S, R:31E	LEA C	011	3/1/2002		No	link	3,930	I	Temporarily Abandoned	
30-015-20697	WESTBROOK OIL CORP	EDDY	S:11, T:17S, R:31E	LEA C	012	3/1/2002		No	link	3,995	O	Pumping	
30-015-20704	WESTBROOK OIL CORP	EDDY	S:11, T:17S, R:31E	LEA C	013	3/1/2002		No	link	4,000	I	Temporarily Abandoned	
30-015-20705	WESTBROOK OIL CORP	EDDY	S:11, T:17S, R:31E	LEA C	014	3/1/2002		No	link	4,020	O	Temporarily Abandoned	
30-015-20706	WESTBROOK OIL CORP	EDDY	S:11, T:17S, R:31E	LEA C	015	3/1/2002		No	link	4,030	I	Temporarily Abandoned	
30-015-20707	WESTBROOK OIL CORP	EDDY	S:11, T:17S, R:31E	LEA C	016	3/1/2002		No	link	4,060	O	Pumping	
30-015-31411	OXY USA WTP LIMITED PARTNERSHIP	EDDY	S:3, T:17S, R:31E	OXY PRALINES & CREAM FEDERAL	001	12/28/2001		No	link	12,400	G	Active	
30-015-31411	OXY USA WTP LIMITED PARTNERSHIP	EDDY	S:3, T:17S, R:31E	OXY PRALINES & CREAM FEDERAL	001	11/30/2001		No	link	12,400	G	Active	FREN MORROW
30-015-31322	MARBOB ENERGY CORP	EDDY	S:10, T:17S, R:31E	OXY POTEET STRAWBERRY FEDERAL	001	5/1/2001		No	link	12,200	O	Pumping	FREN MORROW
30-015-29836	BURNS OPERATING	EDDY	S:10, T:17S, R:31E	ARCO 10 FEDERAL	002	1/12/1999		No	link		X	Cancelled	DEVONIAN
30-015-30312	TEXACO EXPLORATION & PRODUCTION INC	EDDY	S:11, T:17S, R:31E	TEXMACK 11 FEDERAL	002	6/15/1998		No	link	12,350	G	Active	WOLFCAMP
30-015-05036	XERIC OIL & GAS CORP	EDDY	S:2, T:17S, R:31E	FEATHERSTONE	001	8/1/1995	0	No	link	3,675	O	Flowing	
30-015-22662	DEVON ENERGY OPERATING CORP	EDDY	S:10, T:17S, R:31E	H E WEST B	001	9/1/1994		No	link	5,515	O	Pumping	
30-015-23835	RAY WESTALL	EDDY	S:1, T:17S, R:31E	VOLA FEDERAL	002	11/1/1981		No	link	0	PO	Pumping	
30-015-23556	RAY WESTALL	EDDY	S:1, T:17S, R:31E	VOLA FEDERAL	001	4/1/1981		No	link	4,500	PO	Pumping	
30-015-23488	STEVENS OPERATING CORPORATION or HANAGAN PETROLEUM CORP	EDDY	S:2, T:17S, R:31E	PRE-ONGARD WELL	006	1/1/1970		No	link		PO	Active Permit	KENNEDY OIL CO INC /NM BG ST
30-015-26202	STEVENS OPERATING CORPORATION or HANAGAN PETROLEUM CORP	EDDY	S:3, T:17S, R:31E	PRE-ONGARD WELL	018	1/1/1970		No	link		PO	Active Permit	HONDO OIL & GAS CO /H E WEST A
30-015-26208	STEVENS OPERATING CORPORATION or HANAGAN PETROLEUM CORP	EDDY	S:10, T:17S, R:31E	PRE-ONGARD WELL	048	1/1/1970		No	link		PO	Active Permit	HONDO OIL & GAS CO /H E WEST B

[PDF](#) [Save](#)
[Map](#) [Image](#)

