

District I  
1625 N. French Dr., Hobbs, NM 88240

District II  
1301 W. Grand Avenue, Artesia, NM 88210

District III  
1000 Rio Brazos Rd., Aztec, NM 87410

District IV  
1220 S. St. Francis Dr., Santa Fe, NM 87505

State of New Mexico  
Energy, Minerals & Natural Resources Department  
**OIL CONSERVATION DIVISION**  
1220 South St. Frances Dr.  
Santa Fe, NM 87505

Form C-102  
Revised October 15, 2009  
Submit one copy to appropriate  
District Office

☐ AMENDED REPORT

WELL LOCATION AND ACREAGE DEDICATION PLAT

1 API Number 30-015- <b>38051</b>		2 Pool Code 96718		3 Pool Name LOCO HILLS; GLORIETA-YESO	
4 Property Code 37868		5 Property Name MIRANDA FEDERAL			6 Well Number 14
7 OGRID No 229137		8 Operator Name COG OPERATING LLC			9 Elevation 3691 3

10 Surface Location

UL or lot	Section	Township	Range	Lot Idn	Feet from the	North/South line	Feet from the	East/West line	County
F	9	17 S	30 E		2528	NORTH	2309	WEST	EDDY

11 Bottom Hole Location If Different From Surface

UL or lot	Section	Township	Range	Lot Idn	Feet from the	North/South line	Feet from the	East/West line	County
F	9	17 S	30 E		2310	NORTH	2310	WEST	EDDY

12 Dedicated Acres 40	13 Joint or Infill	14 Consolidation Code	15 Order No <b>NSL-6204</b>
--------------------------	--------------------	-----------------------	--------------------------------

No allowable will be assigned to this completion until all interests have been consolidated or a non-standard unit has been approved by the division.

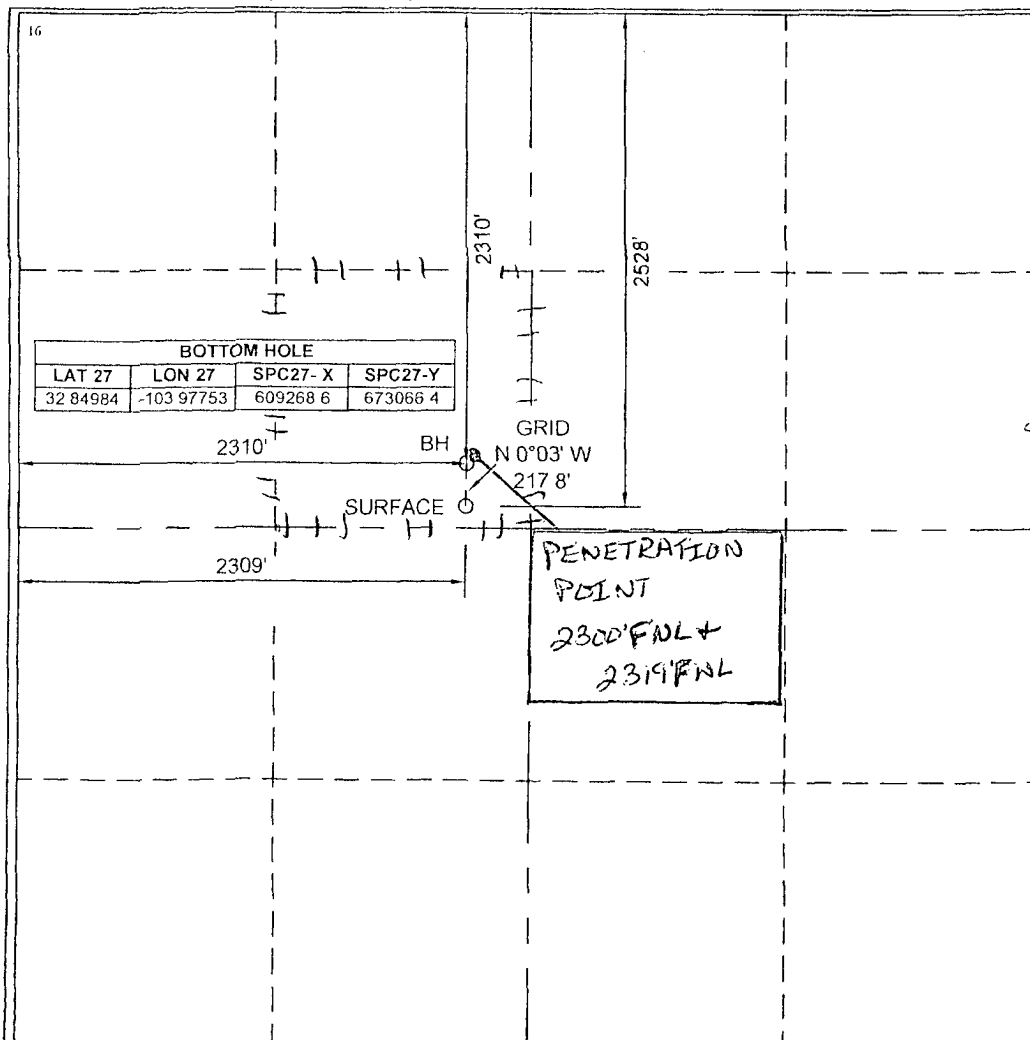

17 OPERATOR CERTIFICATION

I hereby certify that the information contained herein is true and complete to the best of my knowledge and belief, and that this organization either owns a working interest or unleased mineral interest in the land including the proposed bottom hole location or has a right to drill this well at this location pursuant to a contract with an owner of such a mineral or working interest, or to a voluntary pooling agreement or a compulsory pooling order heretofore enter by the division.

*Robyn Odom* 4/16/2010  
Signature Date

Robyn Odom

Printed Name

18 SURVEYOR CERTIFICATION

I hereby certify that the well location shown on this plat was plotted from field notes of actual surveys made by me or under my supervision, and that the same is true and correct to the best of my belief.

03/10/2010

Date of Survey

Signature and Seal of Professional Surveyor

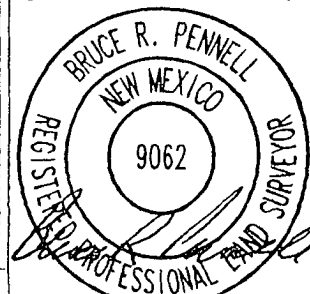

Bruce R. Pennell  
Certificate Number 9062

NAD27 GEOGRAPHIC COORDINATES		NAD27 SPC - NM EAST	
LAT: 32.84924	LON -103 97753	X = 609268 8	Y = 672848.6