

District I
1625 N. French Dr., Hobbs, NM 88240
District II
1301 W. Grand Avenue, Artesia, NM 88210
District III
1000 Rio Brazos Rd., Aztec, NM 87410
District IV
1220 S. St. Francis Dr., Santa Fe, NM 87505

State of New Mexico
Energy, Minerals & Natural Resources Department
OIL CONSERVATION DIVISION
1220 South St. Francis Dr.
Santa Fe, NM 87505

Form C-102
Revised July 16, 2010
Submit one copy to appropriate
District Office

☐ AMENDED REPORT

WELL LOCATION AND ACREAGE DEDICATION PLAT

¹ API Number		² Pool Code		³ Pool Name Wildcat; Upper Penn	
⁴ Property Code		⁵ Property Name Marjorie BGR			⁶ Well Number 1
⁷ OGRID No. 025575		⁸ Operator Name Yates Petroleum Corporation			⁹ Elevation 3392'

¹⁰ Surface Location

UL or lot no.	Section	Township	Range	Lot Idn	Feet from the	North/South line	Feet from the	East/West line	County
G	6	19S	26E		1650'	N	1980'	E	Eddy

¹¹ Bottom Hole Location If Different From Surface

UL or lot no.	Section	Township	Range	Lot Idn	Feet from the	North/South line	Feet from the	East/West line	County

¹² Dedicated Acres 320 N/2	¹³ Joint or Infill	¹⁴ Consolidation Code	¹⁵ Order No.
--	-------------------------------	----------------------------------	-------------------------

No allowable will be assigned to this completion until all interests have been consolidated or a non-standard unit has been approved by the division.

<div data-bbox="103 968 1039 1449"> <p>¹⁶</p> </div>	<div data-bbox="1039 968 1508 1449"> <p>¹⁷ OPERATOR CERTIFICATION I hereby certify that the information contained herein is true and complete to the best of my knowledge and belief, and that this organization either owns a working interest or unleased mineral interest in the land including the proposed bottom hole location or has a right to drill this well at this location pursuant to a contract with an owner of such a mineral or working interest, or to a voluntary pooling agreement or a compulsory pooling order heretofore entered by the division. Signature Date 2/11/11 Printed Name Monti Sanders E-mail Address montis@yatespetroleum.com </p> </div>

105

STATE OF NEW MEXICO WELL LOCATION AND ACREAGE DEDICATION PLAT

Form 1-1-77
Surveyors Use Only
Effective 1-1-77

All distances must be from the outer boundaries of the section.

DORCHESTER EXPLORATION, INC.			LOSEE ET AL COM		Well No. 1
Unit Letter G	Section 6	Township 19S	Range 26E	County Eddy	
Actual Footage Location of Well:					
1650	feet from the North	line and	1980	feet from the East	line
Ground Level Elev. 3392.0	Producing Formation Morrow	Pool Undas. West Four Mile Draw Morrow	Dedicated Acreage: 310.85 Acres		

1. Outline the acreage dedicated to the subject well by colored pencil or hachure marks on the plat below.
2. If more than one lease is dedicated to the well, outline each and identify the ownership thereof (both as to working interest and royalty).
3. If more than one lease of different ownership is dedicated to the well, have the interests of all owners been consolidated by communitization, unitization, force-pooling, etc?

☒ Yes ☐ No If answer is "yes," type of consolidation Communitization

If answer is "no," list the owners and tract descriptions which have actually been consolidated. (Use reverse side of this form if necessary.)

No allowable will be assigned to the well until all interests have been consolidated (by communitization, unitization, forced-pooling, or otherwise) or until a non-standard unit, eliminating such interests, has been approved by the Commission.

CERTIFICATION

I hereby certify that the information contained herein is true and complete to the best of my knowledge and belief.

Joe Bates

Name

Joe Bates

Position

Proration Administrator

Company

Dorchester Exploration, Inc.

Date

8-3-78

I hereby certify that the location shown on this plat was plotted from field notes of actual surveys and that the same is true and correct to the best of my knowledge and belief.

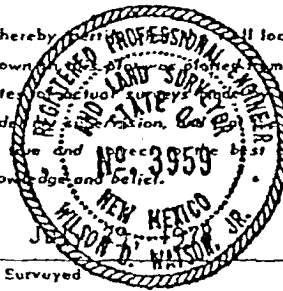

Date Surveyed

Wilson D. Watson, Jr.

Registered Professional Engineer and/or Land Surveyor

Wilson D. Watson, Jr.
3959

Certificate No.

