

30-015-38671

HYDROGEN SULFIDE (H₂S) CONTINGENCY PLAN

ASSUMED 100 PPM ROE = 3000'

Emergency Procedures

In the event of a release of gas containing H₂S, The first responder(s) must

- * Isolate the area and prevent entry by other persons into the 100 PPM ROE.
- * Evacuate any public places encompassed by 100 PPM ROE.
- * Be equipped with H₂S monitors and air packs in order to control release.
- * Use the "buddy system" to ensure no injuries occur during the response.
- * Take precautions to avoid personal injury during this operation.
- * Have received training in the following:
 1. H₂S detection
 2. Measures for protection against this gas
 3. Equipment used for protection and emergency response.

Ignition of Gas Source

Should control of the well be considered lost and ignition considered, take care to protect against exposure to Sulfur Dioxide (SO₂.) Intentional ignition must be coordinated with the NMOCD and local officials. Additionally the New Mexico State Police may become involved. NM State Police shall be the incident command on scene of any major release. Take care to protect downwind whenever there is an ignition of gas.

Characteristics of H₂S and SO₂

Common Name	Chemical Formula	Specific Gravity	Threshold Limit	Hazardous Limit	Lethal Concentration
Hydrogen Sulfide	H ₂ S	1.189 Air = 1	10 ppm	100 ppm/hr	600 ppm
Sulfur Dioxide	SO ₂	2.21 Air = 1	2 ppm	NA	1000 ppm

Contacting Authorities

Burnett Oil Co., Inc. personal must liaison with local and state agencies to ensure a proper response to a major release. Additionally, the OCD must be notified of the release as soon as possible but no later than 4 hours. Agencies will ask for information such as type and volume of release, wind and direction, location of release, etc. **Be sure all is written down and ready to give to contact list (Drilling Exhibit A.) Directions to the site are below.** Burnett's response must be in coordination with the State of New Mexico's Hazardous Materials Emergency Response Plan.

**Burnett Office 87 SQUARE LAKE ROAD (CR #220), Loco Hills, New Mexico 88255
(Loco Hills, New Mexico (2 MILES East of Loco Hills On US Hwy 82 TO C#220 Then North On CR# 220 Approx One Mile To Office**

BURNETT OIL CO., INC.

BURNETT OIL CO., INC. EMERGENCY NOTIFICATION LIST

Burnett's New Mexico Office (575) 677-2313
Belton Mathews BOCI District Superintendent CELL (575) 703-9601
BURNETT OIL HOME OFFICE (817) 332-5108
Mark Jacoby BOCI ENGINEERING MANAGER CELL (817) 312- 2751

EDDY COUNTY SHERIFF 911 OR (575) 746-9888
NEW MEXICO STATE POLICE (575) 746-2701

Loco Hills Fire Department (VOLUNTEER ONLY) 911 OR (575) 677 2349
For Medical and Fire (575) 746-2701 (ARTESIA)

Flight for Life Air Ambulance (LUBBOCK) (806) 743-9911
Aerocare Air Ambulance (LUBBOCK) (806) 747-8923
Med Flight Air Ambulance (ALBUQ) (505) 842-4433
S B Med Svc Air Ambulance (ALBUQ) (505) 842-4949

US Bureau of Land Management Carlsbad (575) 361-2822 (575) 234-5972
New Mexico Oil Conversation Division ARTESIA (575) 748-1283
New Mexico Emergency Response Commission 24 HR (575) 827-9126
New Mexico State Emergency Operation Center (575) 476-9635
Local Emergency Planning Committee (Artesia) (575) 746-2122
National Emergency Response Center (Washington, DC) (800) 424-8802

Boots & Coots IWC (800) 256-9688
Cudd Pressure Control (432) 570-5300
Halliburton Svc (575) 746-2757
B J Svc (575) 746-2293

THIS MUST BE POSTED AT THE RIG WHILE ON LOCATION.

Burnett Office 87 SQUARE LAKE ROAD (CR #220), Loco Hills, New Mexico 88255
(Loco Hills, New Mexico (2 MILES East of Loco Hills On US Hwy 82 TO C#220 Then North On CR# 220 Approx One Mile To Office.).

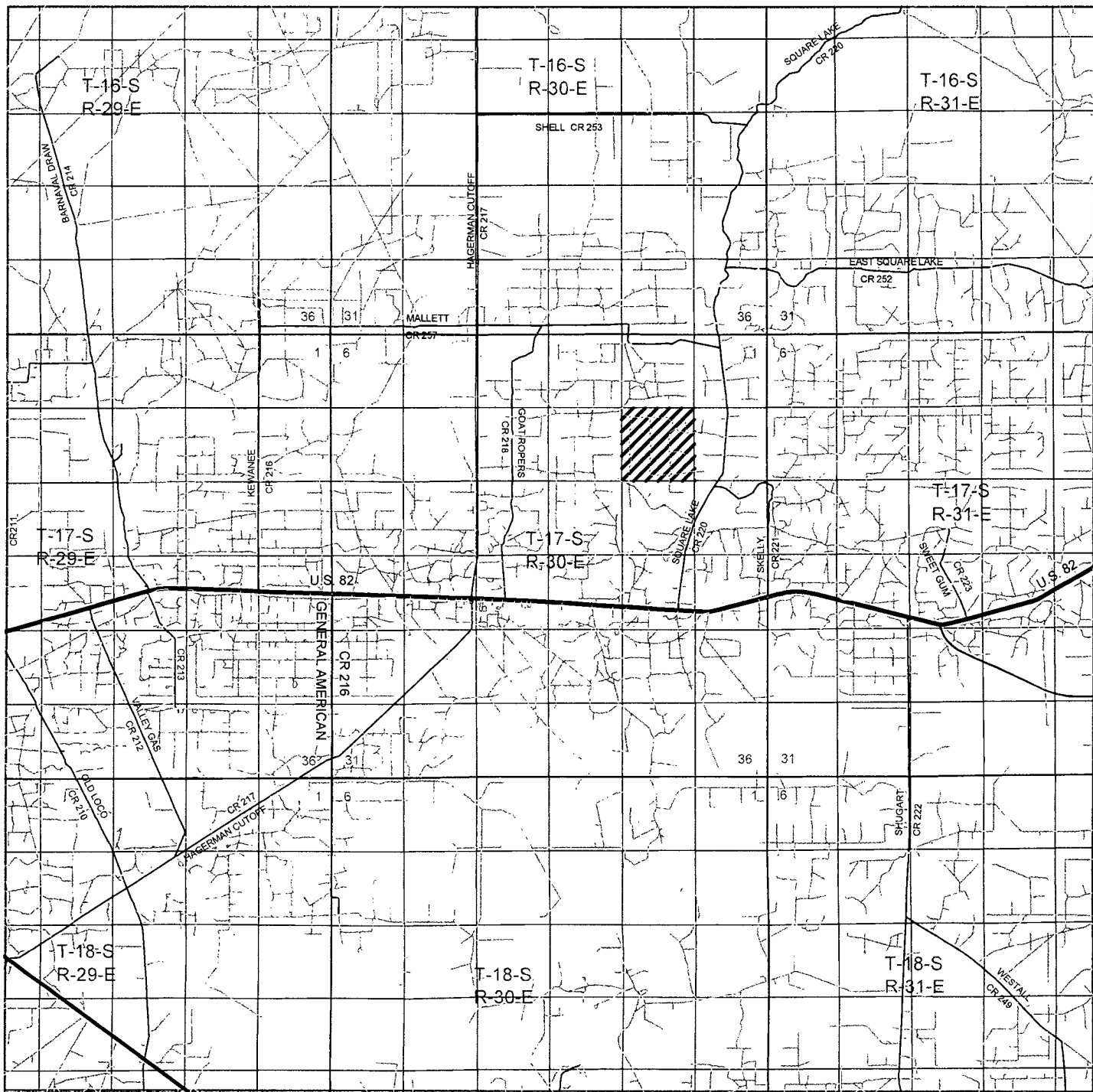

PROPOSED GISSLER "B" #69 LOCATION AND FLOWLINE
 Located 2160' FSL and 430' FWL
 Section 11, Township 17 South, Range 30 East,
 N.M.P.M., Eddy County, New Mexico.

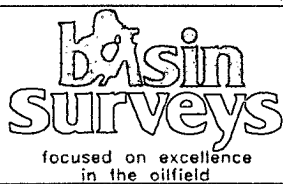

P.O. Box 1786
 1120 N. West County Rd.
 Hobbs, New Mexico 88241
 (575) 393-7316 - Office
 (575) 392-2206 - Fax
 basinsurveys.com

W.O. Number: KJG 23942

Survey Date: 01-04-2011

Scale: 1" = 2 Miles

Date: 01-24-2011

**BURNETT OIL
 COMPANY, INC.**

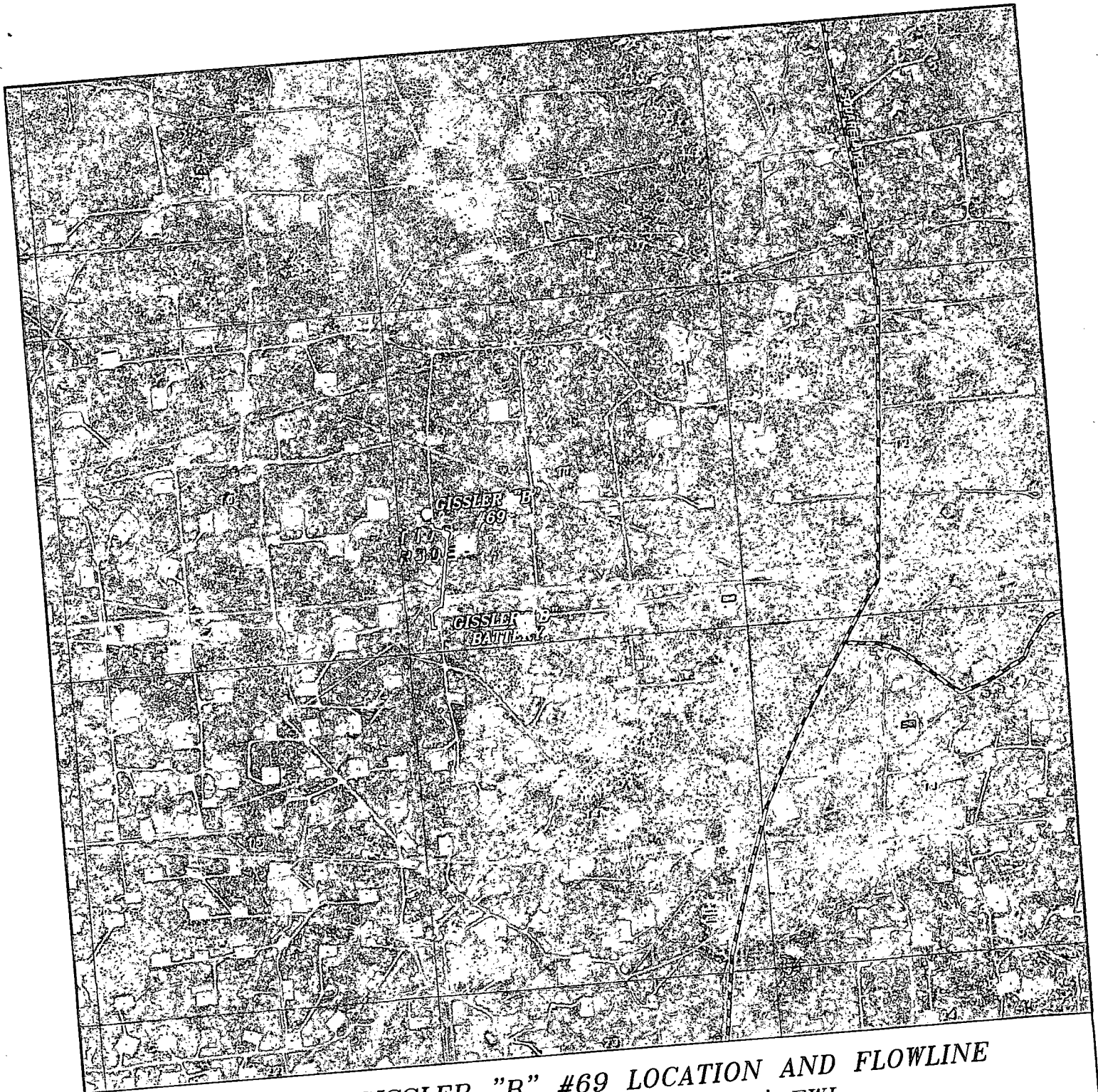

PROPOSED GISSLER "B" #69 LOCATION AND FLOWLINE
 Located 2160' FSL and 430' FWL
 Section 11, Township 17 South, Range 30 East,
 N.M.P.M., Eddy County, New Mexico.

basin
surveys

focused on excellence
 in the oilfield

P.O. Box 1786
 1120 N. West County Rd.
 Hobbs, New Mexico 88241
 (575) 393-7316 - Office
 (575) 392-2206 - Fax
 basinsurveys.com

W.O. Number: KJC 23942

Scale: 1" = 2000'

YELLOW TINT - USA LAND
 BLUE TINT - STATE LAND
 NATURAL COLOR - FEE LAND

**BURNETT OIL
 COMPANY, INC.**

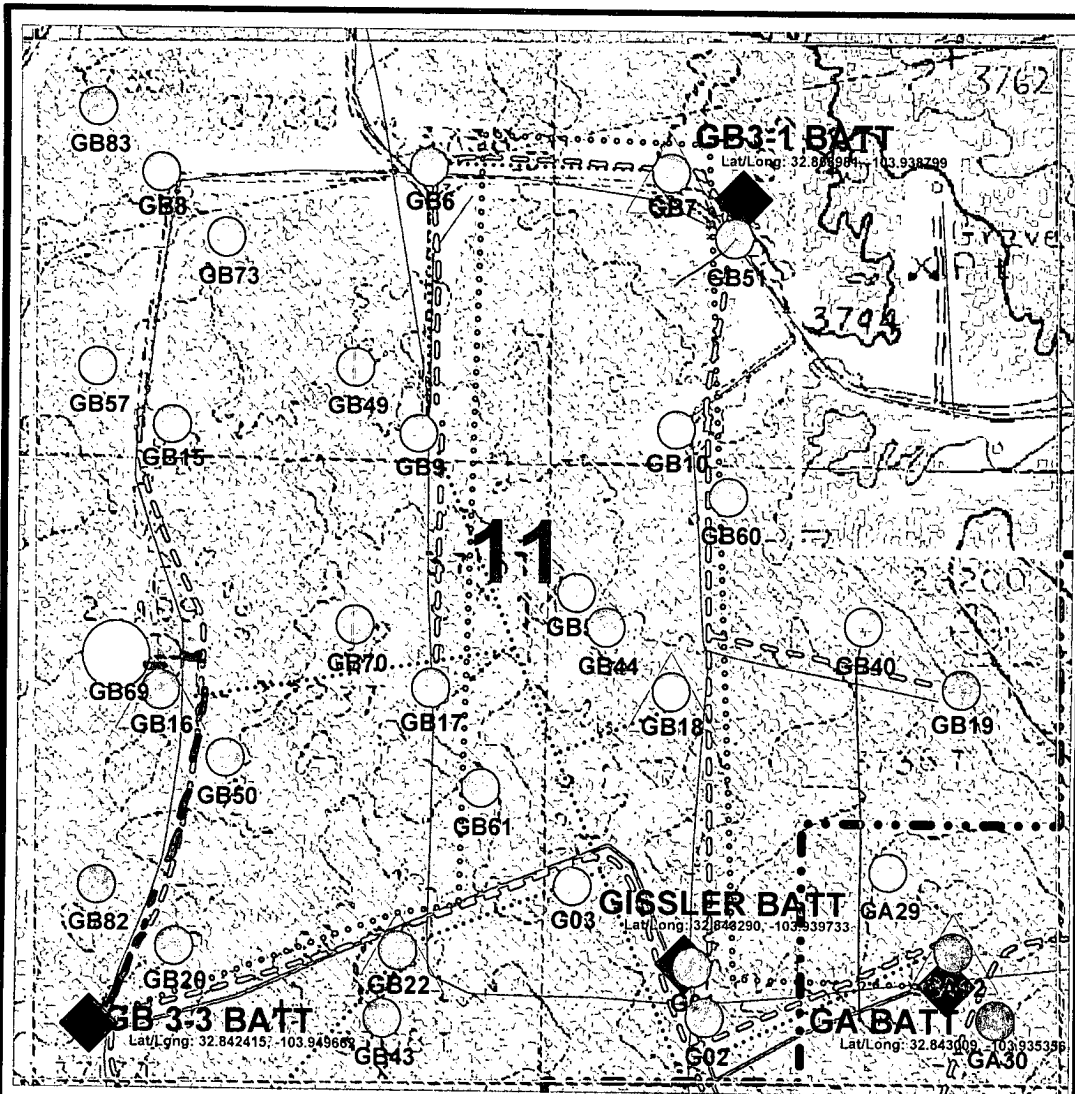

Well Names

- GA = Gissler A
- GB = Gissler B
- JA = Jackson A
- JB = Jackson B
- SA = Stevens A
- SB = Stevens B
- GJSA = Grayburg Jackson San Andres

Burnett Oil Co., Inc. 6666		
Gissler B69 Proposed Well Location (Map Reflects Burnett Operated Wells Only) Eddy County, New Mexico		
Author: C.K. Eng Tech	Date: December 28, 2010	
Scale: 1" = 750'		



2250' Flow line

Gissler B69

T17S, R30E, Sect 11, Unit L, NM2748 7493⁹¹
 2160' FSL, 430' FWL, GB 3-3 Battery
 Lat/Long: 32.847577, -103.949235

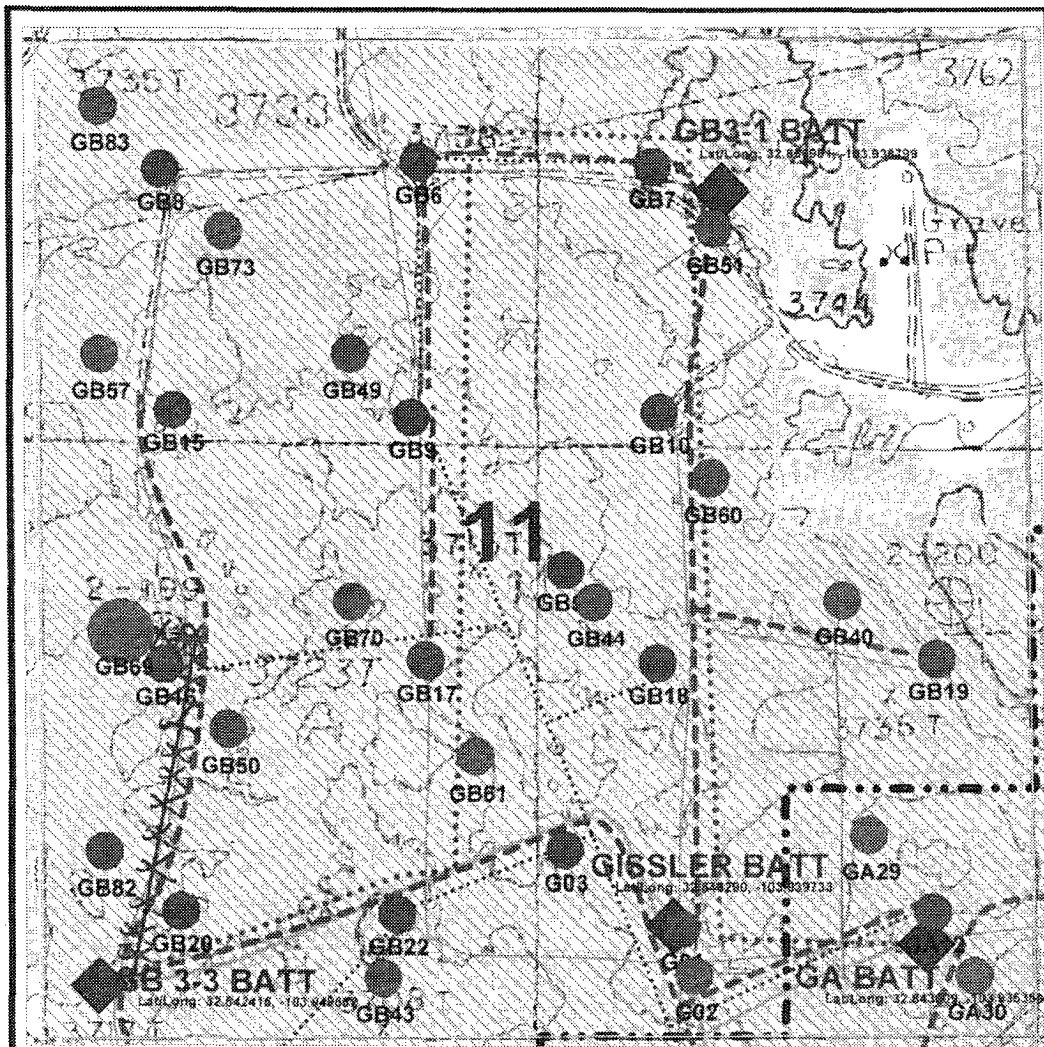

Well Names

- GA = Gissler A
- GB = Gissler B
- JA = Jackson A
- JB = Jackson B
- SA = Stevens A
- SB = Stevens B
- GJSA = Grayburg Jackson San Andres

Burnett Oil Co., Inc.		
6666		
Gissler B69 Proposed Well Location (Map Reflects Burnett Operated Wells Only) Eddy County, New Mexico		
Author: G. E. Long Tech	Date: December 24, 2011	
Scale: 1" = 250'		

2250 3" poly

Gissler B69

T17S, R30E, Sect 11, Unit L, NM 27-48 74939
 2160' FSL, 430' FWL, GB 3-3 Battery
 Lat/Long: 32.847577, -103.849235

SECTION 12, TOWNSHIP 17 SOUTH, RANGE 30 EAST, N.M.P.M.,
 EDDY COUNTY, NEW MEXICO.

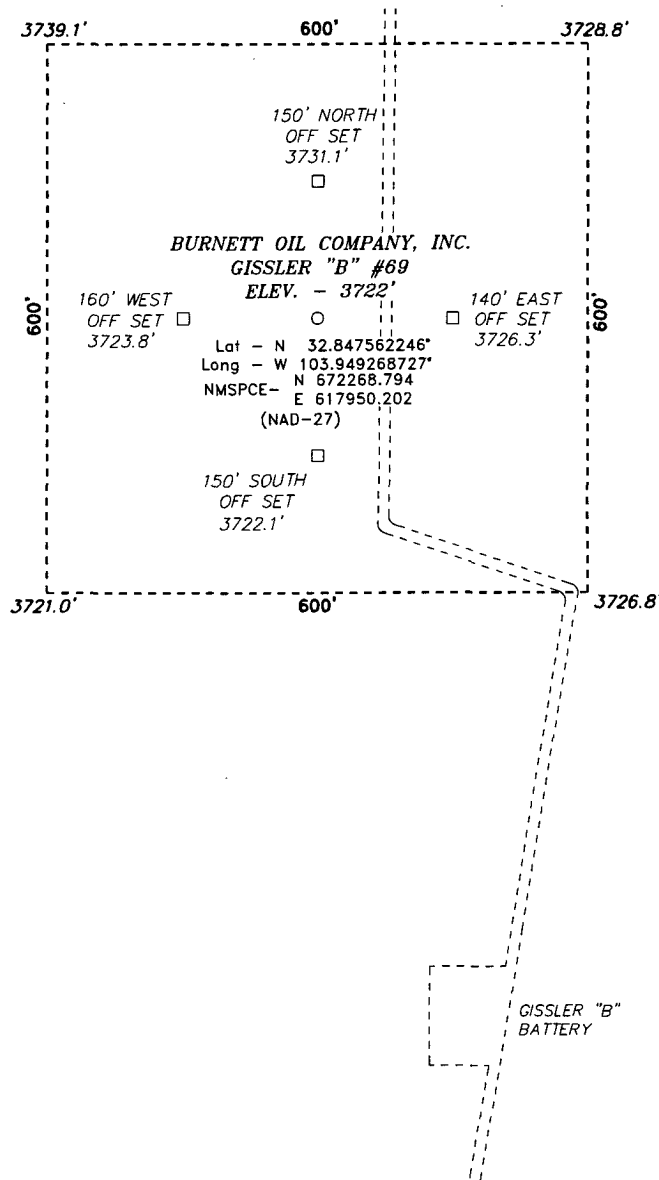

BURNETT OIL COMPANY, INC.
GISSLER "B" #69
ELEV. - 3722'

160' WEST
 OFF SET □
 3723.8'

140' EAST
 OFF SET □
 3726.3'

Lat - N 32.847562246°
 Long - W 103.949268727°
 NAD-27
 N 672268.794
 E 617950.202

150' SOUTH
 OFF SET □
 3722.1'

GISSLER "B"
 BATTERY

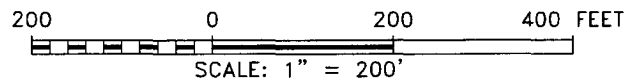

Directions to Location:

FROM THE JUNCTION OF HWY 82 AND SQUARE LAKE,
 GO NORTH ON SQUARE LAKE FOR APPROX. 1.2
 MILES TO LEASE ROAD, THEN WESTERLY ON LEASE
 ROAD FOR APPROX. 1.0 MILE, THEN NORTH FOR 0.1
 MILE TO THE GISSLER "B" BATTERY AND PROPOSED
 LEASE ROAD.

BURNETT OIL COMPANY, INC.

REF: GISSLER "B" #69 / WELL PAD TOPO

THE GISSLER "B" #69 LOCATED 2160'
 FROM THE SOUTH LINE AND 430' FROM THE WEST LINE OF
 SECTION 11, TOWNSHIP 17 SOUTH, RANGE 30 EAST,
 N.M.P.M., EDDY COUNTY, NEW MEXICO.

BASIN SURVEYS P.O. BOX 1786-HOBBS, NEW MEXICO

W.O. Number: 23942

Drawn By: K. GOAD

Date: 01-24-2011

Disk: KJG 23942

Survey Date: 01-04-2011

Sheet 1 of 1 Sheets

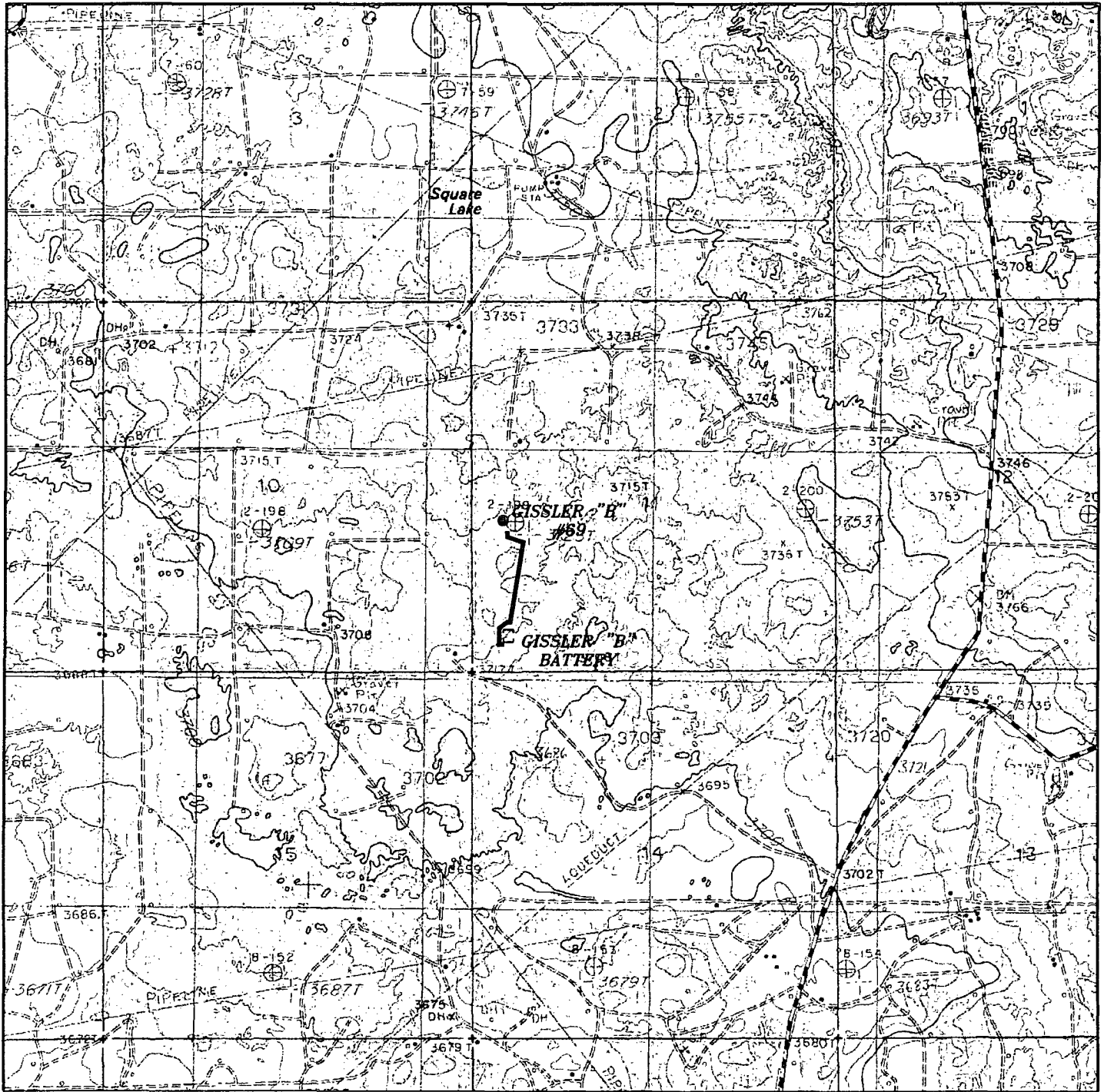

PROP. GISSLER "B" #69 LOCATION AND FLOWLINE
 Located 2160' FSL and 430' FWL
 Section 11, Township 17 South, Range 30 East,
 N.M.P.M., Eddy County, New Mexico.

basin
surveys
 focused on excellence
 in the oilfield

P.O. Box 1786
 1120 N. West County Rd.
 Hobbs, New Mexico 88241
 (575) 393-7316 - Office
 (575) 392-2206 - Fax
 basinsurveys.com

W.O. Number: KJC 23942

Survey Date: 01-04-2011

Scale: 1" = 2000'

Date: 01-24-2011

BURNETT OIL
COMPANY, INC.

SECTIONS 11, TOWNSHIP 17 SOUTH, RANGE 30 EAST, N.M.P.M.,
 EDDY COUNTY, NEW MEXICO.

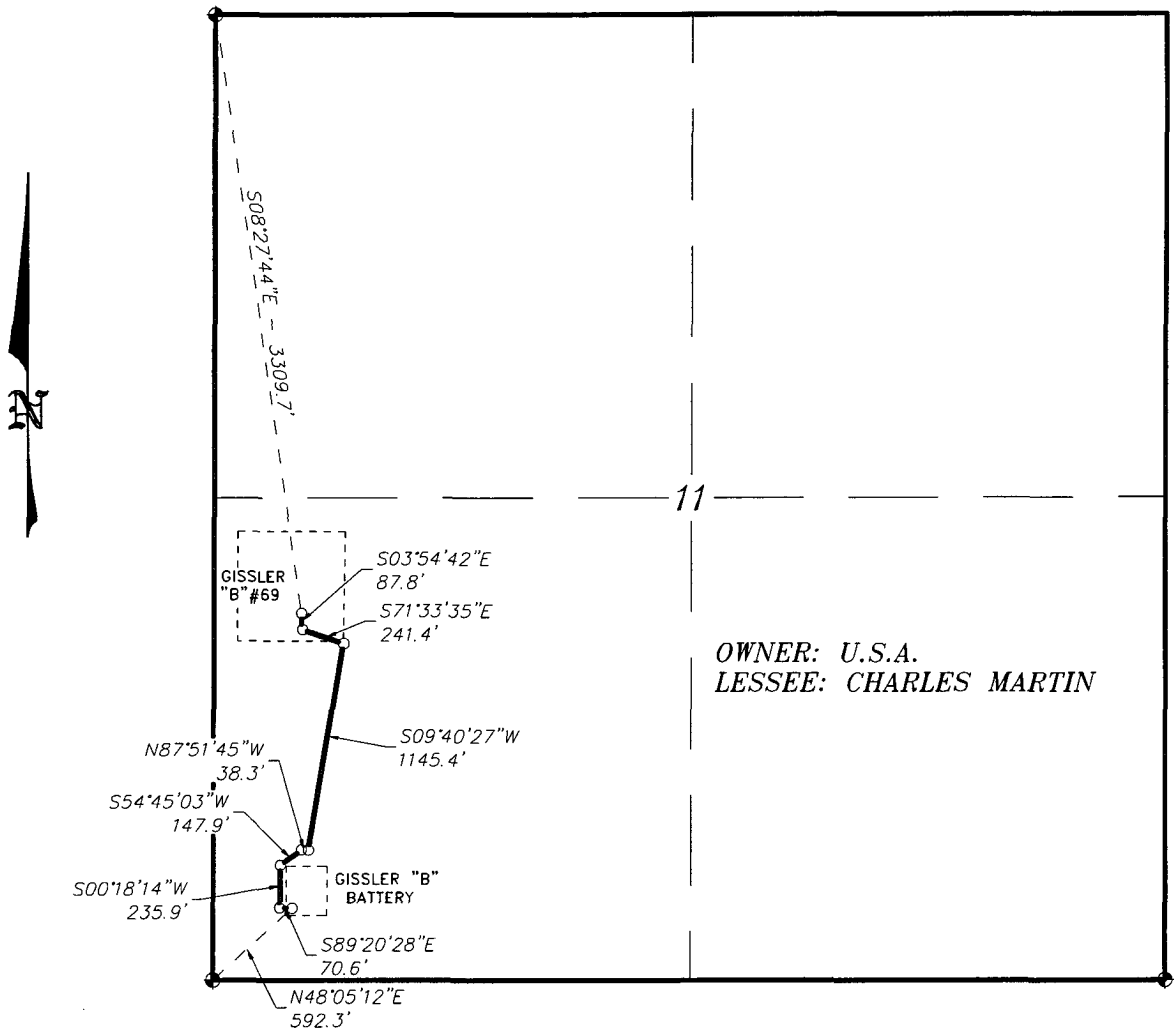

OWNER: U.S.A.
 LESSEE: CHARLES MARTIN

LEGAL DESCRIPTION

A STRIP OF LAND 30.0 FEET WIDE, LOCATED IN SECTION 11, TOWNSHIP 17 SOUTH, RANGE 30 EAST, N.M.P.M., EDDY COUNTY, NEW MEXICO AND BEING 15.0 FEET LEFT AND RIGHT OF THE ABOVE PLATTED CENTERLINE SURVEY.

1967.3 FEET = 119.23 RODS = 0.37 MILES = 1.35 ACRES

I HEREBY CERTIFY THAT THIS PLAN WAS PREPARED FROM FIELD NOTES OF THE ACTUAL SURVEY AND MEETS OR EXCEEDS ALL REQUIREMENTS FOR LAND SURVEYS AS SPECIFIED BY THIS STATE.

GARY L. JONES
 REGISTERED PROFESSIONAL LAND SURVEYOR
 No. 7977
 No. 5074



BURNETT OIL COMPANY, INC.

REF: PROPOSED FLOWLINE TO THE GISSLER "B" #69

A FLOWLINE CROSSING USA LAND IN
 SECTION 11, TOWNSHIP 17 SOUTH, RANGE 30 EAST,
 N.M.P.M., EDDY COUNTY, NEW MEXICO.

BASIN SURVEYS P.O. BOX 1786-HOBBS, NEW MEXICO

W.O. Number: 23945	Drawn By: K. GOAD
Date: 01-24-2011	Disk: KJG - 23942WELL.DWG
Survey Date: 01-04-2011	Sheet 1 of 1 Sheets

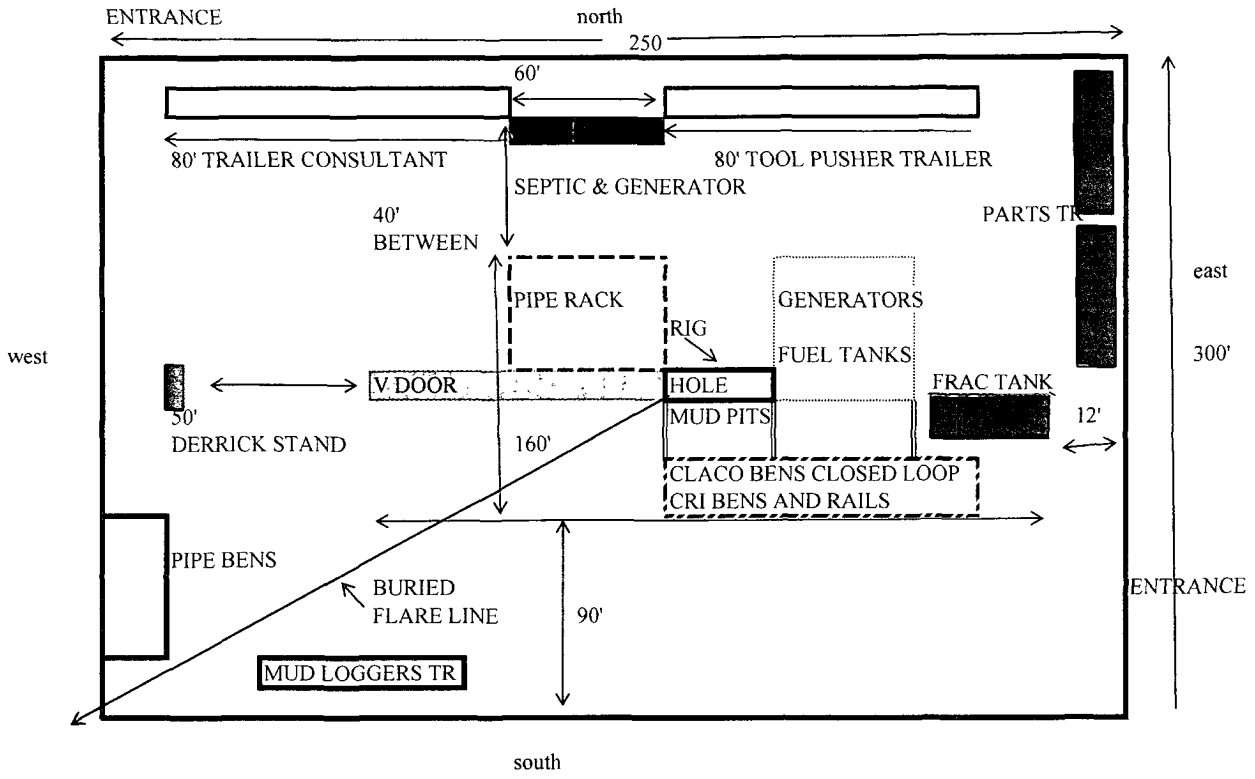

Gissler B 69 Rig Layout

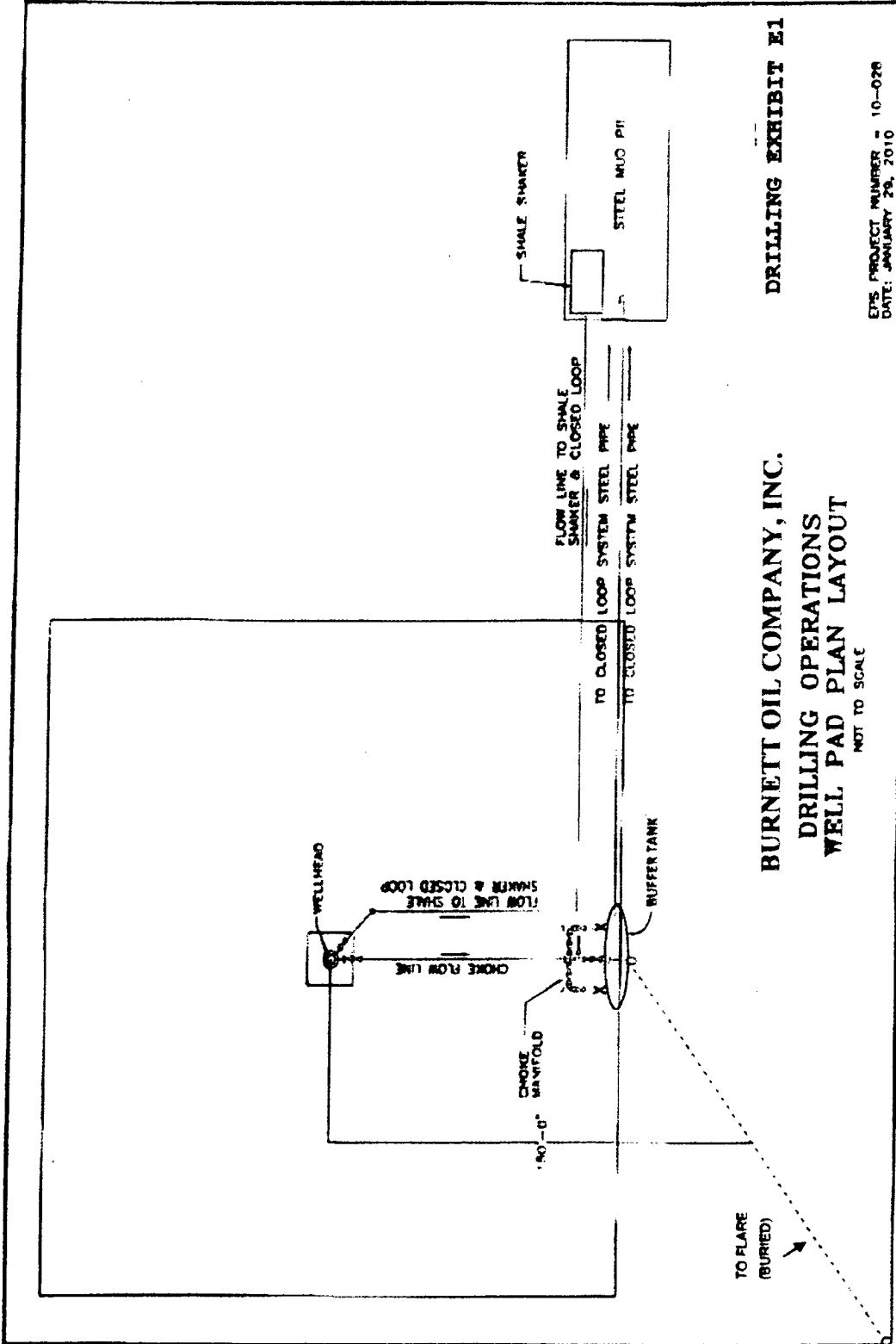

DRILLING EXHIBIT E1

BURNETT OIL COMPANY, INC.

**DRILLING OPERATIONS
WELL PAD PLAN LAYOUT**

NOT TO SCALE

EDS PROJECT NUMBER - 10-028
DATE: JANUARY 29, 2010

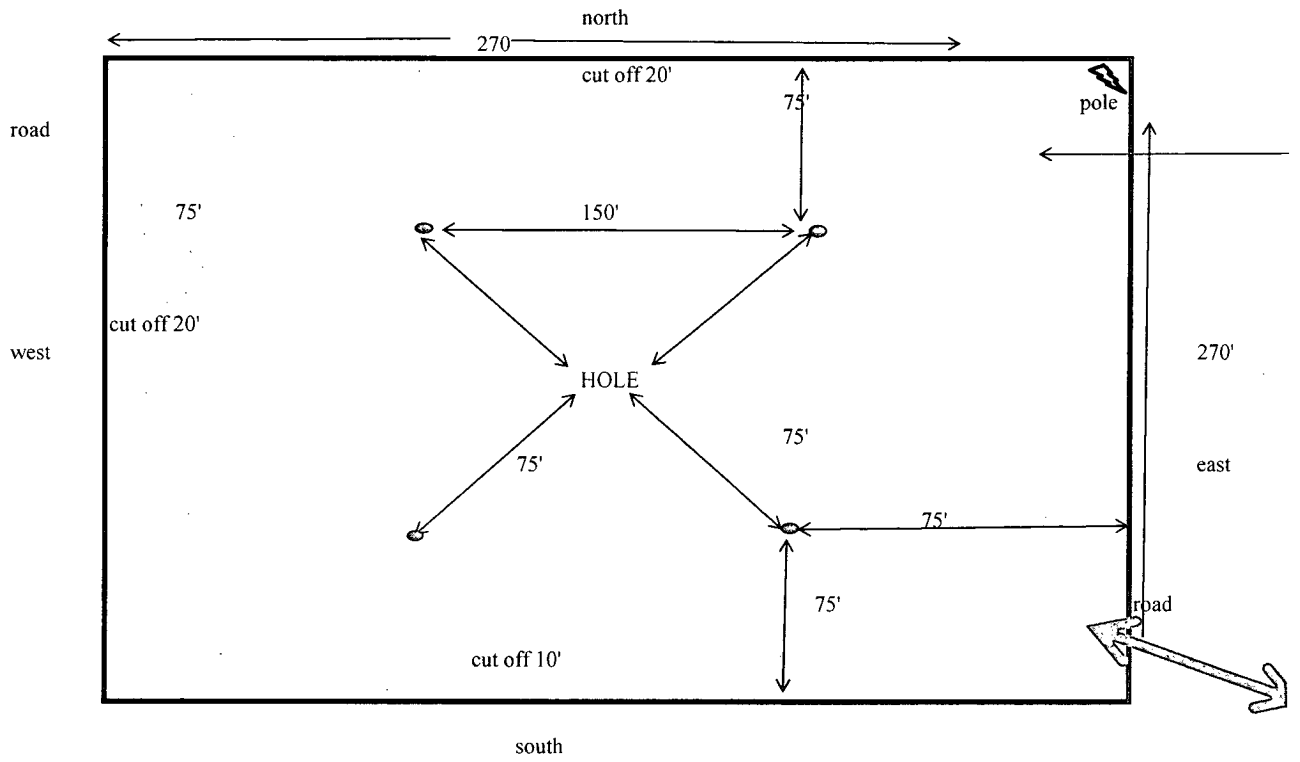

Gissler B 69 Reclamation Exhibit F



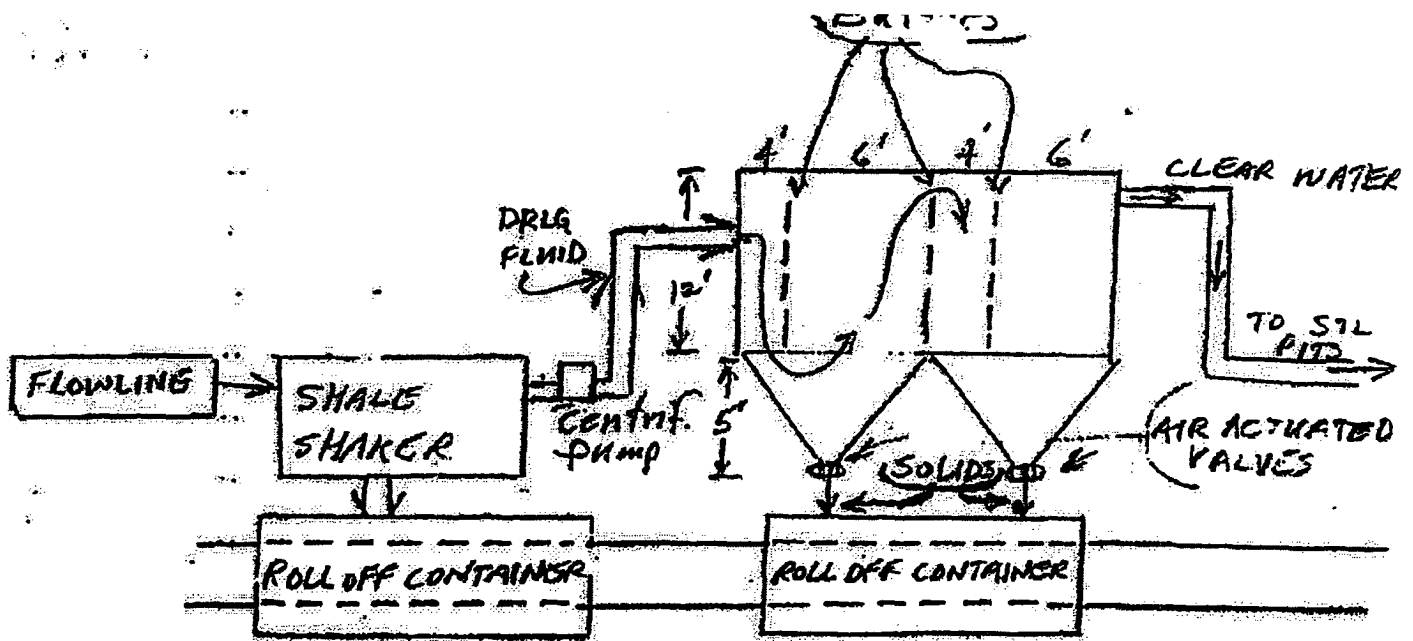

RECEIVED

APR 04 2011

HOBBSCOCK

OPERATIONAL & MAINTENANCE

DRILLING FLUIDS FROM THE WELLBORE WILL GO THROUGH FLOWLINE ACROSS SHALE SHAKER. SOLIDS WILL DROP INTO ROLL-OFF CONTAINERS WITH BAFFLES AS DRAWN ABOVE. BAFFLES SLOW FLUID VELOCITY TO ALLOW SOLIDS TO FALL DOWN THROUGH 6" AIR ACTUATED VALVES INTO ROLL-OFF CONTAINERS. CLEAN WATER GOES OUT BACK TO THE DRILLING FLUID STEEL PITS. SOLIDS ARE HAULED TO DISPOSAL. ANY LEFTOVER LIQUID WILL BE HAULED TO DISPOSAL.

BURNETT OIL CO., INC.

Operations and Maintenance

Closed Loop equipment will be inspected daily by each tour and any necessary maintenance performed.
 Any leak in system will be repaired and/or contained immediately.
 OCD notified within 48 hours
 Remediation process started

Closure Plan

During drilling operations all liquids, drilling fluids and cutting will be hauled off via CRO (Controlled Recovery Incorporated Permit R-9166.)