

## District I

1625 N. French Dr., Hobbs, NM 88240

## District II

1301 W. Grand Avenue, Artesia, NM 88210

## District III

1000 Rio Brazos Road, Aztec, NM 87410

## District IV

1220 S. St. Francis Dr., Santa Fe, NM 87505

State of New Mexico  
Energy Minerals and Natural Resources

Form C-101

June 16, 2001

## Oil Conservation Division

1220 South St. Francis Dr.

Santa Fe, NM 87505

Submit to appropriate District Office

☐ AMENDED REPORTAPPLICATION FOR PERMIT TO DRILL, RE-ENTER, DEEPEN,  
PLUGBACK, OR ADD A ZONE

<sup>1</sup> Operator Name and Address Lime Rock Resources A. L.P. 1111 Bagby Street, Suite 4600 Houston, TX 77002		<sup>2</sup> OGRID Number 255333 ✓
		<sup>3</sup> API Number 30-015-32509 ✓
<sup>3</sup> Property Code 305464 ✓	<sup>5</sup> Property Name Marathon 25 State ✓	
		<sup>6</sup> Well No. 31 ✓
<sup>9</sup> Proposed Pool 1 Red Lake QUEEN-GRAYBURG-SA		<sup>10</sup> Proposed Pool 2

<sup>7</sup> Surface Location

UL or lot no. C	Section 25	Township 17-S	Range 28-E	Lot Idn	Feet from the 990	North/South line North	Feet from the 2310	East/West line WEST	County EDDY
--------------------	---------------	------------------	---------------	---------	----------------------	------------------------------	-----------------------	------------------------	----------------

<sup>8</sup> Proposed Bottom Hole Location If Different From Surface

UL or lot no.	Section	Township	Range	Lot Idn	Feet from the	North/South line	Feet from the	East/West line	County
---------------	---------	----------	-------	---------	---------------	------------------	---------------	----------------	--------

## Additional Well Information

<sup>11</sup> Work Type Code N ✓	<sup>12</sup> Well Type Code O ✓	<sup>13</sup> Cable/Rotary ROTARY -	<sup>14</sup> Lease Type Code S ✓	<sup>15</sup> Ground Level Elevation 3684' ✓
<sup>16</sup> Multiple N ✓	<sup>17</sup> Proposed Depth 3,600' ✓	<sup>18</sup> Formation SAN ANDRES ✓	<sup>19</sup> Contractor UNITED DRILLING	<sup>20</sup> Spud Date 4/4/11

<sup>21</sup> Proposed Casing and Cement Program

Hole Size	Casing Size	Casing weight/foot	Setting Depth	Sacks of Cement	Estimated TOC
12 1/4"	8 5/8"	24#	450'	350 sx Cl C	Surface
7 7/8"	5 1/2"	14#	3,500'	400 Poz + 400 Lite	Surface

<sup>22</sup> Describe the proposed program. If this application is to DEEPEN or PLUG BACK, give the data on the present productive zone and proposed new productive zone. Describe the blowout prevention program, if any. Use additional sheets if necessary.

Drilling operations will utilize a closed loop mud system w/fresh water during surface hole and brine fluids after. BOP info attached. Plan to drill a 12-1/4" hole to approx. 450', then set and cement 8-5/8" casing to 450'. Class C cement will be circulated back to surface.

Drill 7 7/8" hole to TD of approx. 3500'. Run OH logs. Set 5 1/2" casing to TD and cement will be circulated back to surface. Perforate the San Andres interval. Stimulate as necessary for optimum production. Produce well by flowing or pumping.

H2S levels are not expected to high enough to require a H2S Contingency Plan

RECEIVED

FEB 14 2011

NMOOD ARTESIA

OIL CONSERVATION DIVISION

<sup>23</sup> I hereby certify that the information given above is true and complete to the best of my knowledge and belief.

Signature:

George R. Smith

Printed name

George R. Smith:

Title:

POA Agent for Lime Rock Resources A, L.P.

E-mail Address:

grsmith130@yahoo.com

Date:

February 10, 2011

Phone:

(575) 623-4940

Approved by:

Approved by: *Archie Roover*  
Title: *Geologist*

Approval Date:

3/2/2011

Expiration Date:

3/2/2013

Conditions of Approval Attached ☐

**BOP DIAGRAM  
3000# SYSTEM**

EXHIBIT "A"  
LIME ROCK RESOURCES A, L.P.  
BOP Specifications



UNITED DRILLING, INC.

LOCATION PLAT

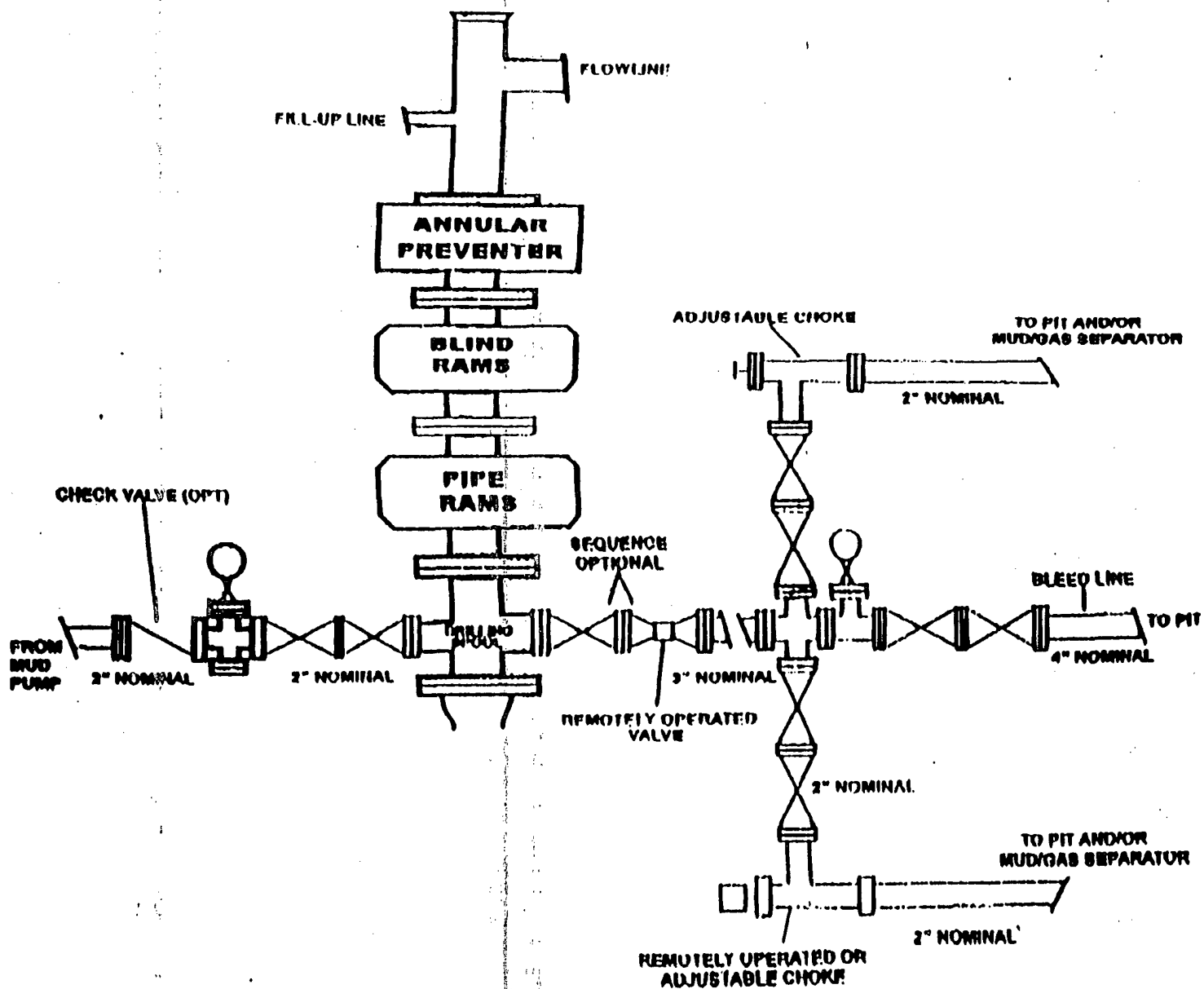
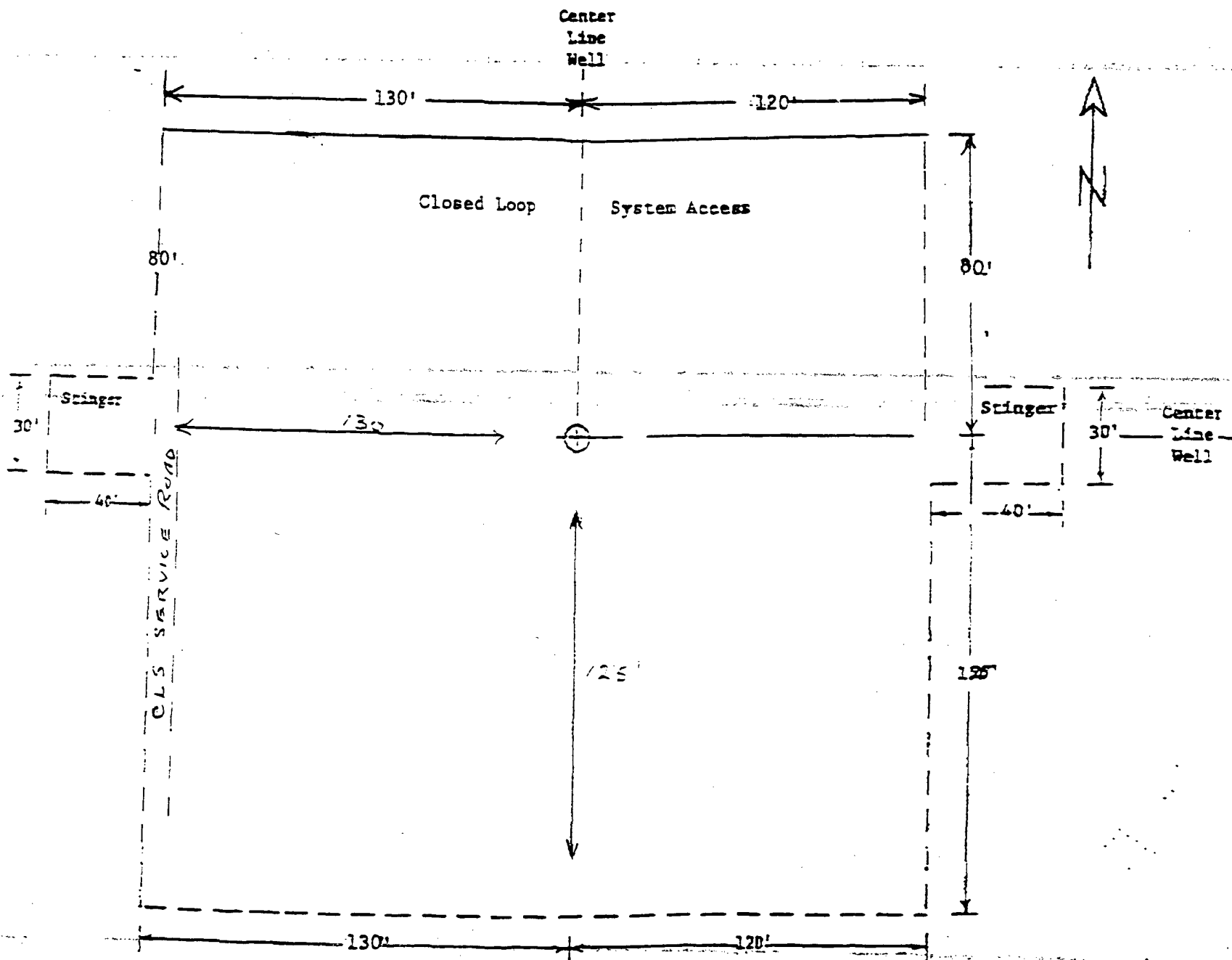
RIG