

UNITED STATES  
DEPARTMENT OF THE INTERIOR  
BUREAU OF LAND MANAGEMENTFORM APPROVED  
OMB No. 1004-0137  
Expires: July 31, 2010

## SUNDRY NOTICES AND REPORTS ON WELLS

**Do not use this form for proposals to drill or to re-enter an abandoned well. Use Form 3160-3 (APD) for such proposals.**5. Lease Serial No.  
NM-037489

6. If Indian, Allottee or Tribe Name

SUBMIT IN TRIPLICATE - Other instructions on page 2.

## 1. Type of Well

☒ Oil Well ☐ Gas Well ☐ Other2. Name of Operator  
DEVON ENERGY PRODUCTION COMPANY LP3a. Address  
PO BOX 250, ARTESIA, NM 882113b. Phone No. (include area code)  
575-748-33714. Location of Well (Footage, Sec., T., R., M., or Survey Description)  
330' FNL & 660' FEL, Unit A, SEC 34, T24s, R31E

7. If Unit of CA/Agreement, Name and/or No.

8. Well Name and No.  
Cotton Draw Unit #150H9. API Well No.  
30-015-3853610. Field and Pool or Exploratory Area  
Delaware; Brushy Canyon11. Country or Parish, State  
Eddy County, New Mexico

## 12. CHECK THE APPROPRIATE BOX(ES) TO INDICATE NATURE OF NOTICE, REPORT OR OTHER DATA

TYPE OF SUBMISSION	TYPE OF ACTION			
<input checked="" type="checkbox"/> Notice of Intent	<input type="checkbox"/> Acidize	<input type="checkbox"/> Deepen	<input type="checkbox"/> Production (Start/Resume)	<input type="checkbox"/> Water Shut-Off
<input type="checkbox"/> Subsequent Report	<input type="checkbox"/> Alter Casing	<input type="checkbox"/> Fracture Treat	<input type="checkbox"/> Reclamation	<input type="checkbox"/> Well Integrity
<input type="checkbox"/> Final Abandonment Notice	<input type="checkbox"/> Casing Repair	<input type="checkbox"/> New Construction	<input type="checkbox"/> Recomplete	<input checked="" type="checkbox"/> Other
	<input type="checkbox"/> Change Plans	<input type="checkbox"/> Plug and Abandon	<input type="checkbox"/> Temporarily Abandon	Construct
	<input type="checkbox"/> Convert to Injection	<input type="checkbox"/> Plug Back	<input type="checkbox"/> Water Disposal	Road

13. Describe Proposed or Completed Operation: Clearly state all pertinent details, including estimated starting date of any proposed work and approximate duration thereof. If the proposal is to deepen directionally or recompleat horizontally, give subsurface locations and measured and true vertical depths of all pertinent markers and zones. Attach the Bond under which the work will be performed or provide the Bond No. on file with BLM/BIA. Required subsequent reports must be filed within 30 days following completion of the involved operations. If the operation results in a multiple completion or recompleat in a new interval, a Form 3160-4 must be filed once testing has been completed. Final Abandonment Notices must be filed only after all requirements, including reclamation, have been completed and the operator has determined that the site is ready for final inspection.)

Devon Energy requests approval to construct approximately 900' x 20' wide access road from the Cotton Draw Unit #150 east to the Cotton Draw Unit #151. (Please see attached plat)

We are in the process of drilling the Cotton Draw Unit #156, have constructed the Cotton Draw Unit #155, and are currently constructing the Cotton Draw Unit #152 and the Cotton Draw Unit #151.

We have equipment in the field and would therefore appreciate a quick review. Thank you

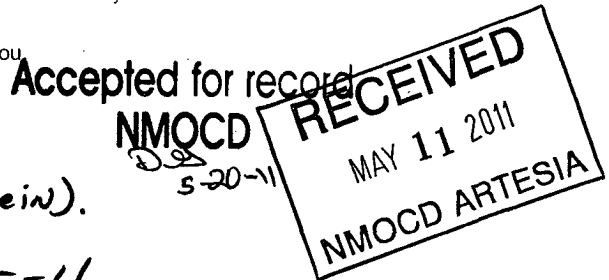

14. I hereby certify that the foregoing is true and correct. Name (Printed/Typed)

Joe Lara, 575-748-0163

Title Engineer

Signature

Date

5/05/11

## THIS SPACE FOR FEDERAL OR STATE OFFICE USE

Approved by

Conditions of approval, if any, are attached. Approval of this notice does not warrant or certify that the applicant holds legal or equitable title to those rights in the subject lease which would entitle the applicant to conduct operations thereon.

Title

BLM Carlsbad Field Office

Date

Title 18 U.S.C. Section 1001 and Title 43 U.S.C. Section 1212, make it a crime for any person knowingly and willfully to make to any department or agency of the United States any false, fictitious or fraudulent statements or representations as to any matter within its jurisdiction.

(Instructions on page 2)

SECTION 34, TOWNSHIP 24 SOUTH, RANGE 31 EAST, N.M.P.M.  
EDDY COUNTY, STATE OF NEW MEXICO

# LOCATION VERIFICATION MAP

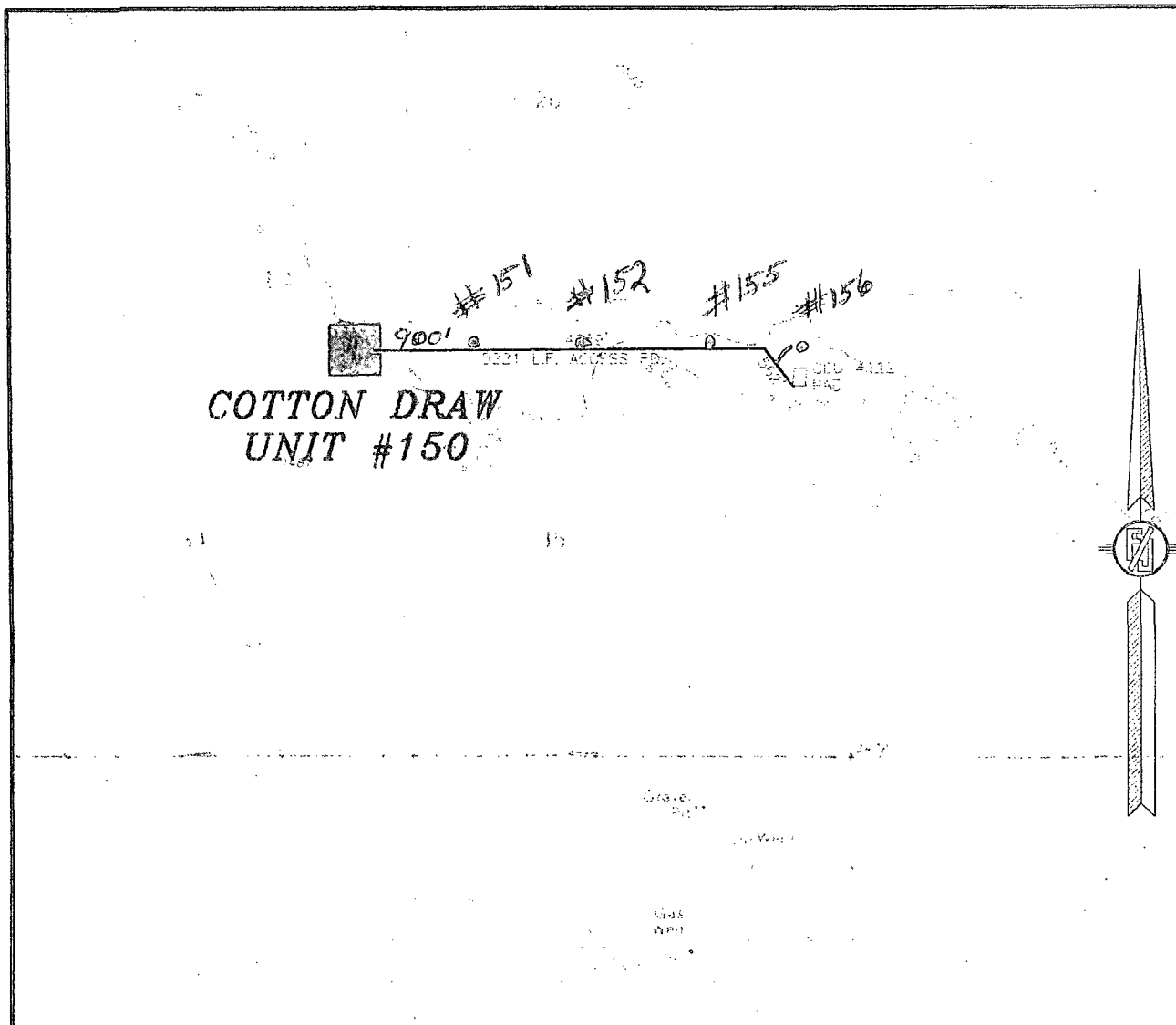

CONTOUR INTERVAL:  
BIG SINKS  
PADUCA BREAKS

NOT TO SCALE

DEVON ENERGY PRODUCTION COMPANY, L.P.  
**COTTON DRAW UNIT #150**  
LOCATED 330 FT. FROM THE NORTH LINE  
AND 660 FT. FROM THE EAST LINE OF  
SECTION 34, TOWNSHIP 24 SOUTH,  
RANGE 31 EAST, N.M.P.M.  
EDDY COUNTY, STATE OF NEW MEXICO

NOVEMBER 24, 2010

SURVEY NO. 229-R1

MADRON SURVEYING, INC. CARLSBAD, NEW MEXICO

SECTION 34, TOWNSHIP 24 SOUTH, RANGE 31 EAST, N.M.P.M.  
EDDY COUNTY, STATE OF NEW MEXICO

# LOCATION VERIFICATION MAP

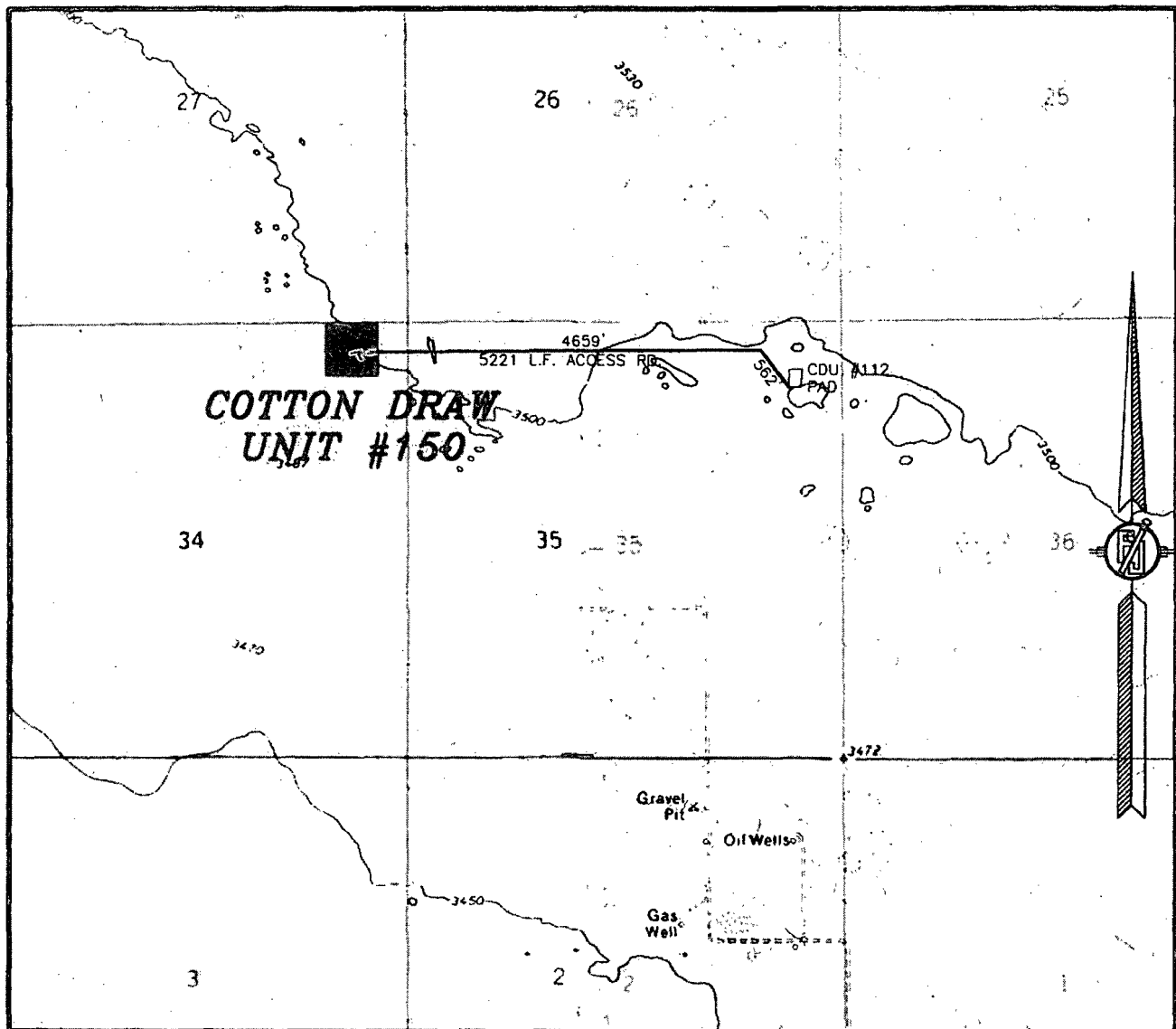

CONTOUR INTERVAL:  
BIG SINKS  
PADUCA BREAKS

NOT TO SCALE

DEVON ENERGY PRODUCTION COMPANY, L.P.  
**COTTON DRAW UNIT #150**

LOCATED 330 FT. FROM THE NORTH LINE  
AND 660 FT. FROM THE EAST LINE OF  
SECTION 34, TOWNSHIP 24 SOUTH,  
RANGE 31 EAST, N.M.P.M.  
EDDY COUNTY, STATE OF NEW MEXICO

NOVEMBER 24, 2010

SURVEY NO. 229-R1

MADRON SURVEYING, INC. 301 SOUTH CANAL CARLSBAD, NEW MEXICO  
(575) 887-5830