

**DISTRICT I**

1620 N. French Dr., Hobbs, NM 88240

**DISTRICT II**

611 South First, Artesia, NM 88210

**DISTRICT III**

1060 E. Brown Rd., Artesia, NM 87410

**DISTRICT IV**

2040 South Pacheco, Santa Fe, NM 87505

**State of New Mexico**

Energy, Minerals and Natural Resources Department

Form C-102

Revised March 17, 1998

Submit to Appropriate District Office

State Lease - 4 Copies

Fee Lease - 3 Copies

**OIL CONSERVATION DIVISION**

2040 South Pacheco

Santa Fe, New Mexico 87504-2088

☐ AMENDED REPORT**WELL LOCATION AND ACREAGE DEDICATION PLAT**

API Number 30-015-33164	Pool Code 72122	Pool Name BIG SINKS;WOLFCAMP (GAS)
Property Code 001796	Property Name POKER LAKE UNIT	Well Number 196
OSRD No. 001801	Operator Name BASS ENTERPRISES PRODUCTION COMPANY	Elevation 3456'

**Surface Location**

UL or lot No.	Section	Township	Range	Lot Mn	Feet from the	North/South line	Feet from the	East/West line	County
K	29	24 S	31 E		2055	SOUTH	2335	WEST	EDDY

**Bottom Hole Location If Different From Surface**

UL or lot No.	Section	Township	Range	Lot Idn	Feet from the	North/South line	Feet from the	East/West line	County

Dedicated Acres	Joint or Infill	Consolidation Code	Order No.
320	I		

NO ALLOWABLE WILL BE ASSIGNED TO THIS COMPLETION UNTIL ALL INTERESTS HAVE BEEN CONSOLIDATED  
OR A NON-STANDARD UNIT HAS BEEN APPROVED BY THE DIVISION

**OPERATOR CERTIFICATION**

I hereby certify the information contained herein is true and complete to the best of my knowledge and belief.

*Tami Wilber*  
Signature

TAMI WILBER

Printed Name

PRODUCTION CLERK

Title

2/25/04

Date

**SURVEYOR CERTIFICATION**

I hereby certify that the well location shown on this plat was plotted from field notes of actual surveys made by me or under my supervision, and that the same is true and correct to the best of my belief.

OCTOBER 18, 2001

Date  
Signature & Seal of  
Professional Surveyor

7977  
W.C. No.

Correlation No. 7977 Jones 7977

HARRIS SURVEYS

LAT - N32°11'11.4"  
LONG - W103°48'03.2"  
(NAD83)

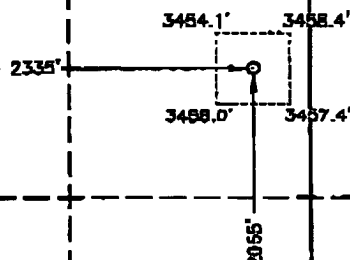

BASS ENTERPRISES PRODUCTION CO.

201 MAIN ST.  
FORT WORTH, TEXAS 76102-3131  
817/390-8400

March 3, 2004

**MAIL / FAX TRANSMITTAL (505) 748-9720**

Mr. Tim Gum  
New Mexico Oil Conservation Division  
1301 W. Grand Avenue  
Artesia, New Mexico 88210

Re: Poker Lake Unit No. 196  
Big Sinks - Wolfcamp (Gas) Field  
2,055 FSL, 2,325 FWL  
Section 29, T24S-R31E  
Poker Lake Unit  
Eddy County, New Mexico

RECEIVED  
MAR - 8 2004  
OCD-ARTESIA

Dear Tim:

This will acknowledge our conversation of this date concerning the non-standard location for the above well. As we discussed, the well was originally permitted for the Morrow Formation, however the well was drilled to the Wolfcamp Formation and has been completed as a gas producer in the Wolfcamp. Apparently the non-standard location authorization was issued by Mr. Stogner for the Morrow Formation, which was its original permitted depth. Therefore, Mr. Jim Bruce will ask Mr. Stogner to execute an amended non-standard location approval to affect the Wolfcamp Formation as soon as possible. As we discussed, Bass is the owner of all leases offsetting the proration unit for the subject well. By copy of this letter, Mr. Bruce will be asked to provide you with a copy of the amended non-standard authorization. Thank you very much and should you have any questions or comments in the above regard, please advise the undersigned at (817) 390-8671.

Very truly yours,

  
J. Wayne Bailey

JWB:ca

cc: Mr. Jim Bruce  
369 Montezuma  
Santa Fe, New Mexico 87501