

RECEIVED

NOTICE OF INTENTION TO DRILL MAR 2 1960

Notice must be given to the District Office of the Oil Conservation Commission and approval obtained before drilling or recompletion begins. If changes in the proposed plan are considered advisable, a copy of this notice showing such changes will be returned to the sender. Submit this notice in **QUINTUPLICATE**. One copy will be returned following approval. See additional instructions in Rules and Regulations of the Commission. **If State Land submit 6 Copies Attach Form O- 128 in triplicate to first 3 copies of form O-101**

Roswell, New Mexico
 (Place)

March 1, 1960
 (Date)

OIL CONSERVATION COMMISSION
 SANTA FE, NEW MEXICO

30-005-00238

Gentlemen:

You are hereby notified that it is our intention to commence the Drilling of a well to be known as
Steinberger Drilling Company

(Company or Operator)

Superior State

(Lease)

Well No. 1

in P

(Unit)

The well is

located 660 feet from the South line and 660 feet from the

East

line of Section 34

T. 8-S

R. 27-E

NMPM.

(GIVE LOCATION FROM SECTION LINE)

Wildcat
Undesignated Pool,

Chaves County

If State Land the Oil and Gas Lease is No. E-3487

If patented land the owner is.....

Address.....

We propose to drill well with drilling equipment as follows:

Rotary

The status of plugging bond is \$10,000.00 Blanket

Drilling Contractor Steinberger Drilling Company

We intend to complete this well in the Queen Sand

formation at an approximate depth of 850 feet.

CASING PROGRAM

We propose to use the following strings of Casing and to cement them as indicated:

Size of Hole	Size of Casing	Weight per Foot	New or Second Hand	Depth	Sacks Cement
8-5/8"	7"	24	Used	20'	5

If changes in the above plans become advisable we will notify you immediately.

ADDITIONAL INFORMATION (If recompletion give full details of proposed plan of work.)

**850 feet of 4 1/2" pipe will be used in case of production.
 Circulated cement.**

MAR 2 1960

Approved....., 19.....
 Except as follows:

Sincerely yours,

Steinberger Drilling Company
 (Company or Operator)

By A. Steinberger

Position Co-Owner

Send Communications regarding well to

Name.....

Address.....

OIL CONSERVATION COMMISSION

By M.L. Armstrong

RECEIVED

NEW MEXICO OIL CONSERVATION COMMISSION
WELL LOCATION AND ACREAGE DEDICATION PLAT

MAR 2

FORM C-128
Revised 5/1/57
1960

SEE INSTRUCTIONS FOR COMPLETING THIS FORM ON THE REVERSE SIDE

SECTION A

Operator Steinberger Drilling Co.		Lease Superior State		Well No. 1
Unit Letter P	Section 34	Township 8 S	Range 27 E	County Chaves
Actual Footage Location of Well: 660 feet from the South line and 660 feet from the East line				
Ground Level Elev. 3959	Producing Formation Queen	Pool Vildont	Dedicated Acreage: 40 Acres	

1. Is the Operator the only owner in the dedicated acreage outlined on the plat below? YES NO ("Owner" means the person who has the right to drill into and to produce from any pool and to appropriate the production either for himself or for himself and another. (65-3-29 (e) NMSA 1935 Comp.)
2. If the answer to question one is "no," have the interests of all the owners been consolidated by communitization agreement or otherwise? YES NO . If answer is "yes," Type of Consolidation _____
3. If the answer to question two is "no," list all the owners and their respective interests below:

Owner	Land Description

SECTION B

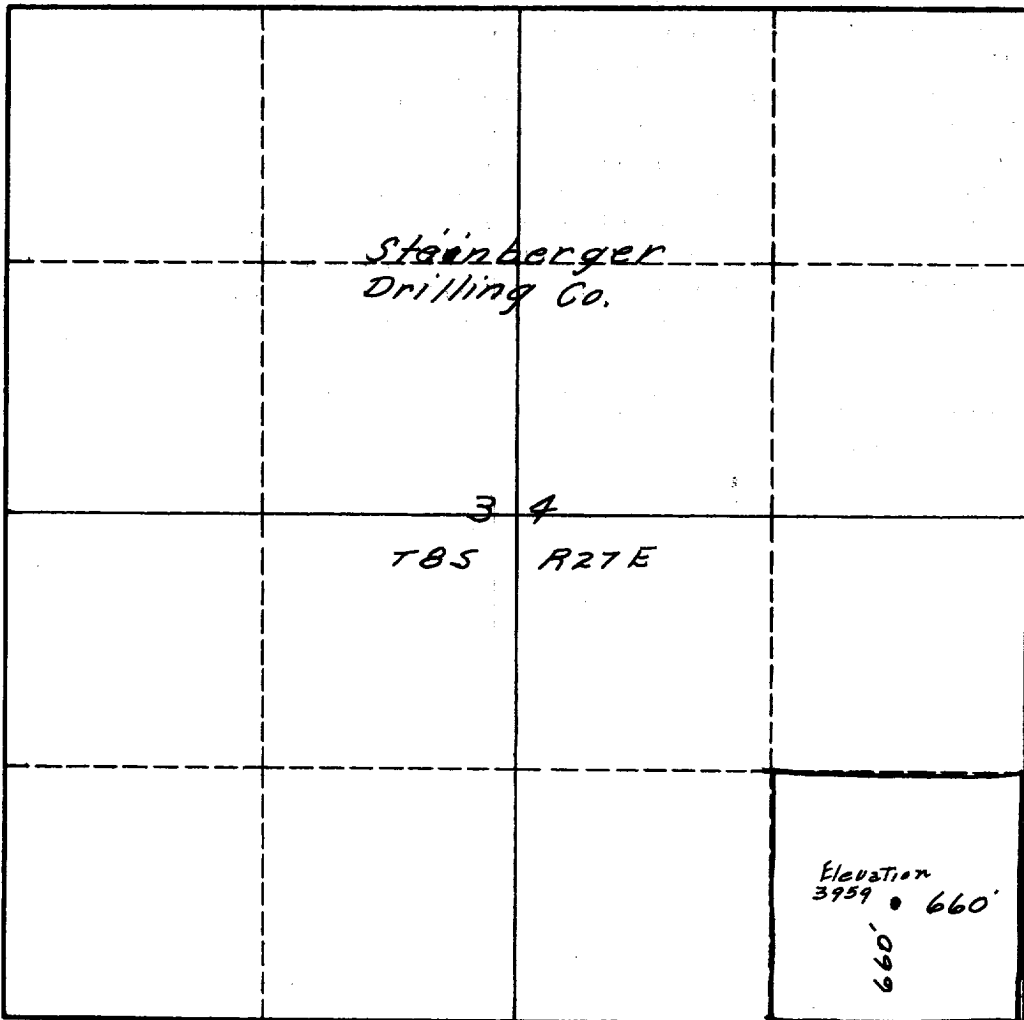

CERTIFICATION

I hereby certify that the information in SECTION A above is true and complete to the best of my knowledge and belief.

Steinberger
Name

Position
Co-Owner

Company
Steinberger Drilling Co.

Date
March 1, 1960

I hereby certify that the well location shown on the plat in SECTION B was plotted from field notes of actual surveys made by me or under my supervision, and that the same is true and correct to the best of my knowledge and belief.

Date Surveyed
Feb-29-1960

Registered Professional Engineer and/or Land Surveyor
Wann Engineering Co.
By: Kayrus J. [Signature]

Certificate No.
1697

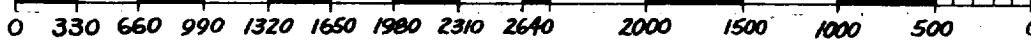

INSTRUCTIONS FOR COMPLETION OF FORM C-128

1. Operator shall furnish and certify to the information called for in Section A.
2. Operator shall outline the dedicated acreage for *both* oil and gas wells on the plat in Section B.
3. A registered professional engineer or land surveyor registered in the State of New Mexico or approved by the Commission shall show on the plat the location of the well and certify this information in the space provided.
4. All distances shown on the plat must be from the outer boundaries of the Section.
5. If additional space is needed for listing owners and their respective interests as required in question 3 of Section A, please use space below.

OIL CONSERVATION COMMISSION	
ARTESIA DISTRICT OFFICE	
No. Copies Received	6
DISTRIBUTION	
OPERATOR	1
SANTA FE	1
PROBATION	1
STATE LAND	1
UTB/ENR	2
TRANS.	
FILE	1
STAMP	✓

RECEIVED

STEINBERGER DRILLING CO.

BOX 1137

ROSWELL, NEW MEXICO

March 2, 1960

MAR 3 1960

O. C. C.
ARTESIA, OFFICE

H. J. STEINBERGER
KATHERINE STEINBERGER
~~W. J. STEINBERGER~~

Oil Conservation Commission
Carper Building
Artesia, New Mexico

RE: Steinberger-Superior #1
State Lease # E-3486
NE/NE 7/10/27
Chaves Count, N M

Gentlemen:

The enclosed form C-102 is herewith submitted for your approval and advice.

We hope our judgement is correct in using this form to advise your office of the progress of the well at the above location.

Very truly yours

STEINBERGER DRILLING CO.

Helen Jansen
BY (Mrs.) Helen Jansen

Encls.

*C-103
after this*