

NO. OF COPIES RECEIVED		
DISTRIBUTION		
SANTA FE	✓	
FILE	✓	✓
U.S.O.S.		
LAND OFFICE		
OPERATOR	✓	

RECEIVED

MAY 31 1983

5a. Indicate Type of Lease
State ☐ Fee ☒

5. State Oil & Gas Lease No.
N. A.

SUNDRY NOTICES AND REPORTS ON WELLS

(DO NOT USE THIS FORM FOR PROPOSALS TO DRILL OR TO DEEPEN OR PLUG BACK TO A DIFFERENT RESERVOIR.
USE "APPLICATION FOR PERMIT --" (FORM C-101) FOR SUCH PROPOSALS.)

Q. C. D.

~~ARTESIA, OFFICE~~

1. <input checked="" type="checkbox"/> OIL WELL <input type="checkbox"/> GAS WELL <input type="checkbox"/> OTHER-		ARTESIA, OFFICE		7. Unit Agreement Name N.A.	
2. Name of Operator BILL G. ISLER ✓ 505-622-1529				8. Farm or Lease Name Isler	
3. Address of Operator 123 Three Cross, Roswell, New Mexico 88201				9. Well No. 1	
4. Location of Well UNIT LETTER <u>A</u> , <u>330</u> FEET FROM THE <u>North</u> LINE AND <u>330</u> FEET FROM THE <u>East</u> LINE, SECTION <u>29</u> TOWNSHIP <u>10S</u> RANGE <u>28E</u> N.M.P.M.				10. Field and Pool, or Wildcat L.E. Ranch-San Andre	
15. Elevation (Show whether DF, RT, GR, etc.) 3741' Tubing Head				12. County Chaves	

Check Appropriate Box To Indicate Nature of Notice, Report or Other Data

NOTICE OF INTENTION TO:	SUBSEQUENT REPORT
<input type="checkbox"/> (a) Obtain information	<input type="checkbox"/> (a) Obtain information
<input type="checkbox"/> (b) Obtain information	<input type="checkbox"/> (b) Obtain information
<input type="checkbox"/> (c) Obtain information	<input type="checkbox"/> (c) Obtain information
<input type="checkbox"/> (d) Obtain information	<input type="checkbox"/> (d) Obtain information
<input type="checkbox"/> (e) Obtain information	<input type="checkbox"/> (e) Obtain information
<input type="checkbox"/> (f) Obtain information	<input type="checkbox"/> (f) Obtain information
<input type="checkbox"/> (g) Obtain information	<input type="checkbox"/> (g) Obtain information
<input type="checkbox"/> (h) Obtain information	<input type="checkbox"/> (h) Obtain information
<input type="checkbox"/> (i) Obtain information	<input type="checkbox"/> (i) Obtain information
<input type="checkbox"/> (j) Obtain information	<input type="checkbox"/> (j) Obtain information
<input type="checkbox"/> (k) Obtain information	<input type="checkbox"/> (k) Obtain information
<input type="checkbox"/> (l) Obtain information	<input type="checkbox"/> (l) Obtain information
<input type="checkbox"/> (m) Obtain information	<input type="checkbox"/> (m) Obtain information
<input type="checkbox"/> (n) Obtain information	<input type="checkbox"/> (n) Obtain information
<input type="checkbox"/> (o) Obtain information	<input type="checkbox"/> (o) Obtain information
<input type="checkbox"/> (p) Obtain information	<input type="checkbox"/> (p) Obtain information
<input type="checkbox"/> (q) Obtain information	<input type="checkbox"/> (q) Obtain information
<input type="checkbox"/> (r) Obtain information	<input type="checkbox"/> (r) Obtain information
<input type="checkbox"/> (s) Obtain information	<input type="checkbox"/> (s) Obtain information
<input type="checkbox"/> (t) Obtain information	<input type="checkbox"/> (t) Obtain information
<input type="checkbox"/> (u) Obtain information	<input type="checkbox"/> (u) Obtain information
<input type="checkbox"/> (v) Obtain information	<input type="checkbox"/> (v) Obtain information
<input type="checkbox"/> (w) Obtain information	<input type="checkbox"/> (w) Obtain information
<input type="checkbox"/> (x) Obtain information	<input type="checkbox"/> (x) Obtain information
<input type="checkbox"/> (y) Obtain information	<input type="checkbox"/> (y) Obtain information
<input type="checkbox"/> (z) Obtain information	<input type="checkbox"/> (z) Obtain information

1. PERFORM REMEDIAL WORK	<input checked="" type="checkbox"/>	3. PLUG AND ABANDON	<input type="checkbox"/>	5. REMEDIAL WORK	<input type="checkbox"/>	7. ALTERING CASING	<input type="checkbox"/>
2. TEMPORARILY ABANDON	<input type="checkbox"/>			6. COMMENCE DRILLING OPNS.	<input type="checkbox"/>	8. PLUG AND ABANDONMENT	<input type="checkbox"/>
4. PULL OR ALTER CASING	<input type="checkbox"/>	3. CHANGE PLANS	<input type="checkbox"/>	5. CASING TEST AND CEMENT JOBS	<input type="checkbox"/>		
OTHER <u>Change Operator</u>	<input type="checkbox"/>			OTHER _____	<input type="checkbox"/>		

17. Describe Proposed or Completed Operations (Clearly state all pertinent details, and give pertinent dates, including estimated date of starting any proposed work) SEE RULE 1103.

This well was completed as a San Andres oil well on March 15, 1963 and has been temporarily abandoned since December 5, 1969.

Present casing: 8-5/8" set at 373' and cemented with 140 sx
5-1/2" set at 2375' and cemented with 100 sx

It is proposed to:

1. Change operator to BILL G. ISLER and well name to No.1 Isler.
2. Conduct operations under operators One-Well Bond No. 3SE-593722.
3. Run 2-3/8" tubing to approximately 2340'.
4. Clean out hole and acidize present perforations, 2089' to 96', 2276' to 82' and 2332' to 42'.
5. Run rods and metal-to-metal pump.
6. Test by pumping.
7. Produce to tanks.

10. I hereby certify that the information above is true and complete to the best of my knowledge and belief.

SIGNED

TITLE Agent

DATE May 21, 1983

Original Signed By

Leslie A. Clements

Supervisor District II

DATE JUN 02 1983

APPROVED BY

E. CONDITIONS OF APPROVAL, IF ANY:

NEW MEXICO OIL CONSERVATION COMMISSION
WELL LOCATION AND ACREAGE DEDICATION PLAT

Form C-102
Supersedes C-128
Effective 1-1-65

All distances must be from the outer boundaries of the Section.

Operator BILL G. ISLER			Lease Isler		Well No. 1
Unit Letter A	Section 29	Township 10S	Range 28E	County Chaves	
Actual Footage Location of Well: <div style="display: flex; justify-content: space-between;"> 330 feet from the North line and 330 feet from the East line Sec. 29 </div>					
Ground Level Elev.	Producing Formation San Andres		Pool L.E. Ranch-San Andres		Dedicated Acreage: 40 Acres

1. Outline the acreage dedicated to the subject well by colored pencil or hachure marks on the plat below.
2. If more than one lease is dedicated to the well, outline each and identify the ownership thereof (both as to working interest and royalty). SINGLE LEASE
3. If more than one lease of different ownership is dedicated to the well, have the interests of all owners been consolidated by communitization, unitization, force-pooling, etc?

☐ Yes ☐ No If answer is "yes," type of consolidation _____

If answer is "no," list the owners and tract descriptions which have actually been consolidated. (Use reverse side of this form if necessary.) _____

No allowable will be assigned to the well until all interests have been consolidated (by communitization, unitization, forced-pooling, or otherwise) or until a non-standard unit, eliminating such interests, has been approved by the Commission.

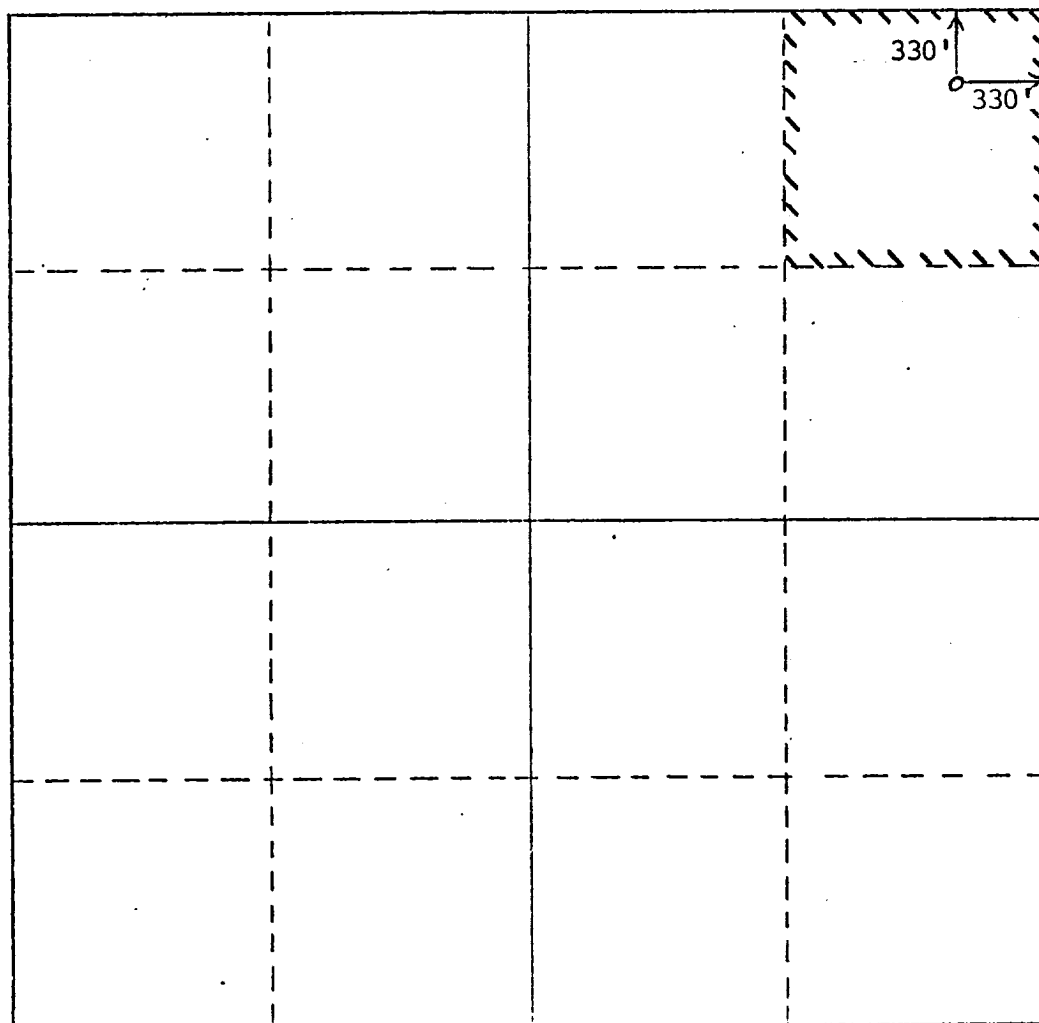

CERTIFICATION

I hereby certify that the information contained herein is true and complete to the best of my knowledge and belief.

Jerry W. Long
Name
JERRY W. LONG

Position
Agent

Company
BILL G. ISLER

Date
May 21, 1983

I hereby certify that the well location shown on this plat was plotted from field notes of actual surveys made by me or under my supervision, and that the same is true and correct to the best of my knowledge and belief.

See original plat in
NMOCd file.

Date Surveyed

Registered Professional Engineer
and/or Land Surveyor

Certificate No.

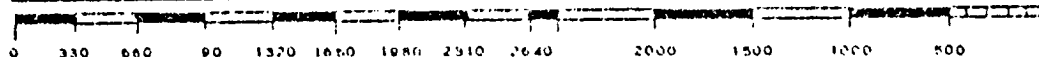

30x60 MINUTE SERIES (TOPOGRAPHIC)

BILL G. ISLER

NO. 1 ISLER

330' /N 330' /E Sec. 29-10S-28E
CHAVES CO., N.M.

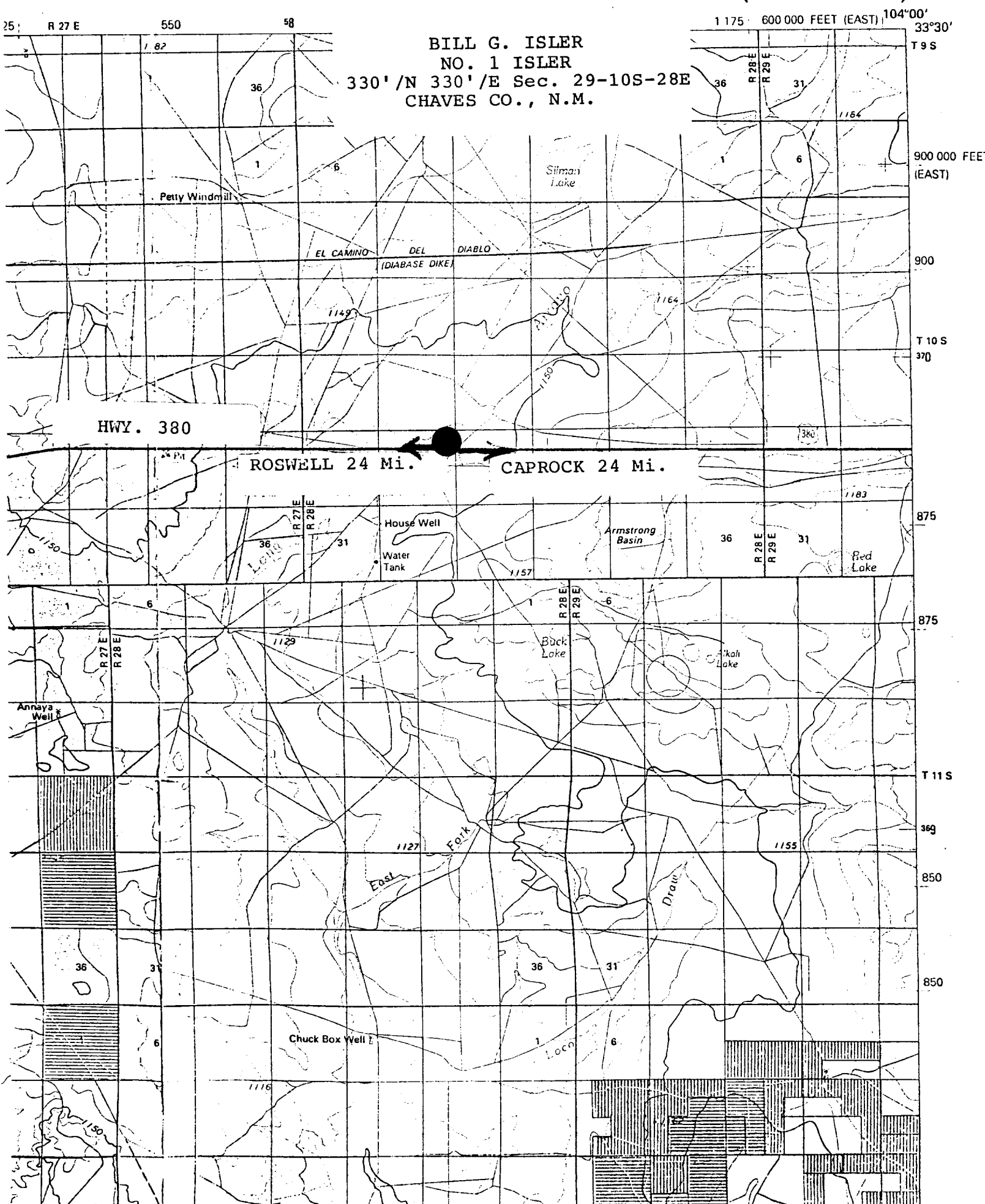

BILL G. ISLER
NO. 1 ISLER
NENE SEC. 29-105-24E

12

7

8

2326

2500

KLABZUBA

13

18

17

16

2435

2
(SWD)

State

DRESSER

2504

24

19

20

21

Christman

1250

2340

13

5

4

2

De KALE

2
2505

2560

25

30

29

28

2
1460

White

2270

3

36

31

32

33

2500

State