

| | |
|------------------------|---|
| NO. OF COPIES RECEIVED | 7 |
| DISTRIBUTION | |
| SANTA FE | 1 |
| FILE | 1 |
| U.S.G.S. | 2 |
| LAND OFFICE | 7 |
| OPERATOR | 2 |

NEW MEXICO OIL CONSERVATION COMMISSION

30-005-10488
Form C-101
Revised 1-1-65

5A. Indicate Type of Lease
STATE FEE
5. State Oil & Gas Lease No.
K 1006

APPLICATION FOR PERMIT TO DRILL, DEEPEN, OR PLUG BACK

1a. Type of Work
DRILL DEEPEN PLUG BACK
b. Type of Well
OIL WELL GAS WELL OTHER SINGLE ZONE MULTIPLE ZONE

2. Name of Operator
MR. SAN G. BUNN

3. Address of Operator
POST OFFICE BOX 192, ARTESIA, NEW MEXICO

4. Location of Well
UNIT LETTER **L** LOCATED **1650** FEET FROM THE **SOUTH** LINE
AND **990** FEET FROM THE **WEST** LINE OF SEC. **4** TWP. **8S** RGE. **27E** NMPM

7. Unit Agreement Name
8. Farm or Lease Name
AVALANCHE JOURNAL ST.

9. Well No.
6

10. Field and Pool, or Wildcat
acmt
UND. SAN ANDRES

12. County
CHAVEZ

19. Proposed Depth
2000

19A. Formation
San Andres

20. Rotary or C.T.
ROTARY

21. Elevations (Show whether DF, RT, etc.)
3960

21A. Kind & Status Plug. Bond
BLANKET

21B. Drilling Contractor
SELF

22. Approx. Date Work will start
7-21-66

23. PROPOSED CASING AND CEMENT PROGRAM

| SIZE OF HOLE | SIZE OF CASING | WEIGHT PER FOOT | SETTING DEPTH | SACKS OF CEMENT | EST. TOP |
|--------------|----------------|-----------------|---------------|-----------------|----------|
| 11 | 8 5/8 | 260 | 250 | 150 | |
| 7 7/8 | 5 1/2 | 170 | 2000 | 250 | |

CEMENT CIRCULATED 250' OF 8 5/8 CASING THEN DRILL TO APPROX. 2000 THROUGH ACME SAN ANDRES SECTION. CIRCULATE CEMENT WITH 250 SACKS. WILL DRILL 8 7 7/8 HOLE TO CORE POINT. WILL CORE ACME SAN ANDRES. WILL RUN 5 1/2 170 CASING. CEMENT WITH 250 SACKS.

RECEIVED

APPROVAL VALID
FOR 90 DAYS UNLESS
DRILLING COMMENCED,

EXPIRES 10-17-66

JUL 20 1966

O. C. C.
ARTESIA, OFFICE

IN ABOVE SPACE DESCRIBE PROPOSED PROGRAM: IF PROPOSAL IS TO DEEPEN OR PLUG BACK, GIVE DATA ON PRESENT PRODUCTIVE ZONE AND PROPOSED NEW PRODUCTIVE ZONE. GIVE BLOWOUT PREVENTER PROGRAM, IF ANY.

I hereby certify that the information above is true and complete to the best of my knowledge and belief.

Signed Thelma Hall Title AGENT Date 7-19-66

(This space for State Use)

APPROVED BY M.L. Armstrong TITLE OIL AND GAS INSPECTOR DATE JUL 20 1966

CONDITIONS OF APPROVAL, IF ANY:

NEW MEXICO OIL CONSERVATION COMMISSION
WELL LOCATION AND ACREAGE DEDICATION PLAT

Form C-102
Supersedes C-128
Effective 1-1-65

All distances must be from the outer boundaries of the Section.

| | | | | | |
|---|--|--|---------------------------------------|-------------------------|----------------------|
| Operator Dr. Sam G. Dunn | | Lease Avalanch-Journal STATE | | | Well No. 6 |
| Unit Letter L | Section 4 | Township 8 South | Range 27 East | County Chaves | |
| Actual Footage Location of Well: 1650 feet from the South line and 990 feet from the West line | | | | | |
| Ground Level Elev: 3969 | Producing Formation SAN ANDRES | Pool UND ACME SAN ANDRES | Dedicated Acreage: 40 Acres | | |

- Outline the acreage dedicated to the subject well by colored pencil or hachure marks on the plat below.
- If more than one lease is dedicated to the well, outline each and identify the ownership thereof (both as to working interest and royalty).
- If more than one lease of different ownership is dedicated to the well, have the interests of all owners been consolidated by communitization, unitization, force-pooling, etc?

RECEIVED

JUL 20 1966

Yes No If answer is "yes," type of consolidation _____
If answer is "no," list the owners and tract descriptions which have actually been consolidated (use reverse side of this form if necessary.) _____

D. G. C. ARTERIA, OFFICIAL

No allowable will be assigned to the well until all interests have been consolidated (by communitization, unitization, forced-pooling, or otherwise) or until a non-standard unit, eliminating such interests, has been approved by the Commission.

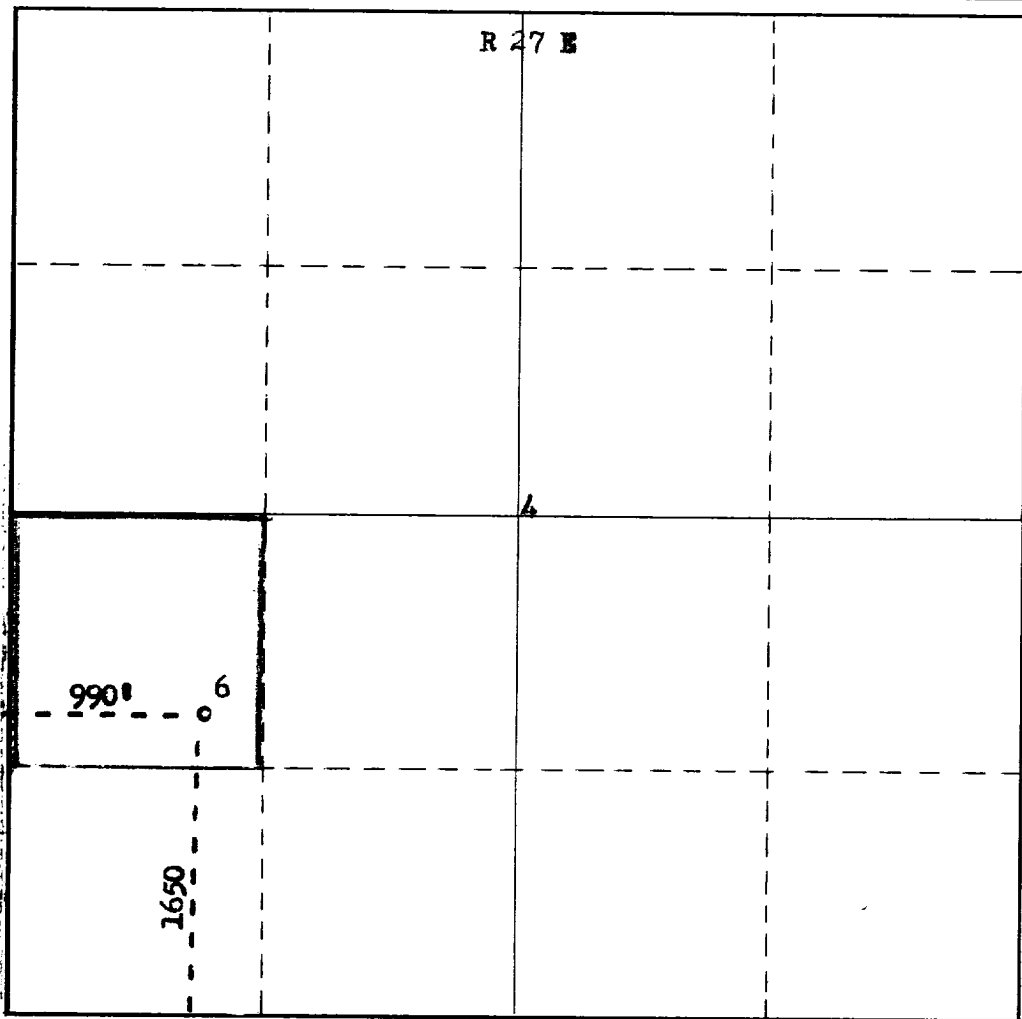

CERTIFICATION

I hereby certify that the information contained herein is true and complete to the best of my knowledge and belief.

Name
Helma Hall

Position
Agent

Company
Dr. Sam G. Dunn

Date
7-19-66

I hereby certify that the well location shown on this plat was plotted from field notes of actual surveys made by me or under my supervision, and that the same is true and correct to the best of my knowledge and belief.

Date Surveyed
June 28th 1966

Registered Professional Engineer and/or Land Surveyor
James H. Brown

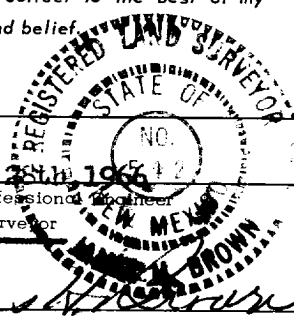

Certificate No. _____
N.M.L.S. No. 542

60 00 1-3

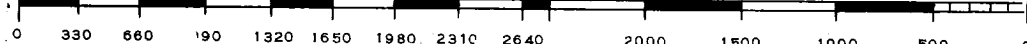

100

100

100

100

100

100

