

NO. OF COPIES RECEIVED	6
DISTRIBUTION	
SANTA FE	1
FILE	1
U.S.G.S.	2
LAND OFFICE	1
OPERATOR	1

RECEIVED
NEW MEXICO OIL CONSERVATION COMMISSION
JAN 29 1979

O. C. C.
ARTESIA, OFFICE

30-005-60544
Form C-101
Revised 1-1-65

5A. Indicate Type of Lease STATE <input checked="" type="checkbox"/> FEE <input type="checkbox"/>
5. State Oil & Gas Lease No. L-2464

APPLICATION FOR PERMIT TO DRILL, DEEPEN, OR PLUG BACK

1a. Type of Work b. Type of Well OIL WELL <input type="checkbox"/> GAS WELL <input checked="" type="checkbox"/> OTHER <input type="checkbox"/>		DRILL <input checked="" type="checkbox"/> DEEPEN <input type="checkbox"/> PLUG BACK <input type="checkbox"/>		SINGLE ZONE <input checked="" type="checkbox"/> MULTIPLE ZONE <input type="checkbox"/>	
2. Name of Operator McClellan Oil Corporation				7. Unit Agreement Name	
3. Address of Operator P.O. Box 848, Roswell, New Mexico 88210				8. Farm or Lease Name Tolmac	
4. Location of Well UNIT LETTER P LOCATED 660' FEET FROM THE South LINE AND 660' FEET FROM THE East LINE OF SEC. 36 TWP. 9-S RGE. 25-E NMPM				9. Well No. 1	
				10. Field and Pool, or Wildcat Wildcat also	
				12. County Chaves	
19. Proposed Depth 4500'		19A. Formation Abo		20. Rotary or C.T. Rotary	
21. Elevations (Show whether DI, RT, etc.) 3663 GL		21A. Kind & Status Plug. Bond Statewide		22. Approx. Date Work will start 2/16/79	

23.

PROPOSED CASING AND CEMENT PROGRAM

SIZE OF HOLE	SIZE OF CASING	WEIGHT PER FOOT	SETTING DEPTH	SACKS OF CEMENT	EST. TOP
* 16"	12 3/4"	48 lb.	70'	4 yards	surface
11"	8 5/8"	24 lb. API	800'	300 sx	circulated
7 7/8"	4 1/2"	10 1/2 lb.	4500'	300 sx	3500'

Will drill to approximately 4500' to test the Abo formation.
If production is indicated, will run casing and attempt completion.

Estimated Geologic Tops:

San Andres 700'
Glorieta 1830'
Tubb 3300'
Abo 4060'

APPROVAL AND
FOR 90 DAY PERIOD
DRILLING COMMENCED,

EXPIRES **5-1-79**

gas is not dedicated

* The conductor pipe will only be set if required by the NMOCDC.

IN ABOVE SPACE DESCRIBE PROPOSED PROGRAM: IF PROPOSAL IS TO DEEPEN OR PLUG BACK, GIVE DATA ON PRESENT PRODUCTIVE ZONE AND PROPOSED NEW PRODUCTIVE ZONE. GIVE BLOWOUT PREVENTER PROGRAM, IF ANY.

I hereby certify that the information above is true and complete to the best of my knowledge and belief.

Signed *Jack L. McClellan* Title Operator Date 1/27/79

(This space for State Use)

APPROVED BY *W. A. Gressett* TITLE SUPERVISOR, DISTRICT 4 DATE FEB 1 1979

CONDITIONS OF APPROVAL, IF ANY:

Consent must be obtained to
surface behind 8 7/8" casing

NEW MEXICO OIL CONSERVATION COMMISSION
WELL LOCATION AND ACREAGE DEDICATION PLAT

Form C-102
Supersedes C-128
Effective 1-1-65

All distances must be from the outer boundaries of the Section

Lessee McClellan Oil Corp.			Well No. 1		
Initial Letter P	Section 36	Township 9 South	Range 25 East	County Chaves	
Actual Footage Location of Well: 660 feet from the South line and 660 feet from the East line					
Ground Level Elev. 3663.0	Producing Formation Abo	Pool Wildcat	Dedicated Acreage: 160 Acres		

1. Outline the acreage dedicated to the subject well by colored pencil or hatchure marks on the plat below.
2. If more than one lease is dedicated to the well, outline each and identify the ownership thereof (both as to working interest and royalty).
3. If more than one lease of different ownership is dedicated to the well, have the interests of all owners been consolidated by communitization, unitization, force-pooling, etc?

☐ Yes ☐ No If answer is "yes," type of consolidation _____

If answer is "no," list the owners and tract descriptions which have actually been consolidated. (Use reverse side of this form if necessary.) _____

No allowable will be assigned to the well until all interests have been consolidated (by communitization, unitization, forced-pooling, or otherwise) or until a non-standard unit, eliminating such interests, has been approved by the Commission.

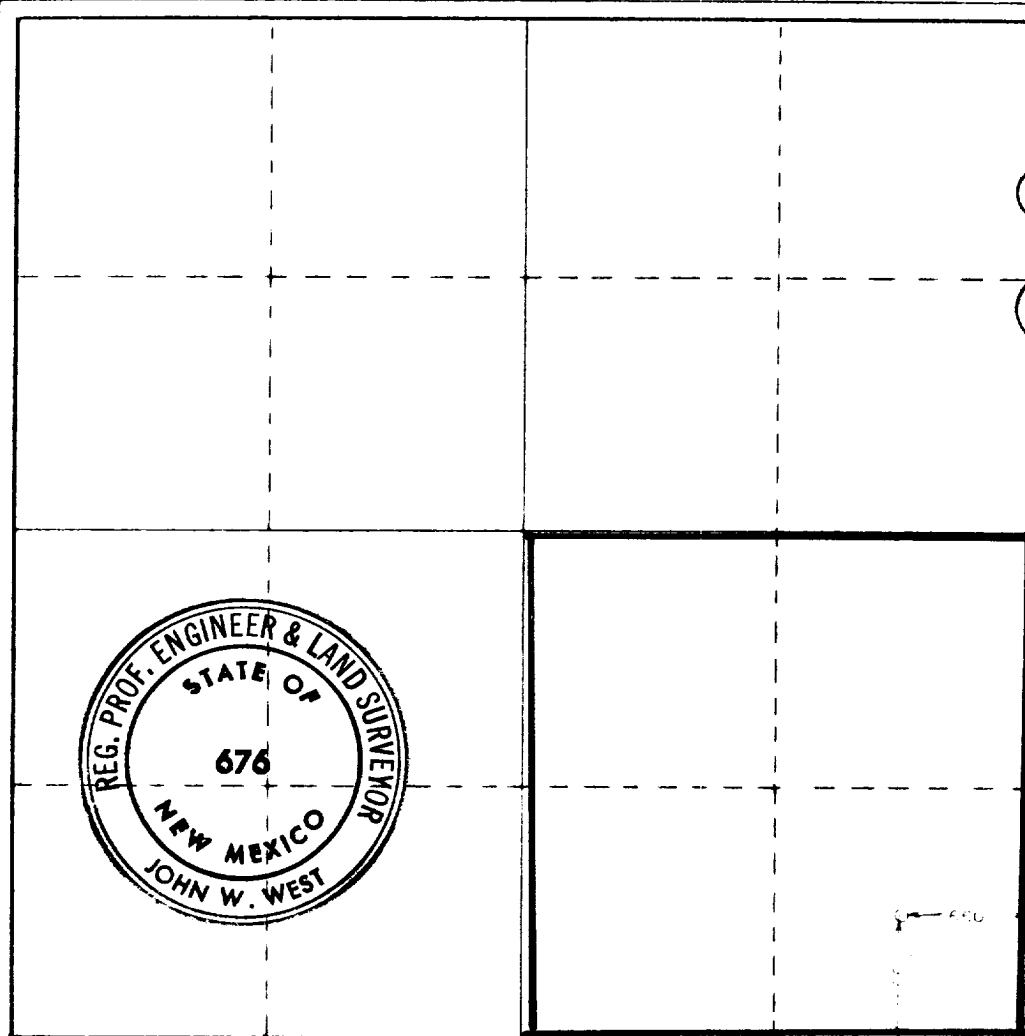

CERTIFICATION

I hereby certify that the information contained herein is true and complete to the best of my knowledge and belief.

Jack L. McClellan
Name
Position
President
Company
McClellan Oil Corporation

Date
1/26/79

I hereby certify that the well location shown on this plat was plotted from field notes of actual surveys made by me or under my supervision, and that the same is true and correct to the best of my knowledge and belief.

Date Surveyed
January 17, 1979

Registered Professional Engineer and/or Land Surveyor

John W. West
Certificate No. **John W. West 676**

Ronald J. Eidson 3239

