

NO. OF COPIES RECEIVED	
DISTRIBUTION	
SANTA FE	1
FILE	1
U.S.G.S.	2
LAND OFFICE	
OPERATOR	1

NEW MEXICO OIL CONSERVATION COMMISSION

RECEIVED

JUN 20 1980

O. C. D.
ARTESIA, OFFICE

30-005-60729

Form C-101
Revised 1-1-65

5A. Indicate Type of Lease
STATE ☐ FEE ☒
5. State Oil & Gas Lease No.

APPLICATION FOR PERMIT TO DRILL, DEEPEN, OR PLUG BACK

1a. Type of Work b. Type of Well OIL WELL <input checked="" type="checkbox"/> GAS WELL <input type="checkbox"/> OTHER <input type="checkbox"/> c. Name of Operator Coronado Exploration Corp. d. Address of Operator 1005 Marquette NW Albuquerque, NM 87102 e. Location of Well UNIT LETTER B LOCATED 660 FEET FROM THE North LINE AND 1980 FEET FROM THE East LINE OF SEC. 6 TWP. 10S RGE. 28E NMPM f. Proposed Depth 2400' g. Formation San Andres h. History of C.T. C.T. i. Elevations (Show whether DL, RI, etc.) 3864.7 Gr j. Kind & Status Plug Bond Statewide k. Drilling Contractor Cortez Drilling Co. l. Approx. Date Work will start 06-21-80		7. Lease Agreement Name 8. Firm or Lease Name Annette 9. Well No. 1 10. Field and Pool, or Well Unit Wildcat 11. County Chaves
--	--	--

PROPOSED CASING AND CEMENT PROGRAM

SIZE OF HOLE	SIZE OF CASING	WEIGHT PER FOOT	SETTING DEPTH	SACKS OF CEMENT	EST. TOP
12-1/4"	8-5/8"	24#	300'	330	Circ.
7-7/8"	4 1/2"	10.5#	2400'	175	

We propose to:

Set 8-5/8" casing at 300'; circulate cement to surface; WOC 18 hrs.
Test casing to 500 psi for 30 minutes, before drilling out. Drill 7-7/8" hole to 2400'; reduce water loss to below 10cc before drilling San Andres. Run DDL with Microlaterolog, GR-CNL-D. Set 4 1/2" casing, to either TD or above P1 zone depending on outcome of logs. In latter case open hole completion will be attempted, in former case casing will be perforated.

APPROVAL VALID
FOR 90 DAYS UNLESS
DRILLING COMMENCED,
EXPIRES 9-20-80

IN ABOVE SPACE DESCRIBE PROPOSED PROGRAM; IF PROPOSAL IS TO DEEPEN OR PLUG BACK, GIVE DATA ON PRESENT PRODUCTIVE ZONE AND PROPOSED NEW PRODUCTIVE ZONE, GIVE BLOWOUT PREVENTER PROGRAM, IF ANY.

I hereby certify that the information above is true and complete to the best of my knowledge and belief.

Signed BY: Alma Brown Title Production Secretary Date June 12, 1980

(This space for State Use)

APPROVED BY: W.A. Grossett TITLE SUPERVISOR, DISTRICT II DATE JUN 20 1980

CONDITIONS OF APPROVAL, IF ANY:

NEW MEXICO OIL CONSERVATION COMMISSION
WELL LOCATION AND ACREAGE DEDICATION PLAT

JUN 20 1980

Form C-102
Supersedes C-128
Effective 1-1-65

All distances must be from the outer boundaries of the Section.

O. C. D.

Operator Coronado Exploration Corp.			Lease Annette		Office ARTESIA, OFFICE	Well No. 1
Unit Letter B	Section 6	Township 10 South	Range 28 East	County Chaves		
Actual Footage Location of Well: 660 feet from the North line and 1980 feet from the East line						
Ground Level Elev. 3864.7	Producing Formation San Andres		Pool Wildcat		Dedicated Acreage: 40 Acres	

1. Outline the acreage dedicated to the subject well by colored pencil or hachure marks on the plat below.
2. If more than one lease is dedicated to the well, outline each and identify the ownership thereof (both as to working interest and royalty).
3. If more than one lease of different ownership is dedicated to the well, have the interests of all owners been consolidated by communitization, unitization, force-pooling, etc?

☐ Yes ☒ No If answer is "yes," type of consolidation _____

If answer is "no," list the owners and tract descriptions which have actually been consolidated. (Use reverse side of this form if necessary.) All leases are held by operator and participating parties

No allowable will be assigned to the well until all interests have been consolidated (by communitization, unitization, forced-pooling, or otherwise) or until a non-standard unit, eliminating such interests, has been approved by the Commission.

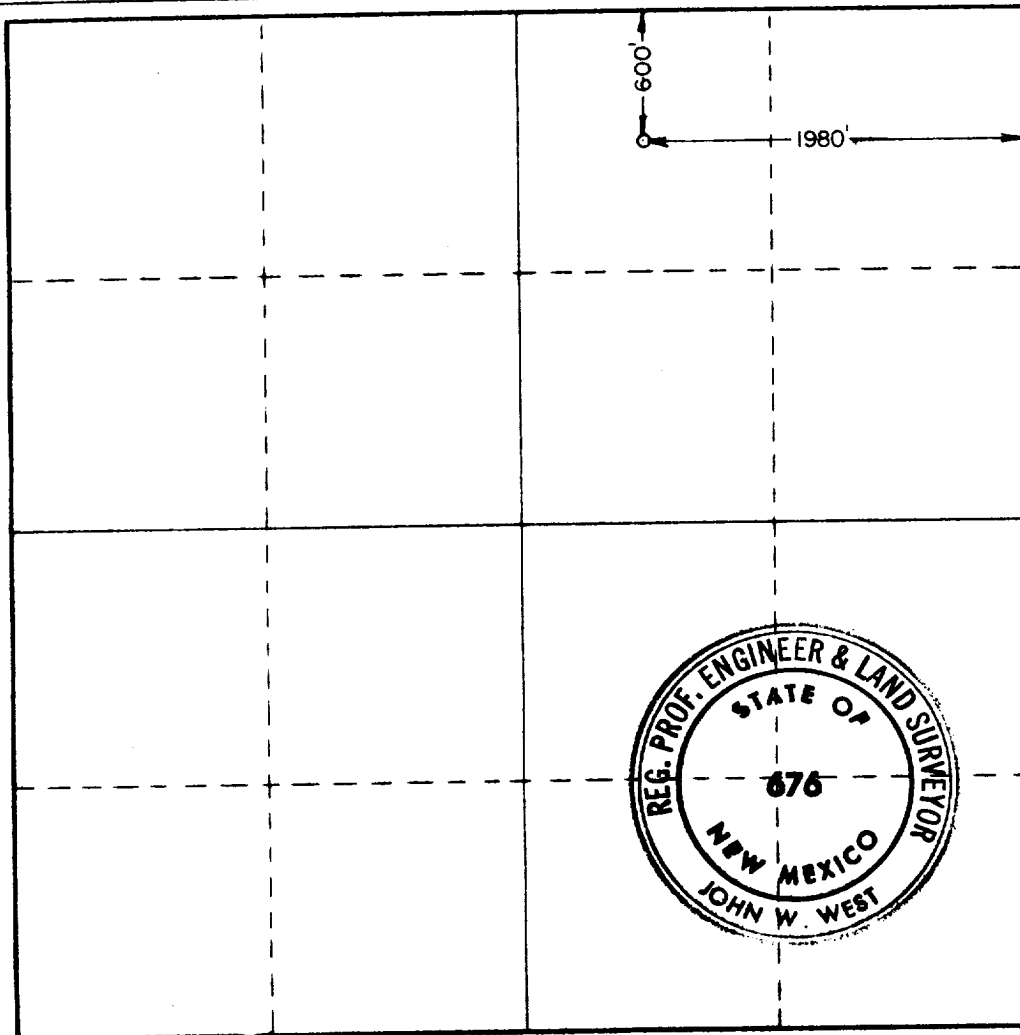

CERTIFICATION

I hereby certify that the information contained herein is true and complete to the best of my knowledge and belief.

Pamela Bacon

Name

Pamela Bacon

Position

Production Secretary

Company

Coronado Exploration Corp.

Date

06-19-80

I hereby certify that the well location shown on this plat was plotted from field notes of actual surveys made by me or under my supervision, and that the same is true and correct to the best of my knowledge and belief.

Date Surveyed

June 10, 1980

Registered Professional Engineer and/or Land Surveyor

John W. West

Certificate No. **JOHN W. WEST 676**
PATRICK A. ROMERO 8883
Ronald J. Eidson 3239

0 330 660 990 1320 1650 1980 2310 2640 2970 3300 3630 3960 4290 4620 4950 5280 5610 5940 6270 6600