

UNITED STATES DEPARTMENT OF THE INTERIOR GEOLOGICAL SURVEY

30-005-61747

APPLICATION FOR PERMIT TO DRILL, DEEPEN, OR PLUG BACK

1a. TYPE OF WORK DRILL [X] DEEPEN [] PLUG BACK []

b. TYPE OF WELL OIL WELL [] GAS WELL [X] OTHER [] SINGLE ZONE [] MULTIPLE ZONE []

2. NAME OF OPERATOR Yates Petroleum Corporation

3. ADDRESS OF OPERATOR 207 S. 4th, Artesia, New Mexico 88210

4. LOCATION OF WELL (Report location clearly and in accordance with any State requirements.*) At surface 660' FSL and 660' FWL At proposed prod. hole same

14. DISTANCE IN MILES AND DIRECTION FROM NEAREST TOWN OR POST OFFICE* Approximately 30 miles NNE of Roswell, NM

15. DISTANCE FROM PROPOSED LOCATION TO NEAREST PROPERTY OR LEASE LINE, FT. (Also to nearest drig. unit line, if any) 660'

16. NO. OF ACRES IN LEASE 640

17. NO. OF ACRES ASSIGNED TO THIS WELL 160

18. DISTANCE FROM PROPOSED LOCATION TO NEAREST WELL, DRILLING, COMPLETED, OR APPLIED FOR, ON THIS LEASE, FT.

19. PROPOSED DEPTH 4150'

20. ROTARY OR CABLE TOOLS Rotary

21. ELEVATIONS (Show whether DF, RT, GR, etc.) 3799.4' GL

22. APPROX. DATE WORK WILL START* ASAP

23. PROPOSED CASING AND CEMENTING PROGRAM

Table with 5 columns: SIZE OF HOLE, SIZE OF CASING, WEIGHT PER FOOT, SETTING DEPTH, QUANTITY OF CEMENT. Rows show 14 3/4" hole with 10 3/4" casing, and 7 7/8" hole with 4 1/2" casing.

We propose to drill and test the Abo and intermediate formations. Approximately 880' of surface casing will be set and cement circulated to shut off gravel and caving. If needed (lost circulation) 8 5/8" intermediate casing will be run to 1500' and cemented with enough cement calculated to tie back into the surface casing. If commercial, production casing will be run and cemented with adequate cover, perforated and stimulated as needed for production.

MUD PROGRAM: FW gel and LCM to 880', KCL & starch to 3500', Brine & KCL water to TD.

BOP PROGRAM: BOP's will be installed at the offset and tested daily.

GAS NOT DEDICATED.

IN ABOVE SPACE DESCRIBE PROPOSED PROGRAM: If proposal is to deepen or plug back, give data on present productive zone and proposed new productive zone. If proposal is to drill or deepen directionally, give pertinent data on subsurface locations and measured and true vertical depths. Give blowout preventer program, if any.

24. SIGNED [Signature] TITLE Regulatory Coordinator DATE 5/11/82

Approval stamps and signatures: APPROVED (Orig. Sgd.) GEORGE H. STEWART, APPROVAL DATE AUG 26 1982, APPROVED BY JAMES A. GILHAM DISTRICT SUPERVISOR.

UNITED STATES
DEPARTMENT OF THE INTERIOR
GEOLOGICAL SURVEY

SUNDRY NOTICES AND REPORTS ON WELLS

(Do not use this form for proposals to drill or to deepen or plug back to a different reservoir. Use Form 9-331-C for such proposals.)

1. oil well gas well other

2. NAME OF OPERATOR
Yates Petroleum Corporation

3. ADDRESS OF OPERATOR
207 S. 4th, Artesia, New Mexico

4. LOCATION OF WELL (REPORT LOCATION CLEARLY. See space 17 below.)
AT SURFACE: 990' FSL and 660' FWL
AT TOP PROD. INTERVAL:
AT TOTAL DEPTH: same

16. CHECK APPROPRIATE BOX TO INDICATE NATURE OF NOTICE, REPORT, OR OTHER DATA

| | | | |
|----------------------------|--------------------------|-----------------------|--------------------------|
| REQUEST FOR APPROVAL TO: | | SUBSEQUENT REPORT OF: | |
| TEST WATER SHUT-OFF | <input type="checkbox"/> | | <input type="checkbox"/> |
| FRACTURE TREAT | <input type="checkbox"/> | | <input type="checkbox"/> |
| SHOOT OR ACIDIZE | <input type="checkbox"/> | | <input type="checkbox"/> |
| REPAIR WELL | <input type="checkbox"/> | | <input type="checkbox"/> |
| PULL OR ALTER CASING | <input type="checkbox"/> | | <input type="checkbox"/> |
| MULTIPLE COMPLETE | <input type="checkbox"/> | | <input type="checkbox"/> |
| CHANGE ZONES | <input type="checkbox"/> | | <input type="checkbox"/> |
| ABANDON* | <input type="checkbox"/> | | <input type="checkbox"/> |
| (other) change of location | <input type="checkbox"/> | | <input type="checkbox"/> |

5. LEASE
NM-28304-A

6. IF INDIAN, ALLOTTEE OR TRIBE NAME

7. UNIT AGREEMENT NAME

8. FARM OR LEASE NAME
Albitus "TH" Federal #3

9. WELL NO.
3

10. FIELD OR WILDCAT NAME
Under. Pecos Slope Abo

11. SEC., T., R., M., OR BLK. AND SURVEY OR AREA
Sec. 21-T7S-R25E

12. COUNTY OR PARISH
Chaves

13. STATE
NM

14. API NO.

15. ELEVATIONS (SHOW DF, KDB, AND WD)
3808.6' GL

(NOTE: Report results of multiple completion or zone change on Form 9-330.)

17. DESCRIBE PROPOSED OR COMPLETED OPERATIONS (Clearly state all pertinent details, and give pertinent dates, including estimated date of starting any proposed work. If well is directionally drilled, give subsurface locations and measured and true vertical depths for all markers and zones pertinent to this work.)*

Change location from: 660' FSL and 660' FWL
to: 990' FSL and 660' FWL

PER REQUEST OF BLM

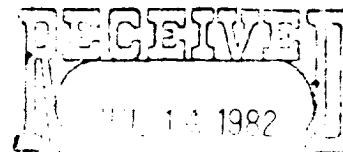

OIL & GAS
U.S. GEOLOGICAL SURVEY
ROSWELL, NEW MEXICO
Set @ _____ Ft.

Subsurface Safety Valve: Manu. and Type _____

18. I hereby certify that the foregoing is true and correct

SIGNED *George H. Stewart* TITLE Regulatory Secy DATE 7/13/82

APPROVED
(Orig. Sgd.) GEORGE H. STEWART
(This space for Federal or State office use)

APPROVED BY _____ TITLE _____ DATE _____
CONDITIONS OF APPROVAL, IF ANY:

AUG 26 1982
JAMES A. GILHAM
DISTRICT SUPERVISOR

*See Instructions on Reverse Side

NEW MEXICO OIL CONSERVATION COMMISSION
WELL LOCATION AND ACREAGE DEDICATION PLAT

Form C-192
Supersede C-128
Effective 4-65

All distances must be from the outer boundaries of the Section

| | | | | | | |
|---|----------------------------|---------------------|-------------------------------|------------------|---------------------------------|---------------|
| Operator YATES PETROLEUM CORPORATION | | | Lease Albitus "TH" Federal | | | Well No. 3 |
| Unit Letter M | Section 21 | Township 7 South | Range 25 East | County Chaves | | |
| Actual Footage Location of Well: 990 feet from the South line and 660 feet from the West line. | | | | | | |
| Ground Level Elev. 3808.6' | Producing Formation Abo | | Pool Under Pecos Slope Abo | | Dedicated Acreage: 160 Acres | |

- Outline the acreage dedicated to the subject well by colored pencil or hachure marks on the plat below.
- If more than one lease is dedicated to the well, outline each and identify the ownership thereof (both as to working interest and royalty).
- If more than one lease of different ownership is dedicated to the well, have the interests of all owners been consolidated by communitization, unitization, force-pooling, etc?

Yes No If answer is "yes," type of consolidation _____

If answer is "no," list the owners and tract descriptions which have actually been consolidated. (Use reverse side of this form if necessary.) _____

No allowable will be assigned to the well until all interests have been consolidated (by communitization, unitization, forced-pooling, or otherwise) or until a non-standard unit, eliminating such interests, has been approved by the Commission.

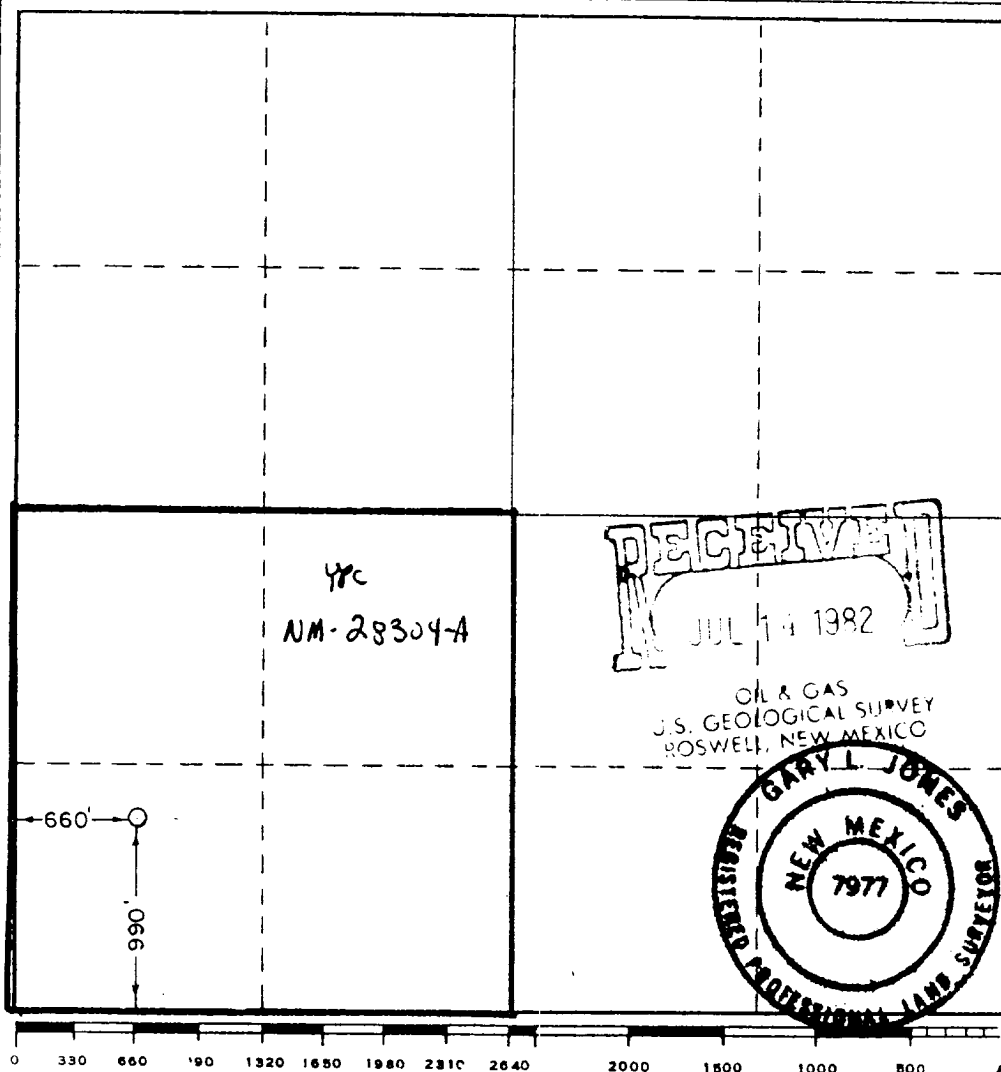

CERTIFICATION

I hereby certify that the information contained herein is true and complete to the best of my knowledge and belief.

Ken Beardolph

Name
KEN BEARDOLPH

Position
REGULATORY COORDINATOR

Company
YATES PETROLEUM CORP.

Date
7/12/82

I hereby certify that the well location shown on this plat was plotted from field notes of actual surveys made by me or under my supervision, and that the same is true and correct to the best of my knowledge and belief.

Date Surveyed
July 8, 1982

Registered Professional Engineer and/or Land Surveyor

[Signature]

Certificate No.
7977

YATES PETROLEUM CORP.
ALBERTA "TH" FEDERAL #3
990' FSC ? 660 FWC
SEC. 21-T25-R25E
CHAVES COUNTY, NM

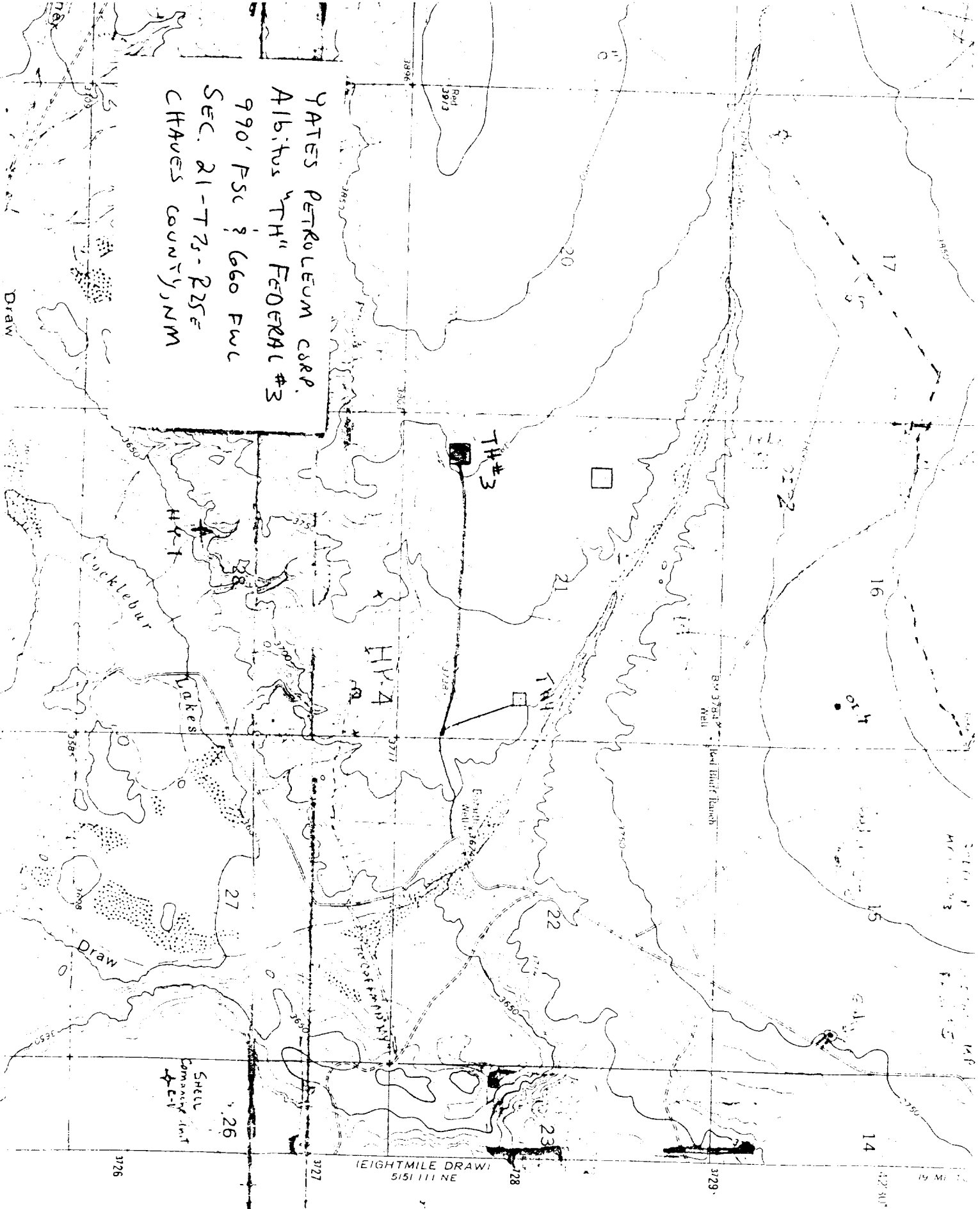

Draw

Cucklebur

Lakes

Draw

SHELL
Company limit

EIGHTMILE DRAW
5151 111 NE

3726

3727

3728

3729

4230'

YATES PETROLEUM CORPORATION
Albitus "TH" Federal #3
660' FSL and 660' FWL
Section 21-T7S-R25E
Chaves County, New Mexico

In conjunction with Form 9-331C, Application for Permit to Drill subject well, Yates Petroleum Corporation submits the following ten items of pertinent information in accordance with USGS requirements.

1. The geologic surface formation is sandy residium.

2. The estimated tops of geologic markers are as follows:

| | |
|-------------------|--------------|
| <u>San Andres</u> | <u>400'</u> |
| <u>Glorieta</u> | <u>1420'</u> |
| <u>Fullerton</u> | <u>2875'</u> |
| <u>Abo</u> | <u>3600'</u> |
| <u>TD</u> | <u>4150'</u> |

3. The estimated depths at which anticipated water, oil or gas formations are expected to be encountered:

Water: 250'

Oil or Gas: 3630'

4. Proposed Casing Program: See Form 9-331C.

5. Pressure Control Equipment: See Form 9-331C and Exhibit B.

6. Mud Program: See Form 9-331C.

7. Auxiliary Equipment: Kelly Cock; pit level indicators and flow sensor equipment; sub with full-opening valve on floor, drill pipe connection.

8. Testing, Logging and Coring Program:

Samples: Surface casing to TD.

DST's: As warranted

Coring: As warranted

Logging: CNL-FDC TD to casing w/GR-CNL to surface & DLL from TD to casing

9. No abnormal pressures or temperatures are anticipated.

10. Anticipated starting date: As soon as possible after approval.

E HIBIT B

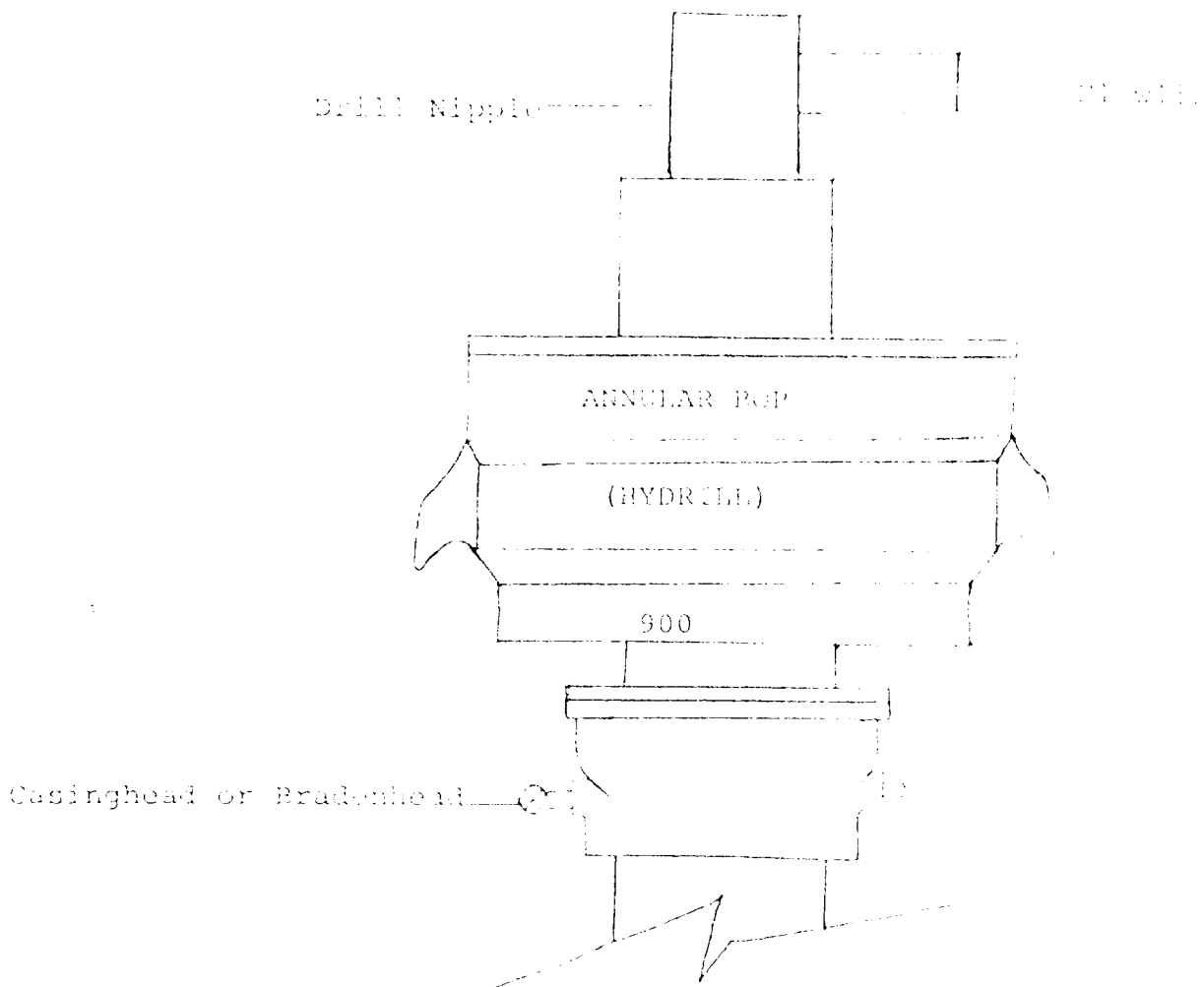

THE FOLLOWING CONSTITUTE MINIMUM BLOWOUT PREVENTER REQUIREMENTS:

1. All preventers to be hydraulically operated with secondary manual controls installed prior to drilling out from under casing.
2. All connections from operating manifolds to preventers to be all steel. Hole or tube a minimum of one inch in diameter.
3. The available closing pressure shall be at least 15% in excess of that required with sufficient volume to operate the BOP's.
4. All connections to and from preventer to have a pressure rating equivalent to that of the BOP's.
5. Hole must be kept filled on trips below intermediate casing.

E. EXHIBIT C

YATES PETROLEUM CORPORATION

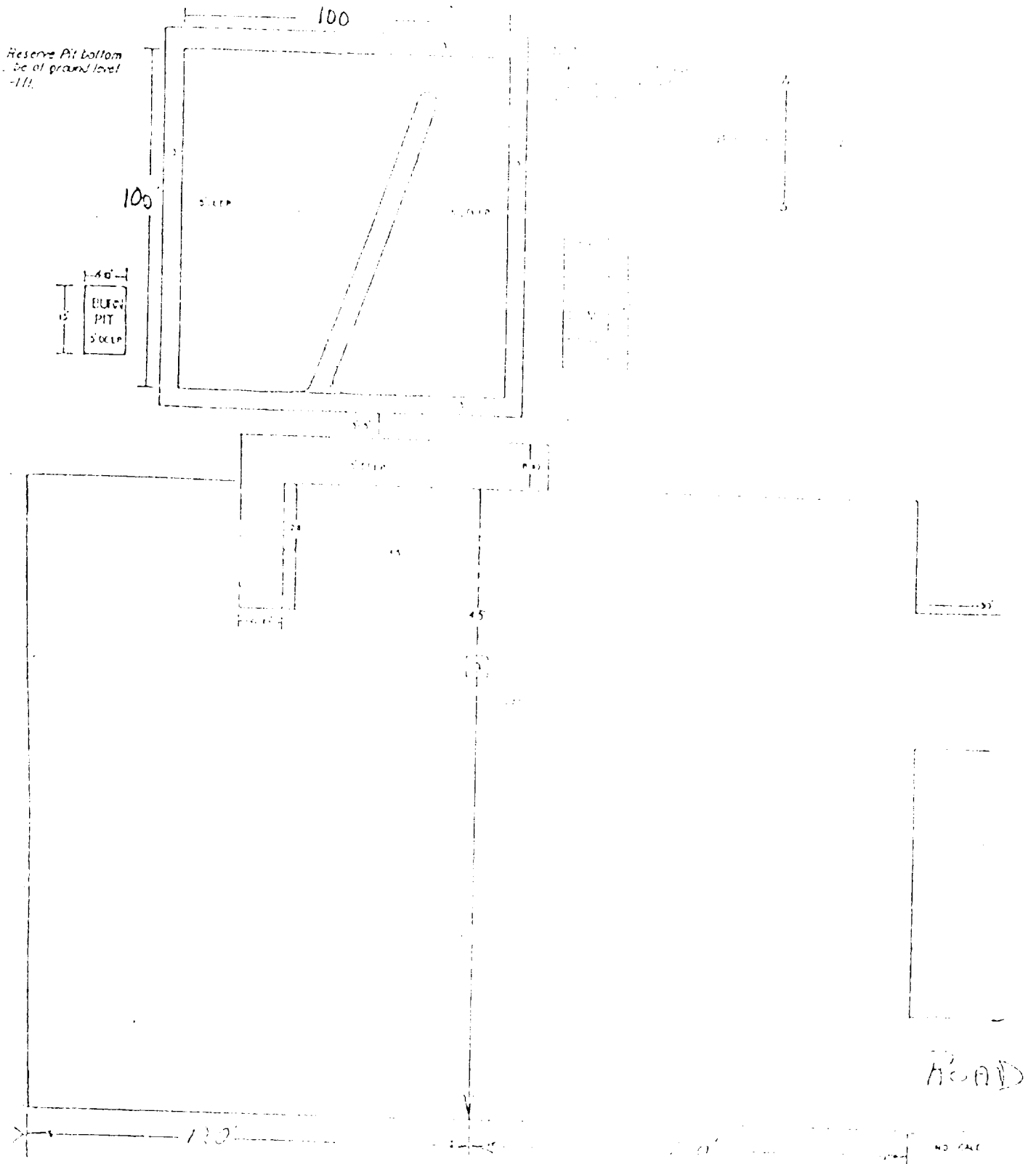

30-005-61689

