

UNITED STATES
DEPARTMENT OF THE INTERIOR
BUREAU OF LAND MANAGEMENT
Artesia, NM 88210

Budget Bureau No. 1004-0135
Expires August 31, 1985
9SF

SUNDRY NOTICES AND REPORTS ON WELLS

(Do not use this form for proposals to drill or to deepen or plug back to a surface reservoir.
Use "APPLICATION FOR PERMIT—" for such proposals.)

1. OIL WELL <input type="checkbox"/> GAS WELL <input checked="" type="checkbox"/> OTHER		2. NAME OF OPERATOR Yates Petroleum Corporation		3. ADDRESS OF OPERATOR 207 S. 4th, Artesia, New Mexico 88210		4. LOCATION OF WELL (Report location clearly and in accordance with any State requirements. See also space 17 below.) At surface see attached map		5. LEASE DESIGNATION AND SERIAL NO. NM-18483		6. IF INDIAN, ALLOTTEE OR TRIBE NAME		7. UNIT AGREEMENT NAME		8. FARM OR LEASE NAME Morton "SZ"		9. WELL NO. 4		10. FIELD AND POOL, OR WILDCAT Pecos Slope Abo		11. SEC., T., R., M., OR BLK. AND SURVEY OR AREA Sec. 10-T8S-R25E		12. COUNTY OR PARISH Chaves		13. STATE NM	
14. PERMIT NO.				15. ELEVATIONS (Show whether DF, RT, GR, etc.)				16. Check Appropriate Box To Indicate Nature of Notice, Report, or Other Data																	

RECEIVED BY
JUL 11 1984
O. C. D.
ARTESIA, OFFICE

NOTICE OF INTENTION TO:		SUBSEQUENT REPORT OF:	
TEST WATER SHUT-OFF <input type="checkbox"/>	PULL OR ALTER CASING <input type="checkbox"/>	WATER SHUT-OFF <input type="checkbox"/>	REPAIRING WELL <input type="checkbox"/>
FRACTURE TREAT <input type="checkbox"/>	MULTIPLE COMPLETE <input type="checkbox"/>	FRACTURE TREATMENT <input type="checkbox"/>	ALTERING CASING <input type="checkbox"/>
SHOOT OR ACIDIZE <input type="checkbox"/>	ABANDON* <input type="checkbox"/>	SHOOTING OR ACIDIZING <input type="checkbox"/>	ABANDONMENT* <input type="checkbox"/>
REPAIR WELL <input type="checkbox"/>	CHANGE PLANS <input type="checkbox"/>	(Other) <input type="checkbox"/>	
(Other) amend surface use plan			

17. DESCRIBE PROPOSED OR COMPLETED OPERATIONS (Clearly state all pertinent details, and give pertinent dates, including estimated date of starting any proposed work. If well is directionally drilled, give subsurface locations and measured and true vertical depths for all markers and zones pertinent to this work.)

Amend surface use plan to include 2 7/8" gas gathering line for the purpose of selling gas from the above referenced well. As can be seen on the attached map, the line will be laid on the surface going from the Morton #4 west across the road to the existing pipeline and will parallel it going south to a meterhouse set by Transwestern at the section line (meterhouse for Morton #2 also set here). Approximately 800' of line will be laid on federal surface.

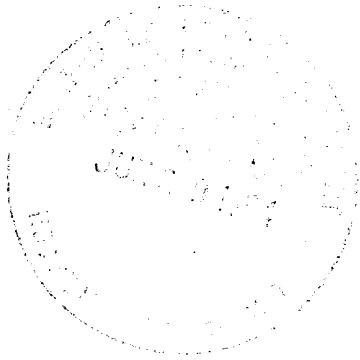

18. I hereby certify that the foregoing is true and correct

SIGNED Debra A. Williams TITLE Regulatory Secretary DATE 6/19/84

(This space for Federal or State office use)

APPROVED BY Shirley... TITLE Area Manager DATE JUL 5 1984

CONDITIONS OF APPROVAL, IF ANY:

*See Instructions on Reverse Side

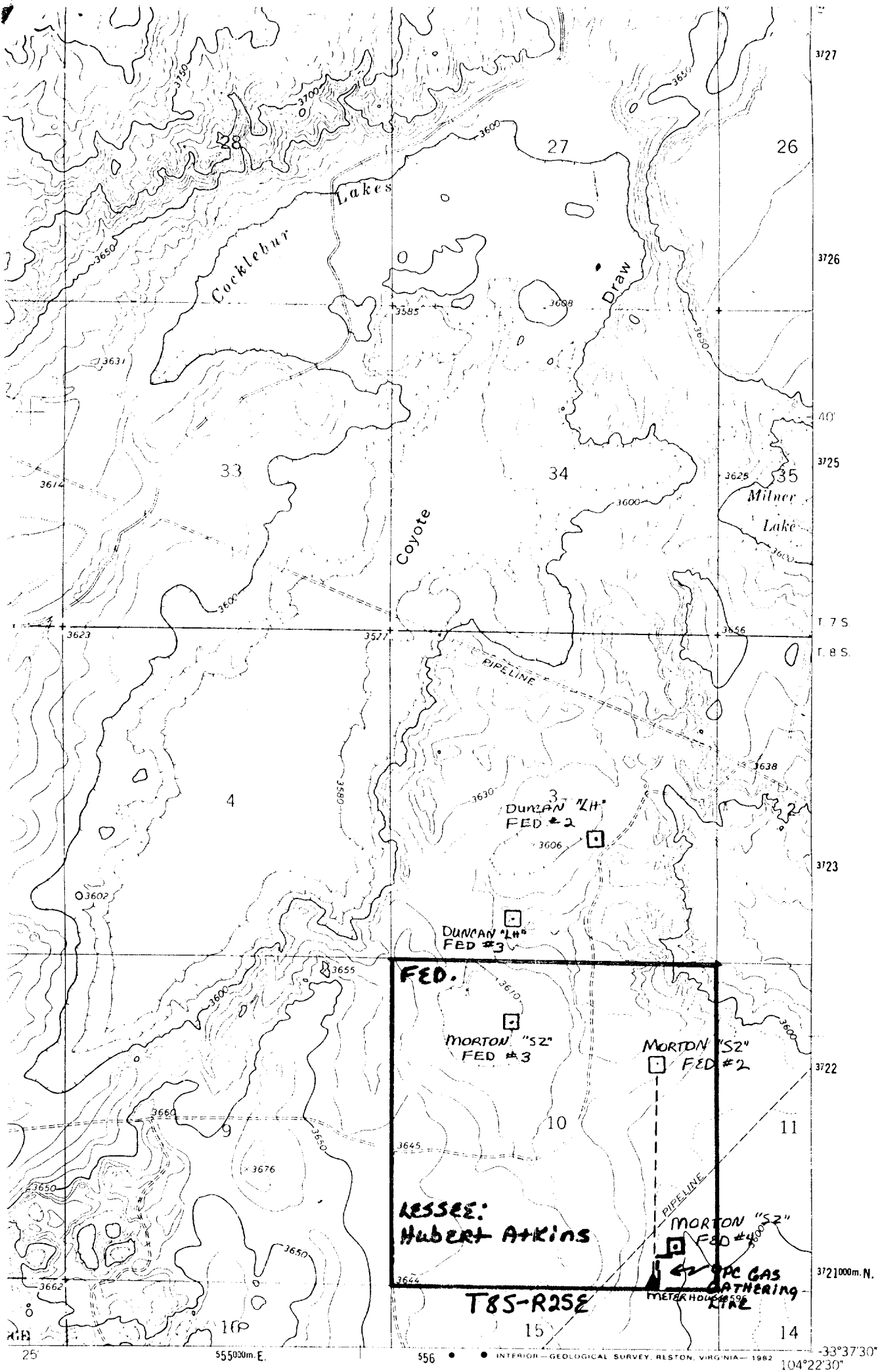

ROAD CLASSIFICATION

Light-duty Unimproved dirt



QUADRANGLE LOCATION

COYOTE DRAW, N. MEX.

N3337.5 - W10422 5/7.5

1963
PHOTOREVISED 1982
DMA 5151 III NW-SERIES V881

(ACME)
5151 III SE

WELL NAMES: Morton SZ Fed #4 Pipeline

OIL & GAS LEASE NUMBER NM 18483

STANDARD STIPULATIONS FOR PIPELINES AND UNDERGROUND CABLES
IN THE ROSWELL RESOURCE AREA, BLM

Operator will comply with the following stipulations to the satisfaction of the BLM's Roswell Resource Area Manager:

1. Clearing and blading necessary for construction will be held to the absolute minimum. Without prior agreement, these actions will not exceed those limits agreed upon at the pre-construction inspection. Vegetation removed will be "walked-down" in place.
2. Care will be taken by the operator to assure that scenic values are not damaged in the disposal of waste materials. Any large rocks which are left as a result of construction activities will be placed so that they do not detract from the scenic view and do not hinder the movement of livestock or of big game animals. These residual rocks will not be piled or left in rows.
3. Roads will not be constructed where terrain features permit vehicles to maneuver without the aid of such construction. All vehicular traffic and construction activity will be confined to the authorized area.
4. If a natural barrier which is being used for livestock control, is broken during construction, the operator will adequately fence the area to prevent drift of livestock. Such fencing will be at his own expense.
5. To prevent slacking of fence wire, the operator will brace and tie-off each existing fence to be crossed, before cutting. During construction, the opening will be protected to prevent the escape of livestock. Fences which have been cut during construction will be restored by the operator to a condition which is equal to, or better, than the original. Cattleguards and adjacent gates which are of a suitable width will also be installed in any fence where a road created during construction is to be regularly traveled.
6. Gates or cattleguards on public lands will not be locked or closed to public use by the operator.
7. Compatible with construction requirements, the period of time that trenches and other excavations are kept open by the operator will be held to a minimum.
8. Operator (~~wikk~~) (will not) reseed. If reseeding is required, it will be done according to the following requirements for BLM's Roswell District:

<input checked="" type="checkbox"/> seed mixture 1 Loamy	<input type="checkbox"/> seed mixture 3
<input type="checkbox"/> seed mixture 2	<input type="checkbox"/> seed mixture 4
9. All above-ground structures which are not subject to safety requirements, will be painted by the operator to blend with the natural landscape. The paint used will be a color which simulates Federal Standard No. 595A:

color 30318

color _____

10. In those areas where erosion control structures are required to stabilize soil conditions, the operator will install such structures as are suitable for the specific soil conditions being encountered and which are in accordance with sound resource management practices.

11. Upon abandonment of the well(s) to be connected, the operator will comply with those abandonment procedures as prescribed by BLM's Roswell Resource Area Manager.

12. The operator will make a diligent effort to contact the BLM grazing permittee or lessee prior to entering the public lands on all grazing allotments.

13. Special Stipulations:

- a. Signs, which at a minimum (1) warn of the gas pipeline and (2) state the name of the operator, will be placed at the following locations:
 - 1) Where the pipeline leaves the 4 Morton pad at the point where it crosses under the access road.
 - 2) Near the meterhouse at the point where it crosses under the access road.
- b. Any off-lease measurement requires approval of the authorized officer; BLM. Contact Pete Chester at 624-1790.
- c. Line will be laid no further than 10 feet away from existing pipeline.
- d. No clearing or blading will be allowed. Total width of construction disturbance will not exceed 15 feet.
- e. All applicable terms, conditions and stipulations of the original permit to drill for the Morton SZ #4 well will also apply to this authorization.