

NO. OF COPIES RECEIVED	
DISTRIBUTION	
SANTA FE	✓
FILE	✓
U.S.G.S.	2
LAND OFFICE	✓
OPERATOR	✓

RECEIVED BY
NOV 30 1984
O. C. D.
ARTESIA, OFFICE

NEW MEXICO OIL CONSERVATION COMMISSION

Form C-101
 Revised 1-1-65 **30-005-62219**

5A. Indicate Type of Lease
 STATE FEE

5. State Oil & Gas Lease No.
L-6362

APPLICATION FOR PERMIT TO DRILL, DEEPEN, OR PLUG BACK

1a. Type of Work DRILL <input checked="" type="checkbox"/> DEEPEN <input type="checkbox"/> PLUG BACK <input type="checkbox"/>		7. Unit Agreement Name Campbell Station Unit
b. Type of Well OIL WELL <input checked="" type="checkbox"/> GAS WELL <input type="checkbox"/> OTHER <input type="checkbox"/> SINGLE ZONE <input checked="" type="checkbox"/> MULTIPLE ZONE <input type="checkbox"/>		8. Farm or Lease Name Campbell Station Unit
2. Name of Operator Carl A. Schellinger ✓		9. Well No. 5
3. Address of Operator P.O. Box 447, Roswell, New Mexico 88201		10. Field and Pool, or Wildcat Wildcat - <i>Fusselman</i>
4. Location of Well UNIT LETTER E LOCATED 1980 FEET FROM THE North LINE AND 660 FEET FROM THE West LINE OF SEC. 3 TWP. 9-S RGE. 27-E NMPM		12. County Chaves
		19. Proposed Depth 6750'
		19A. Formation Fusselman
		20. Rotary or C.T. Rotary
21. Elevations (Show whether DF, RT, etc.) 3865 GR	21A. Kind & Status Plug. Bond Blanket	21B. Drilling Contractor RDC, Inc.
		22. Approx. Date Work will start December 20, 1984

23. PROPOSED CASING AND CEMENT PROGRAM

SIZE OF HOLE	SIZE OF CASING	WEIGHT PER FOOT	SETTING DEPTH	SACKS OF CEMENT	EST. TOP
12 1/4"	8 5/8"	23#	1450'	350	Circ.
7 7/8"	5 1/2"	15.5#	6750'	300	

We propose to drill to the Fusselman and to evaluate all intermediate zones.

Mud Program: 0-4200' Fresh water and native mud.
 4200-5000' SW gel, X-PEL-G, Vis 31-33
 5000-6750' SW gel, X-PEL-G, flo sal, Vis 31-45.

Blowout preventer diagram is attached.

APPROVAL VALID FOR 180 DAYS
 PERMIT EXPIRES 6-3-85
 UNLESS DRILLING UNDERWAY
*Posted IDI
 API to NL
 12-7-84*

IN ABOVE SPACE DESCRIBE PROPOSED PROGRAM: IF PROPOSAL IS TO DEEPEN OR PLUG BACK, GIVE DATA ON PRESENT PRODUCTIVE ZONE AND PROPOSED NEW PRODUCTIVE ZONE. GIVE BLOWOUT PREVENTER PROGRAM, IF ANY.

I hereby certify that the information above is true and complete to the best of my knowledge and belief.

Signed *[Signature]* Title Operator Date November 29, 1984

(This space for State Use)

ORIGINAL SIGNED
 BY LARRY BROOKS
 GEOLOGIST - NMOC

DEC 03 1984

APPROVED BY _____ DATE _____
 CONDITIONS OF APPROVAL, IF ANY:

CARL A. SCHELLINGER
No. 5 Campbell Station Unit
Unit E, Sec. 3-9S-27E
Chaves County, New Mexico

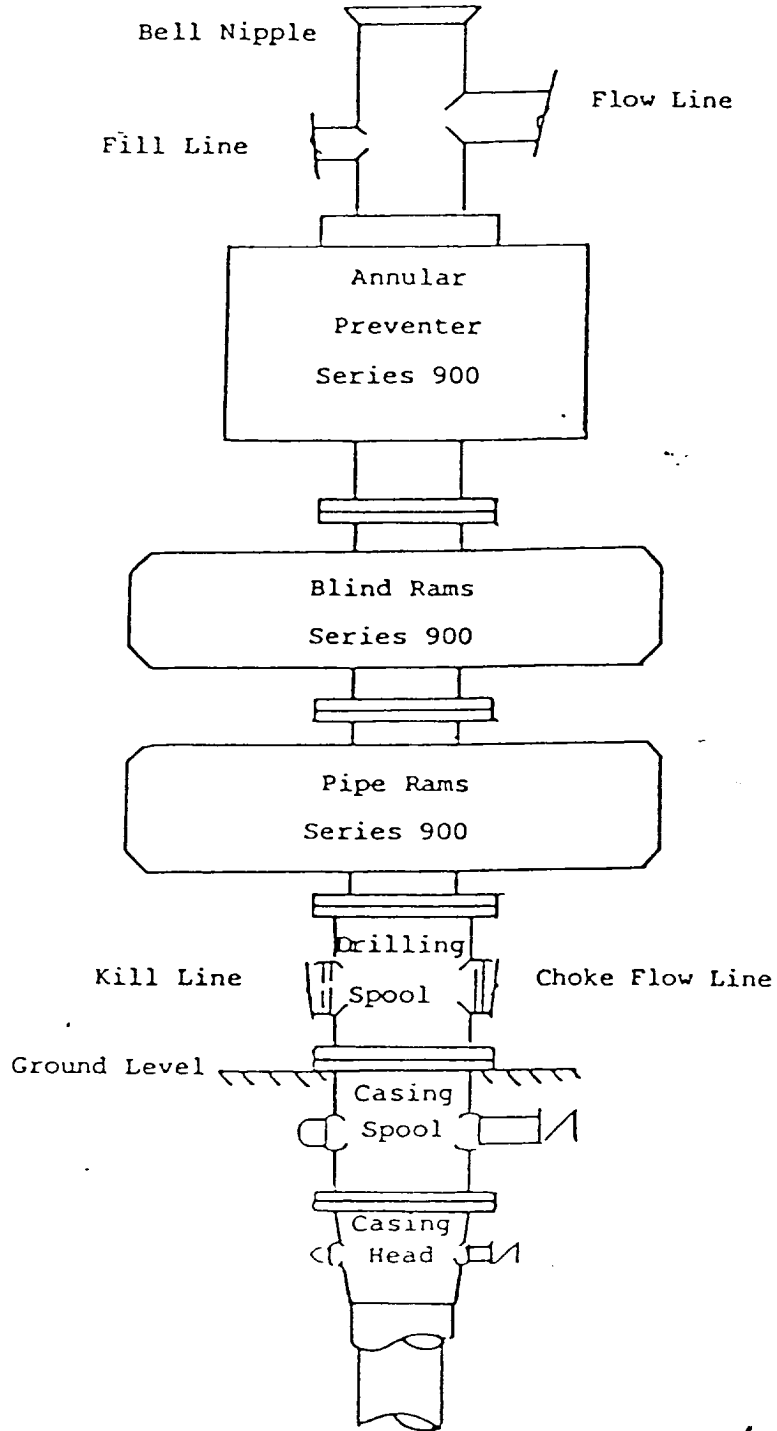

BLOWOUT PREVENTER STACK
3000# WP

All distances must be from the outer boundaries of the Section.

Operator Carl Schellinger		Lease Campbell Station Unit			Well No. #5
Section E	Section 3	Township 9 South	Range 27 East	County Chaves	
Well Location Location of Well					
660 feet from the West line and		1980 feet from the North line			
Ground Level Elev. 3865	Producing Formation Fusselman	Pool Wildcat		Dedicated Acreage 40 Acres	

- Outline the acreage dedicated to the subject well by colored pencil or hatchure marks on the plat below.
- If more than one lease is dedicated to the well, outline each and identify the ownership thereof (both as to working interest and royalty).
- If more than one lease of different ownership is dedicated to the well, have the interests of all owners been consolidated by communitization, unitization, force-pooling, etc?
 Yes No If answer is "yes," type of consolidation _____

If answer is "no," list the owners and tract descriptions which have actually been consolidated. (Use reverse side of this form if necessary.) _____
 No allowable will be assigned to the well until all interests have been consolidated (by communitization, unitization, forced-pooling, or otherwise) or until a non-standard unit, eliminating such interests, has been approved by the Division

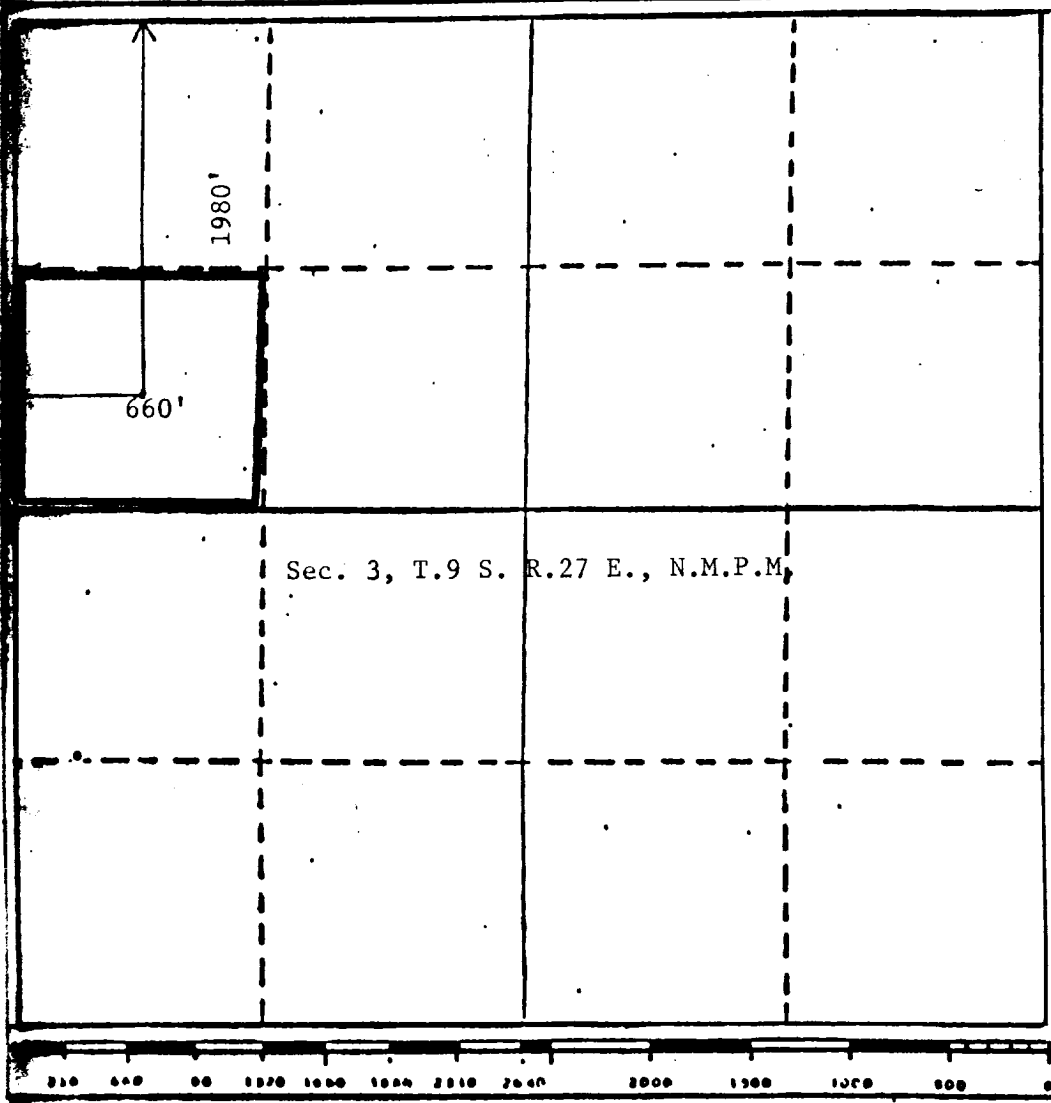

CERTIFICATION

I hereby certify that the information contained herein is true and complete to the best of my knowledge and belief.

Name
CARL A. SCHELLINGER

Position
OPERATOR

Company
-

Date
November 29, 1984

I hereby certify that the well location shown on this plat was plotted from field notes of actual surveys made by me or under my supervision, and that the same is true and correct to the best of my knowledge and belief.

Date Surveyed
November 21, 1984

Registered Professional Engineer
and/or Land Surveyor
6290

John D. Jaquess, P.E. & L.S.

Certificate No. 6290