

* American Application To
Change Location

API #30-023-20009

NO. OF COPIES RECEIVED		
DISTRIBUTION		
SANTA FE	✓	
FILE	✓	✓
U.S.G.S.	✓	✓
LAND OFFICE	✓	✓
OPERATOR	✓	✓

NEW MEXICO OIL CONSERVATION COMMISSION
RECEIVED BY
OCT 31 1984
O. C. D.
ARTESIA OFFICE

Form C-101
Revised 1-1-65

5A. Indicate Type of Lease
STATE FEE

5. State Oil & Gas Lease No.
NM-3836

APPLICATION FOR PERMIT TO DRILL, DEEPEN, OR PLUG BACK

1a. Type of Work
b. Type of Well
OIL WELL GAS WELL OTHER
SINGLE ZONE MULTIPLE ZONE

2. Name of Operator ARCO Oil and Gas Company
Division of Atlantic Richfield Company

3. Address of Operator
P. O. Box 1710, Hobbs, New Mexico 88240

4. Location of Well
UNIT LETTER L LOCATED 990 FEET FROM THE West LINE
AND 2220 FEET FROM THE South LINE OF SEC. 10 TWP. 33S RGE. 20W NMPM

7. Unit Agreement Name

8. Farm or Lease Name
Fitzpatrick

9. Well No.
1

10. Field and Pool, or Wildcat
Wildcat

12. County
Hidalgo

19. Proposed Depth
15,000'

19A. Formation
Epitaph Dolomite

20. Rotary or C.T.
Rotary

21. Elevations (Show whether DF, RT, etc.)
5165' GR

21A. Kind & Status Plug. Bond
GCA #8

21B. Drilling Contractor
Not selected

22. Approx. Date Work will start
11/15/84

PROPOSED CASING AND CEMENT PROGRAM

SIZE OF HOLE	SIZE OF CASING	WEIGHT PER FOOT	SETTING DEPTH	SACKS OF CEMENT	EST. TOP
36"	30" Cond Pipe		Approx. 30-60'	Approx 6 yds Redi-mix	
26"	20" OD	94# K-55	Approx. 500-1000'	1400	Circ to surf
17 1/2"	13-3/8" OD	72# S-95	0-1000'		Approx 4300'
		72# N-80	1000-5000'	2250	fr. surf.
		72# S-95	5000-6500'		
12 1/4"	9-5/8" OD	53.5# S-95	12,500	2500	Approx 8000' FS
8 1/2"	5 1/2" OD	20# N-80	12,000-15,000'	900	

If hole conditions dictate, an 11-3/4" FJ or 7-5/8" FJ liner could be set below the 13-3/8" or 9-5/8" csg respectively and cmt'd w/kind and amount of cmt to be determined.

* Note: Location changed to move away from high pressure pipeline.

Blowout Preventer Program attached.

APPROVAL VALID FOR 180 DAYS
PERMIT EXPIRES 5-1-85
UNLESS DRILLING UNDERWAY
*Post ID-1
11-2-84
Am'd. footage*

IN ABOVE SPACE DESCRIBE PROPOSED PROGRAM: IF PROPOSAL IS TO DEEPEN OR PLUG BACK, GIVE DATA ON PRESENT PRODUCTIVE ZONE AND PROPOSED NEW PRODUCTIVE ZONE. GIVE BLOWOUT PREVENTER PROGRAM, IF ANY.

I hereby certify that the information above is true and complete to the best of my knowledge and belief.

Signed Elizabeth S. Bush Title Drlg. Engr. Date 10/30/84

(This space for State Use)

Original Signed By Leslie A. Clements LE
APPROVED BY _____ DATE OCT 31 1984

CONDITIONS OF APPROVAL, IF ANY: Supervisor District II

**N MEXICO OIL CONSERVATION COMM. ON
WELL LOCATION AND ACREAGE DEDICATION PLAT**

Form C-102
Supersedes C-128
Effective 1-1-65

All distances must be from the outer boundaries of the Section.

Operator: ARCO Oil and Gas Company Division of Atlantic Richfield Company			Lease: Fitzpatrick		Well No.: 1
Unit Letter: L	Section: 10	Township: 33 South	Range: 20 West	County: Hidalgo	
Actual Footage Location of Well: 990 feet from the west line and 2220 feet from the south line					
Ground Level Elev.: 5165	Producing Formation: Epitaph Dolomite		Pool: Wildcat	Dedicated Acreage: 320 Acres	

1. Outline the acreage dedicated to the subject well by colored pencil or hachure marks on the plat below.
2. If more than one lease is dedicated to the well, outline each and identify the ownership thereof (both as to working interest and royalty).
3. If more than one lease of different ownership is dedicated to the well, have the interests of all owners been consolidated by communitization, unitization, force-pooling, etc?

Yes No If answer is "yes," type of consolidation _____

If answer is "no," list the owners and tract descriptions which have actually been consolidated. (Use reverse side of this form if necessary.) _____

No allowable will be assigned to the well until all interests have been consolidated (by communitization, unitization, forced-pooling, or otherwise) or until a non-standard unit, eliminating such interests, has been approved by the Commission.

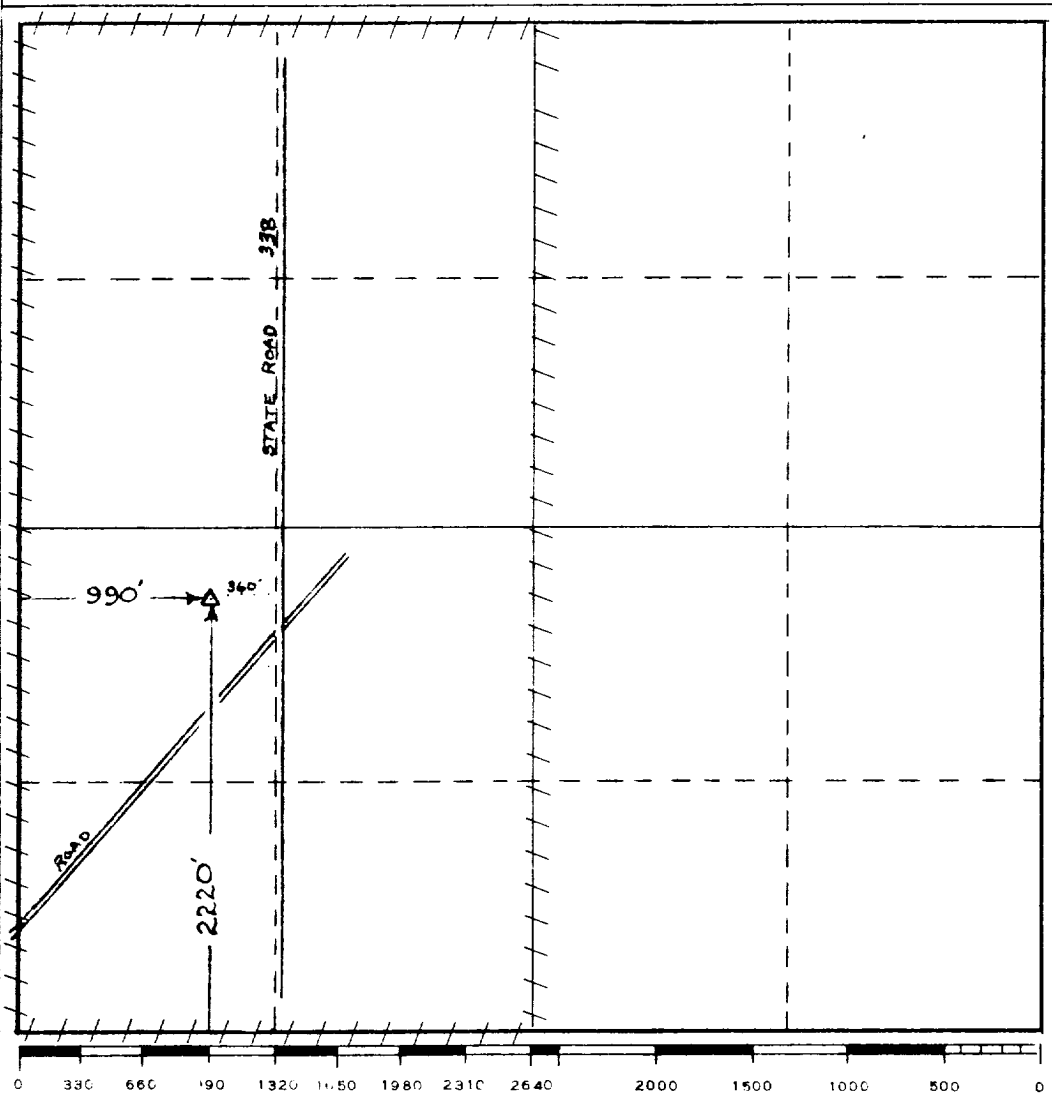

CERTIFICATION
<i>I hereby certify that the information contained herein is true and complete to the best of my knowledge and belief.</i>
Name: <i>Elizabeth S. Bush</i>
Position: Drlg. Engr.
Company: ARCO Oil and Gas Co. Div of Atlantic Richfield Co.
Date: 10/30/84
<i>I hereby certify that the well location shown on this plat was plotted from field notes of actual surveys made by me or under my supervision, and that the same is true and correct to the best of my knowledge and belief.</i>
Oct. 26, 1984
Date Surveyed: _____
Registered Professional Engineer and/or Land Surveyor: <i>Karl D. King</i>
Certificate No.: New Mexico No. 7250

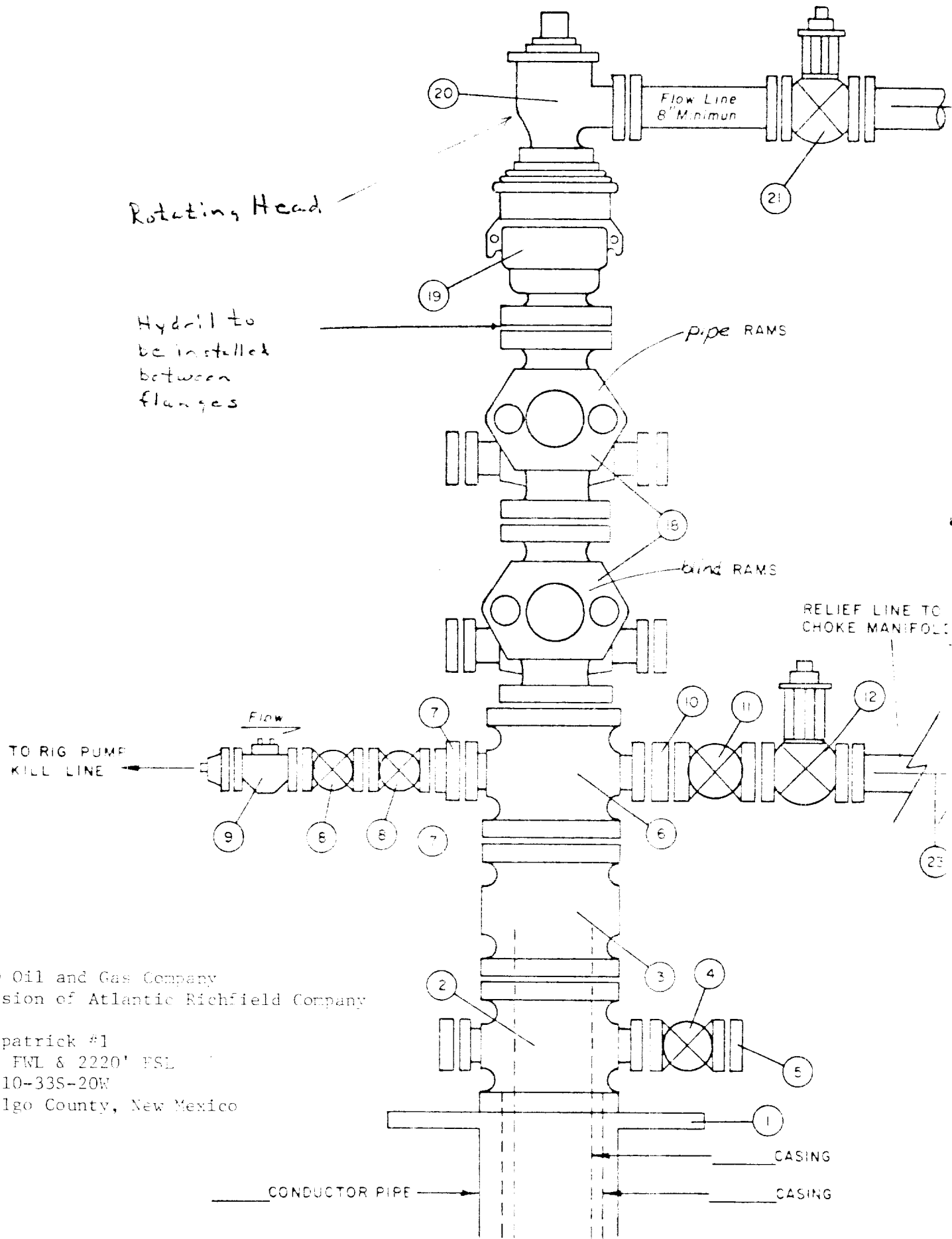

Rotating Head

Hydril to be installed between flanges

pipe RAMS

blind RAMS

RELIEF LINE TO CHOKE MANIFOLD

TO RIG PUMP KILL LINE

Flow

ARCO Oil and Gas Company
 Division of Atlantic Richfield Company

Fitzpatrick #1
 990' FWL & 2220' ESL
 Sec 10-33S-20W
 Hidalgo County, New Mexico

CONDUCTOR PIPE

CASING

CASING