

NO. OF COPIES RECEIVED	5
DISTRIBUTION	
SANTA FE	1
FILE	1
U.S.G.S.	5
LAND OFFICE	1
OPERATOR	1

**RECEIVED**  
NEW MEXICO OIL CONSERVATION COMMISSION

Form C-101  
Revised 1-1-65

**AUG 30 1974**

**O. C. C.**  
**ARTESIA, OFFICE**

5A. Indicate Type of Lease  
STATE  FEE

5. State Oil & Gas Lease No.  
*B-4575*

**APPLICATION FOR PERMIT TO DRILL, DEEPEN, OR PLUG BACK**

1a. Type of Work		7. Unit Agreement Name	
b. Type of Well DRILL <input type="checkbox"/> DEEPEN <input type="checkbox"/> PLUG BACK <input checked="" type="checkbox"/> OIL WELL <input checked="" type="checkbox"/> GAS WELL <input type="checkbox"/> OTHER <input type="checkbox"/> SINGLE ZONE <input type="checkbox"/> MULTIPLE ZONE <input type="checkbox"/>		8. Farm or Lease Name <i>Delhi State</i>	
2. Name of Operator <i>John R. Gray</i>		9. Well No. <i>1</i>	
3. Address of Operator <i>P.O. Box 304, Artesia, New Mexico</i>		10. Field and Pool, or Wildcat <i>Und. E. Empire-Yates-SR</i>	
4. Location of Well UNIT LETTER <i>N</i> LOCATED <i>660</i> FEET FROM THE <i>South</i> LINE AND <i>1980</i> FEET FROM THE <i>West</i> LINE OF SEC. <i>28</i> TWP. <i>17S</i> RGE. <i>28W</i> NMPM <i>1950</i>		12. County <i>Eddy</i>	
		19. Proposed Depth <i>800'</i>	19A. Formation <i>Seven Rivers</i>
		20. Rotary or C.T. <i>C.T.</i>	
21. Elevations (Show whether DF, RT, etc.) <i>3683 G.L.</i>	21A. Kind & Status Plug, Bond <i>Active - Statewide</i>	21B. Drilling Contractor <i>Wesley H. Co. Inc.</i>	22. Approx. Date Work will start <i>Aug. 30, 1974</i>

23.

**PROPOSED CASING AND CEMENT PROGRAM**

SIZE OF HOLE	SIZE OF CASING	WEIGHT PER FOOT	SETTING DEPTH	SACKS OF CEMENT	EST. TOP
10"	8 5/8"	24 lbs.	545'	35	
8"	4 1/2"	9.5 lbs.	2006'	75	

*Well has been producing from perfs at 1932 - 1948 in the Red Lake pool. We propose to set wire line Bridge Plug at 1920' with 3 sacks cement on top, cut off 4 1/2" and pull some. Set 25 sack plug at top of 4 1/2" stub, 25 sack plug 975' and run 4 1/2 back to approx. 800' and cement on. Complete in Seven Rivers formation.*

IN ABOVE SPACE DESCRIBE PROPOSED PROGRAM; IF PROPOSAL IS TO DEEPEN OR PLUG BACK, GIVE DATA ON PRESENT PRODUCTIVE ZONE AND PROPOSED NEW PRODUCTIVE ZONE. GIVE BLOWOUT PREVENTER PROGRAM, IF ANY.

I hereby certify that the information above is true and complete to the best of my knowledge and belief.

Signed *William G. ...* Title Agent Date 8-30-74

(This space for State Use)

APPROVED BY *W. A. Gressett* TITLE OIL AND GAS INSPECTOR DATE SEP 3 1974

CONDITIONS OF APPROVAL, IF ANY:

NEW MEXICO OIL CONSERVATION COMMISSION  
WELL LOCATION AND ACREAGE DEDICATION PLAT

Form C-102  
Supersedes C-128  
Effective 1-1-65

All distances must be from the outer boundaries of the Section.

Operator <i>John R. Gray</i>		Lease <i>Delhi State</i>		Well No. <i>1</i>
Unit Letter <i>N</i>	Section <i>28</i>	Township <i>17 S</i>	Range <i>28 E</i>	County <i>Eddy</i>
Actual Footage Location of Well: <i>660'</i> feet from the <i>South</i> line and <i>1980'</i> feet from the <i>West</i> line				
Ground Level Elev. <i>3683</i>	Producing Formation <i>Seven Rivers</i>	Pool <i>Und. E. Empire Yates SR</i>	Dedicated Acreage: <i>40</i> Acres	

1. Outline the acreage dedicated to the subject well by colored pencil or hachure marks on the plat below.
2. If more than one lease is dedicated to the well, outline each and identify the ownership thereof (both as to working interest and royalty).
3. If more than one lease of different ownership is dedicated to the well, have the interests of all owners been consolidated by communitization, unitization, force-pooling, etc?

**RECEIVED**  
**SEP - 3 1974**

Yes  No If answer is "yes," type of consolidation \_\_\_\_\_

**O. C. C.**  
**ARTESIA, OFFICE**

If answer is "no," list the owners and tract descriptions which have actually been consolidated. (Use reverse side of this form if necessary.) \_\_\_\_\_

No allowable will be assigned to the well until all interests have been consolidated (by communitization, unitization, forced-pooling, or otherwise) or until a non-standard unit, eliminating such interests, has been approved by the Commission.

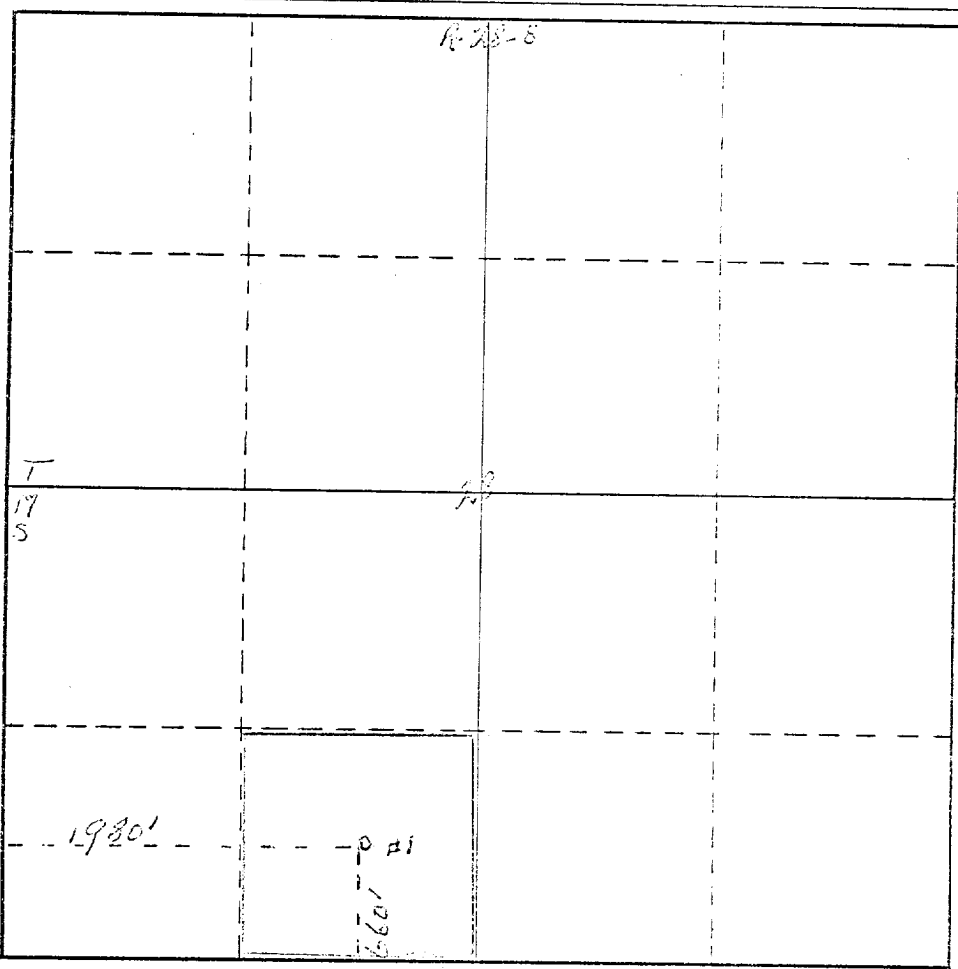

CERTIFICATION

I hereby certify that the information contained herein is true and complete to the best of my knowledge and belief.

Name: *Alicia Anderson*  
 Position: *Agent*  
 Company: *John R. Gray*  
 Date: *Aug. 30, 1974*

I hereby certify that the well location shown on this plat was plotted from field notes of actual surveys made by me or under my supervision, and that the same is true and correct to the best of my knowledge and belief.

Date Surveyed: \_\_\_\_\_  
 Registered Professional Engineer and/or Land Surveyor: \_\_\_\_\_

Certificate No. \_\_\_\_\_

