

Submit to Appropriate District Office  
State Lease - 6 copies  
Fee Lease - 5 copies

State of New Mexico  
Energy, Minerals and Natural Resources Department

Form C-101  
Revised 1-1-89

**OIL CONSERVATION DIVISION**

DISTRICT I  
P.O. Box 1980, Hobbs, NM 88240

P.O. Box 2088  
Santa Fe, New Mexico 87504-2088

DISTRICT II  
P.O. Drawer DD, Artesia, NM 88210

DEC 11 '89

DISTRICT III  
1000 Rio Brazos Rd., Aztec, NM 87410

API NO. (assigned by OCD on New Wells)  
**30-015-01652**

5. Indicate Type of Lease  
STATE  FEB

6. State Oil & Gas Lease No.  
**B-10021**

**APPLICATION FOR PERMIT TO DRILL, DEEPEN, OR PLUG BACK**

1a. Type of Work:  
DRILL  RE-ENTER  DEEPEN  PLUG BACK

b. Type of Well:  
OIL WELL  GAS WELL  OTHER   
SINGLE ZONE  MULTIPLE ZONE

2. Name of Operator  
**Kersey & Co.**

3. Address of Operator  
**808 Grand, Artesia, N. Mex.**

4. Well Location  
Unit Letter **G** : **2288** Feet From The **North** Line and **1625** Feet From The **East** Line  
Section **31** Township **17S** Range **28E** NMPM **Eddy** County

7. Lease Name or Unit Agreement Name  
**Boling**

8. Well No.  
**Boling #1**

9. Pool name or Wildcat  
**Red Lake G-G-SA**

10. Proposed Depth  
11. Formation  
12. Rotary or C.T.

13. Elevations (Show whether DF, RT, GR, etc.)  
14. Kind & Status Plug. Bond  
15. Drilling Contractor  
16. Approx. Date Work will start

17. PROPOSED CASING AND CEMENT PROGRAM

SIZE OF HOLE	SIZE OF CASING	WEIGHT PER FOOT	SETTING DEPTH	SACKS OF CEMENT	EST. TOP
11"	8 5/8"	22.7 @ 24	763	350	1196'
8"	5 1/2"	14#	6025	750	1690'

- Plan to drill out retainer and cement to 1925'.
- Will log and perforate Grayburg zone around 1900'.
- Will acidize Grayburg zone with 2000 Gallons Acid.
- Will fracture this zone with 40,000 Gallons and 50M# sand.
- Will clean out sand and put well on the pump.

Post ID  
12-15-89  
Re-entry

Former:  
ARCO Oil & Gas  
Emp. About Feb  
P&A: 12-20-89  
STD: 6025

IN ABOVE SPACE DESCRIBE PROPOSED PROGRAM: IF PROPOSAL IS TO DEEPEN OR PLUG BACK, GIVE DATA ON PRESENT PRODUCTIVE ZONE AND PROPOSED NEW PRODUCTIVE ZONE. GIVE BLOWOUT PREVENTER PROGRAM, IF ANY.

I hereby certify that the information above is true and complete to the best of my knowledge and belief.

SIGNATURE Harold Kersey TITLE OWNER DATE Nov. 28, 1989  
TYPE OR PRINT NAME Harold Kersey TELEPHONE NO. 746-3671

(This space for State Use)  
APPROVED BY MIKE WILLIAMS SUPERVISOR, DISTRICT II TITLE \_\_\_\_\_ DATE DEC 13 1989

CONDITIONS OF APPROVAL, IF ANY:

APPROVAL VALID FOR 180 DAYS  
PERMIT EXPIRES 6-13-90  
UNLESS DRILLING UNDERWAY

NEW MEXICO OIL CONSERVATION COMMISSION  
**WELL LOCATION AND ACREAGE DEDICATION** **JUL 8 1960**

**RECEIVED**

FORM C-128  
 Revised 5/1/57

SEE INSTRUCTIONS FOR COMPLETING THIS FORM ON THE REVERSE SIDE

**SECTION A**

Pan American PET. CORP.		Lease STATE "CC"		ARTERIA OFFICE		Well No. 1	
Section 31	Township 17S	Range 28E	County EDDY				

Well Location of Well: 1625.15 feet from the NORTH line and 1625.15 feet from the EAST line

Producing Formation: Abo	Pool: Empire Abo	Dedicated Acreage: 40 Acres
--------------------------	------------------	-----------------------------

Is the only owner in the dedicated acreage outlined on the plat below? YES  NO  "Owner" means the person who has the right to drill into and to produce from any pool and to appropriate the production either for himself or for himself and others.

If answer is "no," have the interests of all the owners been consolidated by communitization agreement or other means? NO  YES  If answer is "yes," Type of Consolidation \_\_\_\_\_

If answer to question two is "yes," list all the owners and their respective interests below:

Land Description

**SECTION B**

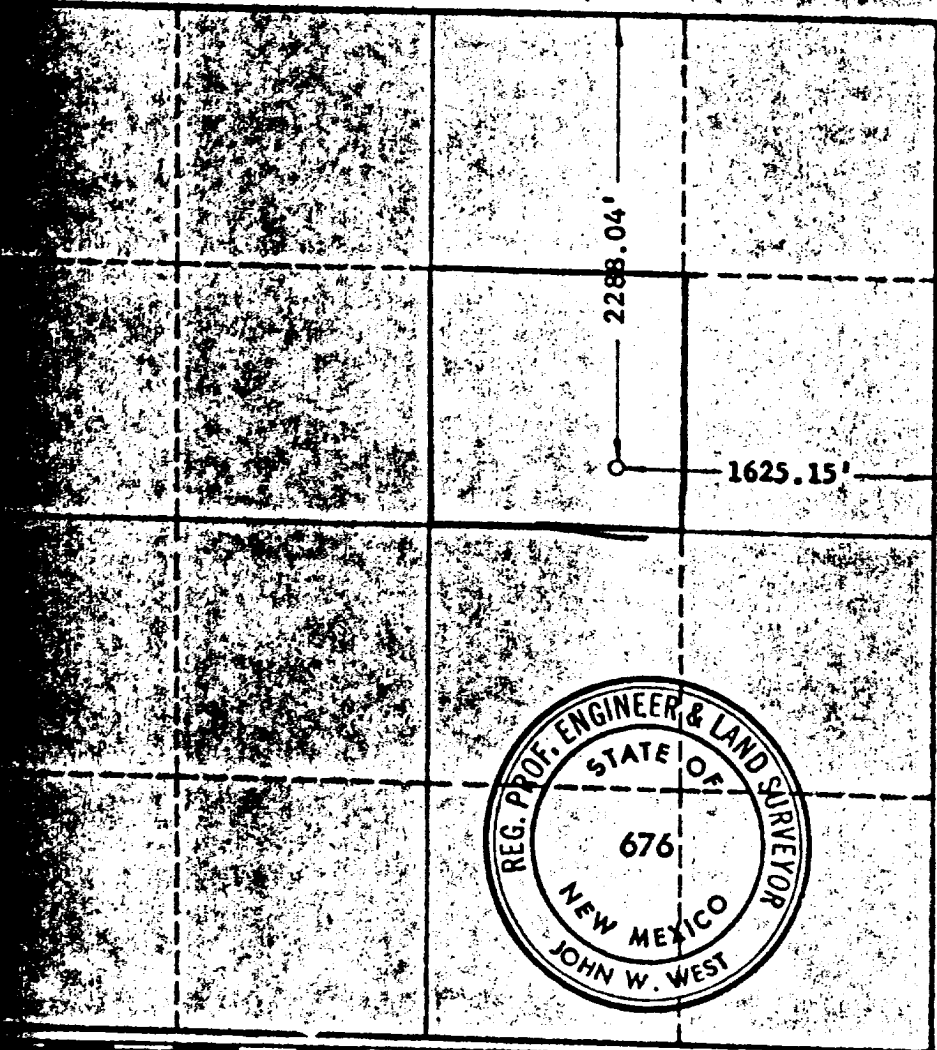

**CERTIFICATION**

I hereby certify that the information in SECTION A above is true and complete to the best of my knowledge and belief.

Name: Original Signed by J. W. BROWN  
 Position: Area Superintendent  
 Company: Pan American Petroleum Corp.  
 Date: July 14, 1960

I hereby certify that the well location shown on the plat in SECTION B was plotted from field notes of actual surveys made by me or under my supervision, and that the same is true and correct to the best of my knowledge and belief.

Date Surveyed: 7/1/60  
 Registered Professional Engineer and/or Land Surveyor, JOHN W. WEST

*John W. West*  
 Certificate No. N.M. - P.E. & L.S. NO 878

