

(SUBMIT IN TRIPLICATE)

Land Office **Las Cruces**

Lease No. **042443**

Unit **RECEIVED**

AUG 25 1961

D. C. F. ARTESIA, OFFICE

APPROVED
AUG 24 1961
James A. Knauf
JAMES A. KNAUF
DISTRICT ENGINEER

**UNITED STATES
DEPARTMENT OF THE INTERIOR
GEOLOGICAL SURVEY**

SUNDRY NOTICES AND REPORTS ON WELLS

NOTICE OF INTENTION TO DRILL.....	<input checked="" type="checkbox"/>	SUBSEQUENT REPORT OF WATER SHUT-OFF.....	
NOTICE OF INTENTION TO CHANGE PLANS.....		SUBSEQUENT REPORT OF SHOOTING OR ACIDIZING.....	
NOTICE OF INTENTION TO TEST WATER SHUT-OFF.....		SUBSEQUENT REPORT OF ALTERING CASING.....	
NOTICE OF INTENTION TO RE-DRILL OR REPAIR WELL.....		SUBSEQUENT REPORT OF RE-DRILLING OR REPAIR.....	
NOTICE OF INTENTION TO SHOOT OR ACIDIZE.....		SUBSEQUENT REPORT OF ABANDONMENT.....	
NOTICE OF INTENTION TO PULL OR ALTER CASING.....		SUPPLEMENTARY WELL HISTORY.....	
NOTICE OF INTENTION TO ABANDON WELL.....			

(INDICATE ABOVE BY CHECK MARK NATURE OF REPORT, NOTICE, OR OTHER DATA)

August 23, 19**61**

Federal "TV"
Well No. **2-5** is located **1900** ft. from **{N}** line and **1900** ft. from **{E}** line of sec. **5**

N44E24 Sec. 5 **14S** **31E** **N.M.P.M.**
(1/4 Sec. and Sec. No.) (Twp.) (Range) (Meridian)
North Square Lake Grayburg **444** **New Mexico**
(Field) (County or Subdivision) (State or Territory)

The elevation of the derrick floor above sea level is **4083** ft.

DETAILS OF WORK

(State names of and expected depths to objective sands; show sizes, weights, and lengths of proposed casings; indicate mudding jobs, cementing points, and all other important proposed work)

We plan to drill a 3500' Grayburg core with rotary tools.

We propose to set approximately 835' of 8 5/8" surface casing in the top of the Anhydrite with 75 sacks.

We expect to run a 4 1/2" oil string through the pay sand and cement with 100 sacks. Cement must cover the Red Sand

All casing will be run and cemented under methods approved by the U. S. Geological Survey

RECEIVED

AUG 24 1961

**U. S. GEOLOGICAL SURVEY
ARTESIA, NEW MEXICO**

I understand that this plan of work must receive approval in writing by the Geological Survey before operations may be commenced.

Company **John H. Trigg**

Address **P. O. Box 520**

Roswell, New Mexico

By *John H. Trigg*
Title **Owner**

NEW MEXICO OIL CONSERVATION COMMISSION
WELL LOCATION AND ACREAGE DEDICATION PLAT

RECEIVED
 FORM C-128
 Revised 5/1/57

AUG 25 1961

SEE INSTRUCTIONS FOR COMPLETING THIS FORM ON THE REVERSE SIDE

SECTION A

Operator John H. Trigg		Lease Federal PV		D. C. C. ARTESIA PRG. 2-5	
Unit Letter J	Section 5	Township 16 S	Range 31 E	County Eddy	
Actual Footage Location of Well: 1980 feet from the South line and 1980 feet from the East line					
Ground Level Elev. *** 4023'	Producing Formation Osageburg Sand	Pool North Square Lake	Dedicated Acreage: 40 Acres		

1. Is the Operator the only owner in the dedicated acreage outlined on the plat below? YES NO . ("Owner" means the person who has the right to drill into and to produce from any pool and to appropriate the production either for himself or for himself and another. (65-3-29 (e) NMSA 1935 Comp.)
2. If the answer to question one is "no," have the interests of all the owners been consolidated by communitization agreement or otherwise? YES NO . If answer is "yes," Type of Consolidation _____
3. If the answer to question two is "no," list all the owners and their respective interests below:

RECEIVED
 AUG 24 1961
 U.S. GEOLOGICAL SURVEY
 ARTESIA, NEW MEXICO

Owner	Land Description

SECTION B

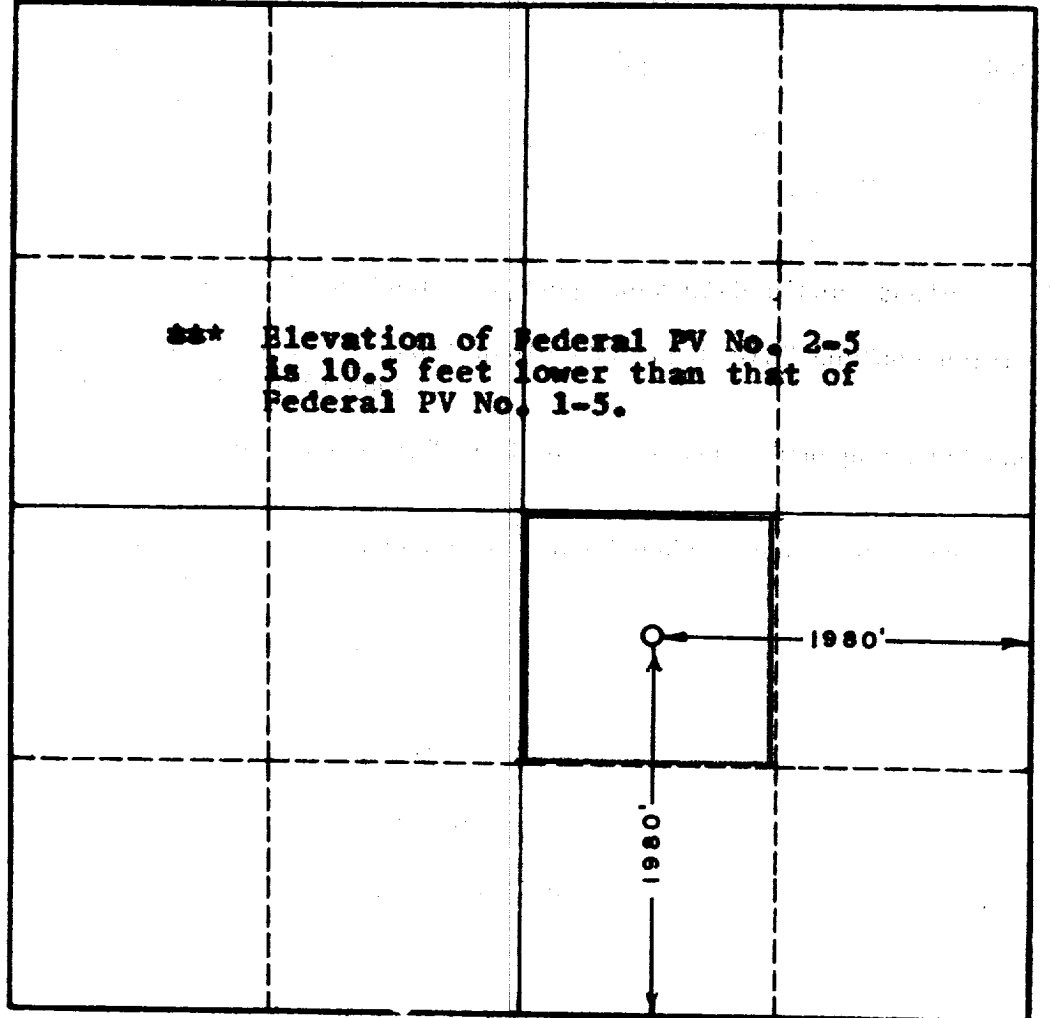

CERTIFICATION

I hereby certify that the information in SECTION A above is true and complete to the best of my knowledge and belief.

Name: John H. Trigg
 Position: _____
 Company: _____
 Date: August 23, 1961

I hereby certify that the well location shown on the plat in SECTION B was plotted from field notes of actual surveys made by me or under my supervision, and that the same is true and correct to the best of my knowledge and belief.

Date Surveyed: **July 21, 1960**
 Registered Professional Engineer and/or Land Surveyor, **JOHN W. WEST**
John W. West
 Certificate No. **N. M. - P. E. & L. S. NO. 676**

