

Form 9-881a  
(Feb. 1961)

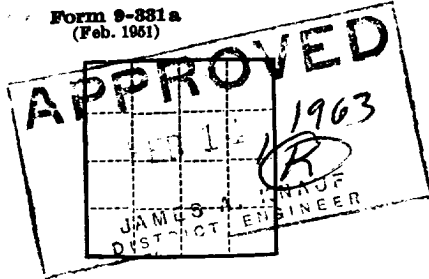

(SUBMIT IN TRIPLICATE)

UNITED STATES  
DEPARTMENT OF THE INTERIOR  
GEOLOGICAL SURVEY

Land Office .....

Lease No. 12-058702(b)

Unit .....

*copy in 87*

SUNDRY NOTICES AND REPORTS ON WELLS

NOTICE OF INTENTION TO DRILL.....	SUBSEQUENT REPORT OF WATER SHUT-OFF.....
NOTICE OF INTENTION TO CHANGE PLANS.....	SUBSEQUENT REPORT OF SHOOTING OR ACIDIZING.....
NOTICE OF INTENTION TO TEST WATER SHUT-OFF.....	SUBSEQUENT REPORT OF ALTERING CASING.....
NOTICE OF INTENTION TO RE-DRILL OR REPAIR WELL.....	SUBSEQUENT REPORT OF RE-DRILLING OR REPAIR.....
NOTICE OF INTENTION TO SHOOT OR ACIDIZE.....	SUBSEQUENT REPORT OF ABANDONMENT.....
NOTICE OF INTENTION TO PULL OR ALTER CASING.....	SUPPLEMENTARY WELL HISTORY.....
NOTICE OF INTENTION TO ABANDON WELL.....	

(INDICATE ABOVE BY CHECK MARK NATURE OF REPORT, NOTICE, OR OTHER DATA)

February 13, 1963, 19.....

~~XXXXX~~ Johnson  
Merced

Well No. No. 7 is located 500 ft. from [N] line and 100 ft. from [E] line of sec. 2

1/4 1/4 Sec. 28 (1/4 Sec. and Sec. No.)      16S (Twp.)      31E (Range)      M.P. (Meridian)  
Quincy (Field)      Ady (County or Subdivision)      New Mexico (State or Territory)

RECEIVED

FEB 19 1963

O. C. C.  
ARTESIA, OFFICE

The elevation of the derrick floor above sea level is ..... ft.

DETAILS OF WORK

(State names of and expected depths to objective sands; show sizes, weights, and lengths of proposed casings; indicate mudding jobs, cementing points, and all other important proposed work)

We propose to clean out to 3650 and drill new hole to approximately 3650. We will run 10" casing and cement. We will run 3650 5 1/2" casing and cement. We propose to perforate zones as indicated from logs, frac with 20,000 gallons gelled water and 15,500 lbs sand. Run 2" tubing with packer, 1" tubing with packer, and hook well up for dual injection.

This well was drilled as S. B. Gappes No. 7 Johnson "E" and erroneously reported as 660/S + 1960/E.

I understand that this plan of work must receive approval in writing by the Geological Survey before operations may be commenced.

Company San Antonio Company

Address Wiley Building

Artesia, New Mexico

By ORIGINAL SIGNED BY  
H. J. LEDBETTER

Title Superintendent

NUMBER OF COPIES RECEIVED	
DISTRIBUTION	
SANTA FE	
FILE	
U.S.G.S.	
LAND OFFICE	
TRANSPORTER	OIL
	GAS
PRODUCTION OFFICE	
OPERATOR	

FORM C-128  
Revised 5/1/57

**NEW MEXICO OIL CONSERVATION COMMISSION**  
**WELL LOCATION AND ACREAGE DEDICATION PLAT**  
**SEE INSTRUCTIONS FOR COMPLETING THIS FORM ON THE REVERSE SIDE**

**SECTION A**

Operator <b>Newmont Oil Company</b>		Lease <del>Federal Johnson XXXXX</del> Sheldon		Well No. <b>7</b>
Unit Letter <b>0</b>	Section <b>28</b>	Township <b>16 South</b>	Range <b>31 East</b>	County <b>Eddy</b>
Actual Footage Location of Well: <b>560 760</b> feet from the <b>South</b> line and <b>1980</b> feet from the <b>East</b> line				
Ground Level Elev. <b>3998</b>	Producing Formation <b>Grayburg-San Andres</b>	Pool <b>Square Lake</b>	Dedicated Acreage: <b>40</b> Acres	

1. Is the Operator the only owner in the dedicated acreage outlined on the plat below? YES  NO . ("Owner" means the person who has the right to drill into and to produce from any pool and to appropriate the production either for himself or for himself and another. (65-3-29 (e) NMSA 1935 Comp.)
2. If the answer to question one is "no," have the interests of all the owners been consolidated by communitization agreement or otherwise? YES  NO . If answer is "yes," Type of Consolidation \_\_\_\_\_
3. If the answer to question two is "no," list all the owners and their respective interests below:

Owner	Land Description

**SECTION B**

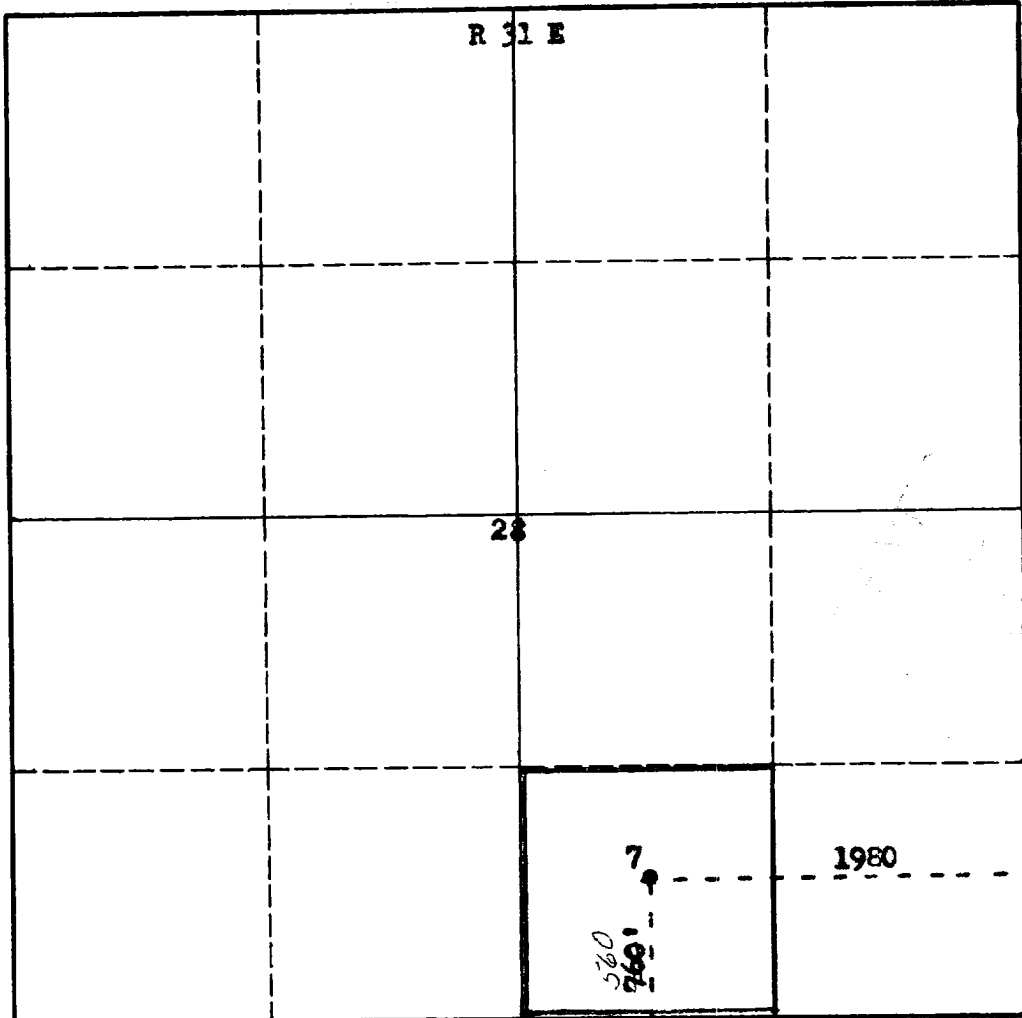

**CERTIFICATION**

I hereby certify that the information in SECTION A above is true and complete to the best of my knowledge and belief.

Name	ORIGINAL SIGNED BY <b>H. J. LEDBETTER</b>
Position	<b>Superintendent</b>
Company	<b>Newmont Oil Company</b>
Date	<b>February 13, 1963</b>

I hereby certify that the well location shown on the plat in SECTION B was plotted from field notes of actual surveys made by me or under my supervision, and that the same is true and correct to the best of my knowledge and belief.

Date Surveyed	<b>February 8, 1963</b>
Registered Professional Engineer and/or Land Surveyor	

Certificate No. *[Signature]*

T  
16  
S

## INSTRUCTIONS FOR COMPLETION OF FORM C-128

1. Operator shall furnish and certify to the information called for in Section A.
2. Operator shall outline the dedicated acreage for *both* oil and gas wells on the plat in Section B.
3. A registered professional engineer or land surveyor registered in the State of New Mexico or approved by the Commission shall show on the plat the location of the well and certify this information in the space provided.
4. All distances shown on the plat must be from the outer boundaries of the Section.
5. If additional space is needed for listing owners and their respective interests as required in question 3 of Section A, please use space below.