

NEW MEXICO OIL CONSERVATION COMMISSION
Santa Fe, New Mexico

Form C-101
Revised (12/1/55)

NOTICE OF INTENTION TO DRILL

Notice must be given to the District Office of the Oil Conservation Commission and approval obtained before drilling or recompletion begins. If changes in the proposed plan are considered advisable, a copy of this notice showing such changes will be returned to the sender. Submit this notice in QUINTUPLICATE. One copy will be returned following approval. See additional instructions in Rules and Regulations of the Commission. If State Land submit 6 Copies Attach Form C-128 in triplicate to first 3 copies of form C-101

Roswell, N.M.
(Place)

12/10/56

(Date)

OIL CONSERVATION COMMISSION
SANTA FE, NEW MEXICO

Gentlemen:

You are hereby notified that it is our intention to commence the Drilling of a well to be known as

John M. Kelly

(Company or Operator)

Elk State A

(Lease)

, Well No. 1, in K The well is

(Unit)

located 1650 feet from the West line and 1650 feet from the South line of Section 5, T. 17, R. 29, NMPM.

(GIVE LOCATION FROM SECTION LINE)

wildcat Pool, Eddy County

If State Land the Oil and Gas Lease is No.

If patented land the owner is.

Address.

We propose to drill well with drilling equipment as follows:

The status of plugging bond is Blanket bond on file

Drilling Contractor Donnelly Drilling Co
Artesia, N.M.

We intend to complete this well in the Grayburg formation at an approximate depth of 2400 feet.

CASING PROGRAM

We propose to use the following strings of Casing and to cement them as indicated:

Size of Hole	Size of Casing	Weight per Foot	New or Second Hand	Depth	Sacks Cement
10 1/2	8 5/8	24	New	250	100
8 1/2	5 1/2	15.5	New	2350	200

If changes in the above plans become advisable we will notify you immediately.

ADDITIONAL INFORMATION (If recompletion give full details of proposed plan of work.)

Approved, 19.....
Except as follows:

OIL CONSERVATION COMMISSION

By M. L. Armstrong

Sincerely yours,

JOHN M. KELLY

(Company or Operator)

By John M. Kelly

Position Operator
Send Communications regarding well to

Name John M. Kelly

Address Box 5671 Roswell

NEW MEXICO
OIL CONSERVATION COMMISSION

Form C-128

Well Location and/or Gas Proration Plat

Date 12/9/56

Operator JOHN M. KELLY

Lease Elk State "A"

Well No. 1 Section 5 Township 17 Range 29 NMPM

Located 1650 Feet From South Line, 1650 Feet From West Line,

Eddy

County, New Mexico. G. L. Elevation _____

Name of Producing Formation _____ Pool _____ Dedicated Acreage _____

(Note: All distances must be from outer boundaries of Section)

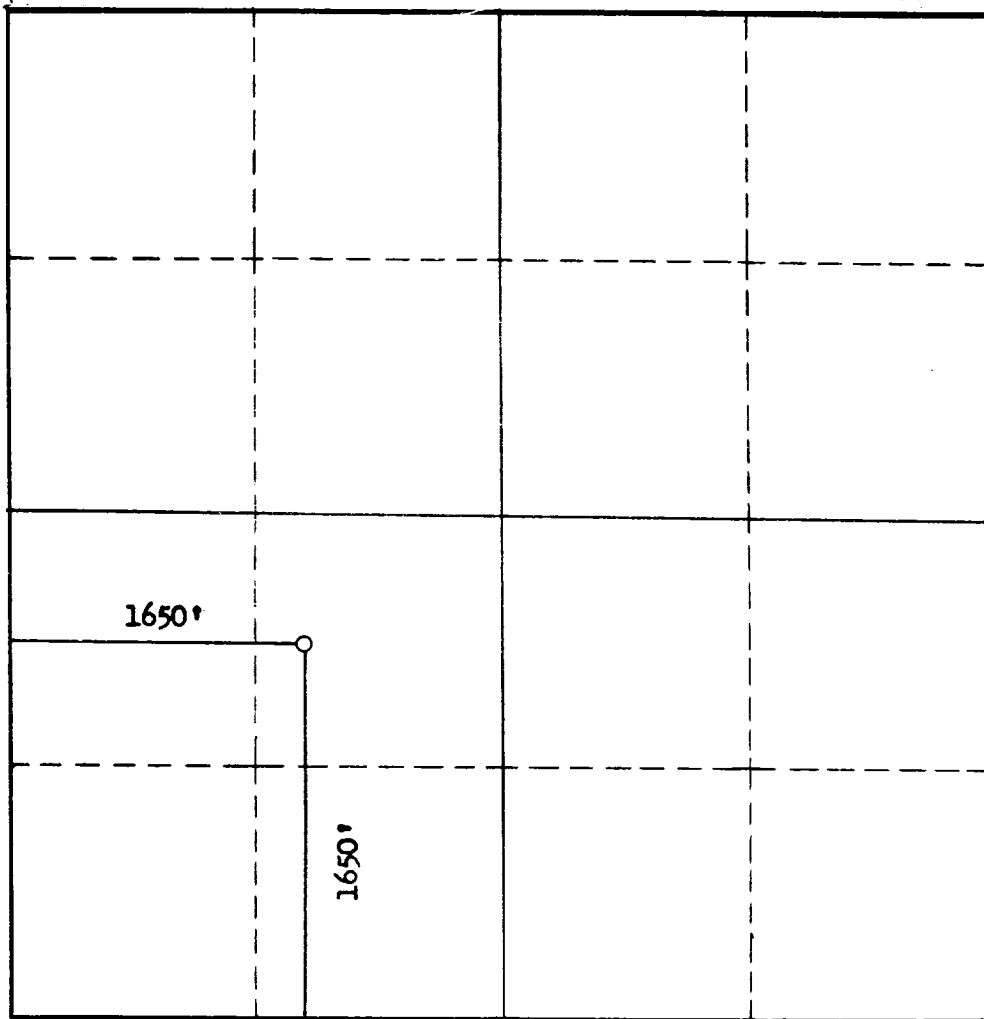

SCALE: 1"=1000'

1. Is this Well a Dual Comp. ? Yes ___ No ___.
2. If the answer to Question 1 is yes, are there any other dually completed wells within the dedicated acreage? Yes ___ No ___.

This is to certify that the above plat was prepared from field notes of actual surveys made by me or under my supervision and that the same are true and correct to the best of my knowledge and belief.

Name _____
Position _____
Representing _____
Address _____

Date Surveyed 12/8/56

George A. Denishfeld
Registered Professional Engineer and/or
Land Surveyor