

(SUBMIT IN TRIPLICATE)

UNITED STATES
DEPARTMENT OF THE INTERIOR
GEOLOGICAL SURVEY

Budget Bureau No. 42-R388.4
Approval expires 12-31-60.

Las Cruces

Land Office

LC 062407

Lease No.

Unit

30-015-03220

SUNDRY NOTICES AND REPORTS ON WELLS

NOTICE OF INTENTION TO DRILL	<input checked="" type="checkbox"/>	SUBSEQUENT REPORT OF WATER SHUT-OFF	
NOTICE OF INTENTION TO CHANGE PLANS		SUBSEQUENT REPORT OF SHOOTING OR ACIDIZING	
NOTICE OF INTENTION TO TEST WATER SHUT-OFF		SUBSEQUENT REPORT OF ALTERING CASING	
NOTICE OF INTENTION TO RE-DRILL OR REPAIR WELL		SUBSEQUENT REPORT OF RE-DRILLING OR REPAIR	
NOTICE OF INTENTION TO SHOOT OR ACIDIZE		SUBSEQUENT REPORT OF ABANDONMENT	
NOTICE OF INTENTION TO PULL OR ALTER CASING		SUPPLEMENTARY WELL HISTORY	
NOTICE OF INTENTION TO ABANDON WELL			

(INDICATE ABOVE BY CHECK MARK NATURE OF REPORT, NOTICE, OR OTHER DATA)

Leonard Fed.

September 15, 1958

Well No. 3 is located 1980 ft. from N line and 1980 ft. from 1/4 line of sec. 33
SE 1/4 NW 1/4 Sec. 33 17 S 29 E NMPN
(1/4 Sec. and Sec. No.) (Twp.) (Range) (Meridian)
Grayburg-Jackson Eddy New Mexico
(Field) (County or Subdivision) (State or Territory)

The elevation of the derrick floor above sea level is _____ ft. Will report later.

DETAILS OF WORK

(State names of and expected depths to objective sands; show sizes, weights, and lengths of proposed casings; indicate mudlogging jobs, cementing points, and all other important proposed work)

We intend to drill the above well with cable tools to a depth of 2750'.
 We will run 8 5/8" new 24# seamless csg. to approximately 350' and cement same with 100 sax neat cement for surface water shut off and will run 5 1/2" new 14# seamless csg. for production string and cement same with 125 sax neat cement. Run Gamma-Ray Neutron log, perforate and Sand-oil free indicated producing zones.

I understand that this plan of work must receive approval in writing by the Geological Survey before operations may be commenced.

Company Western Development Company of Delaware

Address P. O. Box 427
Artesia, New Mexico

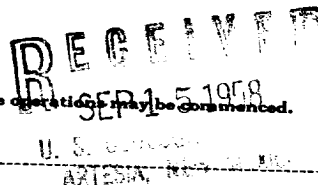

By [Signature]
 Title Dist. Supt.

NEW MEXICO OIL CONSERVATION COMMISSION
Well Location and Acreage Dedication Plat

Section A.

Date September 15, 1958

Operator Western Development Company
of Delaware Lease Leonard Federal
Well No. 3 Unit Letter F Section 33 Township 17 S Range 29 E NMPM
Located 1980 Feet From North Line, 1980 Feet From West Line
County Eddy G. L. Elevation _____ Dedicated Acreage 40 Acres
Name of Producing Formation Grayburg San Andres Pool Grayburg Jackson

1. Is the Operator the only owner* in the dedicated acreage outlined on the plat below?
Yes x No _____.
2. If the answer to question one is "no," have the interests of all the owners been consolidated by communitization agreement or otherwise? Yes _____ No _____. If answer is "yes," Type of Consolidation _____
3. If the answer to question two is "no," list all the owners and their respective interests below:

Owner

Land Description

<u>Owner</u>	<u>Land Description</u>

Section B

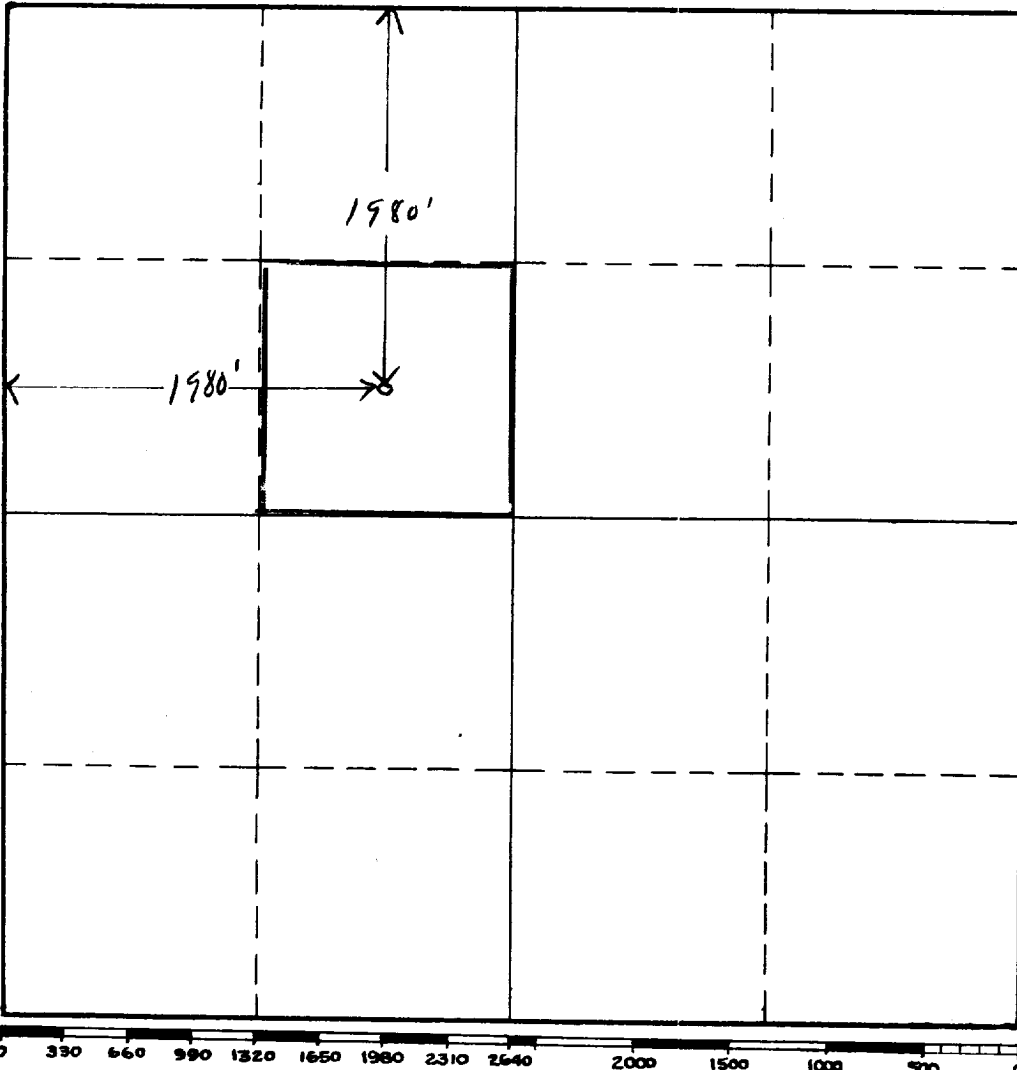

This is to certify that the information in Section A above is true and complete to the best of my knowledge and belief.

Western Development Company
(Operator) of Delaware
P. O. Larson
(Representative) Dist. Supt.

P. O. Box 427, Artesia, N.M.
Address

This is to certify that the well location shown on the plat in Section B was plotted from field notes of actual surveys made by me or under my supervision and that the same is true and correct to the best of my knowledge and belief.

Date Surveyed 9-15-58

W B Morey
Registered Professional
Engineer and/or Land Surveyor.

Certificate No. 926

(See instructions for completing this form on the reverse side)

INSTRUCTIONS FOR COMPLETION

1. Operator shall furnish and certify to the information called for in Section A.
2. Operator shall outline the dedicated acreage for both oil and gas wells on the plat in Section B.
3. A registered professional engineer or land surveyor registered in the State of New Mexico or approved by the Commission shall show on the plat the location of the well and certify this information in the space provided.
4. All distances shown on the plat must be from the outer boundaries of Section.
5. If additional space is needed for listing owners and their respective interests as required in question 3, Section A, please use space below

* "Owner" means the person who has the right to drill into and to produce from any pool and to appropriate the production either for himself or for himself and another. (65-3-29 (e) NMSA 1953 Comp.)