

Form 9-331a
(Feb. 1961)

Budget Bureau No. 42-R358.4.
Approval expires 12-31-60.

(SUBMIT IN TRIPLICATE)

UNITED STATES
DEPARTMENT OF THE INTERIOR
GEOLOGICAL SURVEY

Land Office Las Cruces
Lease No. 029420 (a)
Unit Dow "A"

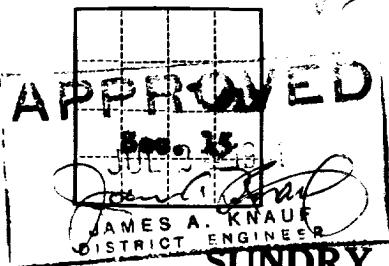

RECEIVED
JUL 26 1961

SUNDRY NOTICES AND REPORTS ON WELLS

NOTICE OF INTENTION TO DRILL.....	<input checked="" type="checkbox"/>	SUBSEQUENT REPORT OF WATER SHUT-OFF.....
NOTICE OF INTENTION TO CHANGE PLANS.....		SUBSEQUENT REPORT OF SHOOTING OR ACIDIZING.....
NOTICE OF INTENTION TO TEST WATER SHUT-OFF.....		SUBSEQUENT REPORT OF ALTERING CASING.....
NOTICE OF INTENTION TO RE-DRILL OR REPAIR WELL.....		SUBSEQUENT REPORT OF RE-DRILLING OR REPAIR.....
NOTICE OF INTENTION TO SHOOT OR ACIDIZE.....		SUBSEQUENT REPORT OF ABANDONMENT.....
NOTICE OF INTENTION TO PULL OR ALTER CASING.....		SUPPLEMENTARY WELL HISTORY.....
NOTICE OF INTENTION TO ABANDON WELL.....		

(INDICATE ABOVE BY CHECK MARK NATURE OF REPORT, NOTICE, OR OTHER DATA)

Hobbs, New Mexico - July 21, 1961

Dow "A"

Well No. 12 is located 1980 ft. from [N] line and 1980 ft. from [E] line of sec. 15

SW/4 NE/4 Sec. 15

(1/4 Sec. and Sec. No.)

17-S

(Twp.)

31-E

(Range)

T.M.P.M.

(Meridian)

Grayburg Jackson

(Field)

ddy

(County or Subdivision)

New Mexico

(State or Territory)

RECEIVED

JUL 24 1961

The elevation of the derrick floor above sea level is _____ ft.

DETAILS OF WORK

(State names of and expected depths to objective sands; show sizes, weights, and lengths of proposed casings; indicate mudding jobs, cementing points, and all other important proposed work)

Propose to drill with cable tools from surface to total depth of approximately 3700' in the San Andres Formation. Casing program to be approximately as follows:

Size Hole	Size Casing	Casing Point	Sacks Cement
16"	8-5/8"	760'	100
8"	5-1/2"	3575'	350

The Pump & Plug Process will be used in cementing both strings of casing. Well will be treated with approximately 1600 bbls. oil and 30,000# sand.

I understand that this plan of work must receive approval in writing by the Geological Survey before operations may be commenced.

Company Shelly Oil Company

Address Box 36

Hobbs, New Mexico

By

Title Dist. Supt.

RECEIVED

JUL 26 1961

FORM C-128
Revised 5/1/57D. C. C.
ARTESIA, OFFICENEW MEXICO OIL CONSERVATION COMMISSION
WELL LOCATION AND ACREAGE DEDICATION PLAT

SEE INSTRUCTIONS FOR COMPLETING THIS FORM ON THE REVERSE SIDE

SECTION A

Operator Skelly Oil Company			Lease Dow "A"		Well No. 12
Unit Letter G	Section 15	Township 17 South	Range 31 East	County Eddy	
Actual Postage Location of Well: 1980 feet from the North line and 1980 feet from the East line					
Ground Level Elev.	Producing Formation San Andres		Pool Grayburg Jackson	Dedicated Acreage: 40 Acres	

1. Is the Operator the only owner in the dedicated acreage outlined on the plat below? YES ☒ NO ☐ ("Owner" means the person who has the right to drill into and to produce from any pool and to appropriate the production either for himself or for himself and another. (65-3-29 (e) NMSA 1955 Comp.)
2. If the answer to question one is "no," have the interests of all the owners been consolidated by communitization agreement or otherwise? YES ☐ NO ☐ If answer is "yes," Type of Consolidation _____
3. If the answer to question two is "no," list all the owners and their respective interests below:

Owner	Land Description

RECEIVED

JUL 24 1961

U. S. GEOLOGICAL SURVEY
ARTESIA, NEW MEXICO

SECTION B

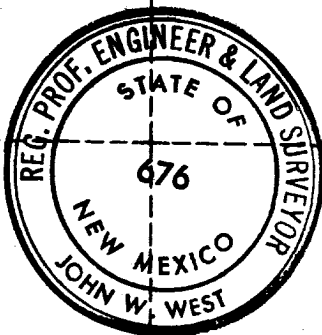
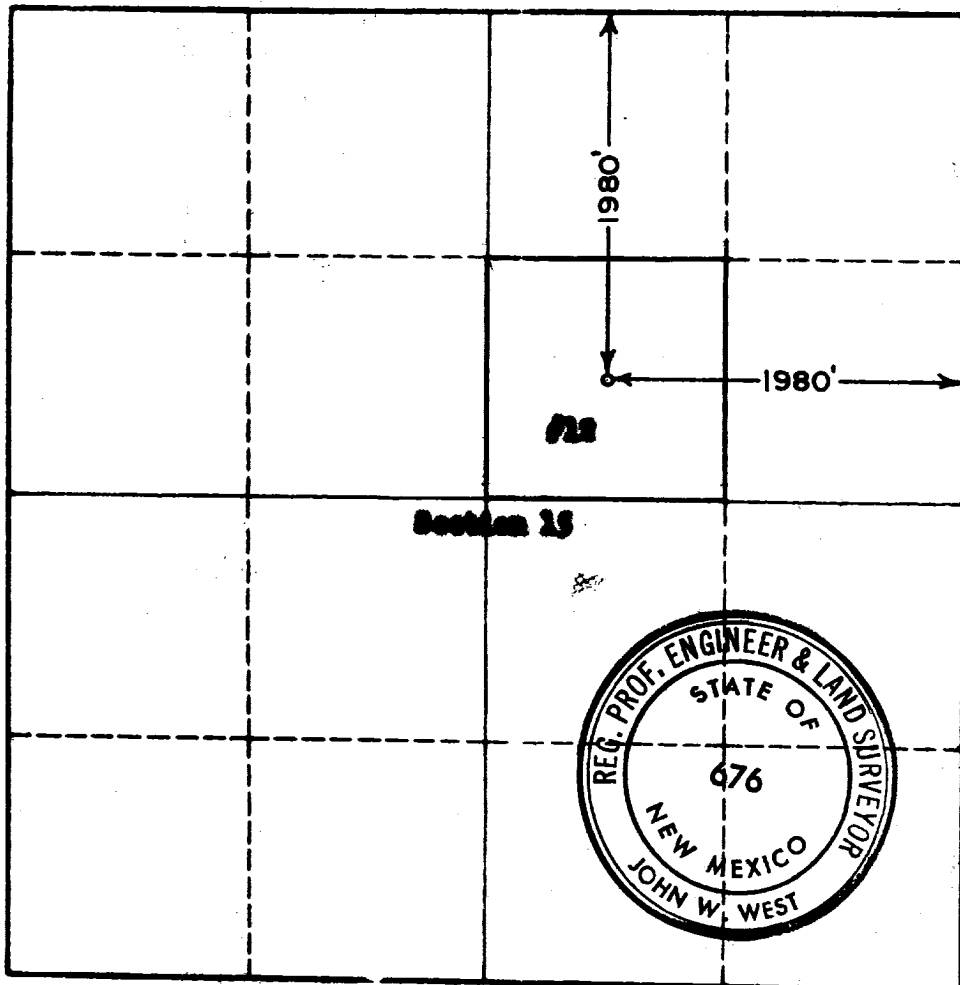

CERTIFICATION

I hereby certify that the information in SECTION A above is true and complete to the best of my knowledge and belief.

Name	J. E. Galt
Position	Dist. Supt.
Company	Skelly Oil Company
Date	July 21, 1961

I hereby certify that the well location shown on the plat in SECTION B was plotted from field notes of actual surveys made by me or under my supervision, and that the same is true and correct to the best of my knowledge and belief.

Date Surveyed	7-17-61
Registered Professional Engineer and/or Land Surveyor, JOHN W. WEST	John W. West
Certificate No.	N. M. - P. E. & L. S. NO. 676

0 330 660 990 1320 1650 1980 2310 2640 2000 1500 1000 500