

## NEW MEXICO OIL CONSERVATION COMMISSION

Santa Fe, New Mexico

RECEIVED

(Form C-104)  
Revised 7/1/57

JUL 13 1962

## REQUEST FOR (OIL) - (GAS) ALLOWABLE

New Well  
Recompletion

This form shall be submitted by the operator before an initial allowable will be assigned ~~on completion~~ Oil or Gas well. Form C-104 is to be submitted in QUADRUPLICATE to the same District Office to which Form C-101 was sent. The allowable will be assigned effective 7:00 A.M. on date of completion or recompletion, provided this form is filed during calendar month of completion or recompletion. The completion date shall be that date in the case of an oil well when new oil is delivered into the stock tanks. Gas must be reported on 15.025 psia at 60° Fahrenheit.

Artesia, New Mexico July 13, 1962

(Place)

(Date)

WE ARE HEREBY REQUESTING AN ALLOWABLE FOR A WELL KNOWN AS:

B. D. Collier

Friess

Well No. 1, in NW 1/4 SE 1/4,

(Company or Operator)

(Lease)

Unit Letter

Eddy

Please indicate location:

D	G	B	A
E	F	G	H
L	K	J	I
M	N	O	P

County. Date Spudded 5-15-62 Date Drilling Completed 7-10-62

Elevation 3600' Ord Total Depth 7085' PBD

Top Oil/Gas Pay 6970' Name of Prod. Form. Abo Reef

PRODUCING INTERVAL -

Perforations 7085-63; 7088-71

Open Hole None Depth 7085 Casing Shoe 7001

OIL WELL TEST -

Natural Prod. Test: None bbls. oil, None bbls water in hrs, min. Size

Test After Acid or Fracture Treatment (after recovery of volume of oil equal to volume of load oil used): 41 bbls. oil, -0- bbls water in 1 hrs, min. Size 1"

GAS WELL TEST -

Natural Prod. Test: MCF/Day; Hours flowed Choke Size

Method of Testing (pitot, back pressure, etc.):

Test After Acid or Fracture Treatment: MCF/Day; Hours flowed

Choke Size Method of Testing:

Acid or Fracture Treatment (Give amounts of materials used, such as acid, water, oil, and sand): 1250 Gal Davell K

Casing Tubing Date first new Press. 2800 oil run to tanks July 13, 1962

Oil Transporter McWood Corporation

Gas Transporter Skelly Oil Company

Remarks:

I hereby certify that the information given above is true and complete to the best of my knowledge.

Approved JUL 13 1962, 19.

B. D. Collier

(Company or Operator)

By: P. B. Kennedy

(Signature)

OIL CONSERVATION COMMISSION

By: M. L. Armstrong

OIL AND GAS INSPECTOR

Title

Title Part Owner

Send Communications regarding well to:

Name Box 151

Address Artesia, New Mexico

OIL CONSERVATION COMMISSION	
ARTESIA DISTRICT OFFICE	
No. Copies Received	9
Date	
OPERATOR	6
SANTA FE	1
PRORATION OFFICE	1
STATE LAND OFFICE	
U. S. G. S.	
TRANSPORTER	
FILE	1
BUREAU OF MINES	

(SUBMIT IN TRIPLICATE)

Land Office **Las Cruces**

Lease No. **060 409**

Unit **30-015-05235**  
**RECEIVED**

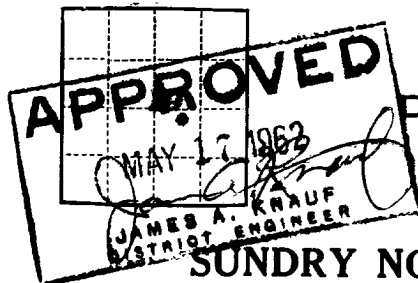

UNITED STATES  
DEPARTMENT OF THE INTERIOR  
GEOLOGICAL SURVEY

MAY 21 1962

**SUNDRY NOTICES AND REPORTS ON WELLS**

ARTESIAL OFFICE

NOTICE OF INTENTION TO DRILL.....	<input checked="" type="checkbox"/>	SUBSEQUENT REPORT OF WATER SHUT-OFF.....	
NOTICE OF INTENTION TO CHANGE PLANS.....		SUBSEQUENT REPORT OF SHOOTING OR ACIDIZING.....	
NOTICE OF INTENTION TO TEST WATER SHUT-OFF.....		SUBSEQUENT REPORT OF ALTERING CASING.....	
NOTICE OF INTENTION TO RE-DRILL OR REPAIR WELL.....		SUBSEQUENT REPORT OF RE-DRILLING OR REPAIR.....	
NOTICE OF INTENTION TO SHOOT OR ACIDIZE.....		SUBSEQUENT REPORT OF ABANDONMENT.....	
NOTICE OF INTENTION TO PULL OR ALTER CASING.....		SUPPLEMENTARY WELL HISTORY.....	
NOTICE OF INTENTION TO ABANDON WELL.....			

(INDICATE ABOVE BY CHECK MARK NATURE OF REPORT, NOTICE, OR OTHER DATA)

May 14, 1962

Well No. **1** is located **1650** ft. from **S** line and **1750** ft. from **E** line of sec. **19**

**NW 1/4 Sec 19** **17 South 31 E NMPH**  
(1/4 Sec. and Sec. No.) (Twp.) (Range) (Meridian)

**Cedar Lake Abo** **Eddy** **New Mexico**  
(Field) (County or Subdivision) (State or Territory)

MAY 17 1962

The elevation of the derrick floor above sea level is **3600** ft. (**Ground**)

U. S. GEOLOGICAL SURVEY  
ARTESIAL, NEW MEXICO

**DETAILS OF WORK**

(State names of and expected depths to objective sands; show sizes, weights, and lengths of proposed casings; indicate mudding jobs, cementing points, and all other important proposed work)

**We propose to drill an Abo test to approximately 7100' using cable tools to set the surface string and rotary tools thereon.**

**Propose to run and mud approximately 400' 10" if necessary**

**Propose to set surface string, 3 5/8" J-55 32# Range 2 casing at 1400' or thru the salt, whichever is deeper, circulate cement to surface**

**Propose to set production string, 5 1/2", J-55, 17#, 15#, 14#, 13#, and 14# tapered as may be necessary, at 7100' and cement into surface string.**

I understand that this plan of work must receive approval in writing by the Geological Survey before operations may be commenced.

Company **R. D. COLLIER**

Address **P.O. Box 100**

**Artesia, New Mexico**

By *[Signature]*

Title **Production Clerk**

NUMBER OF COPIES RECEIVED	
DISTRIBUTION	
SANTA FE	
FILE	
U.S.G.S.	
LAND OFFICE	
TRANSPORTER	OIL
	GAS
PRODUCTION OFFICE	
OPERATOR	

**NEW MEXICO OIL CONSERVATION COMMISSION**  
**WELL LOCATION AND ACREAGE DEDICATION PLAT**  
 SEE INSTRUCTIONS FOR COMPLETING THIS FORM ON THE REVERSE SIDE

FORM C-128  
 Revised 5/1/57

**SECTION A**

Operator <b>R. D. Collier</b>		Lease <b>Friess</b>		Well No. <b>1</b>
Unit Letter <b>J</b>	Section <b>19</b>	Township <b>T-17-S</b>	Range <b>R-31-E</b>	County <b>Eddy</b>
Actual Footage Location of Well: <b>1650</b> feet from the <b>South</b> line and <b>1980</b> feet from the <b>East</b> line				
Ground Level Elev. <b>3600</b>	Producing Formation <b>Abe</b>	Pool	Dedicated Acreage: <b>40</b> Acres	

1. Is the Operator the only owner in the dedicated acreage outlined on the plat below? YES \_\_\_\_\_ NO \_\_\_\_\_. ("Owner" means the person who has the right to drill into and to produce from any pool and to appropriate the production either for himself or for himself and another. (65-3-29 (e) NMSA 1935 Comp.)
2. If the answer to question one is "no," have the interests of all the owners been consolidated by communization agreement or otherwise? YES \_\_\_\_\_ NO \_\_\_\_\_. If answer is "yes," Type of Consolidation \_\_\_\_\_
3. If the answer to question two is "no," list all the owners and their respective interests below:

Owner	Land Description
	<b>MAY 17 1962</b> U. S. GEOLOGICAL SURVEY ARTESIA, NEW MEXICO

**SECTION B**

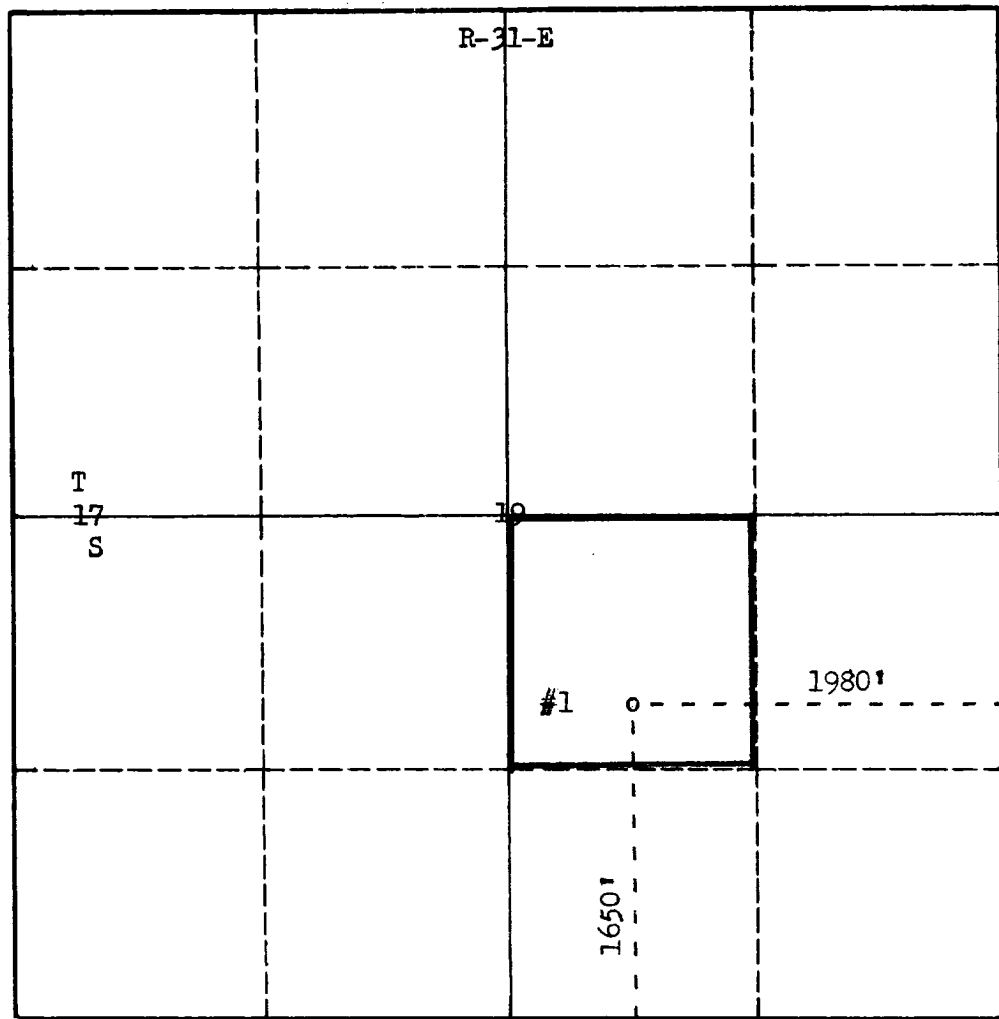

**CERTIFICATION**

I hereby certify that the information in SECTION A above is true and complete to the best of my knowledge and belief.

Name	<b>R. D. Collier</b>
Position	
Company	
Date	

I hereby certify that the well location shown on the plat in SECTION B was plotted from field notes of actual surveys made by me or under my supervision, and that the same is true and correct to the best of my knowledge and belief.

Date Surveyed	<b>May 5, 1962</b>
Registered Professional Engineer and/or Land Surveyor	

*James H. Brown*  
 Certificate No. **542**

## **INSTRUCTIONS FOR COMPLETION OF FORM C-128**

1. Operator shall furnish and certify to the information called for in Section A.
2. Operator shall outline the dedicated acreage for *both* oil and gas wells on the plat in Section B.
3. A registered professional engineer or land surveyor registered in the State of New Mexico or approved by the Commission shall show on the plat the location of the well and certify this information in the space provided.
4. All distances shown on the plat must be from the outer boundaries of the Section.
5. If additional space is needed for listing owners and their respective interests as required in question 3 of Section A, please use space below.

NUMBER OF COPIES RECEIVED DISTRIBUTION SANTA FE FILE U.S.G.S. LAND OFFICE TRANSPORTER OIL GAS PRORATION OFFICE OPERATOR		NEW MEXICO OIL CONSERVATION COMMISSION SANTA FE, NEW MEXICO <b>CERTIFICATE OF COMPLIANCE AND AUTHORIZATION          TO TRANSPORT OIL AND NATURAL GAS</b>			<b>FORM C-110</b> (Rev. 7-60)	
FILE THE ORIGINAL AND 4 COPIES WITH THE APPROPRIATE OFFICE						
Company or Operator <div style="text-align: center;"><b>R. D. Collier</b></div>				Lease <div style="text-align: center;"><b>Friess</b></div>		Well No. <div style="text-align: center;"><b>1</b></div>
Unit Letter <div style="text-align: center;"><b>J</b></div>	Section <div style="text-align: center;"><b>19</b></div>	Township <div style="text-align: center;"><b>17 South</b></div>	Range <div style="text-align: center;"><b>31 East</b></div>	County <div style="text-align: center;"><b>Eddy</b></div>		
Pool <div style="text-align: center;"><b>Cedar Lake Abo</b></div>				Kind of Lease (State, Fed, Fee) <div style="text-align: center;"><b>Federal</b></div>		
If well produces oil or condensate give location of tanks		Unit Letter <div style="text-align: center;"><b>J</b></div>	Section <div style="text-align: center;"><b>19</b></div>	Township <div style="text-align: center;"><b>17 South</b></div>	Range <div style="text-align: center;"><b>31 East</b></div>	
Authorized transporter of oil <input checked="" type="checkbox"/> or condensate <input type="checkbox"/> <div style="text-align: center;"><b>McWood Corporation</b>  <b>306 V &amp; J Tower</b>  <b>Midland, Texas</b></div>				Address (give address to which approved copy of this form is to be sent) <div style="text-align: center;"><b>306 V &amp; J Tower</b>  <b>Midland, Texas</b></div>		
Is Gas Actually Connected? Yes <input type="checkbox"/> No <input checked="" type="checkbox"/>						
Authorized transporter of casing head gas <input checked="" type="checkbox"/> or dry gas <input type="checkbox"/> <div style="text-align: center;"><b>Skelly Oil Company</b></div>		Date Connected <div style="text-align: center;"><b>July 1962</b></div>	Address (give address to which approved copy of this form is to be sent) <div style="text-align: center;"><b>Skelly Oil Company</b>  <b>Skelly Bldg.</b>  <b>Tulsa, Oklahoma</b></div>			
If gas is not being sold, give reasons and also explain its present disposition:						
REASON(S) FOR FILING (please check proper box)						
New Well <input checked="" type="checkbox"/> Change in Ownership <input type="checkbox"/> Change in Transporter (check one) Other (explain below) <input type="checkbox"/> Oil <input type="checkbox"/> Dry Gas <input type="checkbox"/> Casing head gas <input type="checkbox"/> Condensate <input type="checkbox"/>						
<div style="font-size: 2em; font-weight: bold;">RECEIVED</div> <div style="font-size: 1.5em; font-weight: bold;">JUL 13 1962</div> <div style="font-size: 1.2em; font-weight: bold;">O. C. C.</div> <div style="font-size: 1.2em; font-weight: bold;">ARTESIA, OFFICE</div>						
Remarks						
The undersigned certifies that the Rules and Regulations of the Oil Conservation Commission have been complied with.						
Executed this the <u>13th</u> day of <u>July</u> , 19 <u>62</u>						
OIL CONSERVATION COMMISSION				By		
Approved by <div style="text-align: center;"><i>ML Armstrong</i></div>				<div style="text-align: center;"><i>R. B. Kennedy</i></div>		
Title <div style="text-align: center;"><b>Oil and Gas Inspector</b></div>				Title <div style="text-align: center;"><b>Part Owner</b></div>		
Date <div style="text-align: center;"><b>JUL 13 1962</b></div>				Company <div style="text-align: center;"><b>R. D. Collier</b></div>		
				Address <div style="text-align: center;"><b>Box 151 Artesia, New Mexico</b></div>		