

(SUBMIT IN TRIPLICATE)

UNITED STATES
DEPARTMENT OF THE INTERIOR
GEOLOGICAL SURVEYLand Office **Las Cruces**
Lease No. **029420 (b)**
Unit **Dow "B"**

SUNDRY NOTICES AND REPORTS ON WELLS

JAN 25 1962

NOTICE OF INTENTION TO DRILL.....	<input checked="" type="checkbox"/>	SUBSEQUENT REPORT OF WATER SHUT-OFF.....	
NOTICE OF INTENTION TO CHANGE PLANS.....		SUBSEQUENT REPORT OF SHOOTING OR ACIDIZING.....	
NOTICE OF INTENTION TO TEST WATER SHUT-OFF.....		SUBSEQUENT REPORT OF ALTERING CASING.....	
NOTICE OF INTENTION TO RE-DRILL OR REPAIR WELL.....		SUBSEQUENT REPORT OF RE-DRILLING OR REPAIR.....	
NOTICE OF INTENTION TO SHOOT OR ACIDIZE.....		SUBSEQUENT REPORT OF ABANDONMENT.....	
NOTICE OF INTENTION TO PULL OR ALTER CASING.....		SUPPLEMENTARY WELL HISTORY.....	
NOTICE OF INTENTION TO ABANDON WELL.....			

(INDICATE ABOVE BY CHECK MARK NATURE OF REPORT, NOTICE, OR OTHER DATA)

Dow "B"

Hobbs, New Mexico - January 23, 1962

Well No. **38** is located **2080** ft. from **[N]** line and **710** ft. from **[E]** line of sec. **21**
SE 1/4 NE 1/4 Sec. 21 **17-S** **31-E** **N.M.P.M.**
(1/4 Sec. and Sec. No.) (Twp.) (Range) (Meridian)
Grayburg Jackson **Eddy** **New Mexico**
(Field) (County, or Subdivision) (State or Territory)

The elevation of the derrick floor above sea level is _____ ft.

DETAILS OF WORK

(State names of and expected depths to objective sands; show sizes, weights, and lengths of proposed casings; indicate mudding jobs, cementing points, and all other important proposed work)

Propose to drill with Rotary Tools using gas from surface to total depth approx. 3750' in the San Andres Formation. Casing program to be approx. as follows:

Size Hole	Size Casing	Casing Point	Sacks Cement
9"	7"	600'	125
6-1/4"	4-1/2"	3750'	250

The pump & plug process will be used in cementing both strings of casing. The well will be perforated and treated with approx. 1500 bbls. of lse. oil and approx. 60,000# 20/40 sand.

I understand that this plan of work must receive approval in writing by the Geological Survey before operations may be commenced.

Company **Skelly Oil Company**Address **Box 38****Hobbs, New Mexico**

By

Title

Dist. Supt.

NEW MEXICO OIL CONSERVATION COMMISSION
WELL LOCATION AND ACREAGE DEDICATION PLAT

FORM C-128
 Revised 5/1/57

SEE INSTRUCTIONS FOR COMPLETING THIS FORM ON THE REVERSE SIDE

SECTION A

Operator Shelly Oil Company			Lease Dow "B"		Well No. 38
Unit Letter H	Section 21	Township 17 South	Range 31 East	County Hddy	
Actual Footage Location of Well: 2080 feet from the North line and 710 feet from the East line					
Ground Level Elev.	Producing Formation San Andres		Pool Grayburg Jackson	Dedicated Acreage: 40 Acres	

1. Is the Operator the only owner in the dedicated acreage outlined on the plat below? YES ☒ NO ____ . ("Owner" means the person who has the right to drill into and to produce from any pool and to appropriate the production either for himself or for himself and another. (65-3-29 (a) NMSA 1955 Comp.)
2. If the answer to question one is "no," have the interests of all the owners been consolidated by communitization agreement or otherwise? YES ____ NO ____ . If answer is "yes," Type of Consolidation _____
3. If the answer to question two is "no," list all the owners and their respective interests below:

RECEIVED

Owner	Land Description
	JAN 25 1962
	U. S. GEOLOGICAL SURVEY
	ARTESIA, NEW MEXICO

SECTION B

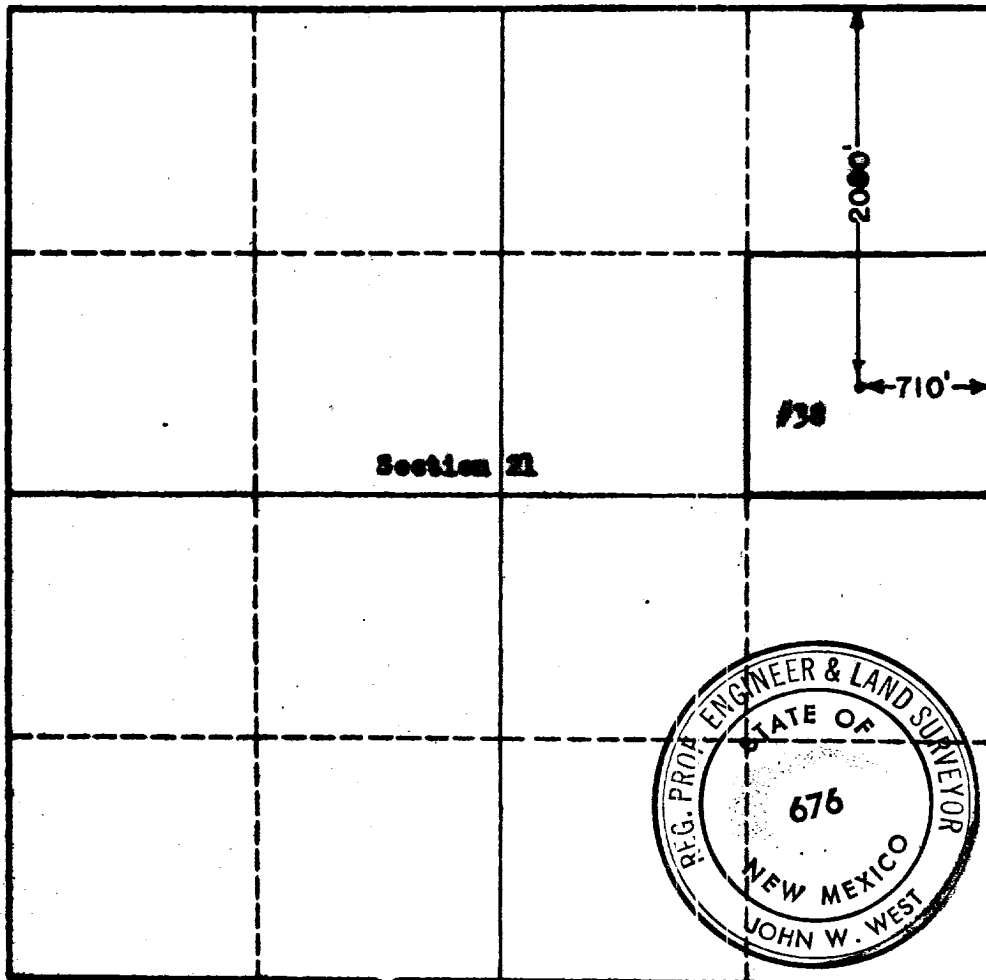

I hereby certify that the information in SECTION A above is true and complete to the best of my knowledge and belief.

Name	A. E. Galt
Position	Dist. Supt.
Company	Shelly Oil Company
Date	January 23, 1962

I hereby certify that the well location shown on the plat in SECTION B was plotted from field notes of actual surveys made by me or under my supervision, and that the same is true and correct to the best of my knowledge and belief.

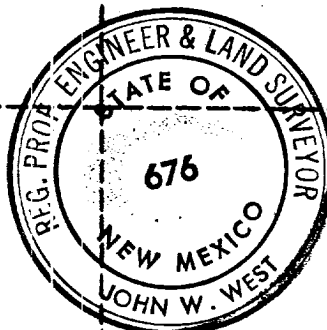

Date Surveyed	1-20-62
Registered Professional Engineer and/or Land Surveyor, JOHN W. WEST	
Certificate No.	N. M. - P. E. & L. S. NO. 676

0 330 660 990 1320 1650 1980 2310 2640 2000 1600 1200 800 0