

(SUBMIT IN TRIPLICATE)

 UNITED STATES
 DEPARTMENT OF THE INTERIOR
 GEOLOGICAL SURVEY

 Land Office Las Cruces
 Lease No. 029418 (S) (6)
 Unit Las "B"

RECEIVED

JUN 1 1960

SUNDRY NOTICES AND REPORTS ON WELLS

D. C. C.

ARTESIA, OFFICE

NOTICE OF INTENTION TO DRILL.....	<input checked="" type="checkbox"/>	SUBSEQUENT REPORT OF WATER SHUT-OFF.....	
NOTICE OF INTENTION TO CHANGE PLANS.....		SUBSEQUENT REPORT OF SHOOTING OR ACIDIZING.....	
NOTICE OF INTENTION TO TEST WATER SHUT-OFF.....		SUBSEQUENT REPORT OF ALTERING CASING.....	
NOTICE OF INTENTION TO RE-DRILL OR REPAIR WELL.....		SUBSEQUENT REPORT OF RE-DRILLING OR REPAIR.....	
NOTICE OF INTENTION TO SHOOT OR ACIDIZE.....		SUBSEQUENT REPORT OF ABANDONMENT.....	
NOTICE OF INTENTION TO PULL OR ALTER CASING.....		SUPPLEMENTARY WELL HISTORY.....	
NOTICE OF INTENTION TO ABANDON WELL.....			

(INDICATE ABOVE BY CHECK MARK NATURE OF REPORT, NOTICE, OR OTHER DATA)

Hobbs, New Mexico May 25, 19 60Las "B"Well No. 10 is located 810 ft. from S line and 660 ft. from E line of sec. 23SE/4 SE/4 Sec. 23

(1/4 Sec. and Sec. No.)

Grayburg Jackson

(Field)

17-S

(Twp.)

Eddy

(County or Subdivision)

31-E

(Range)

N.M.P.M.

(Meridian)

New Mexico

(State or Territory)

The elevation of the derrick floor above sea level is ft.

DETAILS OF WORK

(State names of and expected depths to objective sands; show sizes, weights, and lengths of proposed casings; indicate mudding jobs, cementing points, and all other important proposed work)

Propose to drill with cable tools from surface to total depth of approximately 3875' in the San Andres Formation. Casing program to be approximately as follows:

<u>Size Hole</u>	<u>Size Casing</u>	<u>Casing Point</u>	<u>Sacks Cement</u>
<u>10"</u>	<u>8-5/8"</u>	<u>780'</u>	<u>95</u>
<u>8"</u>	<u>5-1/2"</u>	<u>3750'</u>	<u>350</u>

Halliburton Process will be used in cementing both strings of casing.

I understand that this plan of work must receive approval in writing by the Geological Survey before operations may be commenced.

Company Shelly Oil CompanyAddress Box 38Hobbs, New Mexico

By

Title

Dist. Supt.

 RECEIVED
 MAY 26 1960
 U. S. GEOLOGICAL SURVEY
 ARTESIA, NEW MEXICO

NEW MEXICO OIL CONSERVATION COMMISSION
WELL LOCATION AND ACREAGE DEDICATION PLAT

FORM C-128
Revised 5/1/57

SEE INSTRUCTIONS FOR COMPLETING THIS FORM ON THE REVERSE SIDE

SECTION A

Operator Skelly Oil Co.			Lease Lea "B"			Well No. 10		
Unit Letter P	Section 23	Township 17S	Range 31	County Eddy				
Actual Footage Location of Well: 810 feet from the South line and 660 feet from the East line								
Ground Level Elev.	Producing Formation San Andres		Pool Grayburg Jackson		Dedicated Acreage: 40 Acres			

1. Is the Operator the only owner in the dedicated acreage outlined on the plat below? YES ☒ NO ____ . ("Owner" means the person who has the right to drill into and to produce from any pool and to appropriate the production either for himself or for himself and another. (65-3-29 (e) NMSA 1935 Comp.)
2. If the answer to question one is "no," have the interests of all the owners been consolidated by communitization agreement or otherwise? YES ____ NO ____ . If answer is "yes," Type of Consolidation _____
3. If the answer to question two is "no," list all the owners and their respective interests below:

Owner	Land Description

SECTION B

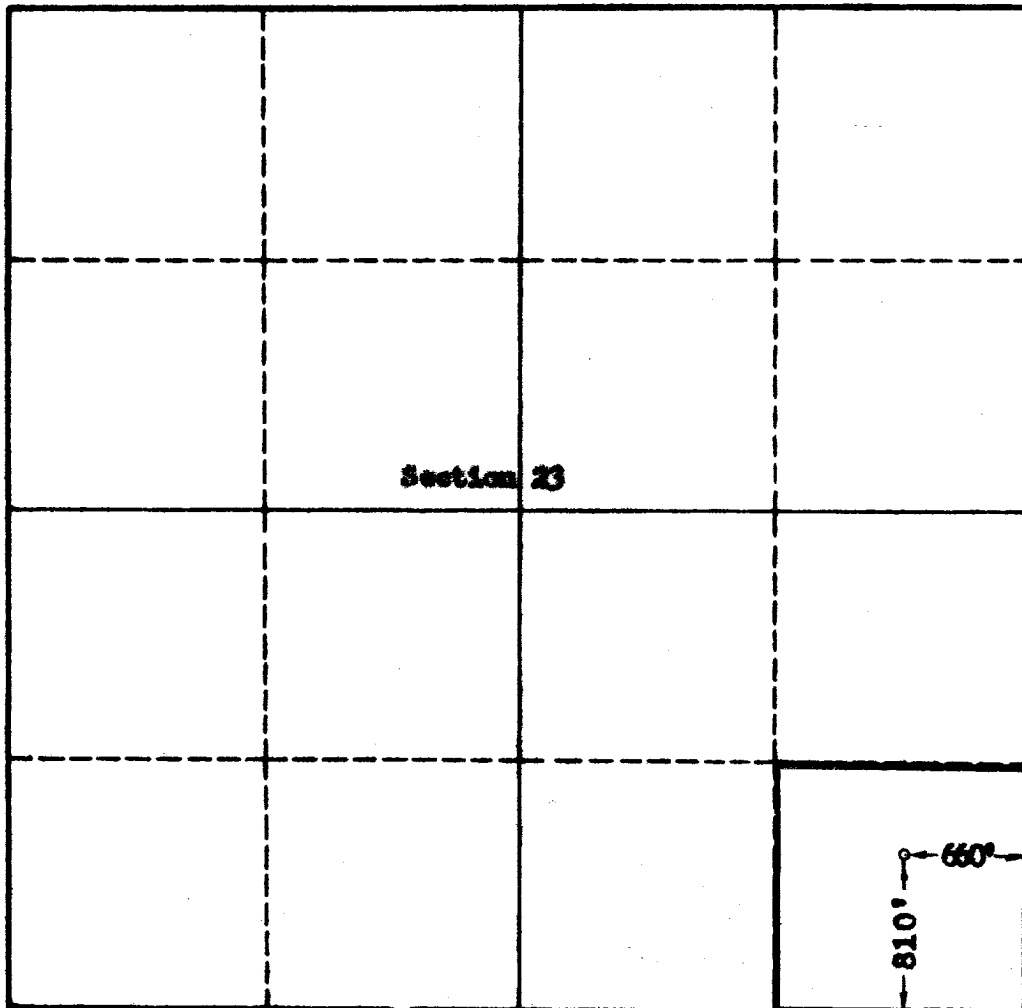

CERTIFICATION

I hereby certify that the information in SECTION A above is true and complete to the best of my knowledge and belief.

Name <i>J. J. [Signature]</i>
Position Dist. Supt.
Company Skelly Oil Company
Date May 25, 1960

I hereby certify that the well location shown on the plat in SECTION B was plotted from field notes of actual surveys made by me or under my supervision, and that the same is true and correct to the best of my knowledge and belief.

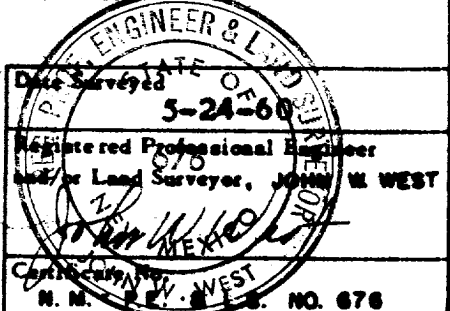

0 330 660 990 1320 1650 1980 2310 2640 2970 3300 3630 3960 4290 4620 4950 5280 5610 5940 6270 6600