

UNITED STATES  
DEPARTMENT OF THE INTERIOR  
GEOLOGICAL SURVEY

Copy to J.

## APPLICATION FOR PERMIT TO DRILL, DEEPEN, OR PLUG BACK

## 1a. TYPE OF WORK

DRILL ☒DEEPEN ☐PLUG BACK ☐

## b. TYPE OF WELL

OIL  
WELL ☐GAS  
WELL ☐

OTHER

Injection

SINGLE  
ZONE ☐MULTIPLE  
ZONE ☐

## 2. NAME OF OPERATOR

General American Oil Company of Texas

## 3. ADDRESS OF OPERATOR

P. O. Box 416, Loco Hills, New Mexico

## 4. LOCATION OF WELL (Report location clearly and in accordance with any State requirements.)\*

At surface

2615' FWL and 1295' FWL of Section 28,

T. 17-S, R. 30-E

At proposed prod. zone

## 14. DISTANCE IN MILES AND DIRECTION FROM NEAREST TOWN OR POST OFFICE\*

2 Miles Southeast Loco Hills

## 15. DISTANCE FROM PROPOSED\*

LOCATION TO NEAREST  
PROPERTY OR LEASE LINE, FT.  
(Also to nearest drlg. unit line, if any)

1320'

## 16. NO. OF ACRES IN LEASE

200

17. NO. OF ACRES ASSIGNED  
TO THIS WELL

40

## 18. DISTANCE FROM PROPOSED LOCATION\*

TO NEAREST WELL, DRILLING, COMPLETED,  
OR APPLIED FOR, ON THIS LEASE, FT.

1500

## 19. PROPOSED DEPTH

3175 Approx.

## 20. ROTARY OR CABLE TOOLS

Cable Tools

## 21. ELEVATIONS (Show whether DF, RT, GR, etc.)

3644 G L

## 22. APPROX. DATE WORK WILL START\*

June 4, 1965

## 23.

## PROPOSED CASING AND CEMENTING PROGRAM

SIZE OF HOLE	SIZE OF CASING	WEIGHT PER FOOT	SETTING DEPTH	QUANTITY OF CEMENT
	8-5/8	240	550' Approx.	100 sacks
	5-1/2	140	3160' Approx.	150 sacks

RECEIVED

JUN 2 1965

O. C. C.  
ARTESIA, OFFICERECEIVED  
JUN 1 1965  
U. S. GEOLOGICAL SURVEY  
ARTESIA, NEW MEXICO

IN ABOVE SPACE DESCRIBE PROPOSED PROGRAM: If proposal is to deepen or plug back, give data on present productive zone and proposed new productive zone. If proposal is to drill or deepen directionally, give pertinent data on subsurface locations and measured and true vertical depths. Give blowout preventer program, if any.

24.

SIGNED

R. J. Heard

TITLE

District Superintendent

DATE

May 31, 1965

(This space for Federal or State office use)

PERMIT NO.

APPROVAL DATE

APPROVED BY

TITLE

DATE

CONDITIONS OF APPROVAL, IF ANY

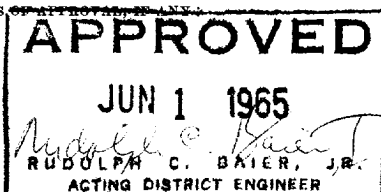

\*See Instructions On Reverse Side

NUMBER OF COPIES RECEIVED	
DISTRIBUTION	
SANTA FE	
FILE	
U.S.G.S.	
LAND OFFICE	
TRANSPORTER	OIL
	GAS
PRODUCTION OFFICE	
OPERATOR	

**NEW MEXICO OIL CONSERVATION COMMISSION**  
**WELL LOCATION AND ACREAGE DEDICATION PLAT**  
 SEE INSTRUCTIONS FOR COMPLETING THIS FORM ON THE REVERSE SIDE

FORM C-128  
 Revised 5/1/57

**SECTION A**

Operator <b>General American Oil Co. of Texas</b>			Lease <b>MEXUPX Madden A</b>		Well No. <b>2</b>
Unit Letter <b>H</b>	Section <b>28</b>	Township <b>17 South</b>	Range <b>30 East</b>	County <b>Eddy</b>	
Actual Footage Location of Well: <b>2615</b> feet from the <b>North</b> line and <b>1295</b> feet from the <b>East</b> line					
Ground Level Elev. <b>3644</b>	Producing Formation <b>Premier</b>	Pool <b>Grayburg-Jackson</b>	Dedicated Acreage: <b>40</b> Acres		

1. Is the Operator the only owner in the dedicated acreage outlined on the plat below? YES ☒ NO \_\_\_\_ . ("Owner" means the person who has the right to drill into and to produce from any pool and to appropriate the production either for himself or for himself and another. (65-3-29 (e) NMSA 1935 Comp.)
2. If the answer to question one is "no," have the interests of all the owners been consolidated by communitization agreement or otherwise? YES \_\_\_\_ NO \_\_\_\_ . If answer is "yes," Type of Consolidation \_\_\_\_\_
3. If the answer to question two is "no," list all the owners and their respective interests below:

Owner	Land Description

**SECTION B**

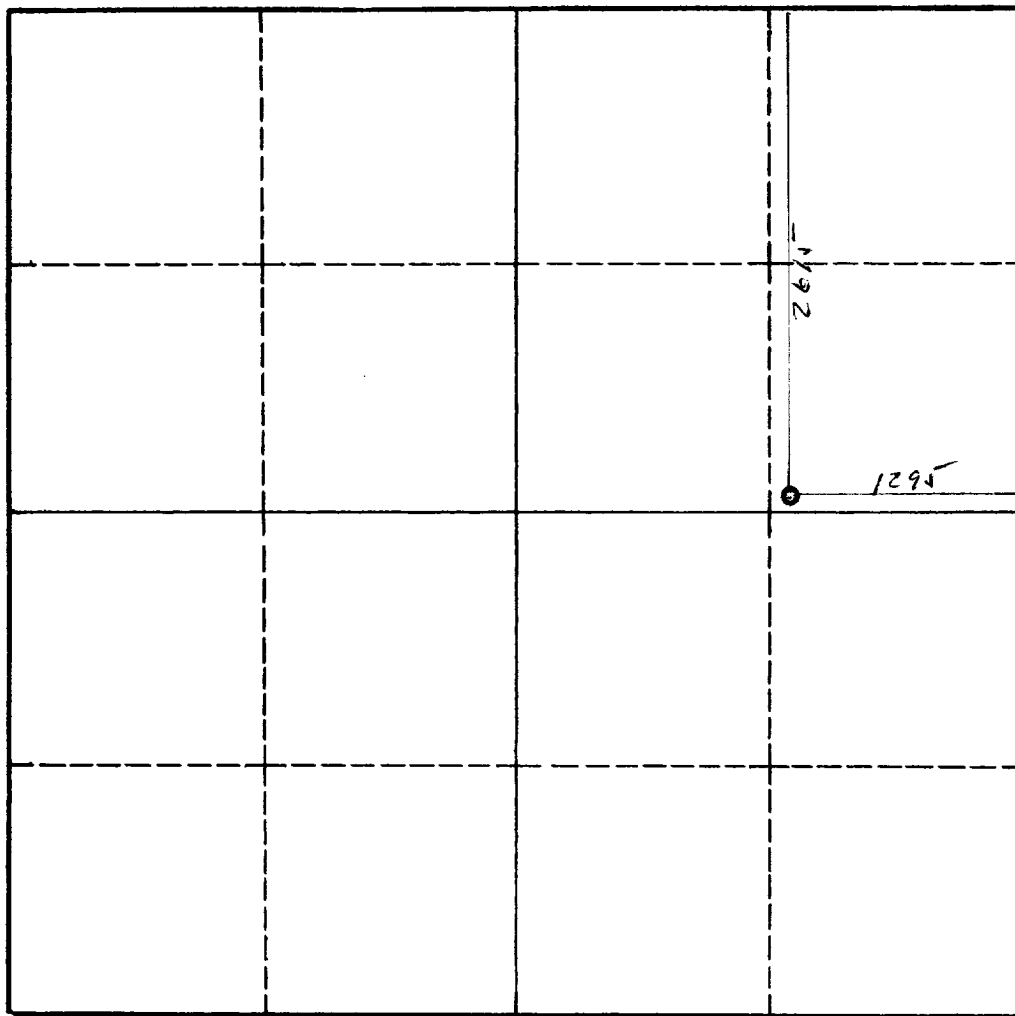

**CERTIFICATION**

I hereby certify that the information in SECTION A above is true and complete to the best of my knowledge and belief.

Name **R. J. Heard**

Position  
**Dist. Superintendent**

Company  
**General American Oil Co.**

Date  
**May 31, 1965**

I hereby certify that the well location shown on the plat in SECTION B was plotted from field notes of actual surveys made by me or under my supervision, and that the same is true and correct to the best of my knowledge and belief.

Date Surveyed  
**May 28, 1965**

Registered Professional Engineer and/or Land Surveyor

*John A. Mathias*

Certificate No.  
**1502**

0 330 660 990 1320 1650 1980 2310 2640 2000 1500 1000 500 0