

30-015-20129

NO. OF COPIES RECEIVED	6
DISTRIBUTION	
SANTA FE	1
FILE	1
U.S.G.S.	2
LAND OFFICE	2
OPERATOR	1

NEW MEXICO OIL CONSERVATION COMMISSION

Form C-101
Revised 1-1-65

5A. Indicate Type of Lease	
STATE <input checked="" type="checkbox"/>	FEE <input type="checkbox"/>
5. State Oil & Gas Lease No.	
B-255-8	

APPLICATION FOR PERMIT TO DRILL, DEEPEN, OR PLUG BACK

1a. Type of Work		7. Unit Agreement Name	
b. Type of Well DRILL <input checked="" type="checkbox"/> DEEPEN <input type="checkbox"/> PLUG BACK <input type="checkbox"/> OIL WELL <input checked="" type="checkbox"/> GAS WELL <input type="checkbox"/> OTHER <input type="checkbox"/> SINGLE ZONE <input checked="" type="checkbox"/> MULTIPLE ZONE <input type="checkbox"/>		8. Farm or Lease Name GJ West Coop Unit	
2. Name of Operator TENNECO OIL COMPANY		9. Well No. 59	
3. Address of Operator P.O. Box 1031 MIDLAND TEXAS 79701		10. Field and Pool, or Wildcat GRAYBURG JACKSON	
4. Location of Well UNIT LETTER E LOCATED 1980 FEET FROM THE NORTH LINE AND 660 FEET FROM THE WEST LINE OF SEC. 16 TWP. 17S RGE. 29E NMPM		12. County EDDY	
19. Proposed Depth 2900		19A. Formation GRAYBURG SA	20. Rotary or C.T. ROTARY
21. Elevations (Show whether DF, RT, etc.) 3582.6 GL	21A. Kind & Status Plug. Bond IN EFFECT	21B. Drilling Contractor CACTUS	22. Approx. Date Work will start UPON APPROVAL

23.

PROPOSED CASING AND CEMENT PROGRAM

SIZE OF HOLE	SIZE OF CASING	WEIGHT PER FOOT	SETTING DEPTH	SACKS OF CEMENT	EST. TOP
11"	8 5/8"	24	360	SUFF. TO CIRCULATE	
7 7/8"	4 1/2"	10.5	2900	SUFF. TO BRING TOP TO 2000'	

APPROVAL VALID
FOR 90 DAYS UNLESS
DRILLING COMMENCED,
EXPIRES 6-22-68

IN ABOVE SPACE DESCRIBE PROPOSED PROGRAM: IF PROPOSAL IS TO DEEPEN OR PLUG BACK, GIVE DATA ON PRESENT PRODUCTIVE ZONE AND PROPOSED NEW PRODUCTIVE ZONE, GIVE BLOWOUT PREVENTER PROGRAM, IF ANY.

I hereby certify that the information above is true and complete to the best of my knowledge and belief.

Signed Monae K. Karamazov Title SR. PROD CLERK Date 3-11-68

(This space for State Use)

APPROVED BY W. G. Gussert TITLE OIL AND GAS INSPECTOR DATE MAR 14 1968

CONDITIONS OF APPROVAL, IF ANY:

NEW MEXICO OIL CONSERVATION COMMISSION
WELL LOCATION AND ACREAGE DEDICATION PLAT

Form C-102
Supersedes C-128
Effective 1-1-65

All distances must be from the outer boundaries of the Section.

Operator TENNECO OIL COMPANY		Lease G-T WEST COOP UNIT		Well No. 59
Unit Letter E	Section 16	Township 17 SOUTH	Range 29 EAST	County EDDY
Actual Well Location of Well: 1980 feet from the NORTH line and 660 feet from the WEST line				
Ground Level Elev. 3582.6	Producing Formation GRAYBURG SAN ANTONIO		Pool under GRAYBURG JACKSON	Dedicated Acreage: 40 Acres

1. Outline the acreage dedicated to the subject well by colored pencil or hatchure marks on the plat below.
2. If more than one lease is dedicated to the well, outline each and identify the ownership thereof (both as to working interest and royalty).
3. If more than one lease of different ownership is dedicated to the well, have the interests of all owners been consolidated by communitization, unitization, force-pooling, etc?

☐ Yes ☐ No If answer is "yes," type of consolidation _____

If answer is "no," list the owners and tract descriptions which have actually been consolidated. (Use reverse side of this form if necessary.) _____

No allowable will be assigned to the well until all interests have been consolidated (by communitization, unitization, forced-pooling, or otherwise) or until a non-standard unit, eliminating such interests, has been approved by the Commission.

CERTIFICATION

I hereby certify that the information contained herein is true and complete to the best of my knowledge and belief.

Name
Donald R. Karsach
Position
Sr Prod Clerk
Company
Tenneco Oil Co
Date
3-11-68

I hereby certify that the well location shown on this plat was plotted from field notes of actual surveys made by me or under my supervision, and that the same is true and correct to the best of my knowledge and belief.

Date Surveyed
FEB. 19, 1968

Registered Professional Engineer and/or Land Surveyor

John W. West
Certificate No. **676**

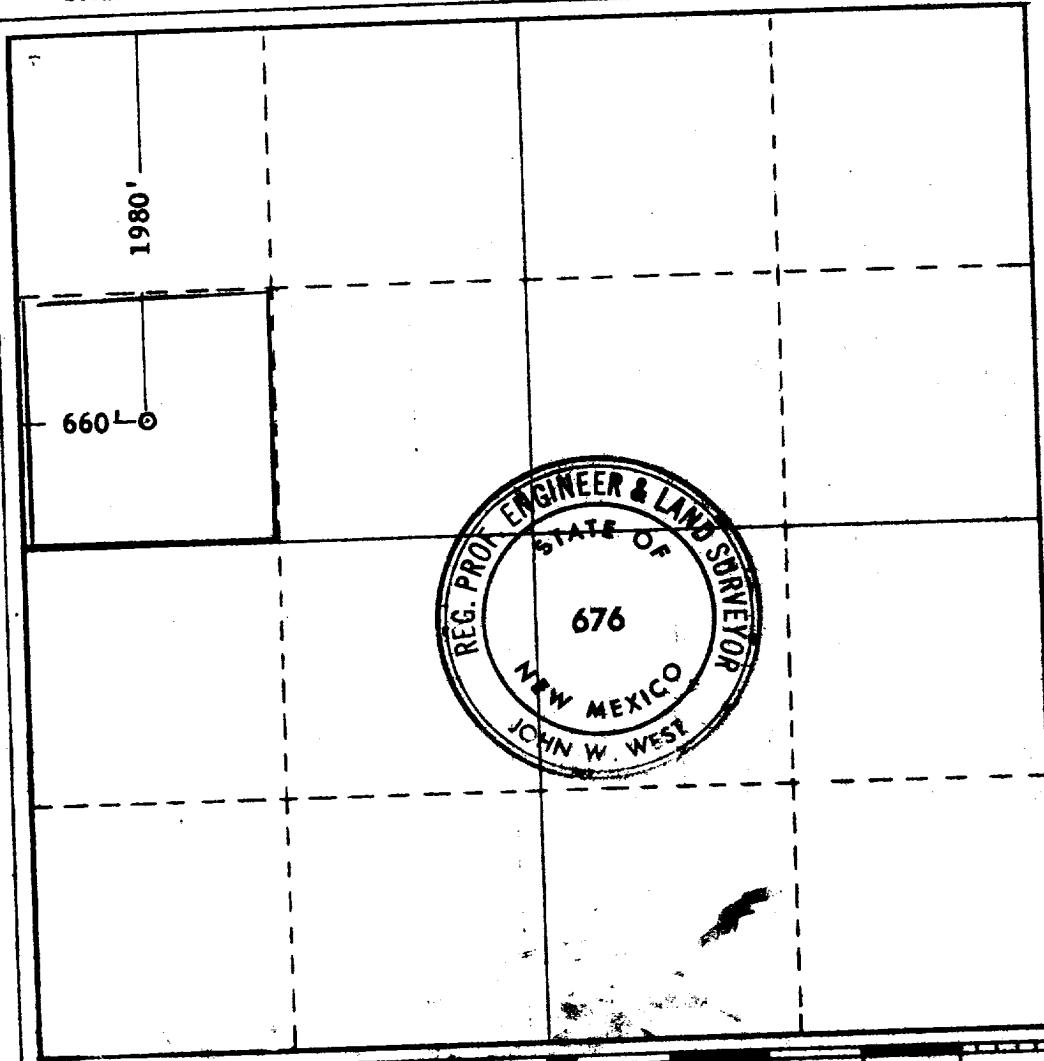
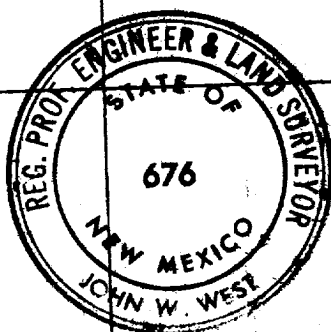



1

2

3

4

5

6