

UNITED STATES
DEPARTMENT OF THE INTERIOR
GEOLOGICAL SURVEY

30-015-20209

APPLICATION FOR PERMIT TO DRILL, DEEPEN, OR PLUG BACK

1a. TYPE OF WORK DRILL <input checked="" type="checkbox"/> DEEPEN <input type="checkbox"/> PLUG BACK <input type="checkbox"/>		5. LEASE DESIGNATION AND SERIAL NO. LC-055264	
b. TYPE OF WELL OIL WELL <input type="checkbox"/> GAS WELL <input type="checkbox"/> OTHER <u>Water Injection</u> SINGLE ZONE <input checked="" type="checkbox"/> MULTIPLE ZONE <input type="checkbox"/>		6. IF INDIAN, ALLOTTEE OR TRIBE NAME	
2. NAME OF OPERATOR WINDFOHR OIL COMPANY		7. UNIT AGREEMENT NAME Grayburg Jackson S.A.	
3. ADDRESS OF OPERATOR 1202 First National Bank Bldg., Fort Worth, Texas 76102		8. FARM OR LEASE NAME <i>Grayburg Jackson (San Andres) Unit</i>	
4. LOCATION OF WELL (Report location clearly and in accordance with any State requirements.) At surface 1650' from North and 1980' from West lines of Sec. 24-17S-30E. At proposed prod. zone		9. WELL NO. 40	
14. DISTANCE IN MILES AND DIRECTION FROM NEAREST TOWN OR POST OFFICE* 2 miles northeast of Loco Hills, New Mexico		10. FIELD AND POOL, OR WILDCAT Grayburg Jackson, GB-SA	
15. DISTANCE FROM PROPOSED* LOCATION TO NEAREST PROPERTY OR LEASE LINE, FT. (Also to nearest drlg. line, if any) 1650'		11. SEC., T., R., M., OR BLK. AND SURVEY OR AREA Sec. 24-17S-30E	
16. NO. OF ACRES IN LEASE 320		12. COUNTY OR PARISH Eddy	
17. NO. OF ACRES ASSIGNED TO THIS WELL None		13. STATE New Mexico	
18. DISTANCE FROM PROPOSED LOCATION* TO NEAREST WELL, DRILLING, COMPLETED, OR APPLIED FOR, ON THIS LEASE, FT. 1320'		19. PROPOSED DEPTH 3500	
20. ROTARY OR CABLE TOOLS Rotary		21. APPROX. DATE WORK WILL START*	
21. ELEVATIONS (Show whether DF, RT, GR, etc.)			

23. PROPOSED CASING AND CEMENTING PROGRAM				
SIZE OF HOLE	SIZE OF CASING	WEIGHT PER FOOT	SETTING DEPTH	QUANTITY OF CEMENT
12-1/4	8-5/8" OD	20# - H	500'	200 sx. 2% CaCl.
7-7/8	4 1/2" OD	9.5# - J	3500'	200 sx. 50/50 Pozmix with 10% gel incor cement plus 225 sx. neat incor cement around shoe.

Casing will be perforated in San Andres pay and acidized.

This will be a water injection well. WFX # 305

RECEIVED

MAR 3 1969

O. C. C.
ARTESIA, OFFICE

FEB 27 1969

IN ABOVE SPACE DESCRIBE PROPOSED PROGRAM: If proposal is to deepen or plug back, give data on present productive zone and proposed new productive zone. If proposal is to drill or deepen directionally, give pertinent data on subsurface locations and measured and true vertical depths. Give blowout preventer program, if any.

24. SIGNED Ralph L Gray TITLE Consultant DATE Feb. 27, 1969
(This space for Federal or State office use)

PERMIT NO. _____

APPROVAL DATE _____

APPROVED BY
CONDITIONS OF APPROVAL, IF ANY:THIS APPROVAL IS RESCINDED IF OPERATIONS
ARE NOT COMMENCED WITHIN 3 MONTHS.
EXPIRES MAY 27 1969

DATE _____

*See Instructions On Reverse Side

Instructions

General: This form is designed for submitting proposals to perform certain well operations, as indicated, on all types of lands and leases for appropriate action by either a Federal or a State agency, or both, pursuant to applicable Federal and/or State laws and regulations. Any necessary special instructions concerning the use of this form and the number of copies to be submitted, particularly with regard to local, area, or regional procedures and practices, either are shown below or will be issued by, or may be obtained from, the local Federal and/or State office.

Item 1: If the proposal is to redrill to the same reservoir at a different subsurface location or to a new reservoir, use this form with appropriate notations. Consult applicable State or Federal regulations concerning subsequent work proposals or reports on the well.

Item 4: If there are no applicable State requirements; locations on Federal or Indian land should be described in accordance with Federal requirements. Consult local State or Federal office for specific instructions.

Item 14: Needed only when location of well cannot readily be found by road from the land or lease description. A plat, or plat, separate or on this reverse side, showing the roads to, and the surveyed location of, the well, and any other required information, should be furnished when required by Federal or State agency offices.

Items 15 and 18: If well is to be, or has been directionally drilled, give distances for subsurface location of hole in any present or objective production zone.

Item 22: Consult applicable Federal or State regulations, or appropriate officials, concerning approval of the proposal before operations are started.

NEW MEXICO OIL CONSERVATION COMMISSION
WELL LOCATION AND ACREAGE DEDICATION PLAT

Form C-102
 Supersedes C-128
 Effective 1-1-65

All distances must be from the outer boundaries of the Section.

Operator WINDFOHR OIL COMPANY			Lease Grayburg Jackson San Andres GB-SA UNIT		Well No. 40
Unit Letter F	Section 24	Township 17 SOUTH	Range 30 EAST	County EDDY	
Actual Footage Location of Well: 1650 feet from the NORTH line and 1980 feet from the WEST line					
Ground Level Elev. 3719.3	Producing Formation San Andres	Pool Grayburg Jackson, GB-SA		Dedicated Acreage: WIW Acres	

1. Outline the acreage dedicated to the subject well by colored pencil or hachure marks on the plat below.
2. If more than one lease is dedicated to the well, outline each and identify the ownership thereof (both as to working interest and royalty).
3. If more than one lease of different ownership is dedicated to the well, have the interests of all owners been consolidated by communitization, unitization, force-pooling, etc?

☒ Yes ☐ No If answer is "yes," type of consolidation Unit

If answer is "no," list the owners and tract descriptions which have actually been consolidated. (Use reverse side of this form if necessary.) _____

No allowable will be assigned to the well until all interests have been consolidated (by communitization, unitization, forced-pooling, or otherwise) or until a non-standard unit, eliminating such interests, has been approved by the Commission.

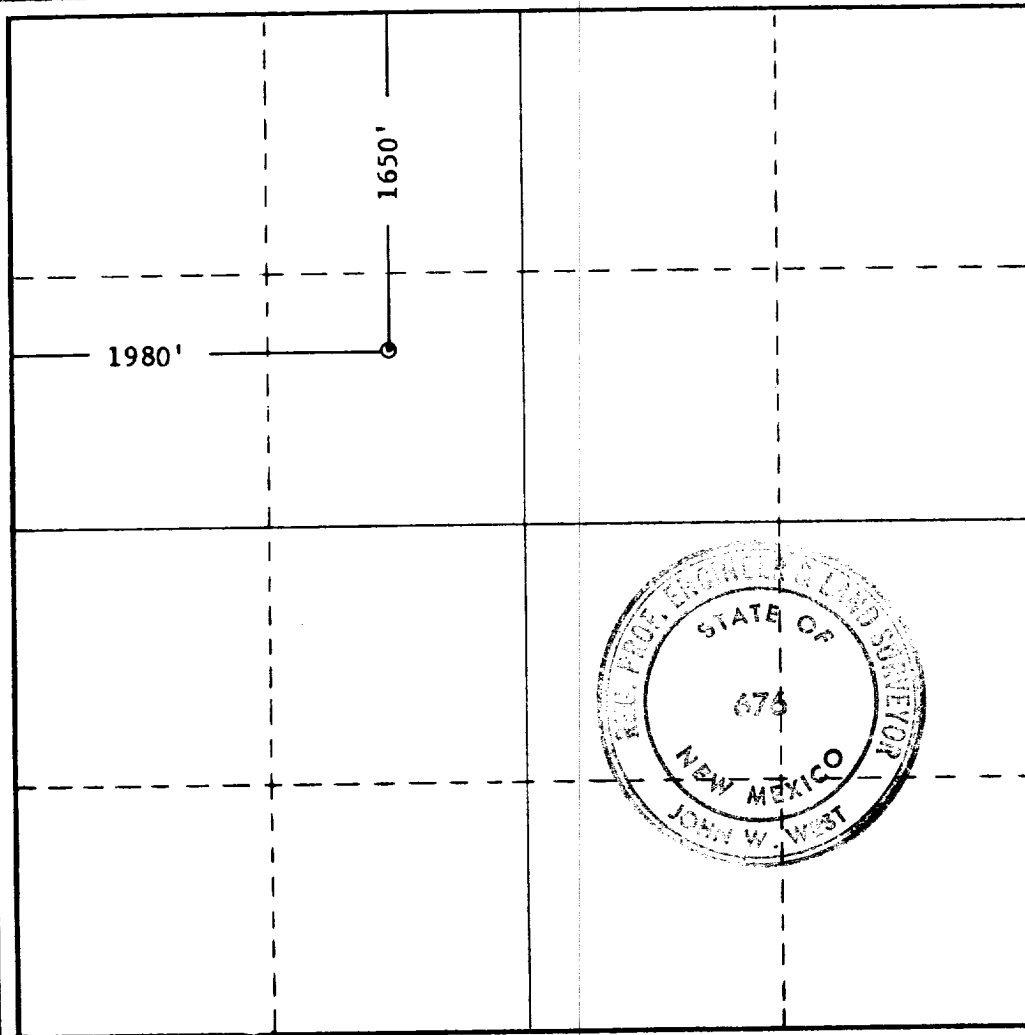

CERTIFICATION

I hereby certify that the information contained herein is true and complete to the best of my knowledge and belief.

Name Ralph L Gray
 Position Consultant

Company
WINDFOHR OIL COMPANY

Date
Feb. 27, 1969

I hereby certify that the well location shown on this plat was plotted from field notes of actual surveys made by me or under my supervision, and that the same is true and correct to the best of my knowledge and belief.

Date Surveyed
FEB. 10, 1969

Registered Professional Engineer and/or Land Surveyor

John W. West
 Certificate No. **676**

