

NO. OF COPIES RECEIVED	6
DISTRIBUTION	
SANTA FE	1
FILE	1
U.S.G.S.	2
LAND OFFICE	1
OPERATOR	1

NEW MEXICO OIL CONSERVATION COMMISSION

RECEIVED

NOV 24 1971

30-015-20540

Form C-101
Revised 1-1-65

5A. Indicate Type of Lease	
STATE <input checked="" type="checkbox"/>	FEE <input type="checkbox"/>
5. State Oil & Gas Lease No.	
B-2209	
7. Unit Agreement Name	
-	
8. Farm or Lease Name	
Etz A State	
9. Well No.	
16	
10. Field and Pool, or Wildcat	
Grayburg Jackson	
12. County	
Eddy	
19. Proposed Depth	19A. Formation
3350	Grayburg Jackson
20. Rotary or C.T.	
	Rotary
21. Elevations (Show whether DF, RT, etc.)	22. Approx. Date Work will start
3665 GR	December 6, 1971

APPLICATION FOR PERMIT TO DRILL, DEEPEN, OR PLUG BACK

1a. Type of Work	
DRILL <input checked="" type="checkbox"/>	DEEPEN <input type="checkbox"/>
b. Type of Well	
OIL WELL <input checked="" type="checkbox"/>	GAS WELL <input type="checkbox"/>
OTHER <input type="checkbox"/>	
2. Name of Operator	
Texas American Oil Corporation	
3. Address of Operator	
1012 Midland Savings Building, Midland, Texas 79701	
4. Location of Well	
UNIT LETTER L	LOCATED 1650 FEET FROM THE South LINE
AND 660 FEET FROM THE West LINE OF SEC. 16	TWP. 17S RGE. 30E NMPM
21. Elevations (Show whether DF, RT, etc.)	
3665 GR	
21A. Kind & Status Plug. Bond	21B. Drilling Contractor
J. S. Ward & Son	WEK Drlg. Company

PROPOSED CASING AND CEMENT PROGRAM

SIZE OF HOLE	SIZE OF CASING	WEIGHT PER FOOT	SETTING DEPTH	SACKS OF CEMENT	EST. TOP
11"	8-5/8"	20#	525	150 sx.	Circ.
7-7/8"	5-1/2"	15.5#	3350	300 sx.	1800

APPROVAL VALID
FOR 90 DAYS UNLESS
DRILLING COMMENCED,
EXPIRES 3-1-72

IN ABOVE SPACE DESCRIBE PROPOSED PROGRAM: IF PROPOSAL IS TO DEEPEN OR PLUG BACK, GIVE DATA ON PRESENT PRODUCTIVE ZONE AND PROPOSED NEW PRODUCTIVE ZONE. GIVE BLOWOUT PREVENTER PROGRAM, IF ANY.

I hereby certify that the information above is true and complete to the best of my knowledge and belief.

Signed Roy K. Valla Title Production Manager Date November 23, 1971

(This space for State Use)

APPROVED BY W. A. Gressett TITLE OIL AND GAS INSPECTOR DATE DEC 1 1971

CONDITIONS OF APPROVAL, IF ANY:

MEXICO OIL CONSERVATION COMMISSION
WELL LOCATION AND ACREAGE DEDICATION PLAT

Form C-102
Supersedes C-128
Effective 1-1-65

All distances must be from the outer boundaries of the Section.

Operator Texas American Oil Corporation			Lease Sta A State		Well No. 16
Unit Letter L	Section 16	Township 17 South	Range 30 East	County Eddy	
Actual Footage Location of Well: 1650 feet from the South line and 660 feet from the West line					
Ground Level Elev: 3665	Producing Formation <i>sa</i> Grayburg Jackson		Pool Grayburg Jackson		Dedicated Acreage: 40 Acres

1. Outline the acreage dedicated to the subject well by colored pencil or hachure marks on the plat below.
2. If more than one lease is dedicated to the well, outline each and identify the ownership thereof (both as to working interest and royalty).
3. If more than one lease of different ownership is dedicated to the well, have the interests of all owners been consolidated by communitization, unitization, force-pooling, etc?

☐ Yes ☐ No If answer is "yes," type of consolidation _____

If answer is "no," list the owners and tract descriptions which have actually been consolidated. (Use reverse side of this form if necessary.) _____

No allowable will be assigned to the well until all interests have been consolidated (by communitization, unitization, forced-pooling, or otherwise) or until a non-standard unit, eliminating such interests, has been approved by the Commission.

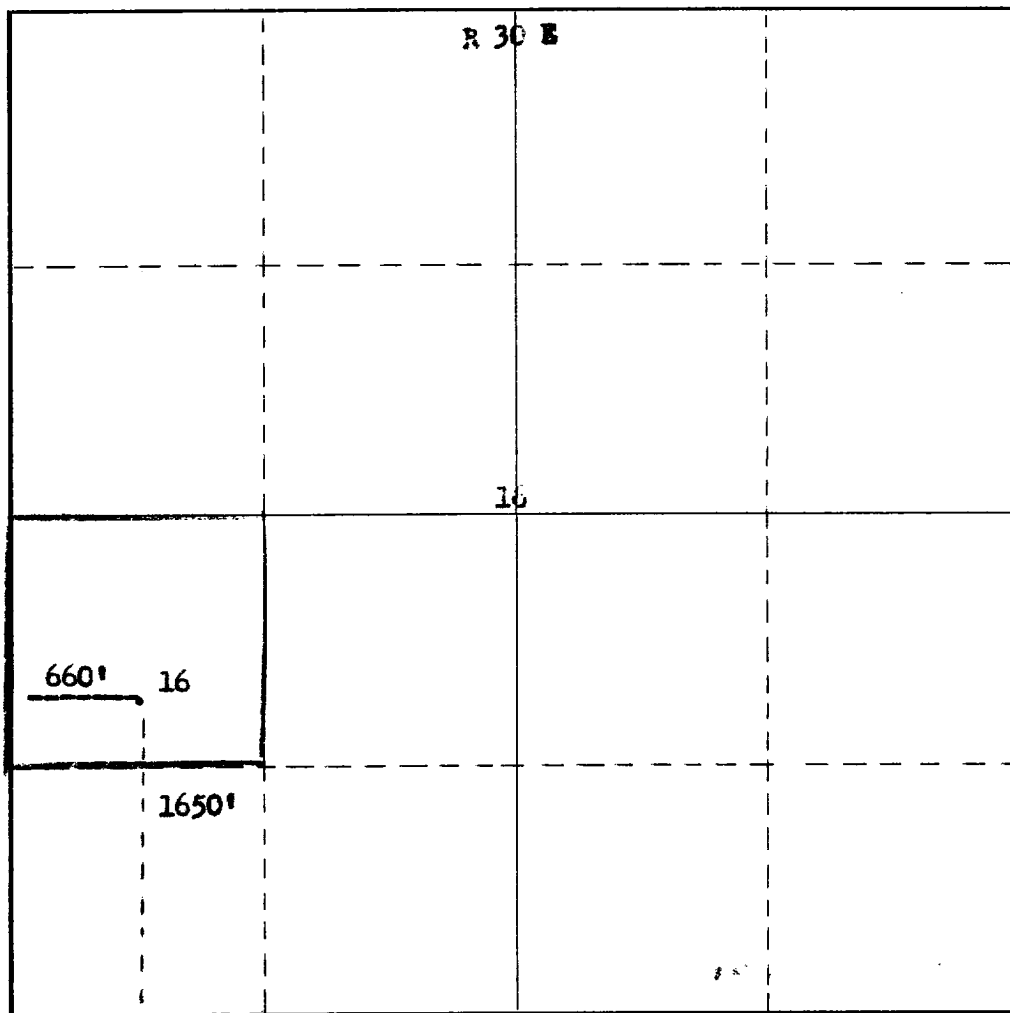

CERTIFICATION

I hereby certify that the information contained herein is true and complete to the best of my knowledge and belief.

Name *Roy K. Valla*
Position
Production Manager
Company
Texas American Oil Corp.
Date
November 23, 1971

I hereby certify that the well location shown on this plat was plotted from field notes of actual surveys made by me or under my supervision, and that the same is true and correct to the best of my knowledge and belief.

Date Surveyed
November 9, 1971
Registered Professional Engineer
and/or Land Surveyor

Certificate No.

542

