

UNITED STATES
DEPARTMENT OF THE INTERIOR
GEOLOGICAL SURVEY

APPLICATION FOR PERMIT TO DRILL, DEEPEN, OR PLUG BACK

1a. TYPE OF WORK

DRILL ☒DEEPEN ☐PLUG BACK ☐

b. TYPE OF WELL

OIL
WELL ☒GAS
WELL ☐

OTHER

SINGLE
ZONE ☐MULTIPLE
ZONE ☐

2. NAME OF OPERATOR

Atlantic Richfield Company

RECEIVED

3. ADDRESS OF OPERATOR

P. O. Box 1710, Hobbs, New Mexico 88240

JAN 15 1975

4. LOCATION OF WELL (Report location clearly and in accordance with any State requirements.)*

At surface

430' FSL & 2250' FEL (Unit letter O)

At proposed prod. zone

Same as surface

O. C. C.
ARTESIA, OFFICE

14. DISTANCE IN MILES AND DIRECTION FROM NEAREST TOWN OR POST OFFICE*

4 miles east of Loco Hills, N.M. on U.S.Hwy & 6 miles North

10. DISTANCE FROM PROPOSED*

LOCATION TO NEAREST
PROPERTY OR LEASE LINE, FT.
(Also to nearest drlg. unit line, if any)

16. NO. OF ACRES IN LEASE

1885

17. NO. OF ACRES ASSIGNED
TO THIS WELL

40

18. DISTANCE FROM PROPOSED LOCATION*

TO NEAREST WELL, DRILLING, COMPLETED,
OR APPLIED FOR, ON THIS LEASE, FT.

19. PROPOSED DEPTH

3250'

20. ROTARY OR CABLE TOOLS

Rotary

21. ELEVATIONS (Show whether DF, RT, GR, etc.)

3760.4' GR

22. APPROX. DATE WORK WILL START*

12/30/74

23.

PROPOSED CASING AND CEMENTING PROGRAM

SIZE OF HOLE	SIZE OF CASING	WEIGHT PER FOOT	SETTING DEPTH	QUANTITY OF CEMENT
12-1/4"	8-5/8" OD	24# K-55.	500'	Circ to surface
7-7/8"	5-1/2" OD	14# H-40	3250'	1000 sx

Propose to drill oilwell in Keel-West Waterflood area to test the Grayburg/San Andres producing capabilities.

Complete plans as required by USGS regulations to drill are attached.

RECEIVED
DEC 19 1974
U.S. GEOLOGICAL SURVEY
ARTESIA, NEW MEXICO

IN ABOVE SPACE DESCRIBE PROPOSED PROGRAM: If proposal is to deepen or plug back, give data on present productive zone and proposed new productive zone. If proposal is to drill or deepen directionally, give pertinent data on subsurface locations and measured and true vertical depths. Give blowout preventer program, if any.

24.

SIGNED

TITLE Dist. Drlg. Supv.

DATE 12/19/74

(This space for Federal or State office use)

PERMIT NO.

APPROVAL DATE

APPROVED BY

TITLE

DATE

CONDITIONS OF APPROVAL, IF ANY:

*See Instructions On Reverse Side

NEW MEXICO OIL CONSERVATION COMMISSION
WELL LOCATION AND ACREAGE DEDICATION PLAT

Form O-100
Supersedes C-128
Effective 1-1-65

All distances must be from the outer boundaries of the Section

Owner Atlantic Richfield Company			Lease Keel "B"		Acres 30	
Section 0	Range 6	Westing 17 South	Meridian 31 East	County Eddy		
Distance from the Well: 430 feet from the South line and 2250 feet from the East line						
Section Acreage 3760.4		Forming Formation San Andres		Pool Grayburg Jackson		Section Acreage SW 1/4 SE 1/4 40

- Outline the acreage dedicated to the subject well by colored pencil or hatchure marks on the plat below.
- If more than one lease is dedicated to the well, outline each and identify the ownership thereof (both as to working interest and royalty)
- If more than one lease of different ownership is dedicated to the well, have the interests of all owners been consolidated by communitization, unitization, force-pooling, etc?

☐ Yes ☐ No If answer is "yes," type of consolidation _____

If answer is "no" list the owners and tract descriptions which have actually been consolidated (Use reverse side of this form if necessary.) _____

No allowable will be assigned to the well until all interests have been consolidated (by communitization, unitization, forced-pooling, or otherwise) or until a non-standard unit, eliminating such interests, has been approved by the Commission.

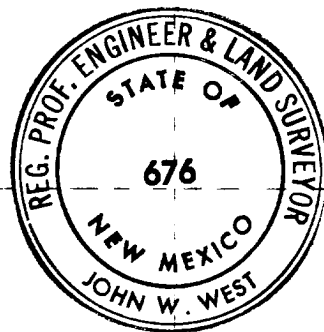

CERTIFICATION

I hereby certify that the information contained herein is true and complete to the best of my knowledge and belief.

H. H. Bernas
District Drilling Supervisor

Atlantic Richfield Company

December 19, 1974

I hereby certify that the well location shown on this plat was located from field notes of actual surveys made by me or under my supervision and that the same is true and correct to the best of my knowledge and belief.

December 17, 1974

Registered Professional Engineer
in the State of New Mexico

John W. West
676

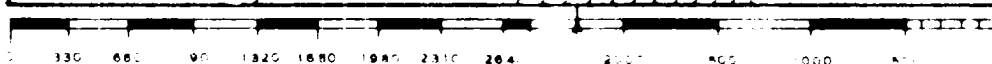
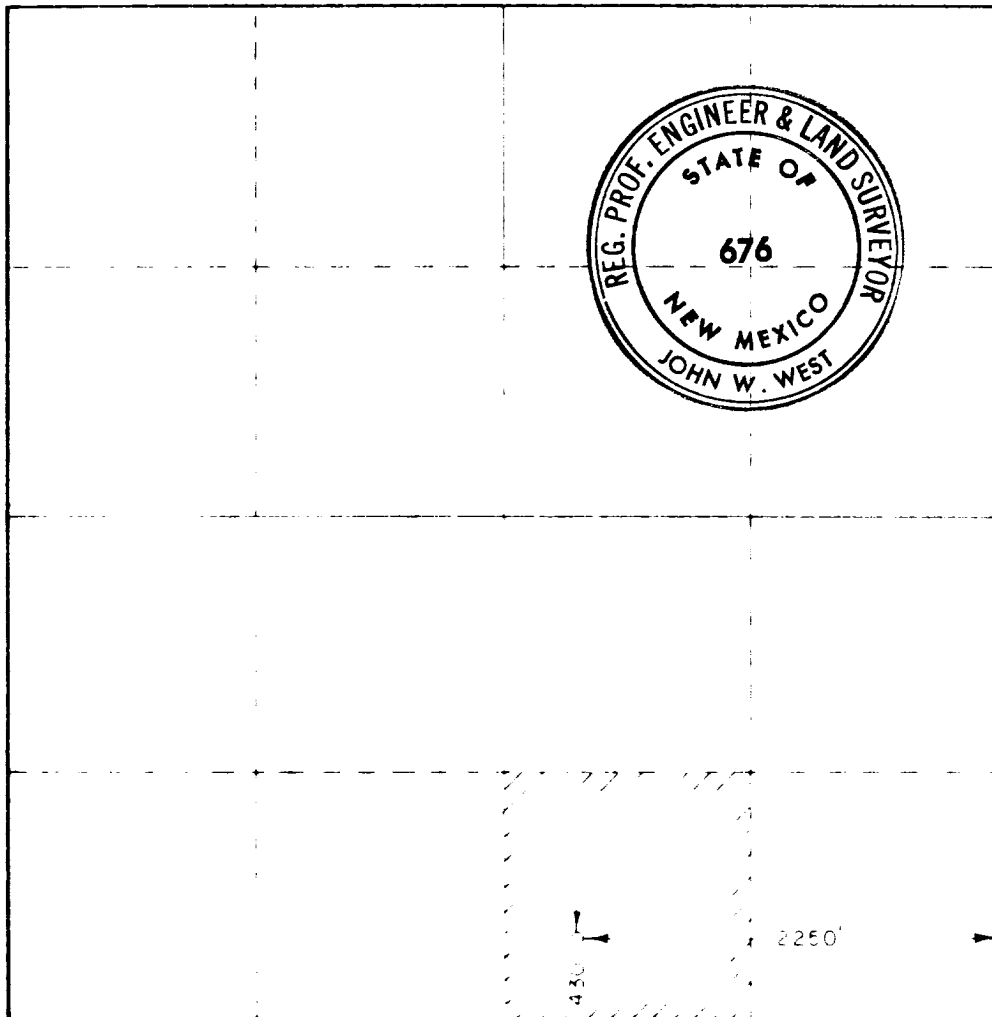

North American Producing Division
Permian District - West Area
Post Office Box 1710
Hobbs, New Mexico 88240
Telephone 505 393-7163

George V. Ricks, Superintendent
Production & Drilling



December 20, 1974

U.S.G.S.
P. O. Drawer U
Artesia, New Mexico 88210

Re: Keel B #3D
330' FSL & 2250' FEL Section 6, T17S, R31E,
Eddy County, New Mexico

Application for Permit to Drill:

1. We will exit off U. S. Highway 82 to the north. Attached is exhibit #1 on which Sec. 6 is outlined in red.
2. Planned access roads:
We will build 700' of new road as indicated on exhibit #2. The road will be 12' wide with 6" caliche compacted.
3. Location of existing wells:
Exhibit #2 shows existing wells.
4. Lateral roads to well locations:
These roads are shown on both exhibit #1 & #2.
5. Location of tank battery:
Tank battery is presently located in Sec 8, T17S, R31E, Unit letter C.
6. Location and type of water supply:
The fresh water for the surface hole and for cementing will be trucked in. The brine water will be produced water on the lease obtained from the tank battery.
7. Methods for handling waste disposal:
All solid waste from the drilling operation will be buried. A trash pit will be used for burning other solid waste.
8. Location of camp:
No camp intended.
9. Location of air strip:
No airstrip intended.

U.S.G.S.
December 20, 1974
Page 2.

10. Location of layout to include position of rig, etc.
Rig will have the engines facing south, the "V" door and racks to the east as shown on plat #3.
11. Plans for restoration of surface:
The pits will be filled and levelled. All not used area will be restored to as near the original condition as possible.
12. Any other information that may be used to evaluate the impact on environment:
(a) The working pits will be lined with plastic to contain its contents.

A handwritten signature in cursive script, reading "H J Bernard". The signature is written in dark ink and is positioned above the printed name.

H. J. Bernard

HJB:kw

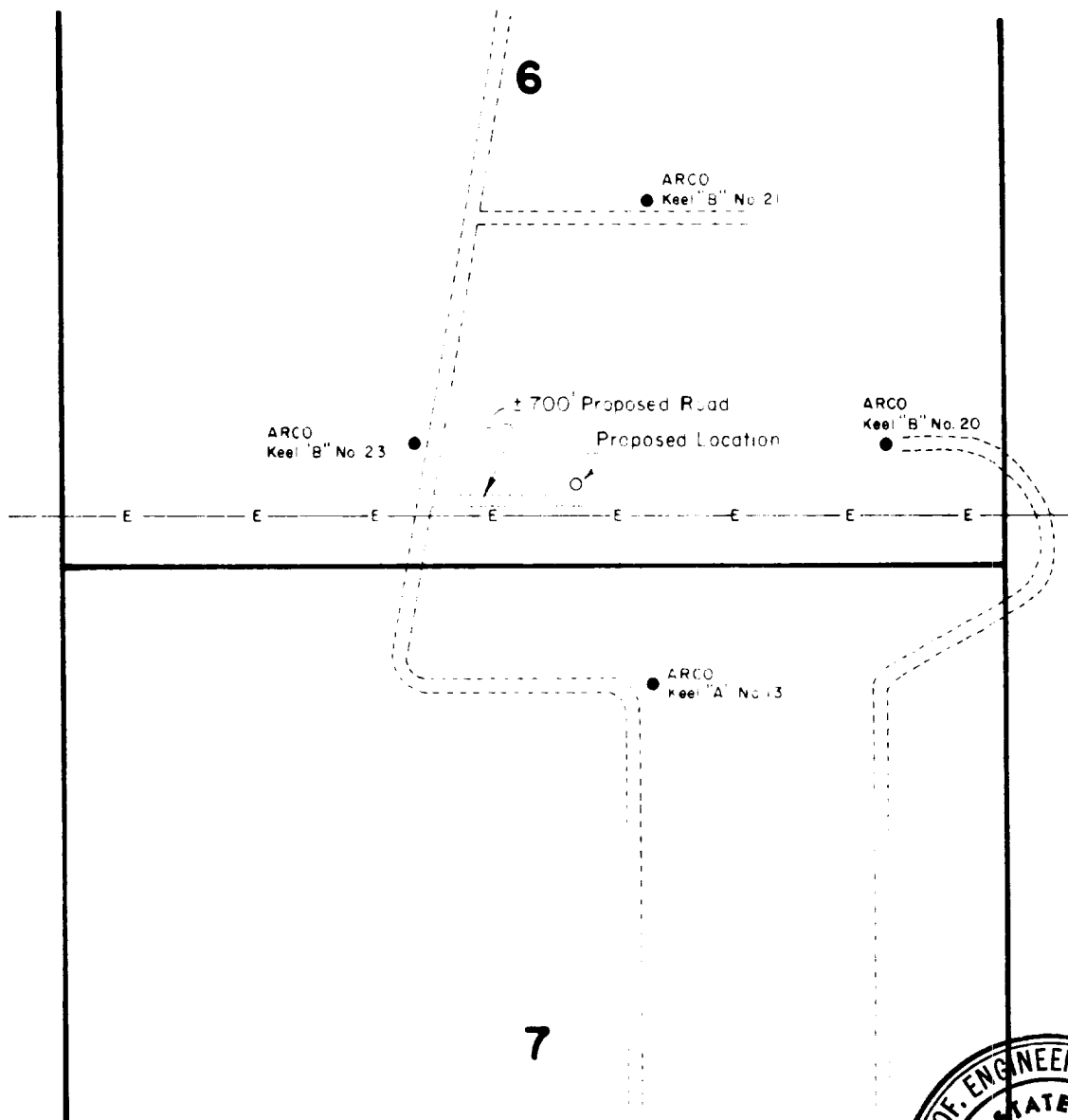

I HEREBY CERTIFY THAT THIS PLAT WAS MADE FROM NOTES TAKEN IN THE FIELD IN A BONA FIDE SURVEY MADE UNDER MY SUPERVISION, AND THAT THE SAME IS TRUE AND CORRECT TO THE BEST OF MY KNOWLEDGE AND BELIEF.

John W. West
 JOHN W. WEST, N.M. P.E. & L.S. NO. 676
 TEXAS R.P.S. NO. 1138

ATLANTIC RICHFIELD COMPANY

Topo Survey of area around the location, Keel "B" No. 31 located in Section 6, Township 17 South, Range 31 East, N.M.P.M., Eddy County, New Mexico.

JOHN W WEST ENGINEERING COMPANY
 CONSULTING ENGINEERS HOBBS, NEW MEXICO

Scale 1"=1000'	Drawn by Beverly
Date December 18, 1974	Sheet 1 of 1 Sheets

EXhibit #2

