

Proposed Well

EXHIBIT "A"  
HOLLY ENERGY INC.  
McINTYRE "B" #4  
1300' FSL 330' FWL  
Sec 20 T-17S R-30E

RIDGE

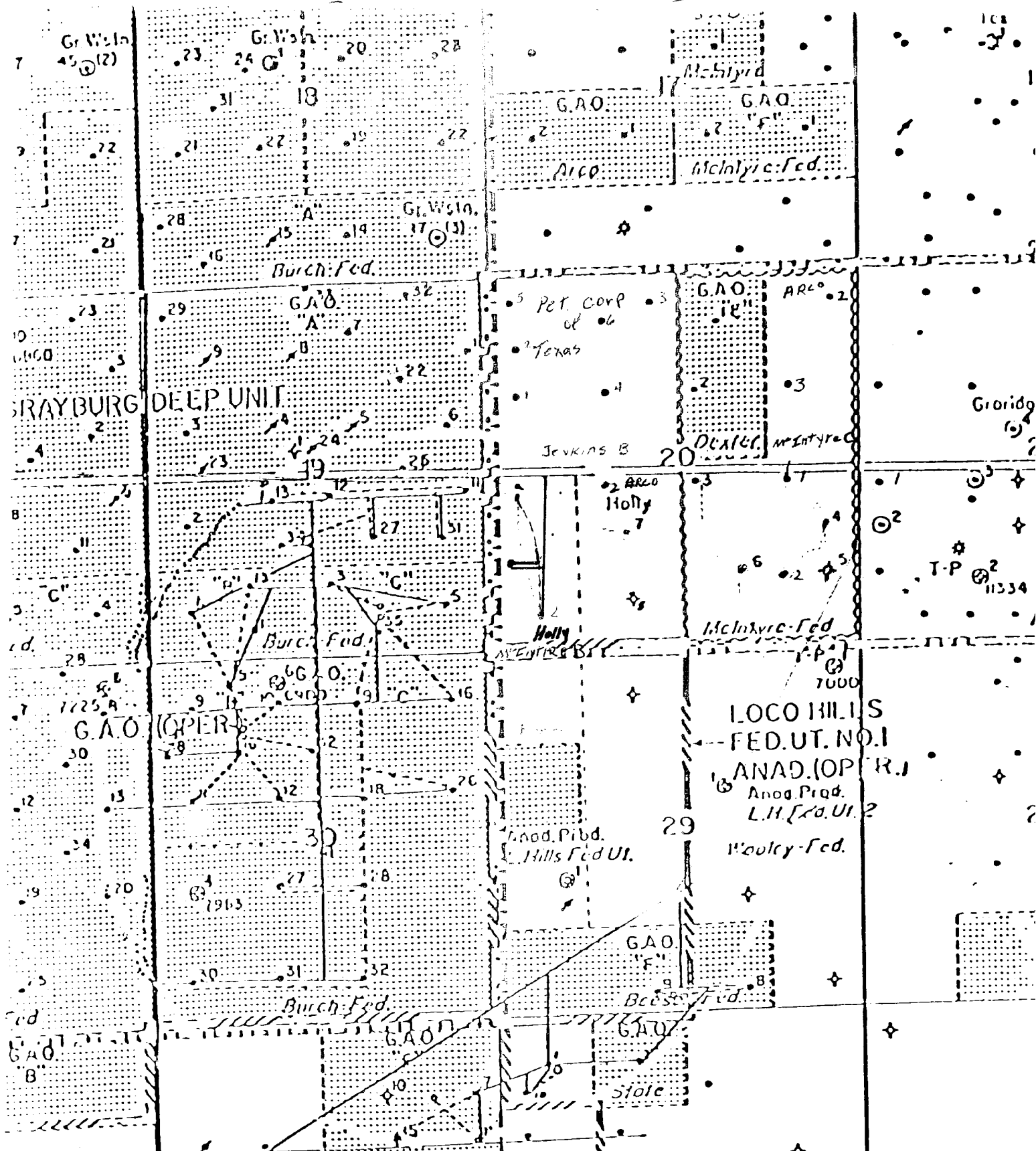

Exhibit B  
 Holly Energy Inc.  
 M-Intyre B #4 (Section 20, Township 17 South, Range 30 East)

Suggested route to location is approximately 24.8 miles East of Artesia, New Mexico to the Holly Energy Oil Camp on the Southside of U.S. 82. Turn into camp go south thru cattle guard on South side of yard for approximately 600'. (On the right side of existing lease road is M-Intyre B Tank Battery.) Location is approximately 200' on West side of existing lease road.

- Oil Well
- ⊙ Injection Well
- Existing Roads
- Proposed flowline (200' of 2" steel on top of ground)
- New proposed Road (Note: This location is just off roadside and less than 200' will be constructed.)

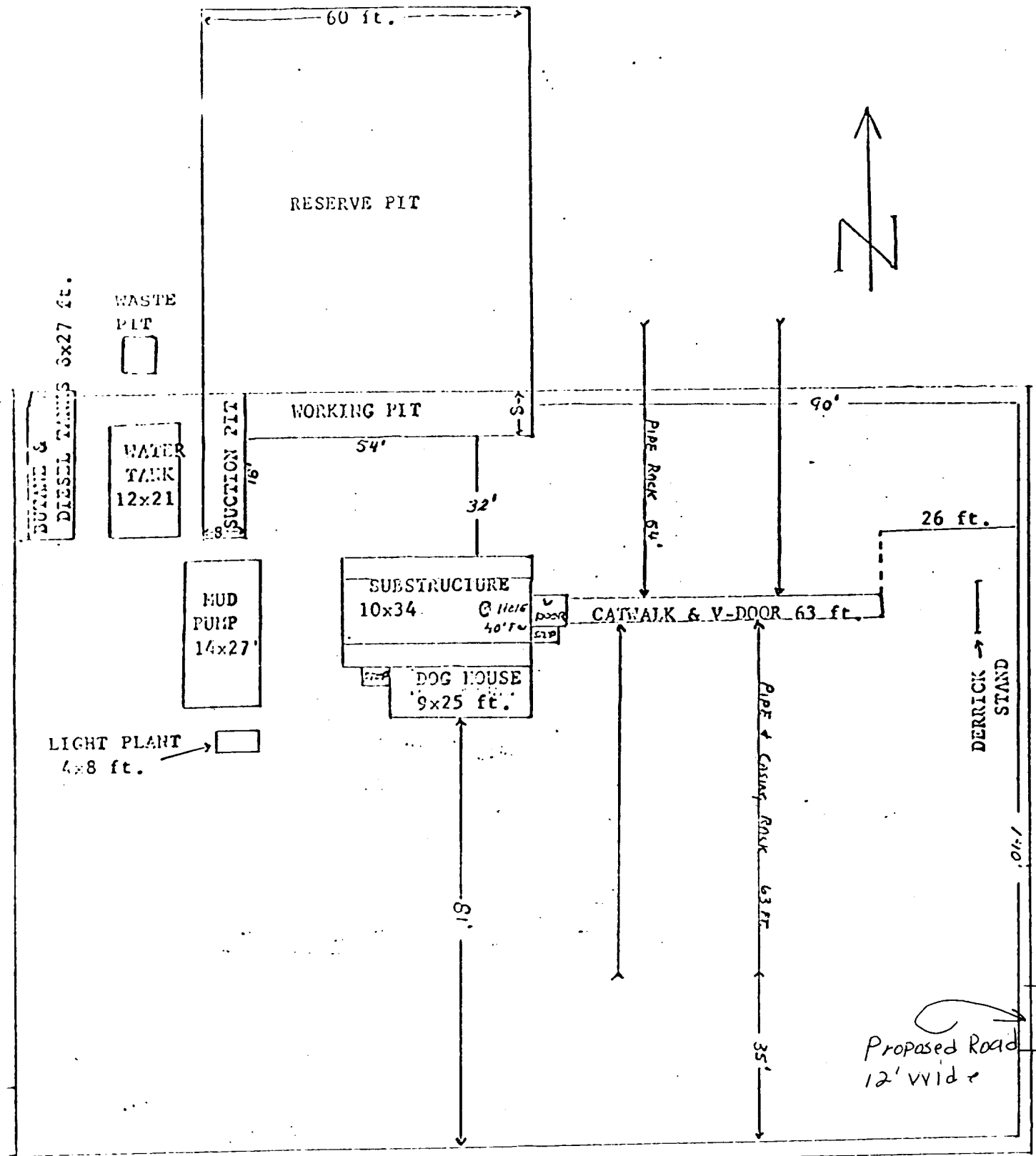

Exhibit "C" 1" = 25 FT.

# CONFIDENTIAL

CONFIDENTIAL

CONFIDENTIAL

CONFIDENTIAL

CONFIDENTIAL

CONFIDENTIAL

30-015-22472

Osrid- 13837  
Property- 18385  
Pool- 28509

938810  
938830  
938850

IT IS THEREFORE ORDERED:

Case # 6217 5-3-78 R8  
Order R-5724

(1) That an unorthodox oil well location is hereby approved for the Holly Energy, Inc. McIntyre B Well No. 4 to be drilled at a point 1300 feet from the South line and 330 feet from the West line of Section 20, Township 17 South, Range 30 East, NMPM, Grayburg-Jackson Pool, Eddy County, New Mexico.

(2) That the SW/4 SW/4 of said Section 20 shall be dedicated to the above-described well.

---