

Section No. _____

State Lease No. _____

Federal Lease No. _____

NEW MEXICO OIL CONSERVATION COMMISSION
WELL LOCATION AND ACREAGE DEDICATION PLAT

Form C-102
Supersedes C-128
Effective 1-1-65

All distances must be from the outer boundaries of the Section.

Operator Exxon Corporation			Lease NEW MEXICO "EO" STATE COMM.		Well No. 1
Unit Letter E	Section 20	Township 17S	Range 29E	County EDDY	
Actual Footage Location of Well: 1980 feet from the NORTH line and 660 feet from the WEST line					
Ground Level Elev: 3638	Producing Formation MORROW		Pool SOUTH EMPIRE-MORROW		Dedicated Acreage: 320 Acres

1. Outline the acreage dedicated to the subject well by colored pencil or hachure marks on the plat below.
2. If more than one lease is dedicated to the well, outline each and identify the ownership thereof (both as to working interest and royalty).
3. If more than one lease of different ownership is dedicated to the well, have the interests of all owners been consolidated by communitization, unitization, force-pooling, etc?

☐ Yes ☐ No If answer is "yes," type of consolidation COMMUNITIZATION IN PROCESS

If answer is "no," list the owners and tract descriptions which have actually been consolidated. (Use reverse side of this form if necessary.) _____

No allowable will be assigned to the well until all interests have been consolidated (by communitization, unitization, forced-pooling, or otherwise) or until a non-standard unit, eliminating such interests, has been approved by the Commission.

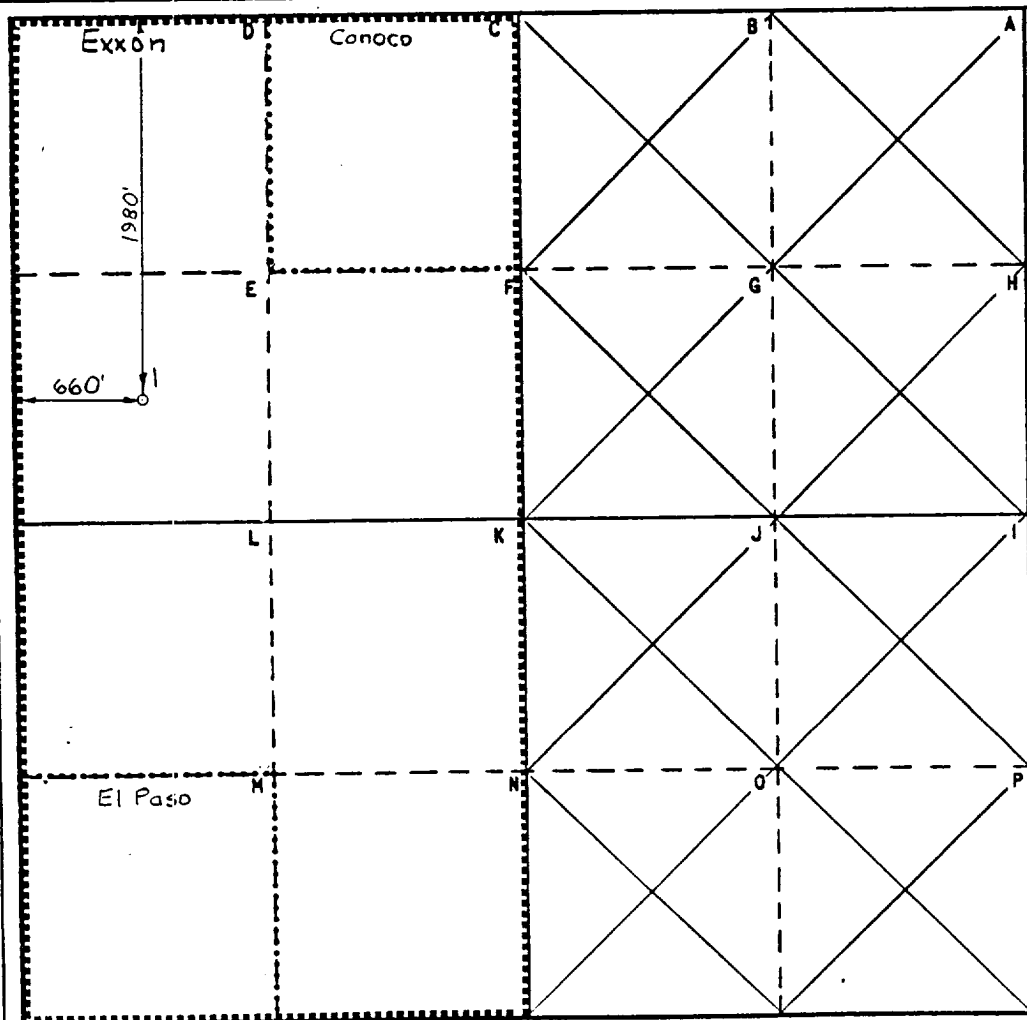

CERTIFICATION

I hereby certify that the information contained herein is true and complete to the best of my knowledge and belief.

Name Melba Knippling
Position **UNIT HEAD**

Company **Exxon Corporation**
Box 1600 Midland, Texas

Date 10-31-84

I hereby certify that the well location shown on this plat was plotted from field notes of actual surveys made by me or under my supervision, and that the same is true and correct to the best of my knowledge and belief.

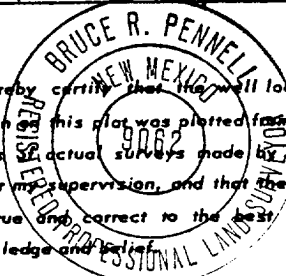

Date Surveyed 9-19-84

Registered Professional Engineer and/or Land Surveyor

Bruce R. Pennell

Certificate No. 9062

23.0 Miles EAST of ARTESIA, New Mexico

C.E. Sec. File No. W-A-8640