

District I
 PO Box 1980, Hobbs, NM 88241-1980
 District II
 811 S. 1st Street Artesia, NM 88210-1404
 District III
 1000 Rio Brazos Rd, Aztec, NM 87410
 District IV
 PO Box 2088, Santa Fe, NM 87504-2088

State of New Mexico
 Energy, Minerals & Natural Resources Department
OIL CONSERVATION DIVISION
 PO Box 2088
 Santa Fe, NM 87504-2088

Form C-101
 Revised February 10, 1994
 Instructions on back
 Submit to Appropriate District Office
 State Lease - 6 Copies
 Fee Lease - 5 Copies

DEC 16 '96

AMENDED REPORT

APPLICATION FOR PERMIT TO DRILL, RE-ENTER, DEEPEN, PLUGBACK, OR ADD A ZONE

Operator Name and Address Mack Energy Corporation P.O. Box 960 Artesia, NM 88211-0960		OGRID Number 013837
		API Number 30-015-29798
Property Code 006104	Property Name G J West Coop Unit	Well No. 141

Surface Location

UL or lot no.	Section	Township	Range	Lot Idn	Feet from the	North/South line	Feet from the	East/West line	County
N	21	17S	29E		686	South	1700	West	Eddy

Proposed Bottom Hole Location If Different From Surface

UL or lot No.	Section	Township	Range	Lot Idn	Feet from the	North/South line	Feet from the	East/West line	County
Proposed Pool 1					Proposed Pool 2				
Grayburg Jackson; 7RVS-QN-GB-SA (28509)									

Work Type Code	Well Type Code	Cable/Rotary	Lease Type Code	Ground Level Elevation
N	O	R	S	3599
Multiple	Proposed Depth	Formation	Contractor	Spud Date
No	4600'	San Andres	LaRue	12/19/96

Proposed Casing and Cement Program **TOC**

Hole Size	Casing Size	Casing weight/foot	Setting Depth	Sacks of Cement
17 1/2	13 3/8	54.5#	125'	Circ
12 1/4	8 5/8	24#	800'	Circ
7 7/8	5 1/2	17#	4600'	Sufficient to Circ

Describe the proposed program. If this application is to DEEPEN or PLUG BACK give the data on the present productive zone and proposed new productive zone. Describe the blowout prevention program, if any. Use additional sheets if necessary.

Mack Energy Corporation proposes to drill to 125', run 13 3/8" casing and cement. Drill to 800', run 8 5/8" casing and cement. Drill to 4600' and test San Andres Zone, run 5 1/2" casing and cement. Put well on production.

Note: On Production string, a fluid caliber will be run, will figure cement, with 25% excess, attempt to circulate.

*Posted FD-1
 N LCA API
 12-19-96*

I hereby certify that the information given above is true and complete to the best of my knowledge and belief		OIL CONSERVATION DIVISION	
Signature <i>Crissa D. Carter</i>	Printed name: Crissa D. Carter	Approval by: <i>Jim W. Lewis</i> BGA	Title: <i>District Supervisor</i>
Title: Production Clerk	Date: 12/16/96	Approval Date: 12-16-96	Expintion Dstc 12-16-97
Phone: (505)748-1288	Conditions of Approval: Attached <input type="checkbox"/>		

686'

66-17-1839

Certificate No. JOHN W. WEST 676
 RONALD J. EIDSON 3239
 GARY EIDSON 12641

VICINITY MAP

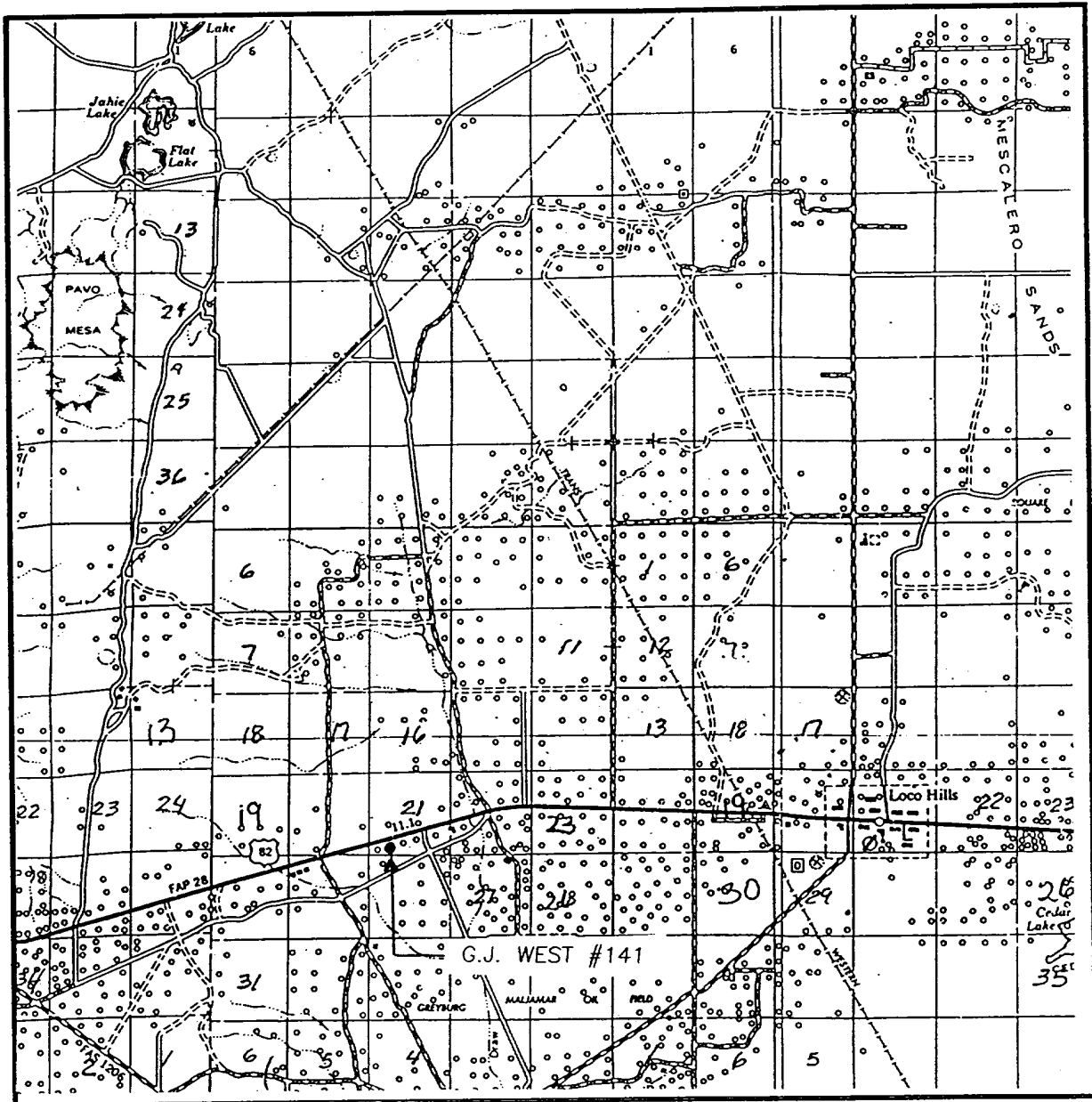

SCALE: 1" = 2 MILES

SEC. 21 TWP. 17-S RGE. 29-E

SURVEY N.M.P.M.

COUNTY EDDY

DESCRIPTION 686' FSL & 1700' FWL

ELEVATION 3599

OPERATOR MACK ENERGY CORPORATION

LEASE G.J. WEST

JOHN WEST ENGINEERING
HOBBS, NEW MEXICO
(505) 393-3117

