

**NEW MEXICO OIL CONSERVATION COMMISSION
WELL LOCATION AND ACREAGE DEDICATION PLAT**

Form C-102
Supersedes C-128
Effective 1-1-65

All distances must be from the outer boundaries of the Section.

Operator ANADARKO PRODUCTION COMPANY		Lease BALLARD GRAYBURG SAN ANDRES UNIT TRACT 13		Well No. 3
Unit Letter D	Section 5	Township 18S	Range 29E	County EDDY
Actual Footage Location of Well: 20 feet from the NORTH line and 1200 feet from the WEST line				
Ground Level Elev. 3569.0'	Producing Formation Grayburg	Pool Loco Hills Queen Grayburg San Andres	Dedicated Acreage: 40	

1. Outline the acreage dedicated to the subject well by colored pencil or hachure marks on the plat below.
2. If more than one lease is dedicated to the well, outline each and identify the ownership thereof (both as to working interest and royalty).
3. If more than one lease of different ownership is dedicated to the well, have the interests of all owners been consolidated by communitization, unitization, force-pooling, etc?

Yes No If answer is "yes," type of consolidation Unitization

If answer is "no," list the owners and tract descriptions which have actually been consolidated (Use reverse side of this form if necessary.) _____

No allowable will be assigned to the well until all interests have been consolidated (by communitization, unitization, forced-pooling, or otherwise) or until a non-standard unit, eliminating such interests, has been approved by the Commission.

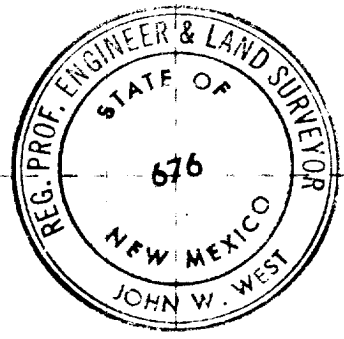
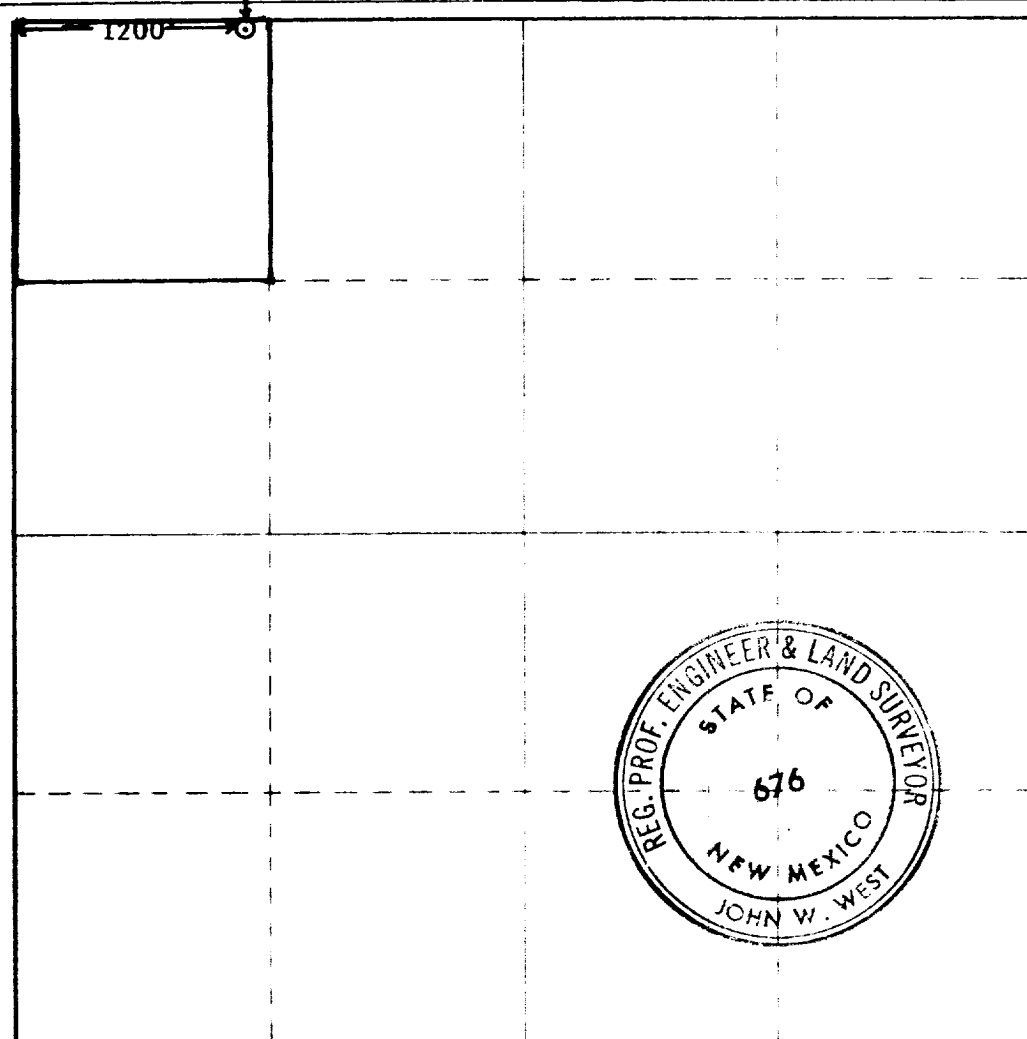

CERTIFICATION

I hereby certify that the information contained herein is true and complete to the best of my knowledge and belief.

Name: *M. J. [Signature]*
 Position: **Area Supervisor**
 Company: **Anadarko Production Co.**
 Date: **September 25, 1973**

I hereby certify that the well location shown on this plat was plotted from field notes of actual surveys made by me or under my supervision, and that the same is true and correct to the best of my knowledge and belief.

Date: **SEPTEMBER 22, 1973**
 Registered Professional Engineer
 or Licensed Surveyor
John W. West
 676

