

UNITED STATES
DEPARTMENT OF THE INTERIOR
GEOLOGICAL SURVEY

APPLICATION FOR PERMIT TO DRILL, DEEPEN, OR PLUG BACK

1a. TYPE OF WORK
 DRILL DEEPEN PLUG BACK

b. TYPE OF WELL
 OIL WELL GAS WELL OTHER **Re-Entry** SINGLE ZONE MULTIPLE ZONE

2. NAME OF OPERATOR
Shenandoah Oil Corporation ✓

3. ADDRESS OF OPERATOR
1500 Commerce Building; Fort Worth, Texas 76102

4. LOCATION OF WELL (Report location clearly and in accordance with any State requirements.)*
 At surface
650' FSL and 1,980' FEL Sec. 19, T-18S, R-31E
 At proposed prod. zone
Penrose Section of Queens Fm (3410'-3440')

14. DISTANCE IN MILES AND DIRECTION FROM NEAREST TOWN OR POST OFFICE*
15 miles SW/Maljamar, New Mexico

10. DISTANCE FROM PROPOSED* LOCATION TO NEAREST PROPERTY OR LEASE LINE, FT. (Also to nearest drlg. unit line, if any) **660'**

16. NO. OF ACRES IN LEASE **160**

17. NO. OF ACRES ASSIGNED TO THIS WELL **40**

18. DISTANCE FROM PROPOSED LOCATION* TO NEAREST WELL, DRILLING, COMPLETED, OR APPLIED FOR, ON THIS LEASE, FT. **1st well 3616'**

19. PROPOSED DEPTH **3616'**

20. ROTARY OR CABLE TOOLS
Reverse Unit

21. ELEVATIONS (Show whether DF, RT, GR, etc.)
3633' DF

22. APPROX. DATE WORK WILL START*
February 15, 1971

5. LEASE DESIGNATION AND SERIAL NO.
M 067896

6. IF INDIAN, ALLOTTEE OR TRIBE NAME

7. UNIT AGREEMENT NAME

8. FARM OR LEASE NAME
Koehane et al "D" Fed.

9. WELL NO.
1

10. FIELD AND POOL, OR WILDCAT
Shugart Y, SR, Q, G.R.

11. SEC, T, R, M, OR BLK. AND SURVEY OR AREA
Sec. 19, T-18S, R-31E

12. COUNTY OR PARISH | 13. STATE
Eddy | N. Mexico

23. PROPOSED CASING AND CEMENTING PROGRAM

SIZE OF HOLE	SIZE OF CASING	WEIGHT PER FOOT	SETTING DEPTH	QUANTITY OF CEMENT
	SEE BELOW			

This well was drilled in January, 1964 by Gulf Oil as the Federal Koehane et al #1 at total depth 3,805'.
 Casing Record - 8 5/8" 24# set @245' w/150 sacks (cement circulated)
 4 1/2" 9.5# set @3804' w/450 sacks
 Plugging Record - January, 1964 - 12 sacks cement plug 3616'-3752' and 50' plug at surface - 5 sacks between 3 5/8" csg. & 4 1/2" csg.
 It is planned to drill out plugs to approximately 3616' - perforate and test Penrose section from 3410' to 3440'.

RECEIVED

FEB 15 1971

O. C. C.
ARTESIA, OFFICE

RECEIVED
FEB 12 1971
U.S. GEOLOGICAL SURVEY
ARTESIA, NEW MEXICO

IN ABOVE SPACE DESCRIBE PROPOSED PROGRAM: If proposal is to deepen or plug back, give data on present productive zone and proposed new productive zone. If proposal is to drill or deepen directionally, give pertinent data on subsurface locations and measured and true vertical depths. Give blowout preventer program, if any.

24. SIGNED T. P. Bates TITLE Vice President - Secondary DATE February 8, 1971

(This space for Federal or State office use)

PERMIT NO. _____ APPROVAL DATE _____

APPROVED BY
CONSTRUCTION APPROVAL, IF ANY:
APPROVED
FEB 12 1971
R. L. BEEKMAN
ACTING DISTRICT ENGINEER

APPROVALS IF OPERATIONS ARE NOT COMMENCED WITHIN 3 MONTHS.
EXPIRES **MAY 12 1971**
*See Instructions On Reverse Side

DATE _____

Instructions

General: This form is designed for submitting proposals to perform certain well operations, as indicated, on all types of lands and leases for appropriate action by either a Federal or a State agency, or both, pursuant to applicable Federal and/or State laws and regulations. Any necessary special instructions concerning the use of this form and the number of copies to be submitted, particularly with regard to local, area, or regional procedures and practices, either are shown below or will be issued by, or may be obtained from, the local Federal and/or State offices.

Item 1: If the proposal is to redrill to the same reservoir at a different subsurface location or to a new reservoir, use this form with appropriate notations. Consult applicable State or Federal regulations concerning subsequent work proposals or reports on the well.

Item 4: If there are no applicable State requirements, locations on Federal or Indian land should be described in accordance with Federal requirements. Consult local State or Federal office for specific instructions.

Item 14: Needed only when location of well cannot readily be found by road from the land or lease description. A plat, or plats, separate or on this reverse side, showing the roads to, and the surveyed location of, the well, and any other required information, should be furnished when required by Federal or State agency offices.

Items 15 and 18: If well is to be, or has been directionally drilled, give distances for subsurface location of hole in any present or objective production zone.

Item 22: Consult applicable Federal or State regulations, or appropriate officials, concerning approval of the proposal before operations are started.

RECEIVED
FEDERAL BUREAU OF INVESTIGATION
U.S. DEPARTMENT OF JUSTICE
MAY 15 1963

NEW MEXICO OIL CONSERVATION COMMISSION
WELL LOCATION AND ACREAGE DEDICATION PLAT

Form C-102
Supersedes C-128
Effective 1-1-65

All distances must be from the outer boundaries of the Section.

Operator Shenandoah Oil Corporation		Lease Keohane et al "D" Federal			Well No. 1
Unit Letter 0	Section 19	Township 18S	Range 31E	County Eddy County	
Actual Footage Location of Well: 660 feet from the South line and 1,980 feet from the East line					
Ground Level Elev. 3623	Producing Formation Queen (Penrose)		Pool Yates, SR, Q, G.R.	Dedicated Acreage: 40 Acres	

1. Outline the acreage dedicated to the subject well by colored pencil or hachure marks on the plat below.
2. If more than one lease is dedicated to the well, outline each and identify the ownership thereof (both as to working interest and royalty).
3. If more than one lease of different ownership is dedicated to the well, have the interests of all owners been consolidated by communitization, unitization, force-pooling, etc?

Yes No If answer is "yes," type of consolidation _____

If answer is "no," list the owners and tract descriptions which have actually been consolidated. (Use reverse side of this form if necessary.) _____

No allowable will be assigned to the well until all interests have been consolidated (by communitization, unitization, forced-pooling, or otherwise) or until a non-standard unit, eliminating such interests, has been approved by the Commission.

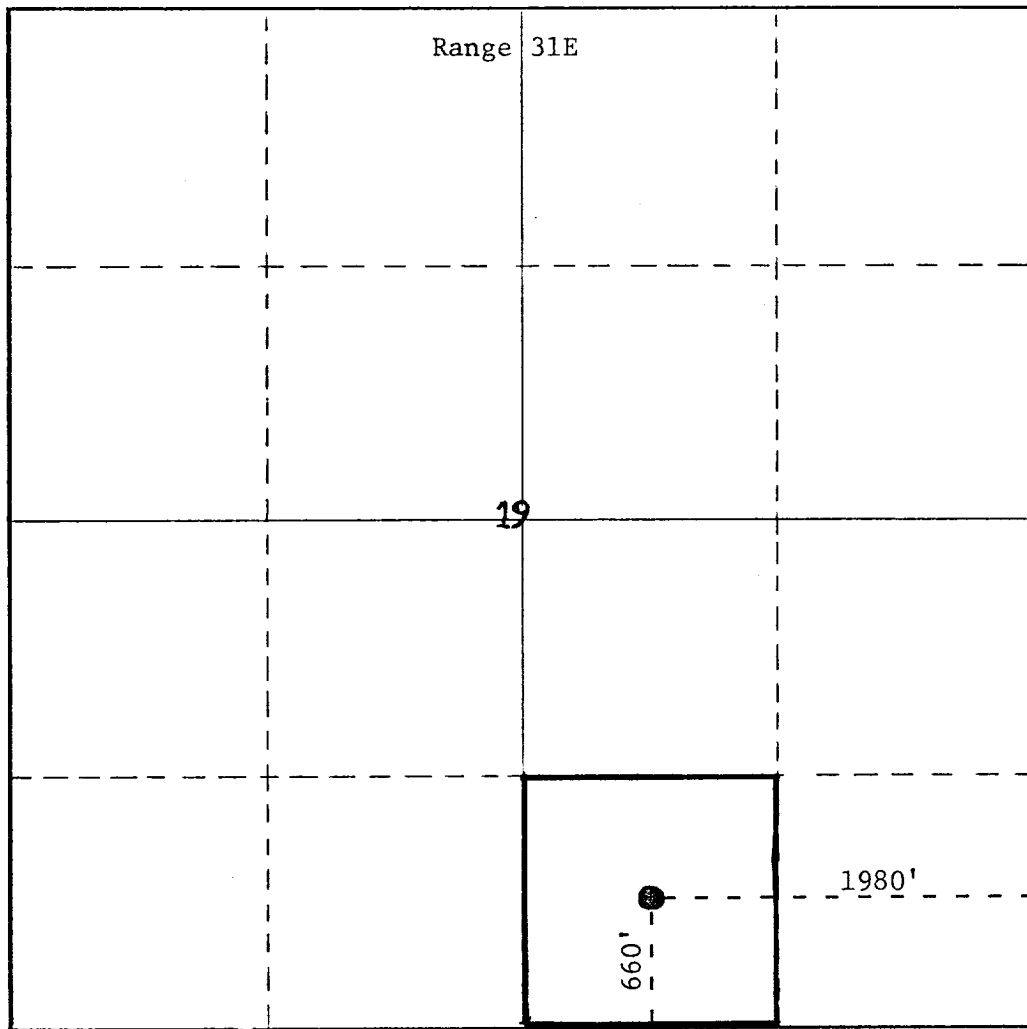

CERTIFICATION

I hereby certify that the information contained herein is true and complete to the best of my knowledge and belief.

T. P. Bates

Name
T. P. Bates

Position
Vice President-Secondary

Company
Shenandoah Oil Corp.

Date
February 8, 1971

I hereby certify that the well location shown on this plat was plotted from field notes of actual surveys made by me or under my supervision, and that the same is true and correct to the best of my knowledge and belief.

Date Surveyed
See Original Plat

Registered Professional Engineer and/or Land Surveyor

Certificate No.

