

NO. OF COPIES RECEIVED	6
DISTRIBUTION	
SANTA FE	
FILE	
U.S.G.S.	
LAND OFFICE	
OPERATOR	

NEW MEXICO OIL CONSERVATION COMMISSION

- 6 - NMOCC - Artesia
- 1 - Div. Prod. Mgr. - Houston
- 1 - Dist. Prod. Mgr. - Midland
- 1 - File

30-015-21641
Form C-101
Revised 1-1-65

5A. Indicate Type of Lease
STATE FEE

5. State Oil & Gas Lease No.
K-6096

APPLICATION FOR PERMIT TO DRILL, DEEPEN, OR PLUG BACK

1a. Type of Work b. Type of Well DRILL <input checked="" type="checkbox"/> DEEPEN <input type="checkbox"/> PLUG BACK <input type="checkbox"/> OIL WELL <input type="checkbox"/> GAS WELL <input checked="" type="checkbox"/> OTHER <input type="checkbox"/> SINGLE ZONE <input type="checkbox"/> MULTIPLE ZONE <input type="checkbox"/>		7. Unit Agreement Name
2. Name of Operator Getty Oil Company		8. Farm or Lease Name State "K" 6096 B
3. Address of Operator P. O. Box 249, Hobbs, New Mexico 88240		9. Well No. 1
4. Location of Well UNIT LETTER G LOCATED 1650 FEET FROM THE North LINE AND 1980 FEET FROM THE East LINE OF SEC. 32 TWP. 19S RGE. 25E NMPM		10. Field and Pool, or Wildcat Undesignated
		12. County Eddy
		19. Proposed Depth 9400
		19A. Formation Morrow
		20. Rotary or C.T. Rotary
21. Elevations (Show whether DF, RT, etc.) 3499.9	21A. Kind & Status Plug. Bond Blanket	21B. Drilling Contractor Pending
		22. Approx. Date Work will start When Rig Available

PROPOSED CASING AND CEMENT PROGRAM

SIZE OF HOLE	SIZE OF CASING	WEIGHT PER FOOT	SETTING DEPTH	SACKS OF CEMENT	EST. TOP
17-1/2	13-3/8	48	475	215	Surface
12-1/4	9-5/8	32.3	1300	410*	Surface
8-3/4	7	23 & 26	9400	511*	6000'

* Actual volume to be determined by Fluid Caliper.

It is proposed to drill a 17-1/2" hole to 475' where 13-3/8" casing will be set. Then an 8-3/4" hole will be drilled to 9400'. Well will be logged and evaluated. The 7" casing will be set if warranted by above evaluation.

BOP - See attachment

APPROVAL VALID FOR 90 DAYS UNLESS DRILLING COMMENCED,
EXPIRES 12-30-75

RECEIVED
SEP 29 1975
O. C. C.
ARTESIA, OFFICE

IN ABOVE SPACE DESCRIBE PROPOSED PROGRAM; IF PROPOSAL IS TO DEEPEN OR PLUG BACK, GIVE DATA ON PRESENT PRODUCTIVE ZONE AND PROPOSED NEW PRODUCTIVE ZONE. GIVE BLOWOUT PREVENTER PROGRAM, IF ANY.

I hereby certify that the information above is true and complete to the best of my knowledge and belief.

Original Signed By

Signed G. L. WALKER Title Area Superintendent Date Sept. 26, 1975

(This space for State Use)

APPROVED BY W. A. Sweet TITLE SUPERVISOR, DISTRICT II DATE SEP 30 1975

CONDITIONS OF APPROVAL, IF ANY:

Cement must be circulated to surface behind 13 3/8" & 9 5/8" casing

Notify N.M.O.C.C. in sufficient time to witness cementing the 9 5/8" casing

NEW MEXICO OIL CONSERVATION COMMISSION
WELL LOCATION AND ACREAGE DEDICATION PLAT

Form C-102
Supersedes C-128
Effective 1-1-65

All distances must be from the outer boundaries of the Section

Operator Getty Oil Company		Lease State K-6096-B			Well No. 1
Section G	Section 32	Township 19 South	Range 25 East	County Eddy	
Actual Well Location of Well: 1650 feet from the North line and 1980 feet from the East line					
Ground Elev. 3499.9	Producing Formation Morrow	Pool <i>See attached</i>		Dedicated Acreage 320	Acre

- Outline the acreage dedicated to the subject well by colored pencil or hachure marks on the plat below.
- If more than one lease is dedicated to the well, outline each and identify the ownership thereof (both as to working interest and royalty).
- If more than one lease of different ownership is dedicated to the well, have the interests of all owners been consolidated by communitization, unitization, force-pooling, etc?

RECEIVED

SEP 29 1975

O. C. C.

ARTEZIA, OFFICE

Communitization is in progress

Yes No If answer is "yes," type of consolidation

If answer is "no," list the owners and tract descriptions which have actually been consolidated. (Use reverse side of this form if necessary.) See attached

No allowable will be assigned to the well until all interests have been consolidated (by communitization, unitization, forced-pooling, or otherwise) or until a non-standard unit, eliminating such interests, has been approved by the Commission.

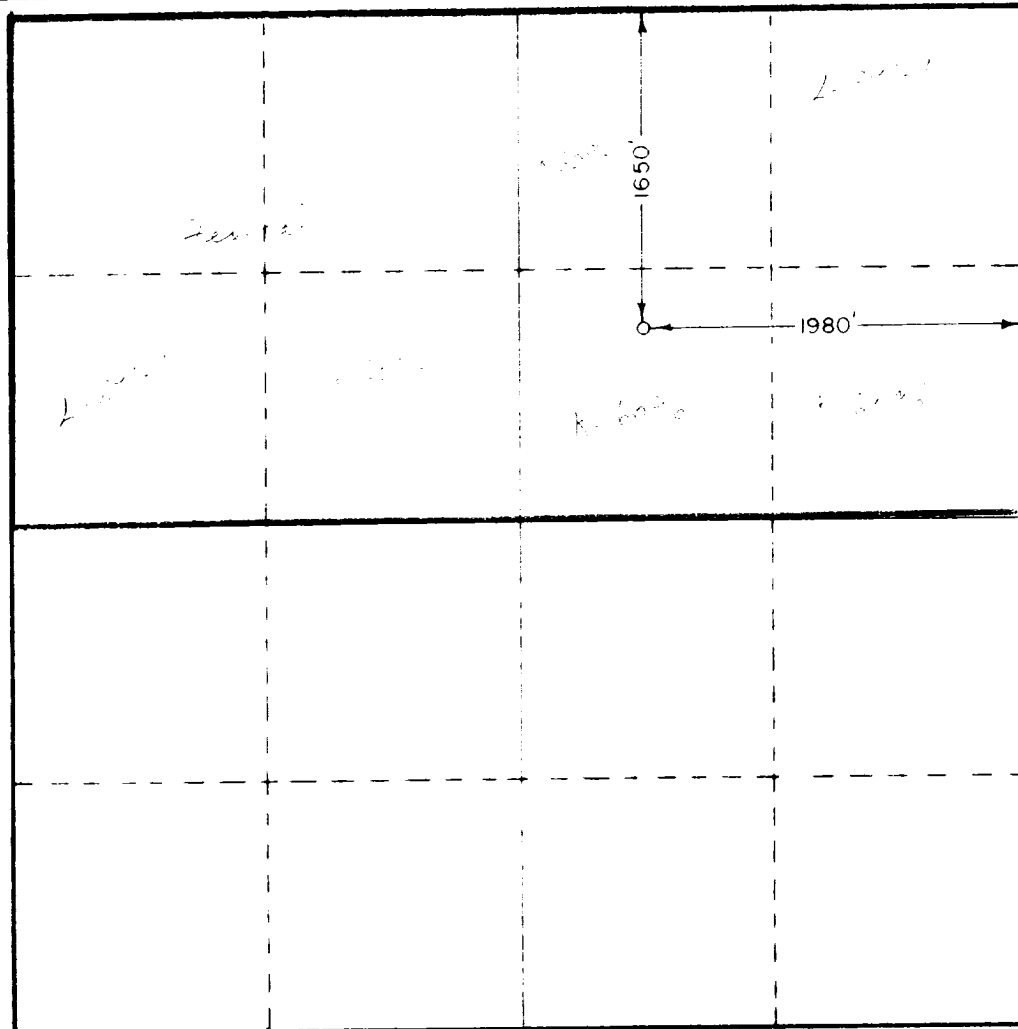

CERTIFICATION

I hereby certify that the information contained herein is true and complete to the best of my knowledge and belief.

Original Signed By

O. L. WADE

Name

C. L. Wade

Position

Area Superintendent

Company

Getty Oil Company

Date

September 26, 1975

I hereby certify that the well location shown on this plat was plotted from field notes of actual surveys made by me or under my supervision, and that the same is true and correct to the best of my knowledge and belief.

Date Surveyed

June 28, 1975

Registered Professional Engineer and Land Surveyor

676

Certificate No.

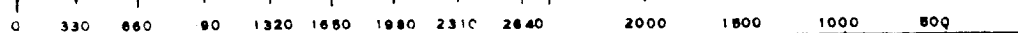
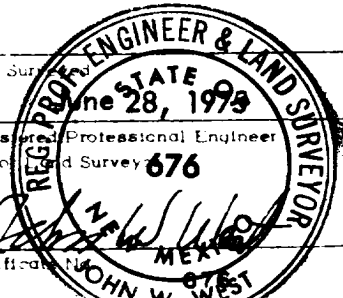

DESCRIPTION OF LEASES COMMITTED

Tract No. I

Lessor: State of New Mexico

Lessee of Record: Mesa Petroleum Co., and King Resources Company.

Serial No. of Lease: L-891-1

Date of Lease: May 21, 1968

Description of Lands Committed:

Township 19 South, Range 25 East, N.M.P.M.

Section 32 - NE/4 NE/4, SW/4 NW/4

Number of Acres: 80 Acres

Working Interest and Percentage:

Mesa Petroleum Company	50%
King Resources Company	50%

Royalty and Percentage:

State of New Mexico	12.5%
---------------------	-------

Overriding Royalty and Percentage:

Robert B. Gates and wife, Nada S. Gates	5%
--	----

Tract No. II

Lessor: State of New Mexico

Lessee of Record: Getty Oil Company

Serial No. of Lease: K-6096

Date of Lease: June 21, 1966

Description of Lands Committed:

Township 19 South, Range 25 East, N.M.P.M.

Section 32 - W/2 NE/4, SE/4 NE/4, SE/4 NW/4

Number of Acres: 160 Acres

Working Interest and Percentage:

Getty Oil Company 100%

Royalty Interest:

State of New Mexico 12.5%

Overriding Royalty Interest:

None*

*The lands are subject to a production payment reserved by T. J. Sivley in the amount of \$400,000. payable out of 1/16th of 8/8ths of gross proceeds, after deduction of gross production, severance and similar taxes, payable out of production from these lands, and from the SW/4 of Section 28, and the S/2 NW/4 of Section 33, both in Township 19 South, Range 25 East, N.M.P.M.

Tract No. III

Lessor: United States of America

Lessee of Record: Monsanto Company

Serial No. of Lease: NM 0553777

Date of Lease: June 1, 1964

Description of Lands Committed:

Township 19 South, Range 25 East, N.M.P.M.

Section 32 - N/2 NW/4

Number of Acres: 80 Acres

Working Interest and Percentage:

Monsanto Company 100%

Royalty and Percentage:

United States of America 12.5%

Overriding Royalty and Percentage:

John B. Carter, Jr., Trustee of
the Catherine Browne Carter
Trust Estate 6.25%

John B. Carter, Jr., Trustee of
the Catherine Browne Carter Trust Estate 6.25%

EXHIBIT "B"

STATE "K" 6096 "B"

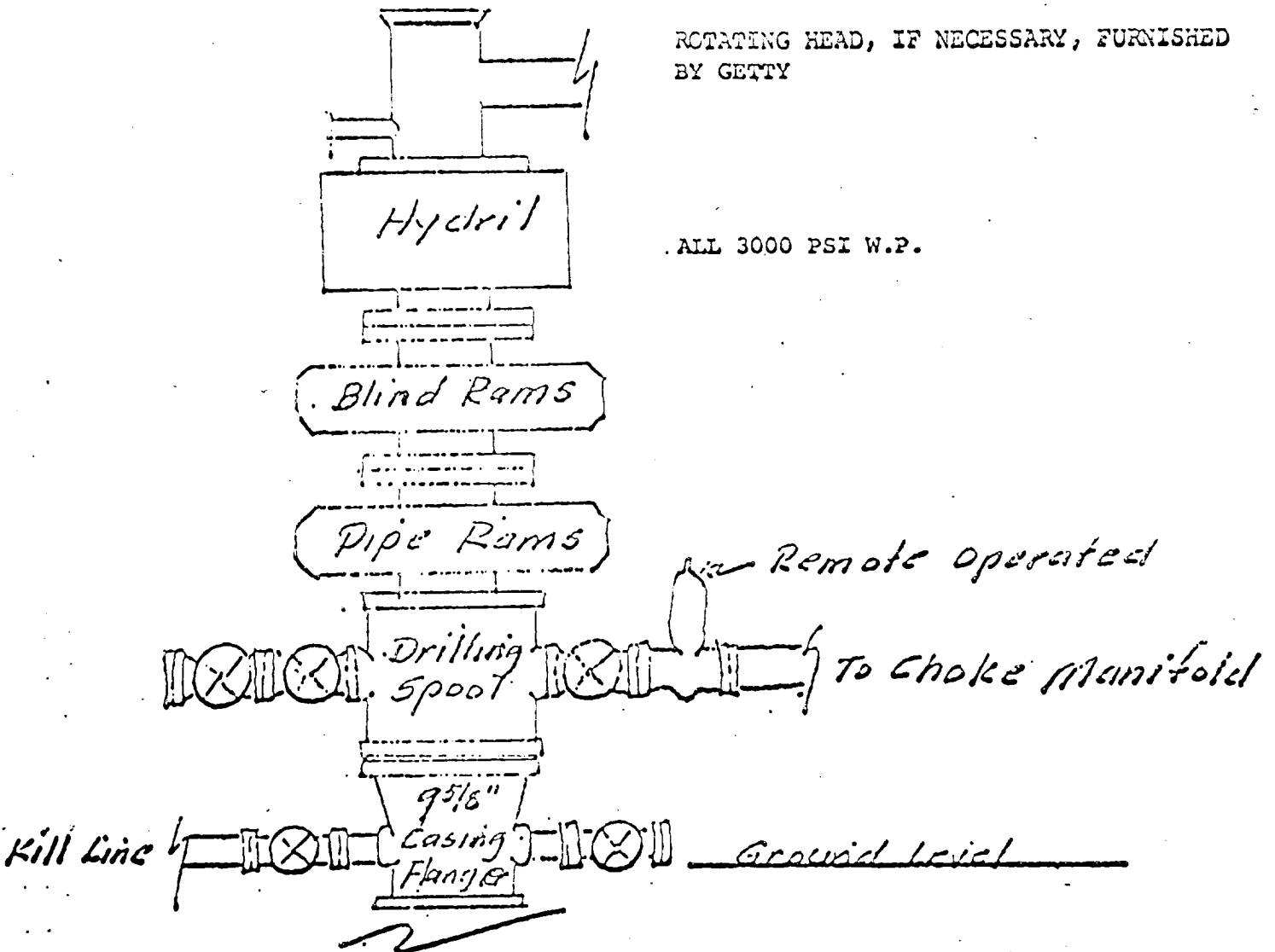

1. The 13-3/8" B.O.P. Stack will consist of two (2) ram type B.O.P.'s.
2. The 9-5/8" B.O.P. Stack will consist of the above arrangement.
3. The choke manifold will consist of one adjustable choke with a By-Pass Valve to the Pit.