

NO. OF COPIES RECEIVED	
DISTRIBUTION	
SANTA FE	✓
FILE	✓
U.S.G.S.	2
LAND OFFICE	✓
OPERATOR	✓

RECEIVED BY
P. O. BOX 208
SANTA FE, NEW MEXICO 87501
JAN 9 1985
O. C. D.
ARTESIA OFFICE

5A. Indicate Type of Lease
STATE FEE
5. State Oil & Gas Lease No.
B-8096

APPLICATION FOR PERMITTED DRILL DEEPENING

1a. Type of Work
b. Type of Well DRILL DEEPEN PLUG BACK
OIL WELL GAS WELL OTHER SINGLE ZONE MULTIPLE ZONE

2. Name of Operator
Mitchell Energy Corporation

3. Address of Operator
P. O. Box 4000 The Woodlands, Texas 77387-4000

4. Location of Well UNIT LETTER J LOCATED 1980 FEET FROM THE South LINE
AND 1980 FEET FROM THE East LINE OF SEC. 7 TWP. 19S RGE. 29E NMPM

7. Unit Agreement Name
N/A

8. Farm or Lease Name
Conoco -7-State

9. Well No.
13

10. Field and Pool, or Wildcat
East Millman-D-G

12. County
Eddy

19. Proposed Depth
3500'

19A. Formation
Grayburg

20. Rotary or C.T.
Rotary

21. Elevations (Show whether DF, KI, etc.)
3376' G.L.

21A. Kind & Status Plug. Bond
Active Blanket

21B. Drilling Contractor
Unknown

22. Approx. Date Work will start
2-15-85

PROPOSED CASING AND CEMENT PROGRAM

SIZE OF HOLE	SIZE OF CASING	WEIGHT PER FOOT	SETTING DEPTH	SACKS OF CEMENT	EST. TOP
11"	8 5/8"	24#	350'	200	Surface
7 7/8"	5 1/2"	14#	3500'	365	Surface

This well will be spudded with an 11" hole and drilled to a depth of 350'. Surface casing will be run and cement circulated to the surface. Casing will be tested to 1000 psi before drilling out of the surface casing. BOP's will be pressure tested a minimum of once every 10 days. A 7 7/8" hole will be drilled to a total depth of 3500'. If the well is determined to be productive, 5 1/2" casing will be run and cemented to the surface with 365 sacks.

ATTENTION: 120 DAYS
7-14-85
ASKED TO 1-2-86 JH

IN ABOVE SPACE DESCRIBE PROPOSED PROGRAM; IF PROPOSAL IS TO DEEPEN OR PLUG BACK, GIVE DATA ON PRESENT PRODUCTIVE ZONE AND PROPOSED NEW PRODUCTIVE ZONE. GIVE BLOWOUT PREVENTER PROGRAM, IF ANY.

I hereby certify that the information above is true and complete to the best of my knowledge and belief.
Signed Bill G. Spencer Title Sr. Regulatory Affairs Coord. Date December 20, 1984

(This space for State Use)
Original Signed By Mike Williams
Oil & Gas Inspector
DATE JAN 14 1985

CONDITIONS OF APPROVAL, IF ANY:

DEC 17 1984

All distances must be from the outer boundaries of the Section.

Operator Mitchell Energy		Lease Conoco Seven State			Well No. #13
Unit Letter J	Section 7	Township 19 South	Range 29 East	County Eddy	
Actual Wellbore Location of Well					
1980 feet from the South line and		1980 feet from the East line			
Ground Level Elev. 3376	Producing Formation Grayburg	Pool East Millman	Dedicated Acreage 40		

1. Outline the acreage dedicated to the subject well by colored pencil or hachure marks on the plat below.
2. If more than one lease is dedicated to the well, outline each and identify the ownership thereof (both as to working interest and royalty).
3. If more than one lease of different ownership is dedicated to the well, have the interests of all owners been consolidated by communitization, unitization, force-pooling, etc?

Yes No If answer is "yes," type of consolidation Communitization (Joint Operating Agreement)

If answer is "no," list the owners and tract descriptions which have actually been consolidated. (Use reverse side of this form if necessary.)

No allowable will be assigned to the well until all interests have been consolidated (by communitization, unitization, forced-pooling, or otherwise) or until a non-standard unit, eliminating such interests, has been approved by the Division

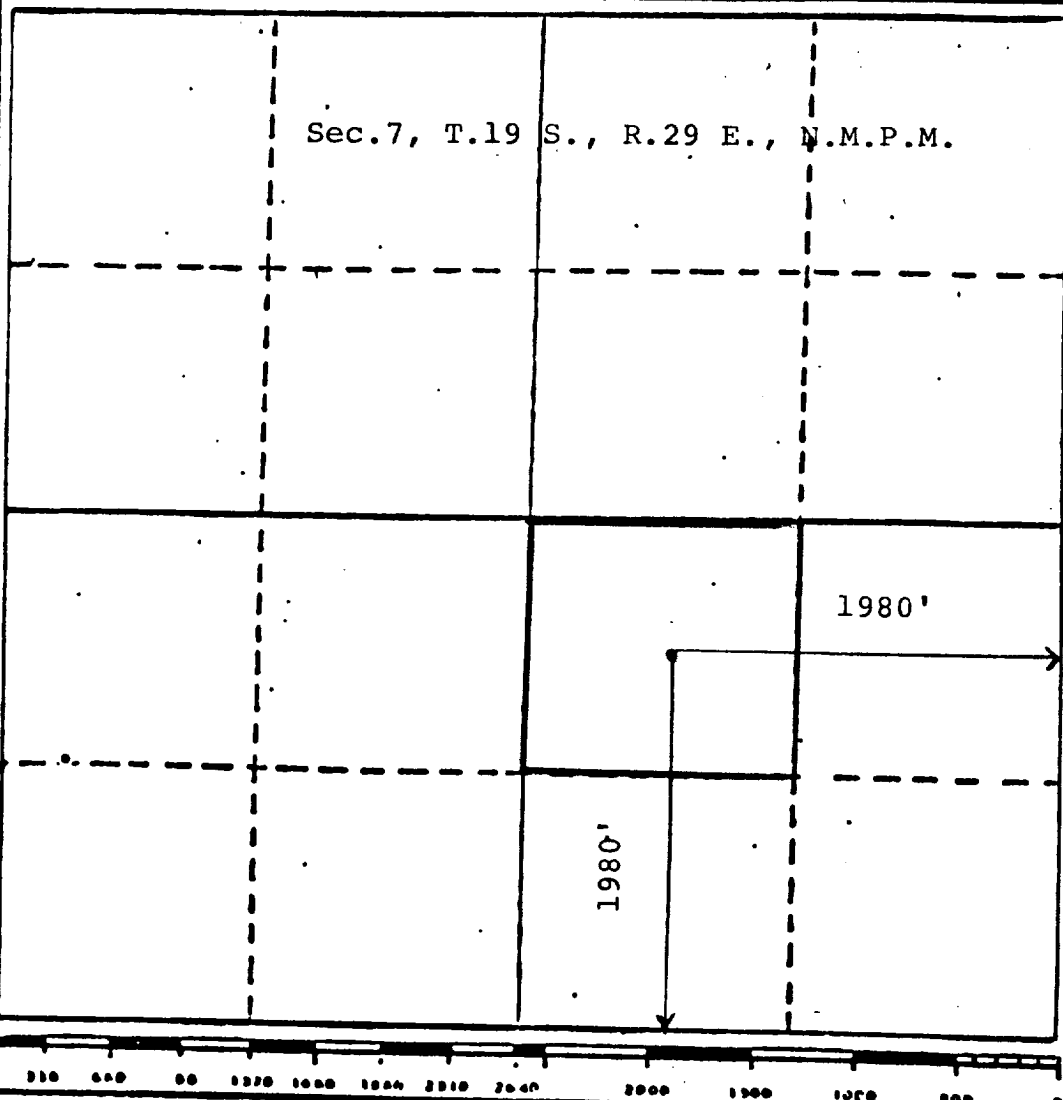

CERTIFICATION

I hereby certify that the information contained herein is true and complete to the best of my knowledge and belief.

Bill G. Spencer

Name

Bill G. Spencer

Position

Sr Regulatory Affairs Coord

Company

Mitchell Energy Corp

Date

December 20, 1984

I hereby certify that the well location shown on this plat was plotted from field notes of actual surveys made by me or under my supervision, and that the same is true and correct to the best of my knowledge and belief.

Date Surveyed December 13, 1984

Registered Professional Engineer and/or Land Surveyor

John D. ...
6290 PROFESSIONAL ENGINEER & LAND SURVEYOR

3000 LB. W.P. B.O.P.
 10" CAMERON TYPE PRESS HYDRAULIC B.O.P. 3000 P.S.I.
 12 G.K. HYDRILL 3000 W.P.
 80 GALLON- STATION KOOMEY ACCUMULATOR
 3000 LB. W.P. CHOKE MANIFOLD

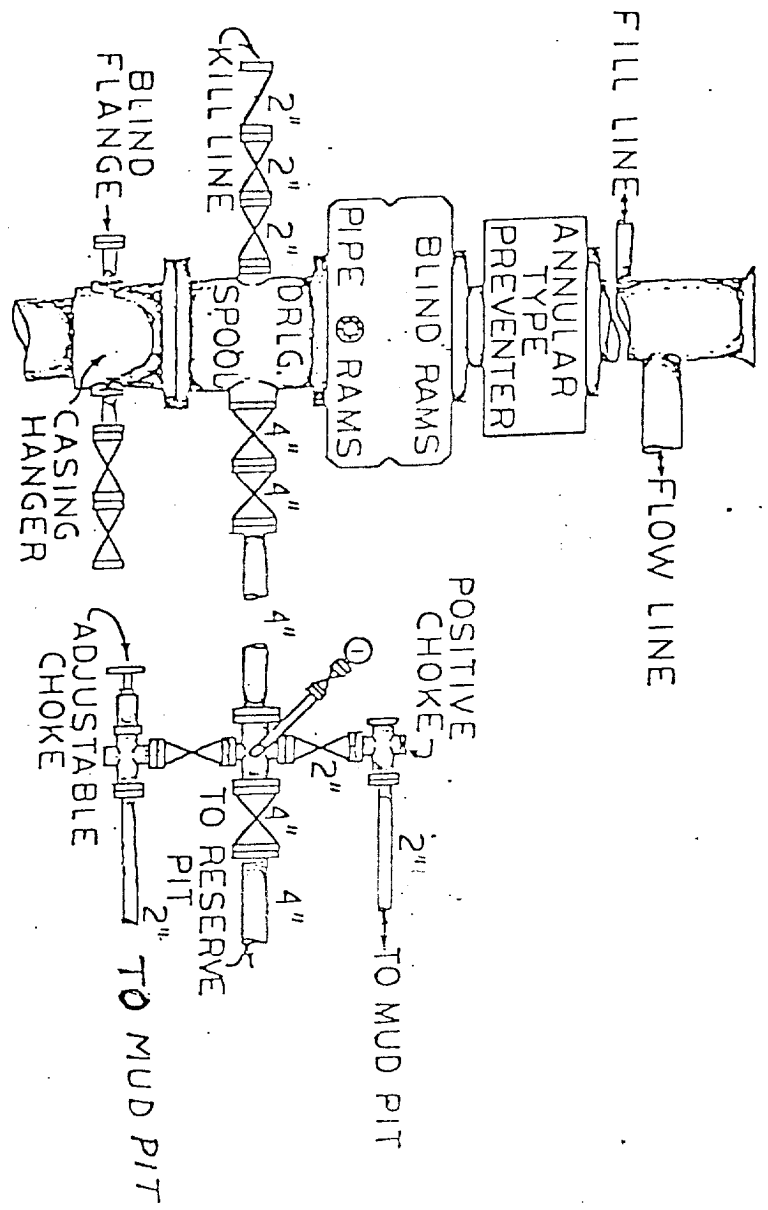

Lands Drilling Company

