

UNITED STATES  
DEPARTMENT OF THE INTERIOR  
BUREAU OF LAND MANAGEMENT

NM OIL CONS. COMMISSION  
DRAWER D.  
ARTESIA, NM 88210

015F

FORM APPROVED  
Budget Bureau No. 1004-0135  
Expires March 31, 1993

**SUNDRY NOTICES AND REPORTS ON WELLS**

Do not use this form for proposals to drill or to deepen or reentry to a different reservoir.  
Use "APPLICATION FOR PERMIT—" for such proposals.

**SUBMIT IN TRIPLICATE**

1. Type of Well  
 Oil Well     Gas Well     Other

2. Name of Operator  
**DEVON ENERGY CORPORATION (NEVADA)**

3. Address and Telephone No.  
**20 NORTH BROADWAY, SUITE 1500, OKLAHOMA CITY, OKLAHOMA 73102 (405) 235-3611**

4. Location of Well (Footage. Sec., T., R., M., or Survey Description)  
**Unit I, Section 34-T18S-R31E, 2450' FSL & 330' FEL**

5. Lease Designation and Serial No.  
**NM 10190**

6. If Indian, Allottee or Tribe Name  
**N/A**

7. If Unit or CA, Agreement Designation  
**14-08-001-11572**

8. Well Name and No.  
**East Shugart Unit #67**

9. API Well No.  
**30-015-27958**

10. Field and Pool, or Exploratory Area  
**Shugart (Y-SR-Q-G)**

11. County or Parish, State  
**Eddy Cnty, NM**

JAN 6 '95

D.  
ARTESIA OFFICE

**CHECK APPROPRIATE BOX(S) TO INDICATE NATURE OF NOTICE, REPORT, OR OTHER DATA**

TYPE OF SUBMISSION	TYPE OF ACTION
<input type="checkbox"/> Notice of Intent	<input type="checkbox"/> Abandonment
<input checked="" type="checkbox"/> Subsequent Report	<input type="checkbox"/> Recompletion
<input type="checkbox"/> Final Abandonment Notice	<input type="checkbox"/> Plugging Back
	<input type="checkbox"/> Casing Repair
	<input type="checkbox"/> Altering Casing
	<input checked="" type="checkbox"/> Other <u>Changed location</u>
	<input type="checkbox"/> Change of Plans
	<input type="checkbox"/> New Construction
	<input type="checkbox"/> Non-Routine Fracturing
	<input type="checkbox"/> Water Shut-Off
	<input type="checkbox"/> Conversion to Injection
	<input type="checkbox"/> Dispose Water

(Note: Report results of multiple completion on Well Completion or Recompletion Report and Log form.)

13. Describe Proposed or Completed Operations (Clearly state all pertinent details, and give pertinent dates, including estimated date of starting any proposed work. If well is directionally drilled, give subsurface locations and measured and true vertical depths for all markers and zones pertinent to this work.)\*

Please be advised the ESU #67 location has been moved 30' east and 500' north from 1950' FSL & 360' FEL to 2450' FSL & 330' FEL. (See attached plat.)

The new location will be arched.

NOV 7 10 23 AM '94  
RECEIVED

Post ID-1  
1-27-95  
chy fts-

4. I hereby certify that the foregoing is true and correct

Signed Candace R. Graham Title CANDACE R. GRAHAM ENGINEERING TECH. Date 11/4/94

This space for Federal or State office use)

Approved by NO. SODA RICHARD T. SPANIA Title AREA MANAGER Date 12/19/94

Conditions of approval, if any:

Title 18 U.S.C. Section 1001, makes it a crime for any person knowingly and willfully to make to any department or agency of the United States any false, fictitious or fraudulent statements or representations as to any matter within its jurisdiction.

**OIL CONSERVATION DIVISION**

P.O. Box 2088

Santa Fe, New Mexico 87504-2088

**DISTRICT I**  
 P.O. Box 1980, Hobbs, NM 88240

**DISTRICT II**  
 P.O. Drawer DD, Artesia, NM 88210

**DISTRICT III**  
 1000 Rio Bravo Rd., Aztec, NM 87410

**WELL LOCATION AND ACREAGE DEDICATION PLAT**

All Distances must be from the outer boundaries of the section

Operator <b>Devon Energy Corporation</b>		Lease <b>East Shugart Unit</b>		Well No. <b>67</b>
Unit Letter <b>I</b>	Section <b>34</b>	Township <b>18 South</b>	Range <b>31 East</b>	County <b>Eddy</b>
Actual Footage Location of Well: <b>2450</b> feet from the <b>South</b> line and <b>330</b> feet from the <b>East</b> line				
Ground level Elev. <b>3627</b>	Producing Formation <b>Yates-Queen</b>	Pool <b>Shugart (Y-SR-Q-G)</b>	Dedicated Acreage: <b>40 Acres</b>	

- Outline the acreage dedicated to the subject well by colored pencil or indelible marks on the plat below.
- If more than one lease is dedicated to the well, outline each and identify the ownership thereof (both as to working interest and royalty).
- If more than one lease of different ownership is dedicated to the well, have the interest of all owners been consolidated by communitization, unitization, force-pooling, etc.?
  - Yes  No If answer is "yes" type of consolidation \_\_\_\_\_
 If answer is "no" list the owners and tract descriptions which have actually been consolidated. (Use reverse side of this form if necessary.)  
 No allowable will be assigned to the well until all interests have been consolidated (by communitization, unitization, force-pooling, or otherwise) or until a non-standard unit, eliminating such interest, has been approved by the Division.

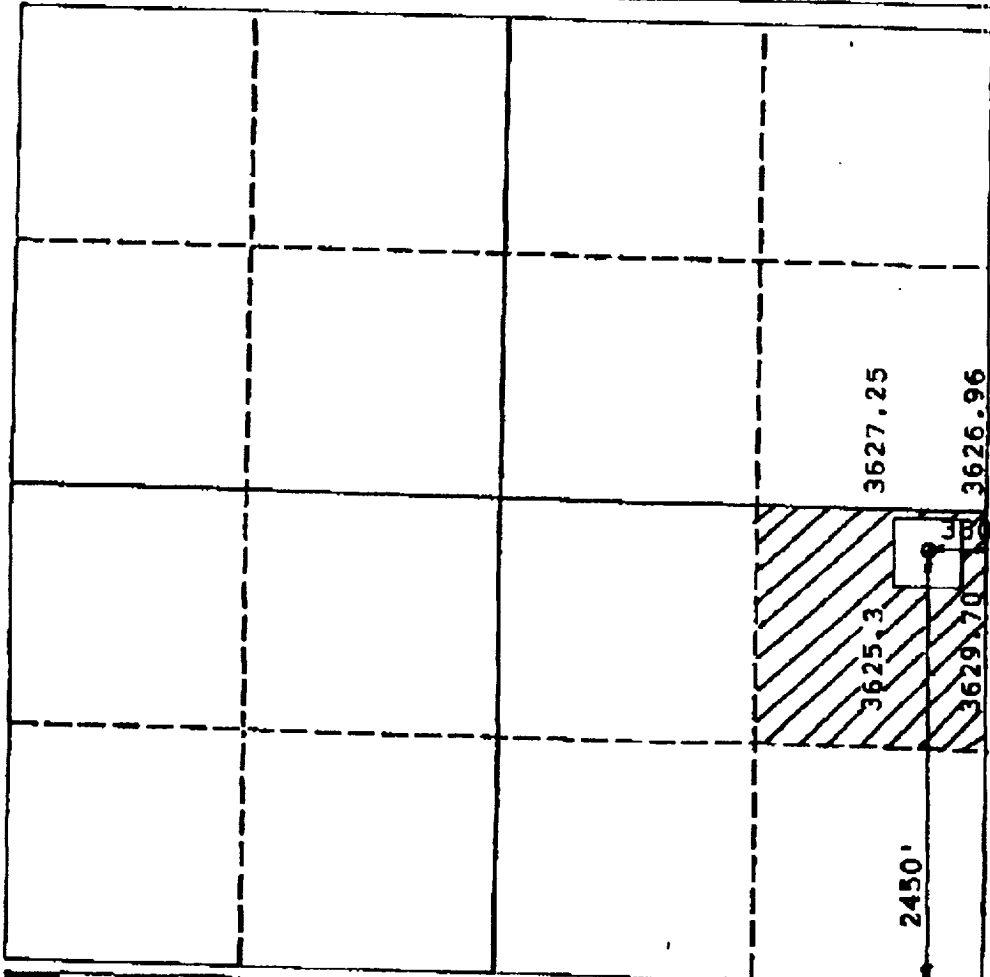

**OPERATOR CERTIFICATION**  
 I hereby certify that the information contained herein is true and complete to the best of my knowledge and belief.

Signature  
*E. L. Buttross Jr.*  
 Printed Name  
 E. L. Buttross, Jr.  
 Position  
 District Engineer  
 Company  
 Devon Energy Corp (Nevada)  
 Date  
 December 16, 1994

**SURVEYOR CERTIFICATION**  
 I hereby certify that the well location shown on this plat was plotted from field notes of actual surveys made by me or under my supervision, and that the same is true and correct to the best of my knowledge and belief.

Date Surveyed  
 September 23, 1994  
 Signature & Seal of Professional Surveyor  
  
 Certificate No.  
 8112

