

HUMBLE LEASE NO.

STATE LEASE NO. 06-5809

FEDERAL LEASE NO.

NEW MEXICO OIL CONSERVATION COMMISSION

Well Location and Acreage Dedication Plat

Form C-128

Revised 5/1/57

Date 8-27-62

Section A.

Operator Humble Oil & Refining Co. Lease New Mexico State "B.T."
 Well No. 1 Unit Letter I Section 15 Township 21 South Range 27 East NMPM
 Located 1980' Feet From South Line, 660' Feet From East Line
 County Eddy G. L. Elevation Later Dedicated Acreage 40 Acres
 Name of Producing Formation Devonian Pool Wildcat

1. Is the Operator the only owner* in the dedicated acreage outlined on the plat below?

Yes _____ No X2. If the answer to question one is "no", have the interests of all the owners been consolidated by communitization agreement or otherwise? Yes X No _____ If answer is "yes," Type of Consolidation Joint Operation

3. If the answer to question two is "no," list all the owners and their respective interests below:

OwnerLand Description

Section B

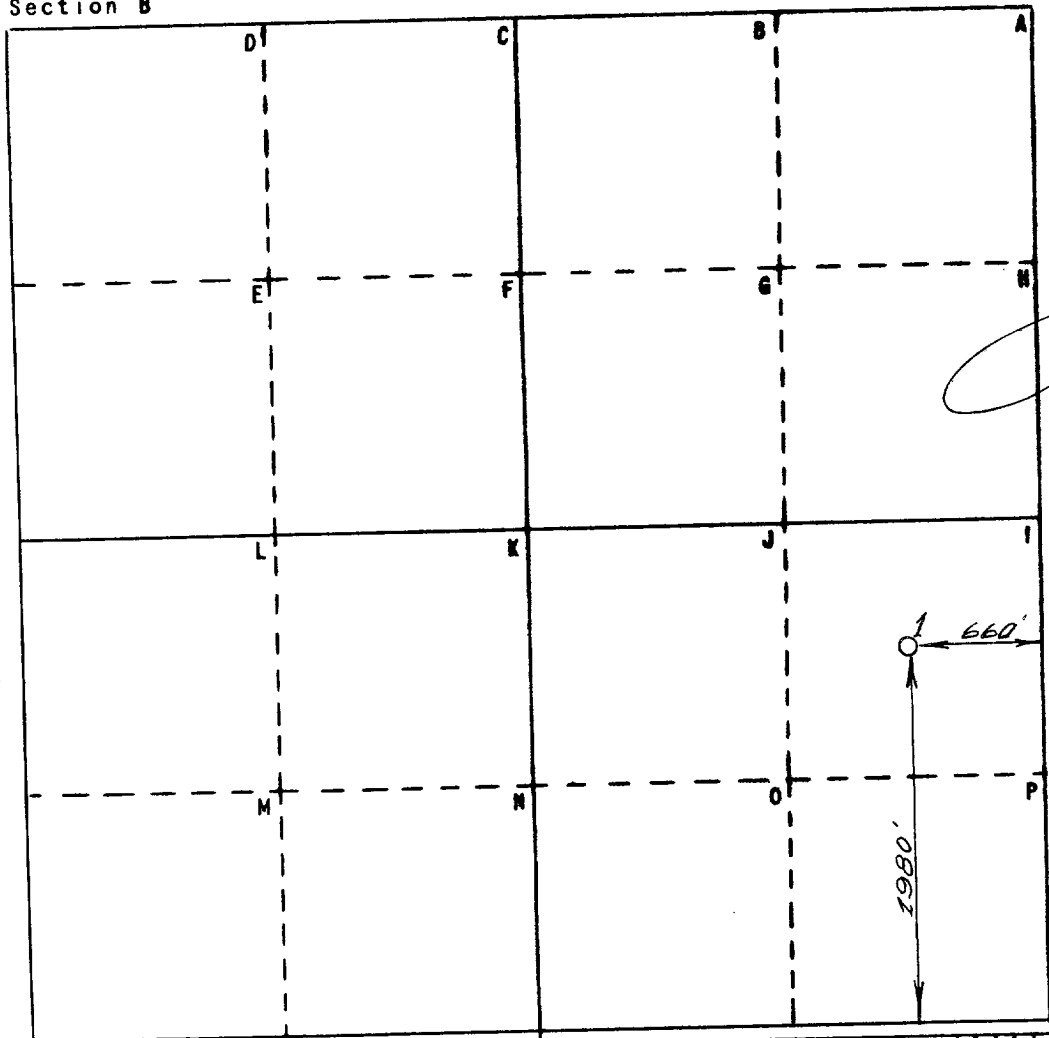

This is to certify that the information in Section A above is true and complete to the best of my knowledge and belief

HUMBLE OIL & REFG. CO.

(Operator)

(Representative)

Box 1600 Midland, Texas
Address

This is to certify that the well location shown on the plat in Section B was plotted from field notes of actual surveys made by me or under my supervision and that the same is true and correct to the best of my knowledge and belief.

Date Surveyed 7-27-62

W. S. Hunterfeld
 Registered Professional
 Engineer and/or Land Surveyor

Certificate No. 1382

0 330 660 990 1320 1650 1980 2310 2640 2000 1500 1000 500 0

FILE NO. WA 3596

OIL CONSERVATION COMMISSION	
ARIZONA DISTRICT OFFICE	
No. Copies Required	6
DATE RECEIVED	
OPERATOR	
SANTA FE	
EXPLORATION CO.	
STATE LAND OFFICE	
U. S. G. S.	
TRANSPORTER	
FILE	
BUREAU OF MINES	