

(SUBMIT IN TRIPLICATE)

UNITED STATES  
DEPARTMENT OF THE INTERIOR  
GEOLOGICAL SURVEY

Land Office New Mexico  
Lease No. 66299  
Unit 30-015-04728  
JUL 20 1956  
NEW MEXICO

SUNDRY NOTICES AND REPORTS ON WELLS

NOTICE OF INTENTION TO DRILL.....	<input checked="" type="checkbox"/>	SUBSEQUENT REPORT OF WATER SHUT-OFF.....	
NOTICE OF INTENTION TO CHANGE PLANS.....		SUBSEQUENT REPORT OF SHOOTING OR ACIDIZING.....	
NOTICE OF INTENTION TO TEST WATER SHUT-OFF.....		SUBSEQUENT REPORT OF ALTERING CASING.....	
NOTICE OF INTENTION TO RE-DRILL OR REPAIR WELL.....		SUBSEQUENT REPORT OF RE-DRILLING OR REPAIR.....	
NOTICE OF INTENTION TO SHOOT OR ACIDIZE.....		SUBSEQUENT REPORT OF ABANDONMENT.....	
NOTICE OF INTENTION TO PULL OR ALTER CASING.....		SUPPLEMENTARY WELL HISTORY.....	
NOTICE OF INTENTION TO ABANDON WELL.....			

(INDICATE ABOVE BY CHECK MARK NATURE OF REPORT, NOTICE, OR OTHER DATA)

Federal #1 Lease July 20, 19 56  
Well No. 1-33 is located 460 ft. from N line and 1960 ft. from E line of sec. 33  
Sec. 33 (1/4 Sec. and Sec. No.) 20-3 (Twp.) 30-3 (Range) R. 3. P. 3. (Meridian)  
San Bernardino (Field) 1447 (County or Subdivision) New Mexico (State or Territory)

The elevation of the derrick floor above sea level is \_\_\_\_\_ ft.

DETAILS OF WORK

(State names of and expected depths to objective sands; show sizes, weights, and lengths of proposed casings; indicate mudding jobs, cementing points, and all other important proposed work)

I propose to drill a 1700' Yates line test, using cable tools all the way.

6-5/8" surface casing will be run to the top of anhydrite at approximately 470' and cemented with 150 sacks.

7" oil string will be run to approximately 1650' and cemented in dolomite with 150 sacks.

All casing will be set under procedures approved by the U. S. Geological Survey.

I understand that this plan of work must receive approval in writing by the Geological Survey before operations may be commenced.

Company John H. Trigg  
Address P. O. Box 5629  
Roswell, New Mexico  
By John H. Trigg  
Title Owner

NEW MEXICO  
OIL CONSERVATION COMMISSION

Form C-128

Well Location and/or Gas Proration Plat

Date 7-17-56

Operator JOHN H. TRIGG

Lease FEDERAL "M"

Well No. 1-33 Section 33 Township 20 Range 30 NMPM

Located 1980 Feet From EAST Line, 660 Feet From NORTH Line,

EDDY

County, New Mexico. G. L. Elevation \_\_\_\_\_

Name of Producing Formation \_\_\_\_\_ Pool \_\_\_\_\_ Dedicated Acreage \_\_\_\_\_

(Note: All distances must be from outer boundaries of Section)

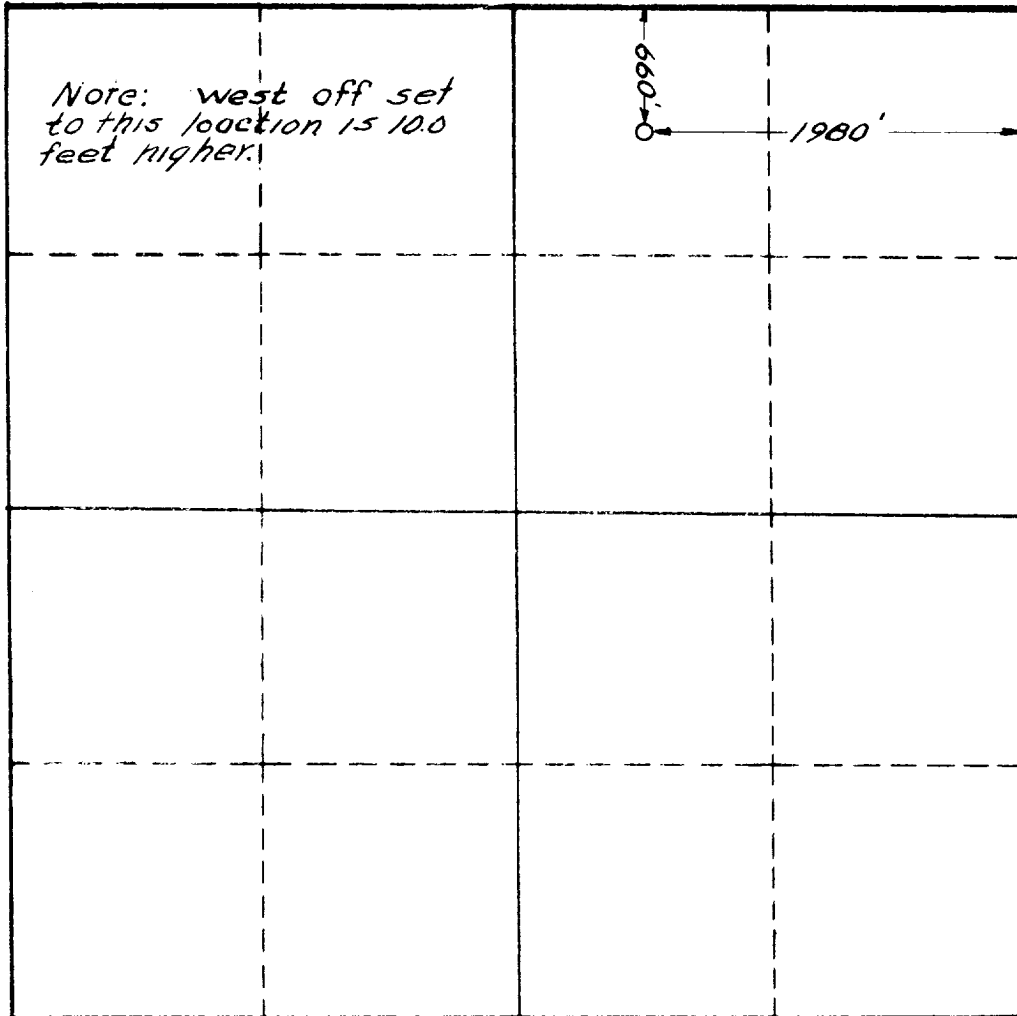

SCALE: 1"=1000'

1. Is this Well a Dual Comp. ? Yes \_\_\_ No \_\_\_.
2. If the answer to Question 1 is yes, are there any other dually completed wells within the dedicated acreage ? Yes \_\_\_ No \_\_\_.

This is to certify that the above plat was prepared from field notes of actual surveys made by me or under my supervision and that the same are true and correct to the best of my knowledge and belief.

Name \_\_\_\_\_  
Position \_\_\_\_\_  
Representing \_\_\_\_\_  
Address \_\_\_\_\_

Date Surveyed 7-17-56  
John W. West  
Registered Professional Engineer and/or  
Land Surveyor