

**NEW MEXICO OIL CONSERVATION COMMISSION
WELL LOCATION AND ACREAGE DEDICATION PLAT**

Form O-102
Supersedes O-124
Effective 1-1-65

All distances must be from the outer boundaries of the Section

GULF OIL CORP.			Lease SPRINGS UNIT		Section 1
Range G	Section 34	Township 20 SOUTH	Range 26 EAST	County EDDY	
Section 34 1980 feet from the NORTH line and 1980 feet from the EAST line Producing Formation Permian Depth 14,100 Depth to Base 300					

1. Outline the acreage dedicated to the subject well by colored pencil or hatchure marks on the plat below.
2. If more than one lease is dedicated to the well, outline each and identify the ownership thereof (both as to working interest and royalty).
3. If more than one lease of different ownership is dedicated to the well, have the interests of **RECEIVED** consolidated by communitization, unitization, force-pooling, etc?

II

☒ Yes ☐ No If answer is "yes," type of consolidation

Unitization

OCT 21 1966

If answer is "no," list the owners and tract descriptions which have actually been consolidated (the reverse side of this form if necessary.)

**O.C.C. side of
ARTESIA, OFFICE**

No allowable will be assigned to the well until all interests have been consolidated (by communitization, unitization, forced-pooling, or otherwise) or until a non-standard unit, eliminating such interests, has been approved by the Commission.

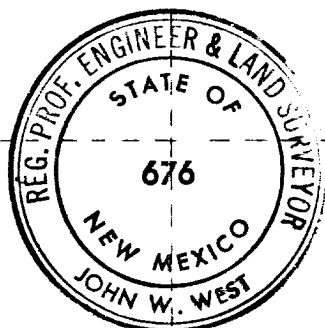
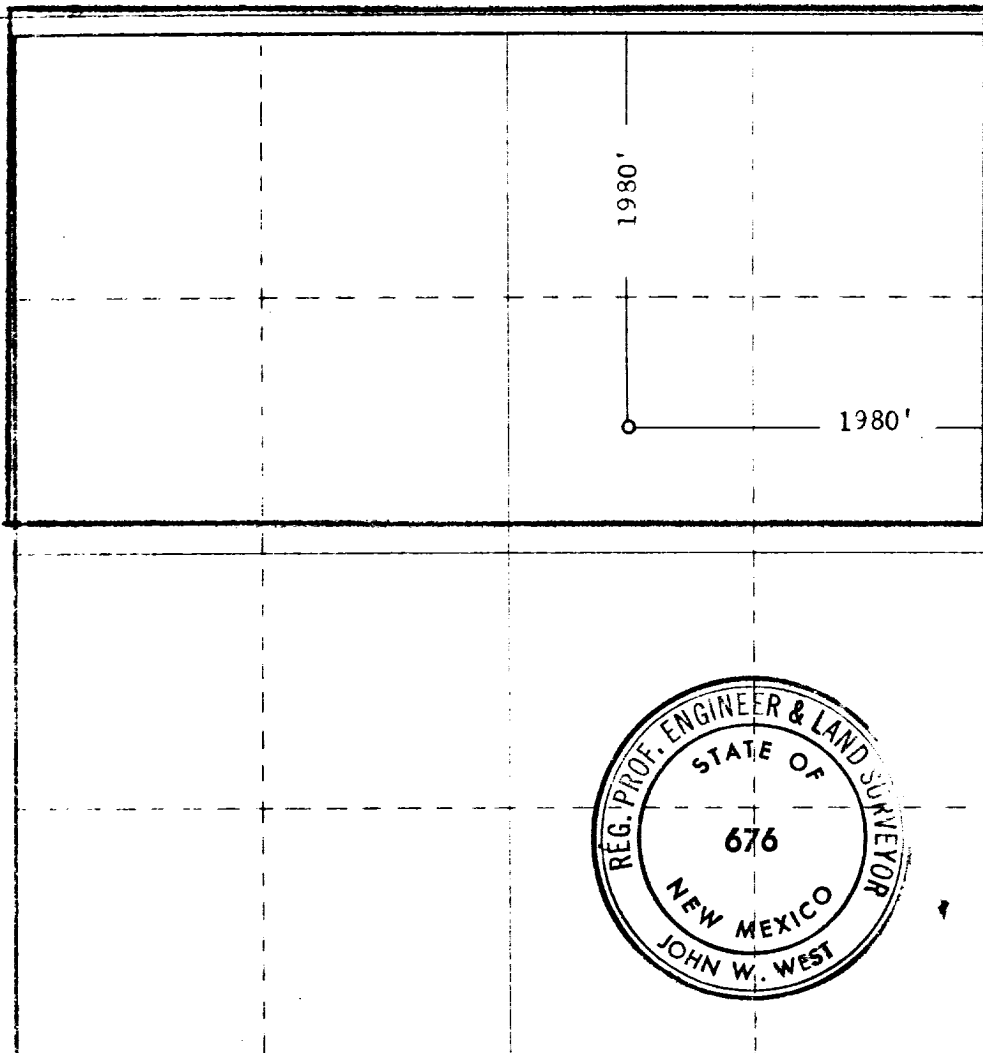

CERTIFICATION

I hereby certify that the information contained herein is true and complete to the best of my knowledge and belief.

By **L. A. TURNER**
Area Production Engineer
Gulf Oil Corporation
October 19, 1966

I hereby certify that the well location shown on this plat was plotted from field notes of actual surveys made by me or under my supervision, and that the same is true and correct to the best of my knowledge and belief.

Date prepared
OCT. 14, 1966
Registered Professional Engineer
and Land Surveyor
John W. West
676