

P. O. BOX 2088

SANTA FE, NEW MEXICO 87501

NO. OF COPIES RECEIVED	
DISTRIBUTION	
SANTA FE	<input checked="" type="checkbox"/>
FILE	<input checked="" type="checkbox"/>
U.S.G.S.	<input checked="" type="checkbox"/>
LAND OFFICE	<input checked="" type="checkbox"/>
OPERATOR	<input checked="" type="checkbox"/>

RECEIVED BY

AUG 24 1983

O. C. D.

ARTESIA OFFICE

5A. Indicate Type of Lease

STATE ☒ FEE ☐

6. State Oil & Gas Lease No.

K-6854

7. Unit Agreement Name

8. Farm or Lease Name

Stonewall "WM" St

9. Well No.

5

10. Field and Pool, or Wildcat

Undes. Delaware

12. County

Eddy

APPLICATION FOR PERMIT TO DRILL, DEEPEN, OR PLUG BACK

a. Type of Work

DRILL ☒DEEPEN ☐

b. Type of Well

OIL WELL ☒GAS WELL ☐OTHER ☐SINGLE ZONE ☐MULTIPLE ZONE ☐

c. Name of Operator

Yates Petroleum Corporation ✓

d. Address of Operator

207 S. 4th, Artesia, New Mexico 88210

e. Location of Well

UNIT LETTER K LOCATED 1980 FEET FROM THE South LINE

ND 1980 FEET FROM THE West LINE OF SEC. 30 TWP. 20S RGE. 28E NMPM

19. Proposed Depth

appr. 4900'

19A. Formation

Delaware

20. Rotary or C.T.

Rotary

f. Elevations (Show whether DF, KI, etc.)

3284' GL

21A. Kind & Status Plug. Bond

Blanket

21B. Drilling Contractor

LaRue Drilling

22. Approx. Date Work will start

ASAP

PROPOSED CASING AND CEMENT PROGRAM

SIZE OF HOLE	SIZE OF CASING	WEIGHT PER FOOT	SETTING DEPTH	SACKS OF CEMENT	EST. TOP
17 1/2"	13 3/8"	48#	550'	550 sx	circ
12 1/4"	8 5/8"	24-28#	2400'	1500 sx	circ
7 7/8"	5 1/2"	17-20#	TD	650 sx	tie to 8 5/8

Propose to test the Delaware and intermediate formations with surface casing being set at approximately 550' and the intermediate casing at approximately 2400' (100' below the Capitan Reef). If commercial pay is encountered, 5 1/2" casing will be run and the well stimulated as needed.

MUD PROGRAM: FW gel/LCM to TD.

BOP PROGRAM: BOP's will be installed on the intermediate casing & tested.

APPROVAL VALID FOR 180 DAYS
PERMIT EXPIRES 2-26-84
UNLESS DRILLING UNDERWAY

ABOVE SPACE DESCRIBE PROPOSED PROGRAM: IF PROPOSAL IS TO DEEPEN OR PLUG BACK, GIVE DATA ON PRESENT PRODUCTIVE ZONE AND PROPOSED NEW PRODUCTIVE ZONE. GIVE BLOWOUT PREVENTER PROGRAM, IF ANY.

I hereby certify that the information above is true and complete to the best of my knowledge and belief.

Signed Shirley Rodriguez Title Regulatory Agent Date 8/24/83
(This space for State Use)

PROVED BY Mike Williams TITLE OIL AND GAS INSPECTOR DATE AUG 26 1983
CONDITIONS OF APPROVAL, IF ANY:

Notify NMLCC in sufficient
time to witness cementing
the 8 5/8 casing

Posted at 9
RD-1 with Book
8-26-83

NEW MEXICO OIL CONSERVATION COMMISSION
WELL LOCATION AND ACREAGE DEDICATION PLAT

Form C-102
Supersedes C-128
Effective 1-1-65

All distances must be from the outer boundaries of the Section.

Operator YATES PETROLEUM CORPORATION			Lease Stonewall WM State		Well No. 5
Unit Letter K	Section 30	Township 20 South	Range 28 East	County Eddy	
Actual Footage Location of Well: 1650 feet from the South line and 1980 feet from the West line					
Ground Level Elev: 3284	Producing Formation Delaware	Pool <i>Burton Flat</i> Undes. Delaware		Dedicated Acreage: 40 Acres	

1. Outline the acreage dedicated to the subject well by colored pencil or hachure marks on the plat below.
2. If more than one lease is dedicated to the well, outline each and identify the ownership thereof (both as to working interest and royalty).
3. If more than one lease of different ownership is dedicated to the well, have the interests of all owners been consolidated by communitization, unitization, force-pooling, etc?

☐ Yes ☐ No If answer is "yes," type of consolidation _____

If answer is "no," list the owners and tract descriptions which have actually been consolidated. (Use reverse side of this form if necessary.) _____

No allowable will be assigned to the well until all interests have been consolidated (by communitization, unitization, forced-pooling, or otherwise) or until a non-standard unit, eliminating such interests, has been approved by the Commission.

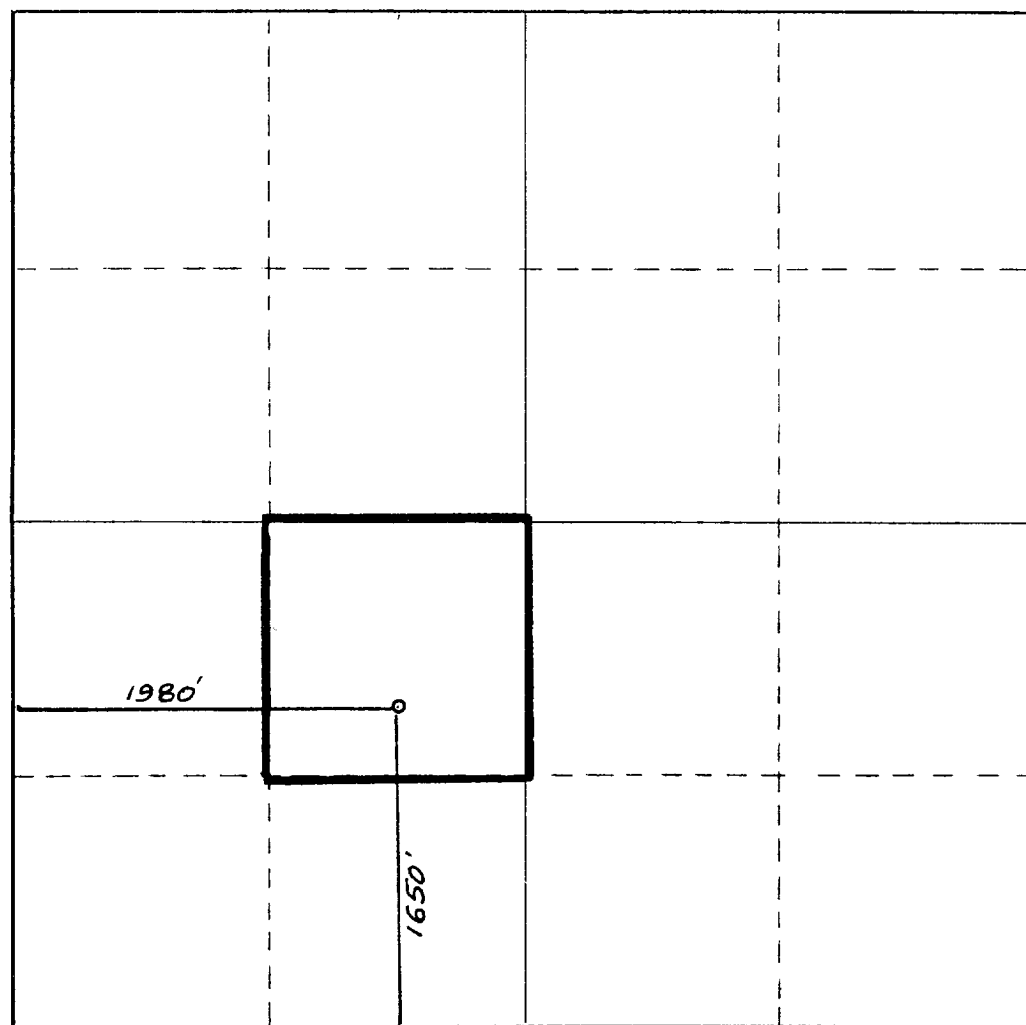

CERTIFICATION

I hereby certify that the information contained herein is true and complete to the best of my knowledge and belief.

Gliserio Rodriguez
Name

GLISERIO RODRIGUEZ

Position

AGENT

Company

YATES PETROLEUM CORP.

Date

8-16-83

DAN R. REDDY
NEW MEXICO
I hereby certify that the well location shows on this plat was plotted from field notes of actual surveys made by me or under my supervision, and that the same is true and correct to the best of my knowledge and belief.
LAND SURVEYOR
PROFESSIONAL ENGINEER

Date Surveyed

August 10, 1983

Registered Professional Engineer and/or Land Surveyor

Dan R. Reddy

Certificate No.

NM PE&LS #5412

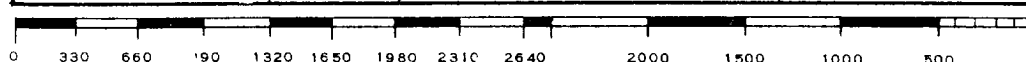

EXHIBIT B

BDP DIAGRAM

