

SUNDRY NOTICES AND REPORTS ON WELLS

(Do not use this form for proposals to drill or to deepen or to connect different reservoirs. Use "APPLICATION FOR PERMIT" for such proposals.)

RECEIVED
JUN 01 1984
O. C. D.
ARTESIA, OFFICE

1. OIL WELL GAS WELL OTHER

2. NAME OF OPERATOR
Liberty Oil & Gas Corporation

3. ADDRESS OF OPERATOR
1776 Woodstead Court, Suite 200, The Woodlands, Texas 77380

4. LOCATION OF WELL (Report location clearly and in accordance with any State requirements. See also space 17 below.)
At surface 2100' FSL & 330' FWL Unit Letter L

14. PERMIT NO. _____ 15. ELEVATIONS (Show whether DF, RT, GR, etc.) _____

5. LEASE DESIGNATION AND SERIAL NO. NM-17103

6. IF INDIAN, ALLOTTEE OR TRIBE NAME _____

7. UNIT AGREEMENT NAME _____

8. FARM OR LEASE NAME Lee Federal

9. WELL NO. 4-Y

10. FIELD AND POOL, OR WILDCAT Wildcat-Bone Springs

11. SEC., T., R., M., OR BLK. AND SURVEY OR AREA Sec. 25, T20S, R28E

12. COUNTY OR PARISH Eddy 13. STATE N.M.

1187

16. Check Appropriate Box To Indicate Nature of Notice, Report, or Other Data

NOTICE OF INTENTION TO:

TEST WATER SHUT-OFF

FRACURE TREAT

SHOOT OR ACIDIZE

REPAIR WELL

(Other) X Move drill location

PULL OR ALTER CASING

MULTIPLE COMPLETE

ABANDON*

CHANGE PLANS

SUBSEQUENT REPORT OF:

WATER SHUT-OFF

FRACURE TREATMENT

SHOOTING OR ACIDIZING

(Other) _____

REPAIRING WELL

ALTERING CASING

ABANDONMENT*

(NOTE: Report results of multiple completion on Well Completion or Recompletion Report and Log form.)

17. DESCRIBE PROPOSED OR COMPLETED OPERATIONS (Clearly state all pertinent details, and give pertinent dates, including estimated date of starting any proposed work. If well is directionally drilled, give subsurface locations and measured and true vertical depths for all markers and zones pertinent to this work.)*

Request permission to move drill location from 2100' FSL & 660' FWL to 2100' FSL & 330' FWL, Sec. 25, T20S, R28E, due to caving in of hole on the Lee Federal No. 4 drilling location. The new location will be named the Lee Federal No. 4-Y.

Refer to original permit to drill (Lee Federal No. 4), for APD information and also to the Surface Use and Operation Plans.

Amended C-102 plat is attached.

Diagram of well pad is also attached.

PD 5700'

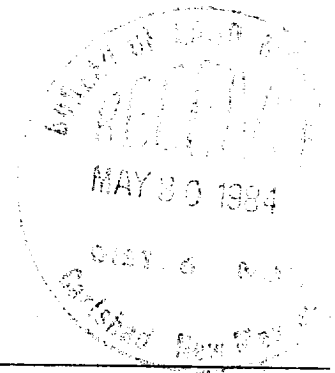

18. I hereby certify that the foregoing is true and correct

SIGNED Terry W. Franklin TITLE Agent DATE 5/30/84

(This space for Federal or State office use)

APPROVED BY R. B. Ritschke TITLE P.E. DATE 5/30/84

CONDITIONS OF APPROVAL, IF ANY:

Post. & Log
PD-1216 B R
6-8-84

*See Instructions on Reverse Side

All distances must be from the outer boundaries of the Section.

Operator Liberty Oil & Gas		Lease Lee Federal		Well No. 4-Y
Unit Letter	Section 25	Township 20- South	Range 28- East	County Eddy

Actual Footage Location of Well:
2100 feet from the **South** line and **330** feet from the **West** line

Ground Level Elev. 3269'	Producing Formation BONE SPRING	Pool WILDCAT	Dedicated Acreage: 40 Acres
------------------------------------	---	------------------------	---------------------------------------

1. Outline the acreage dedicated to the subject well by colored pencil or hachure marks on the plat below.
2. If more than one lease is dedicated to the well, outline each and identify the ownership thereof (both as to working interest and royalty).
3. If more than one lease of different ownership is dedicated to the well, have the interests of all owners been consolidated by communitization, unitization, force-pooling, etc?

Yes No If answer is "yes," type of consolidation _____

If answer is "no," list the owners and tract descriptions which have actually been consolidated. (Use reverse side of this form if necessary.) _____

No allowable will be assigned to the well until all interests have been consolidated (by communitization, unitization, forced-pooling, or otherwise) or until a non-standard unit, eliminating such interests, has been approved by the Division.

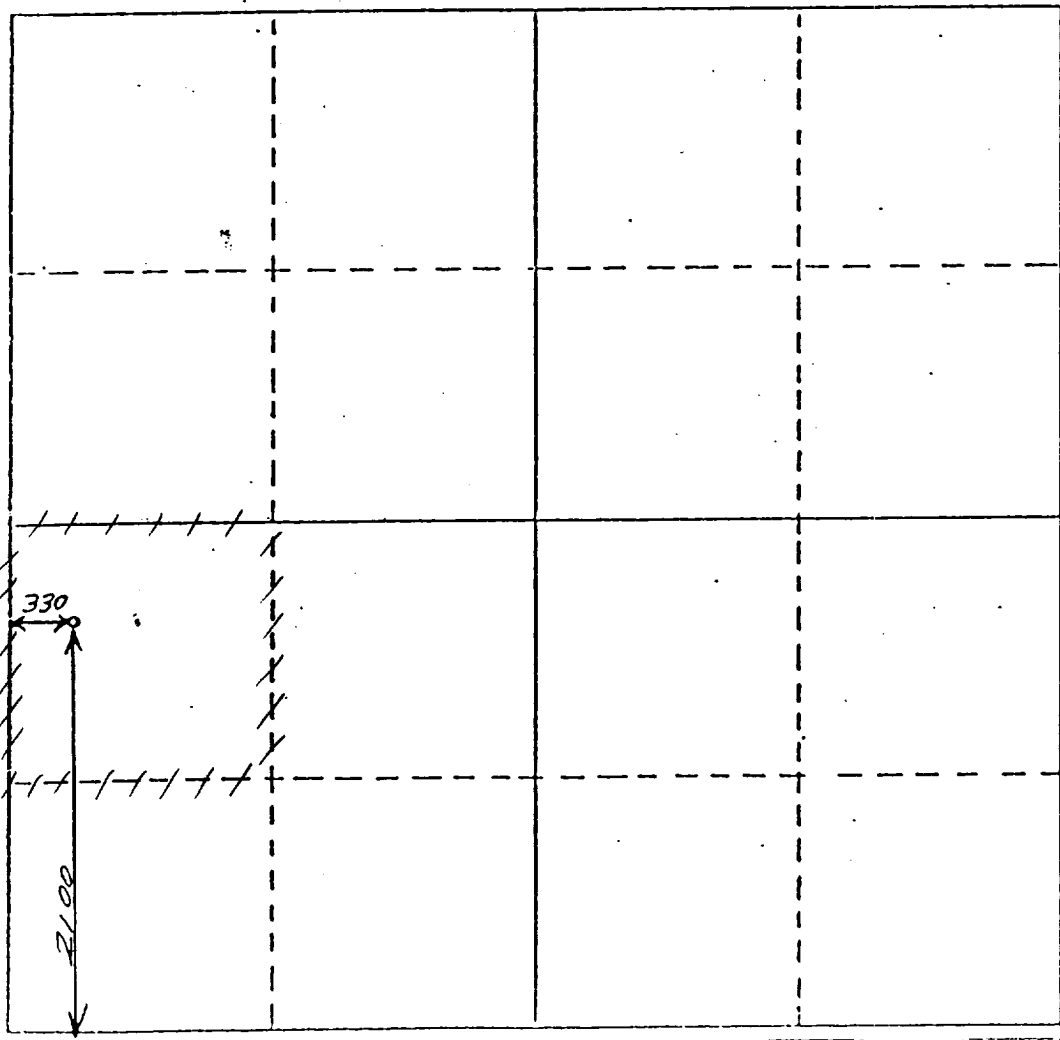

CERTIFICATION

I hereby certify that the information contained herein is true and complete to the best of my knowledge and belief.

Name **Jerry W. Franklin**
 Position **AGENT**
 Company **LIBERTY OIL & GAS**
 Date **5/30/84**

I hereby certify that the well location shown on this plat was plotted from field notes of actual surveys made by me or under my supervision, and that the same is true and correct to the best of my knowledge and belief.

5/29/84
 Date Surveyed
P. R. Patton
 Registered Professional Surveyor
 and/or Land Surveyor
8112
 Certificate No.

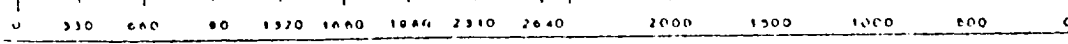

S

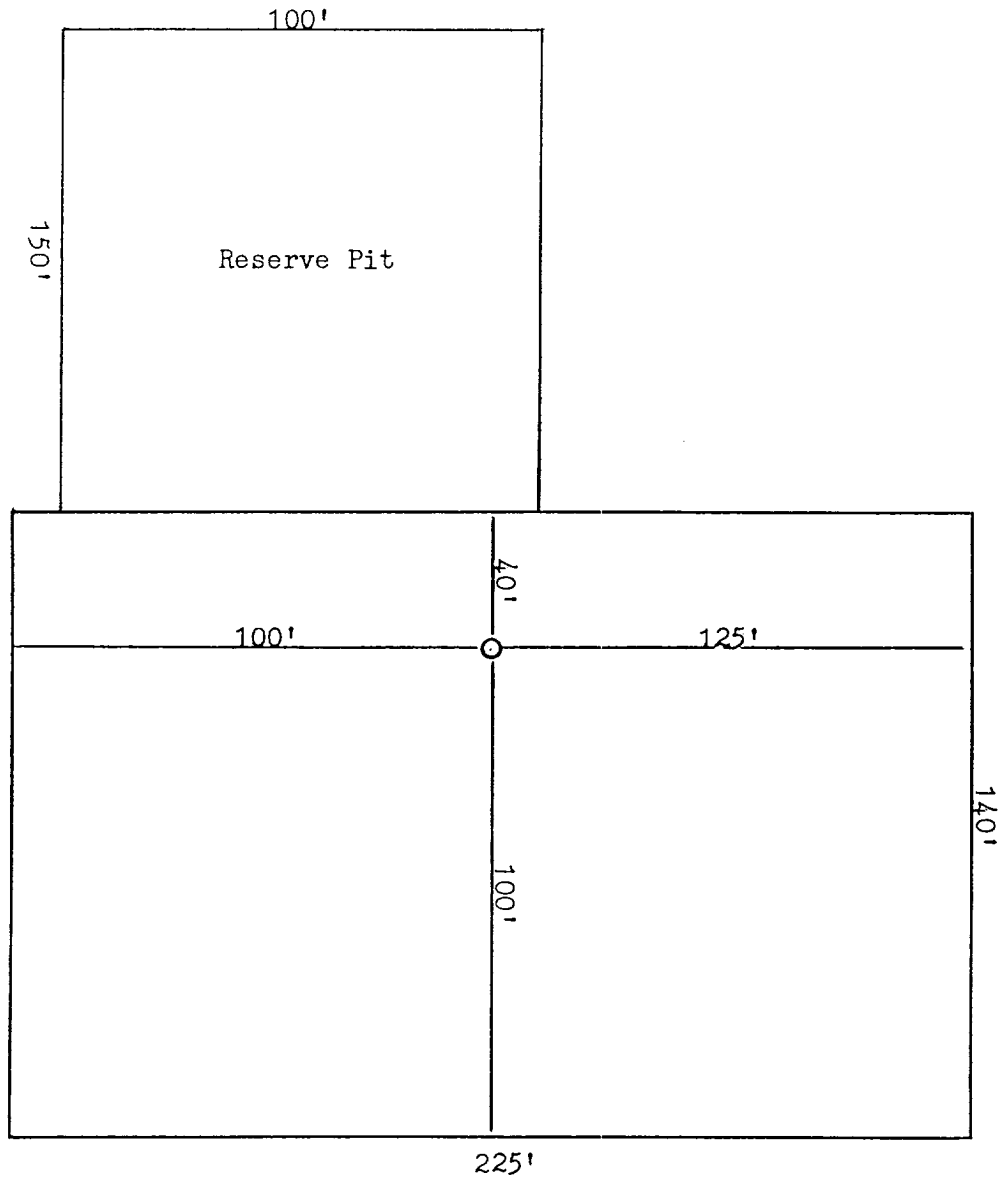

N