

UNITED STATES
DEPARTMENT OF THE INTERIOR
BUREAU OF LAND MANAGEMENT

FORM APPROVED
Budget Bureau No. 1004-0135
Expires July 31, 1996

SUNDRY NOTICES AND REPORTS ON WELLS

Do not use this form for proposals to drill or to re-enter an abandoned well. Use Form 3160-3 (APD) for such proposals.

SUBMIT IN TRIPLICATE - Other instructions on reverse side

1. Type of Well
☒ Oil Well ☐ Gas Well ☐ Other

2. Name of Operator
Santa Fe Energy Resources, Inc.

3a. Address
550 W. Texas, Suite 1330, Midland, TX 79701

3b. Phone No. (include area code)
915-686-6612

4. Location of Well (Footage, Sec., T., R., M., or Survey Description)
(H), 1980' FNL and 660' FEL, Sec. 14, T-21S, R-23E

Proposed BHL: (E), 1980' FNL and 660' FWL, Sec. 14, T-21S, R23E

5. Lease Serial No.

NM-76919

6. If Indian, Allottee or Tribe Name

7. If Unit or CA/Agreement, Name and/or No.

8. Well Name and No.
Roaring Springs
"14" Fed Com #5

9. API Well No.
30-015-28302

10. Field and Pool, or Exploratory Area
Dagger Draw, South
(Upper Penn)

11. County or Parish, State
Eddy NM

12. CHECK APPROPRIATE BOX(ES) TO INDICATE NATURE OF NOTICE, REPORT, OR OTHER DATA

| TYPE OF SUBMISSION | TYPE OF ACTION | | | |
|--|---|---|--|---|
| <input checked="" type="checkbox"/> Notice of Intent | <input type="checkbox"/> Acidize | <input type="checkbox"/> Deepen | <input type="checkbox"/> Production (Start/Resume) | <input type="checkbox"/> Water Shut-Off |
| <input type="checkbox"/> Subsequent Report | <input type="checkbox"/> Alter Casing | <input type="checkbox"/> Fracture Treat | <input type="checkbox"/> Reclamation | <input type="checkbox"/> Well Integrity |
| <input type="checkbox"/> Final Abandonment Notice | <input type="checkbox"/> Casing Repair | <input type="checkbox"/> New Construction | <input type="checkbox"/> Recomplete | <input checked="" type="checkbox"/> Other |
| | <input type="checkbox"/> Change Plans | <input type="checkbox"/> Plug and Abandon | <input type="checkbox"/> Temporarily Abandon | Drill horizontal |
| | <input type="checkbox"/> Convert to Injection | <input type="checkbox"/> Plug Back | <input type="checkbox"/> Water Disposal | lateral |

13. Describe Proposed or Completed Operation (clearly state all pertinent details, including estimated starting date of any proposed work and approximate duration thereof. If the proposal is to deepen directionally or recompleat horizontally, give subsurface locations and measured and true vertical depths of all pertinent markers and zones. Attach the Bond under which the work will be performed or provide the Bond No. on file with BLM/BIA. Required subsequent reports shall be filed within 30 days following completion of the involved operations. If the operation results in a multiple completion or recompleat in a new interval, a Form 3160-4 shall be filed once testing has been completed. Final Abandonment Notices shall be filed only after all requirements, including reclamation, have been completed, and the operator has determined that the final site is ready for final inspection.)

Santa Fe Energy Resources, Inc. respectfully requests permission to drill one horizontal lateral from the existing well bore. The lateral will be drilled into the existing producing Cisco-Canyon interval as per the attached directional plan.

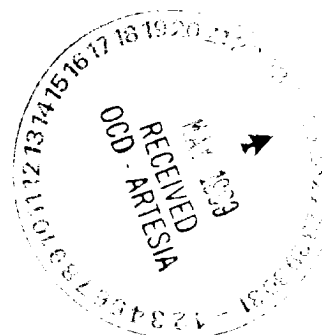

14. I hereby certify that the foregoing is true and correct
Name (Printed/Typed)

Terry McCullough

Title

Sr. Production Clerk

Date

May 14, 1999

THIS SPACE FOR FEDERAL OR STATE OFFICE USE

Approved by

Title

Date

Conditions of approval, if any, are attached. Approval of this notice does not warrant or certify that the applicant holds legal or equitable title to those rights in the subject lease which would entitle the applicant to conduct operations thereon.

Office

Title 18 U.S.C. Section 1001, makes it a crime for any person knowingly and willfully to make to any department or agency of the United States any false, fictitious or fraudulent statements or representations as to any matter within its jurisdiction.

DISTRICT I
P. O. Box 1980
Hobbs, NM 88241-1980

State of New Mexico
Energy, Minerals, and Natural Resources Department

Form C-1C
Revised 02-10-9

Instructions on back

DISTRICT II
P. O. Drower DD
Artesia, NM 88211-0719

OIL CONSERVATION DIVISION

P. O. Box 2088
Santa Fe, New Mexico 87504-2088

Submit to the Appropriate
District Office
State Lease - 4 copies
Fee Lease - 3 copies

DISTRICT III
1000 Rio Brazos Rd.
Aztec, NM 87410

☒ AMENDED REPORT

DISTRICT IV
P. O. Box 2088
Santa Fe, NM 87507-2088

WELL LOCATION AND ACREAGE DEDICATION PLAT

| | | |
|------------------------------|--|--|
| 1 API Number 30-015-28302 | 2 Pool Code 15475 | 3 Pool Name Dagger Draw, So. (Upper Penn) |
| 4 Property Code H | 5 Property Name ROARING SPRINGS '14' FED. COM. | 6 Well Number 5 |
| 7 OGRID No. | 8 Operator Name SANTA FE ENERGY RESOURCES, INC. | 9 Elevation 3814' |

10 SURFACE LOCATION

| | | | | | | | | | |
|--------------------|---------------|----------------------|----------------------------|---------|------------------------|---------------------------|-----------------------|------------------------|----------------|
| UL or lot no. H | Section 14 | Township 21 SOUTH | Range 23 EAST, N.M.P.M. | Lot Ida | Feet from the 1980' | North/South line NORTH | Feet from the 660' | East/West line EAST | County EDDY |
|--------------------|---------------|----------------------|----------------------------|---------|------------------------|---------------------------|-----------------------|------------------------|----------------|

"BOTTOM HOLE LOCATION IF DIFFERENT FROM SURFACE

| | | | | | | | | | |
|--------------------|---------------|----------------------|----------------------------|---------|------------------------|---------------------------|-----------------------|------------------------|----------------|
| UL or lot no. E | Section 14 | Township 21 South | Range 23 EAST, N.M.P.M. | Lot Ida | Feet from the 1980' | North/South line North | Feet from the 660' | East/West line West | County EDDY |
|--------------------|---------------|----------------------|----------------------------|---------|------------------------|---------------------------|-----------------------|------------------------|----------------|

| | | | |
|---------------------------|--------------------|-----------------------|--------------|
| 12 Dedicated Acres 320 | 13 Joint or Infill | 14 Consolidation Code | 15 Order No. |
|---------------------------|--------------------|-----------------------|--------------|

NO ALLOWABLE WELL BE ASSIGNED TO THIS COMPLETION UNTIL ALL INTERESTS HAVE BEEN CONSOLIDATED OR A NON-STANDARD UNIT HAS BEEN APPROVED BY THE DIVISION

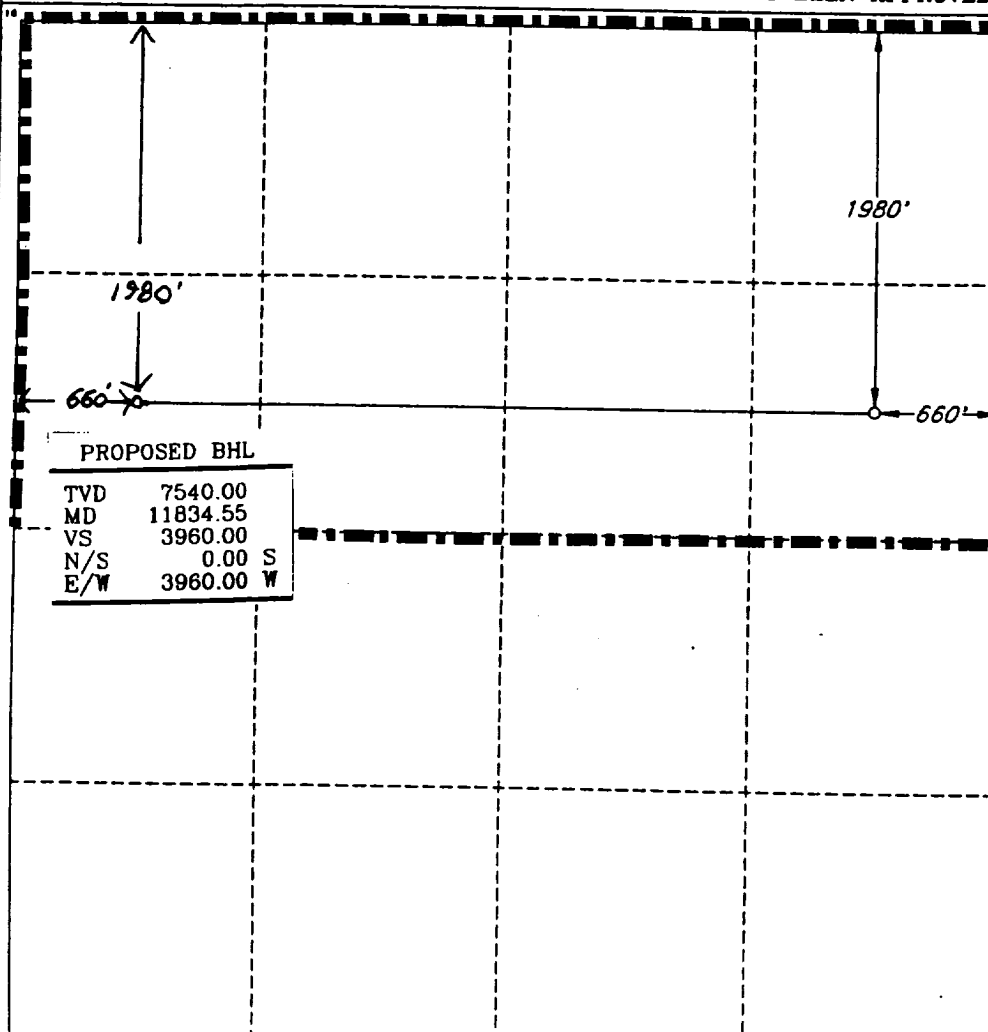

OPERATOR CERTIFICATION

I hereby certify that the information contained herein is true and complete to the best of my knowledge and belief.

Signature
Michael R. Burton
Printed Name
MICHAEL R. BURTON
Title
DIVISION MANAGER-Drilling
Date
5/14/1999

SURVEYOR CERTIFICATION

I hereby certify that the well location shown on this plat was plotted from field notes of actual surveys made by me or under my supervision, and that the same is true and correct to the best of my belief.

Date of Survey
OCTOBER 24, 1994

Signature and Seal of Professional Surveyor
V. L. Beznier
V. L. BEZNIER
NO. 7920
Certification No.
V. L. BEZNIER AND R.P.S. #7920

SANTA FE ENERGY RESOURCES, INC.
 ROARING SPRINGS #14-5
 SECTION 14, T-21-E, R-23-E
 EDDY COUNTY, NEW MEXICO
 PRELIMINARY WELLPLAN

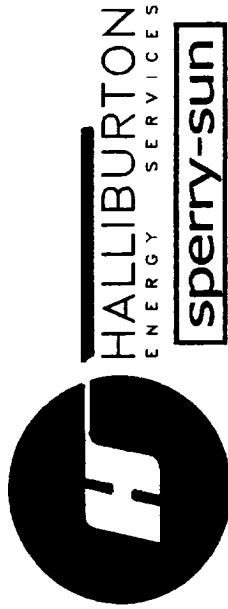

| PROPOSED BHL | |
|--------------|-----------|
| TVD | 7540.00 |
| MD | 11834.55 |
| VS | 3960.00 |
| N/S | 0.00 S |
| E/W | 3960.00 W |

HORIZONTAL VIEW
 SCALE 500 ft. / DIVISION
 SURVEY REF: WELLHEAD

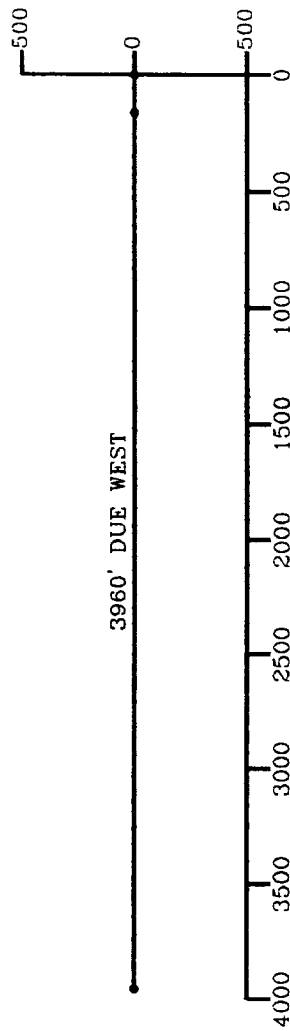

VERTICAL VIEW
 SCALE 500 ft. / DIVISION
 TVD REF: KB
 VERTICAL SECTION REF: WELLHEAD

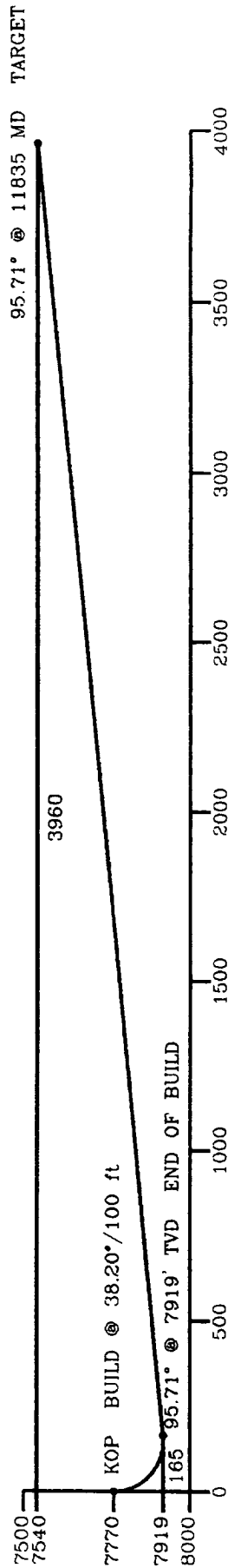

VERTICAL SECTION PLANE: 270.00°

