

District I
PO Box 1980, Hobbs, NM 88241-1980

District II
PO Drawer DD, Artesia, NM 88211-0719

District III
1000 Rio Brason Rd., Aztec, NM 87410

District IV
PO Box 2088, Santa Fe, NM 87504-2088

State of New Mexico
Energy, Minerals & Natural Resources Department

OIL CONSERVATION DIVISION
PO Box 2088
Santa Fe, NM 87504-2088

Form C-102
Revised February 10, 1994
Submit to Appropriate District Office
State Lease - 4 Copies
Fee Lease - 3 Copies

☐ AMENDED REPORT

WELL LOCATION AND ACREAGE DEDICATION PLAT

API Number	Pool Code 03715	Pool Name AVALON DELAWARE 3715
Property Code	Property Name AVALON (DELAWARE) UNIT	Well Number 1612
OGRID No. 007673	Operator Name Exxon Corp.	Elevation 3291'

Surface Location

UL or lot no. N	Section 30	Township 20S	Range 28E	Lot Idn	Feet from the 1152'	North/South line SOUTH	Feet from the 1489'	East/West line WEST	County EDDY
--------------------	---------------	-----------------	--------------	---------	------------------------	---------------------------	------------------------	------------------------	----------------

Bottom Hole Location If Different From Surface

UL or lot no.	Section	Township	Range	Lot Idn	Feet from the	North/South line	Feet from the	East/West line	County
Dedicated Acres 40	Joint or Infill	Consolidation Code	Order No.						

NO ALLOWABLE WILL BE ASSIGNED TO THIS COMPLETION UNTIL ALL INTERESTS HAVE BEEN CONSOLIDATED
OR A NON-STANDARD UNIT HAS BEEN APPROVED BY THE DIVISION

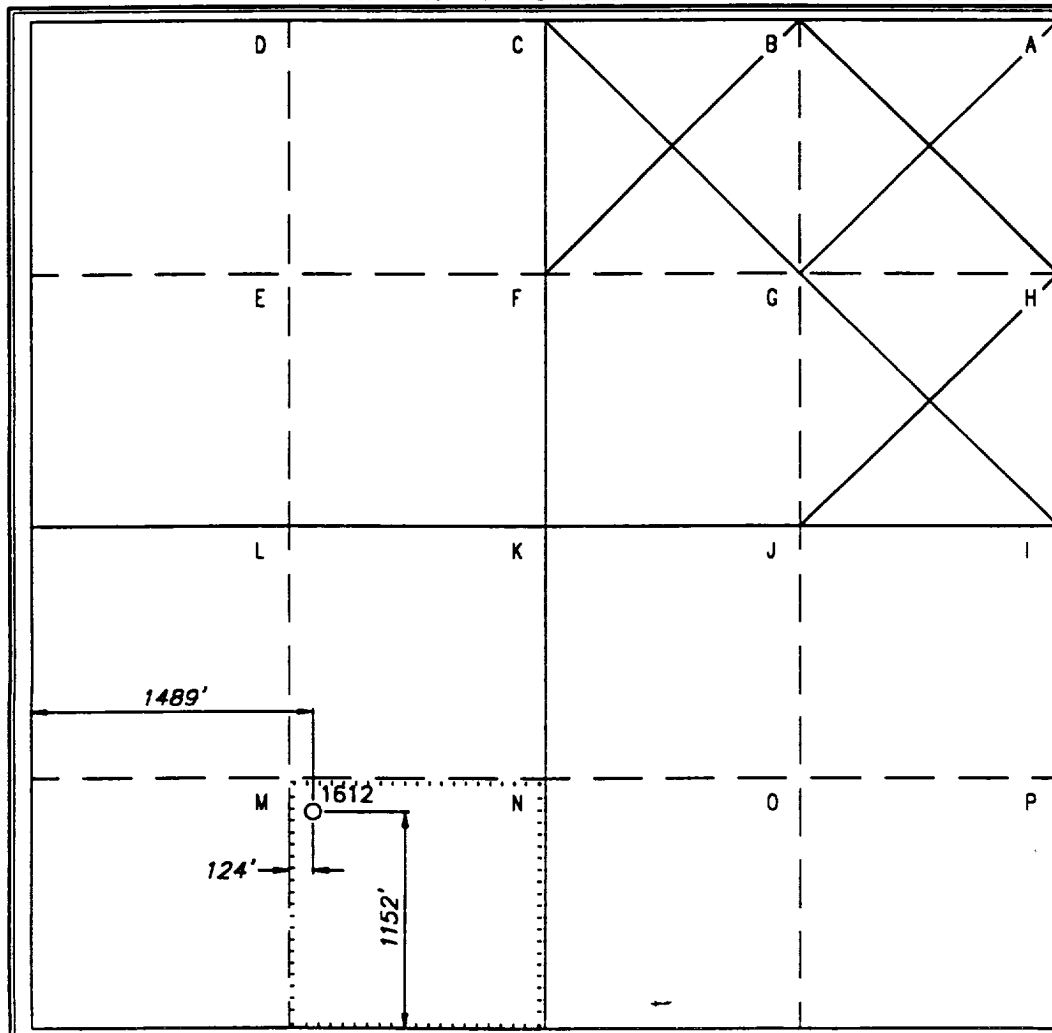

OPERATOR CERTIFICATION

I hereby certify that the information
contained herein is true and complete to the
best of my knowledge and belief.

C.H. Harper
Signature
C.H. Harper

Printed Name
Permits Supervisor

Title
Date

SURVEYOR CERTIFICATION

I hereby certify that the well location shown on this plat
was plotted from field notes of actual surveys made by
me or under my supervision, and that the same is true
and correct to the best of my belief.

8/10/95
Date of Survey

Signature and Seal of Professional Surveyor

REGISTERED SURVEYOR
STATE OF NEW MEXICO
NO. 5109
J. N. NEWTON
5109
Certificate Number

Distance to nearest Town 7.2 Miles N of CARLSBAD, New Mexico	Drawn By SRP	Date 8/15/95	Drawing File Name File No.: A10978d
---	-----------------	-----------------	--