

NO. OF COPIES RECEIVED	
DISTRIBUTION	
SANTA FE	
FILE	
U.S.G.S.	
LAND OFFICE	
OPERATOR	

NEW MEXICO OIL CONSERVATION COMMISSION

DEC 27 1977

O. C. C.

Form C-103
Supersedes Old
C-102 and C-103
Effective 1-1-65

5a. Indicate Type of Lease	
State <input type="checkbox"/>	Fee <input checked="" type="checkbox"/>
5. State Oil & Gas Lease No.	

SUNDRY NOTICES AND REPORTS ON WELLS

(DO NOT USE THIS FORM FOR PROPOSALS TO DRILL OR TO DEEPEN OR PLUG BACK TO A DIFFERENT RESERVOIR. USE "APPLICATION FOR PERMIT -" (FORM C-101) FOR SUCH PROPOSALS.)

1. OIL WELL <input checked="" type="checkbox"/> GAS WELL <input type="checkbox"/> OTHER-		7. Unit Agreement Name
2. Name of Operator Orla Petco, Inc.		8. Farm or Lease Name Swearingen
3. Address of Operator P.O. Box 953, Midland, Texas 79702		9. Well No. 1
4. Location of Well UNIT LETTER <u>G</u> <u>2310</u> FEET FROM THE <u>North</u> LINE AND <u>2310</u> FEET FROM THE <u>East</u> LINE, SECTION <u>5</u> TOWNSHIP <u>23-S</u> RANGE <u>28-E</u> NMPM.		10. Field and Pool, or Wildcat Undesignated (Delaware)
15. Elevation (Show whether DF, RT, GR, etc.) 3010' G.L.		12. County Eddy

Check Appropriate Box To Indicate Nature of Notice, Report or Other Data
NOTICE OF INTENTION TO:

PERFORM REMEDIAL WORK ☐
TEMPORARILY ABANDON ☐
PULL OR ALTER CASING ☐
OTHER ☐

PLUG AND ABANDON ☐
CHANGE PLANS ☐

SUBSEQUENT REPORT OF:

REMEDIAL WORK ☐
COMMENCE DRILLING OPNS. ☐
CASING TEST AND CEMENT JOB ☒
OTHER ☐

17. Describe Proposed or Completed Operations (Clearly state all pertinent details, and give pertinent dates, including estimated date of starting any proposed work) SEE RULE 1103.

December 21, 1977

Ran 363' of new 8 5/8" J-55, API approved casing to a total depth of 365'. Cemented with 250 sx of Class "C" cement, 2% CaCl. Plug down at 9:40 P.M. Plug drilled out the morning of the 22nd of December. Cement circulated.

December 21, 1977

Pulled 85' of 10 3/4" waterstring casing after setting 8 5/8" casing.

18. I hereby certify that the information above is true and complete to the best of my knowledge and belief.

SIGNED James M. C. Ritchie, Jr. TITLE Field Manager DATE 12-23-77

APPROVED BY _____ TITLE _____ DATE _____
CONDITIONS OF APPROVAL, IF ANY:

NO. OF COPIES RECEIVED	
DISTRIBUTION	
SANTA FE	1
FILE	1 ✓
U.S.G.S.	2
LAND OFFICE	3
OPERATOR	1

NEW MEXICO OIL CONSERVATION COMMISSION

RECEIVED

DEC 13 1977

O. C. C.

30-015-22379

Form C-101
Revised 1-1-65

5A. Indicate Type of Lease STATE <input type="checkbox"/> FEE <input checked="" type="checkbox"/>	
5. State Oil & Gas Lease No.	
7. Unit Agreement Name	
8. Farm or Lease Name Swearingen	
9. Well No. 1	
10. Field and Pool, or Wildcat Undesignated (Delaware)	
12. County Eddy	
19. Proposed Depth 2700'	19A. Formation Delaware
20. Rotary or C.T. Cable Tool	
21. Elevations (Show whether DF, RT, etc.) 3010 gr.	21A. Kind & Status Plug. Bond Blanket plugging bond
21B. Drilling Contractor Ford Chapman Drilling	22. Approx. Date Work will start December 17, 1977

1a. Type of Work	
b. Type of Well DRILL <input checked="" type="checkbox"/> DEEPEN <input type="checkbox"/> PLUG BACK <input type="checkbox"/> OIL WELL <input checked="" type="checkbox"/> GAS WELL <input type="checkbox"/> OTHER <input type="checkbox"/>	
2. Name of Operator Orla Petco, Inc. ✓	
3. Address of Operator P.O. Box 953, Midland, Texas 79702	
4. Location of Well UNIT LETTER <u>G</u> LOCATED <u>2310</u> FEET FROM THE <u>North</u> LINE AND <u>2310</u> FEET FROM THE <u>East</u> LINE OF SEC. <u>5</u> TWP. <u>23-S</u> RGE. <u>28-E</u> NMPM	
19. Proposed Depth 2700'	
19A. Formation Delaware	
20. Rotary or C.T. Cable Tool	
21. Elevations (Show whether DF, RT, etc.) 3010 gr.	
21A. Kind & Status Plug. Bond Blanket plugging bond	
21B. Drilling Contractor Ford Chapman Drilling	
22. Approx. Date Work will start December 17, 1977	

PROPOSED CASING AND CEMENT PROGRAM

SIZE OF HOLE	SIZE OF CASING	WEIGHT PER FOOT	SETTING DEPTH	SACKS OF CEMENT	EST. TOP
10 3/4"	8 5/8"	24#	400+	250 sx	(circulated)
8"	4 1/2"	9.5#	2700'	250 sx	

Propose to drill to TD of 2700' to test the Delaware Sand utilizing Cable Tool Drilling Rig. If production is indicated, will run 4 1/2" production casing in attempt to complete.

Blow out preventer: Blind Ram Cable Tool Control Head.

APPROVAL VALID
FOR 90 DAYS UNLESS
DRILLING COMMENCES

EXPIRES 3-15-78

IN ABOVE SPACE DESCRIBE PROPOSED PROGRAM: IF PROPOSAL IS TO DEEPEN OR PLUG BACK, GIVE DATA ON PRESENT PRODUCTIVE ZONE AND PROPOSED NEW PRODUCTIVE ZONE. GIVE BLOWOUT PREVENTER PROGRAM, IF ANY.

I hereby certify that the information above is true and complete to the best of my knowledge and belief.

Signed James M. C. Petcher, Jr. Title Agent (Field Manager) Date December 7, 1977
(This space for State Use)

APPROVED BY W. A. Gussert TITLE SUPERVISOR, DISTRICT II DATE DEC 13 1977
CONDITIONS OF APPROVAL, IF ANY:

MEXICO OIL CONSERVATION COMMISSION
WELL LOCATION AND ACREAGE DEDICATION PLAT

Form C-102
 Supersedes C-128
 Effective 1-1-65

All distances must be from the outer boundaries of the Section.

Operator Oria Petco, Inc.			Lease Swearingen		Well No. 1
Unit Letter G	Section 5	Township 23 S	Range 28 E	County Eddy	
Actual Footage Location of Well:					
2310 feet from the North line and		2310 feet from the East line			
Ground Level Elev. 3010	Producing Formation Delaware Sand	Pool Undesignated (Delaware)		Dedicated Acreage: 40 Acres	

1. Outline the acreage dedicated to the subject well by colored pencil or hachure marks on the plat below.
2. If more than one lease is dedicated to the well, outline each and identify the ownership thereof (both as to working interest and royalty).
3. If more than one lease of different ownership is dedicated to the well, have the interests of all owners been consolidated by communitization, unitization, force-pooling, etc?

☐ Yes ☐ No If answer is "yes," type of consolidation _____

If answer is "no," list the owners and tract descriptions which have actually been consolidated. (Use reverse side of this form if necessary.) _____

No allowable will be assigned to the well until all interests have been consolidated (by communitization, unitization, forced-pooling, or otherwise) or until a non-standard unit, eliminating such interests, has been approved by the Commission.

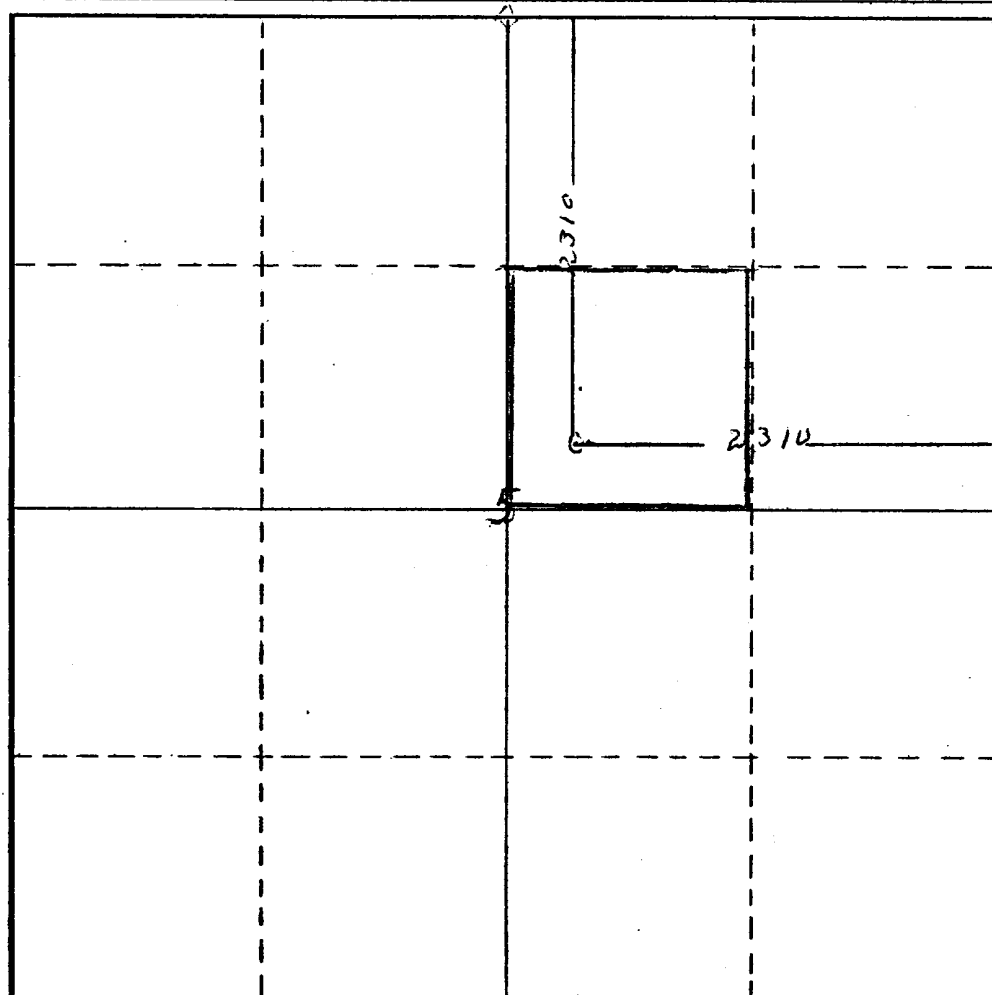

CERTIFICATION

I hereby certify that the information contained herein is true and complete to the best of my knowledge and belief.

Name James M.C. Ritchie, Jr.

Position
Field Manager

Company
Oria Petco, Inc.

Date
December 7, 1977

I hereby certify that the well location shown on this plat was plotted from field notes of actual surveys made by me or under my supervision, and that the same is true and correct to the best of my knowledge and belief.

Dec. 8. 1977

Date Surveyed _____
 Registered Professional Engineer
 and/or Land Surveyor

L. S.
N. M. 220
 Certificate No.

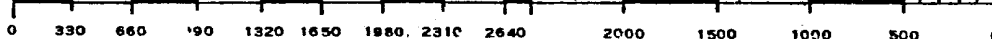

ORLA PETCO, INC.

P. O. BOX 1383 MIDLAND, TEXAS 79702
TELEPHONE 915 684-4762

J. M. C. RITCHIE
PRESIDENT

December 14, 1977

RECEIVED

DEC 14 1977

O. C. C.
ARTESIA, OFFICE

W.A. Gressett
Oil Conservation Commission
P.O. Drawer DD
Artesia, New Mexico 88210

Re: Swearingen No. 1
Sec.5, T-23-S, R-28-E,
Eddy County, New Mexico

Mr. Gressett,

Enclosed please find four (4) copies of surface use plat, showing the proposed access roads to be used en route to our location of 2310' FNL, 2310 FEL of Section 5, T-23-S, R-28-E, Eddy County, New Mexico.

After talking with Gerald Orr with the Bureau of Land Management, he advised that filing the surface use plat with the C-101 and C-102, would be sufficient.

Thank you for your time and consideration,

Sincerely yours,

James M. C. Ritchie, Jr.
James M.C. Ritchie, Jr.
Orla Petco, Inc.

RECEIVED

DEC 14 1977

F.B.I.
ARTESIA, OFFICE