

5
1
2
1

RECEIVED

30-015-22578

MAY 29 1978

O. C. C.
ARTESIA, OFFICE

APPLICATION FOR PERMIT TO DRILL

a. Name of Applicant		b. Type of Well		c. Location		d. Other Data	
BELCO PETROLEUM CORPORATION		Oil X		10,000 Old Katy Road - Suite #100, Houston, Texas 77055		Walker-Coleman	
B		X		2310 east		1	
330	north	29	22-S	27-E	U.S. Carlsbad, S. Cherry Canyon		
				Eddy			
3140.7		permanent	not known	3400	Delaware	Rotary	
				6/1/78			

SIZE OF HOLES	DEPTH	NO. OF HOLES	NO. OF FEET	NO. OF FEET	NO. OF FEET	EST. TOP
11"	8-5/8"	24#	400'	200	Surface	
7-7/8"	5-1/2"	15.5#	3400'	700	1000'	

BOP: 10" 900 ASC pipe rams & 1 set blind rams.
Tests: 8-5/8" to 1000#; 5 1/2" to 1000#.

Note: See attached Letter Application to Drill within The City of Carlsbad as evidence of notification to the incorporation, in accordance with Rule 102 (b)

DRILLING COMMENCED,
EXPIRES 9-13-78

I hereby certify that the information furnished is true and correct.

Signed: *Ed N. King* Administrative Geologist

APPROVED BY: *W. A. Gressett* SUPERVISOR, DISTRICT II

Cement and sand shall be used to

5-26-78
JUN 13 1978

NEW MEXICO OIL CONSERVATION COMMISSION
WELL LOCATION AND ACREAGE DEDICATION PLAT

Form C-122
Supersedes C-128
Effective 1-1-65

All distances must be from the outer boundaries of the Section

Operator Belco Petroleum Corp.			Lease Walker - Coleman			Well No. 1		
Unit Letter B	Section 29	Township 22 South		Range 27 East	County Eddy			
Actual Footage Location of Well: 330 feet from the North line and 2310 feet from the East line								
Ground Level Elev. 3140.7		Producing Formation Delaware			Pool Carlsbad, S. Cherry Canyon		Dedicated Acreage: 40 Acres	

1. Outline the acreage dedicated to the subject well by colored pencil or hatchure marks on the plat below.
2. If more than one lease is dedicated to the well, outline each and identify the ownership thereof (both as to working interest and royalty).
3. If more than one lease of different ownership is dedicated to the well, have the interests of all owners been consolidated by communitization, unitization, force-pooling, etc?

☐ Yes ☐ No If answer is "yes," type of consolidation _____

If answer is "no," list the owners and tract descriptions which have actually been consolidated. (Use reverse side of this form if necessary.) _____

No allowable will be assigned to the well until all interests have been consolidated (by communitization, unitization, forced-pooling, or otherwise) or until a non-standard unit, eliminating such interests, has been approved by the Commission.

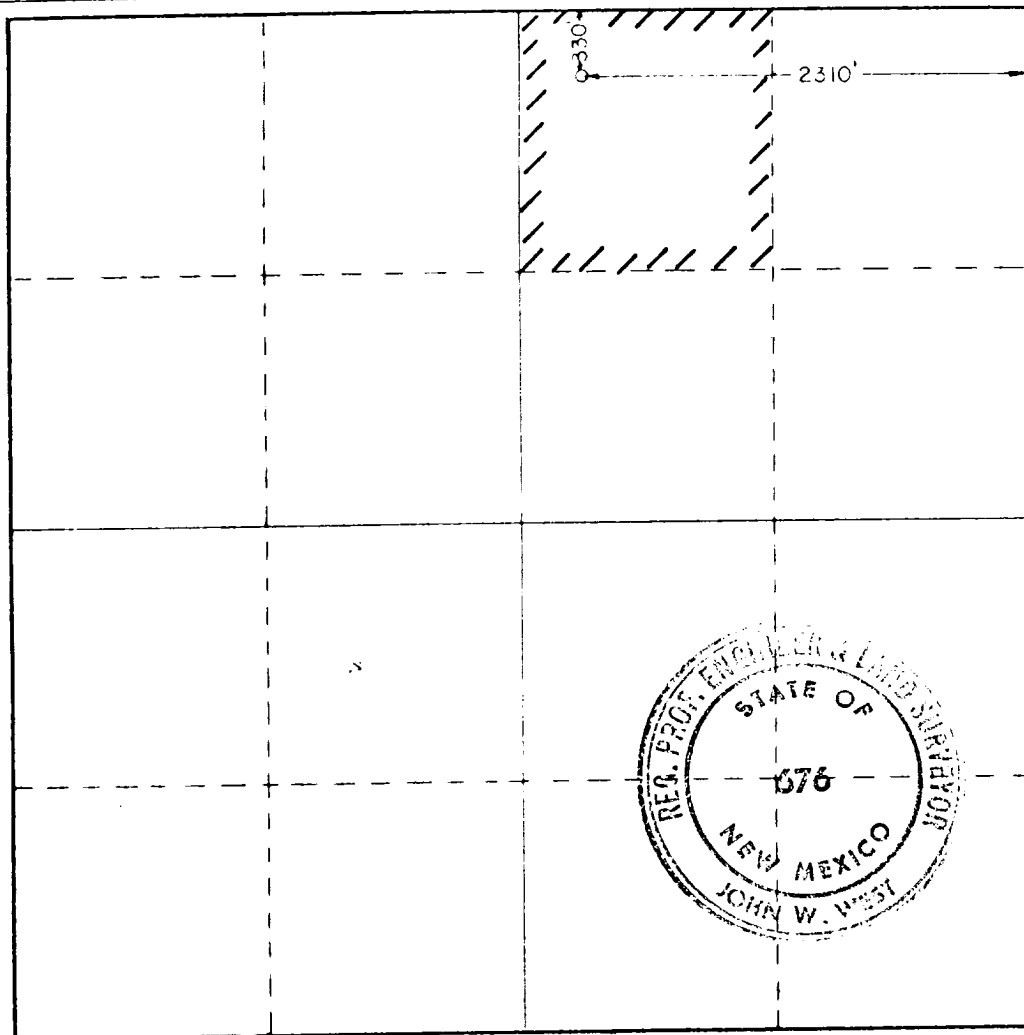

CERTIFICATION

I hereby certify that the information contained herein is true and complete to the best of my knowledge and belief.

Name

Lee G. Nering

Position

Administrative Geologist

Company

BELCO PETROLEUM CORPORATION

Date

5-26-78

I hereby certify that the well location shown on this plat was plotted from field notes of actual surveys made by me or under my supervision, and that the same is true and correct to the best of my knowledge and belief.

Date Surveyed

April 29, 1978

Registered Professional Engineer and/or Land Surveyor

John W. West

Certificate No. **John W. West** **676**

Ronald J. Eidson **3239**

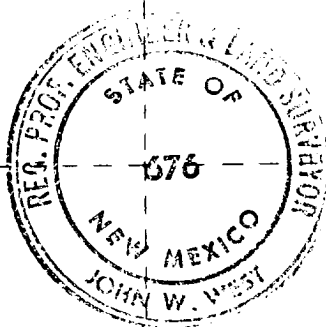

0 13' 660 90 1320 1650 1980 2310 2640 2000 1500 1000 500 0

Belco Petroleum Corporation

Belco

REPRESENTED BY ATTORNEYS, MCCORMICK & FORBES
CARLSBAD, NEW MEXICO

May 26, 1978

City of Carlsbad
Carlsbad, New Mexico 88220

APPLICATION NO. 2

Attention:
Mr. Claude Tabor,
City Administrator

RE: Belco Petroleum Corporation
Walker-Coleman #1 Well
Section 27, T-22-S, R-27-E
Eddy County, New Mexico

Gentlemen:

Belco Petroleum Corporation herein applies for a Permit to Drill the Walker-Coleman No.1 well, 2310 feet FEL and 330 feet FNL, Section 29, T22S, R27E, Eddy County, New Mexico. Included with this Application is a check in the amount of Five Hundred Dollars (\$500.00) payable to the City of Carlsbad.

Subject well is located within the recent annexation to the City of Carlsbad, New Mexico. The proposed location does comply with New Mexico Oil Conservation Division statewide rules for 40-acre oil well spacing.

Application for this location is simultaneously submitted to the New Mexico Oil Conservation Division. The following supporting information is submitted in the same order requested in Ordinance 748, Section 3.B:

1. Date of Application -
2. Name of Applicant - Belco Petroleum Corporation
3. Address of Applicant - 10,00 Old Katy Road - Suite #100,
Houston, Texas 77055
4. Registered Agent - Prentice-Hall Corp. System, Inc., Sena Plaza,
Santa Fe, New Mexico
5. a. Name of Lease Grantors - Walker, Coleman, Valley Insurance Co.
etal, Carlsbad, New Mexico



City of Carlsbad
Page Two
May 26, 1978

5. b. Description of Well Location - See attached plat (NMOCC Form C-102) marked Exhibit I. Proration Unit dedicated to well is SESW $\frac{1}{4}$ of Section 20, also identified on Exhibit I-A.
 - c. Location with Respect to Property Lines - See attached marked Exhibits I and I-A.
 - d. Ground Elevation - 3140.7'
6. Type of Derrick - 110' jackknife
7. Proposed Depth - 3400' Delaware test
8. Explanation of Operating Pressures of Facilities - Anticipating pumping oil well with auxiliary flow line operating at less than 50#, to tank battery.
9. Location of Compressor - No compressor anticipated.
10. Name of Person or Persons to be Notified in Case of Emergency -
 1. Dave Cooper
411 Petroleum Building
Midland, Texas 70701
Office Telephone (915) 683-6366
Residence Telephone (915) 697-1852
 2. Jerry Meyer
10,000 Old Katy Road - Suite #100
Houston, Texas 77055
Office Telephone (713) 932-4700
Residence Telephone (713) 467-0048
11. Proposed Hole Size, Casing Program, Mud Program and Cementing Program
See attached marked Exhibit II

Belco

City of Carlsbad
Page Three
May 26, 1978

12. Safety Provisions of Pipeline with Pressure in Excess of 250# -
Not applicable per Item #8

Yours very truly,

BELCO PETROLEUM CORPORATION

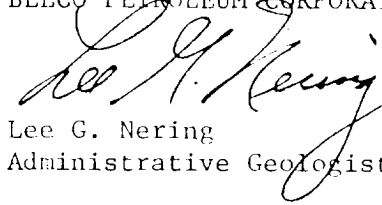

Lee G. Nering
Administrative Geologist

Attachments