

## OIL CONSERVATION DIVISION

P.O. Box 2088

**Santa Fe, New Mexico 87504-2088**

## DISTRICT I

P.O. Box 1980, Hobbs, NM 88240

## DISTRICT II

P.O. Drawer DD, Artesia, NM 88210

### DISTRICT III

1000 Rio Brazos Rd., Aztec, NM 87410

# WELL LOCATION AND ACREAGE DEDICATION PLAT

**All Distances must be from the outer boundaries of the section**

Operator Pogo Producing Company			Lease Cal-Mon		Well No. 7
Unit Letter C	Section 35	Township 23 South	Range 31 East	County Eddy	NMPM
Actual Footage Location of Well:					
330 feet from the North line and		1650 feet from the West line			
Ground level Elev. 3464.6	Producing Formation DELAWARE		Pool UNDES. INGLE WELLS DELAWARE		Dedicated Acreage: 40 Acres

1. Outline the acreage dedicated to the subject well by colored pencil or hatchure marks on the plat below.
2. If more than one lease is dedicated to the well, outline each and identify the ownership thereof (both as to working interest and royalty).
3. If more than one lease of different ownership is dedicated to the well, have the interest of all owners been consolidated by communitization, unitization, force-pooling, etc.?  
☐ Yes      ☐ No      If answer is "yes" type of consolidation \_\_\_\_\_
- If answer is "no" list the owners and tract descriptions which have actually been consolidated. (Use reverse side of this form if necessary.)
- No allowable will be assigned to the well until all interests have been consolidated (by communitization, unitization, forced-pooling, or otherwise) or until a non-standard unit, eliminating such interest, has been approved by the Division.

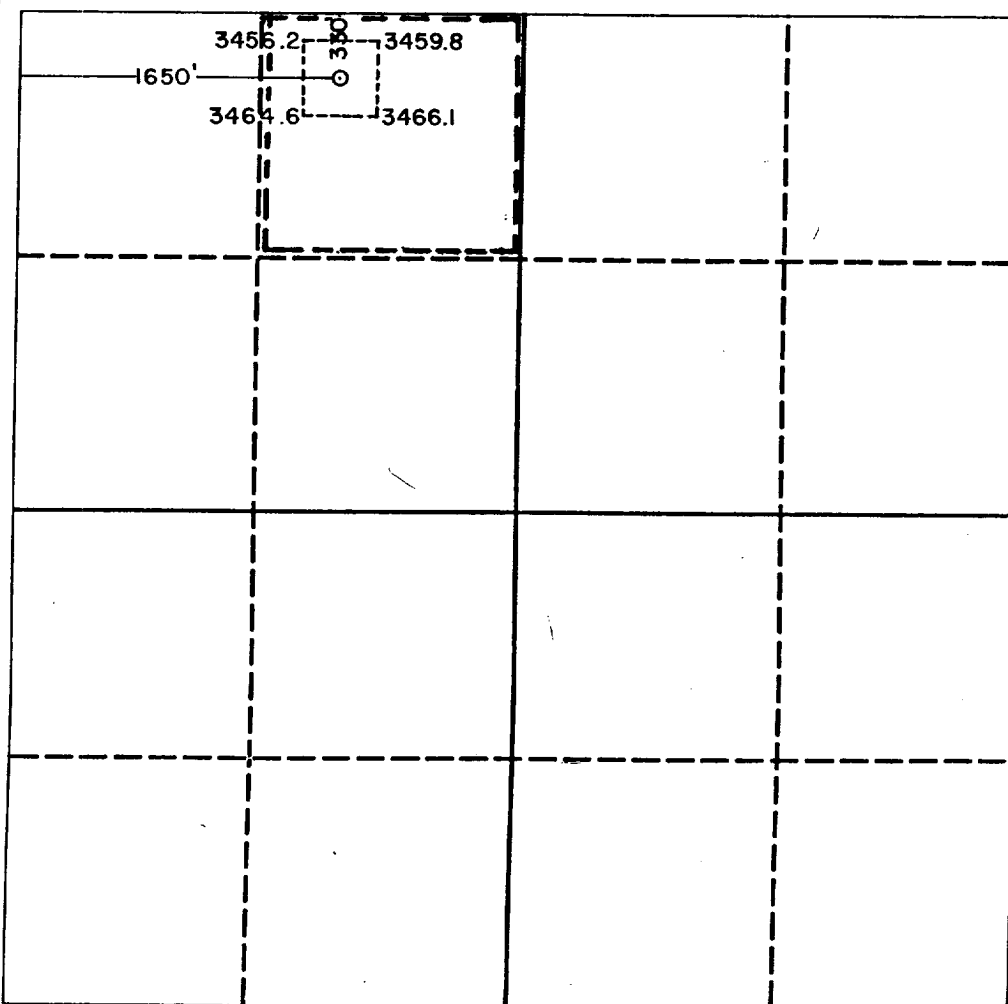

### OPERATOR CERTIFICATION

I hereby certify that the information contained herein is true and complete to the best of my knowledge and belief.

Signature \_\_\_\_\_

Printed Name \_\_\_\_\_

**Position**

Dist. Drlq. &amp; Prod. Supt.

Сотрудники

POGO PRODUCING COMPANY

Date \_\_\_\_\_

June 19, 1992

### SURVEYOR CERTIFICATION

I hereby certify that the well location shown on this plat was plotted from field notes of actual surveys made by me or under my supervision, and that the same is true and correct to the best of my knowledge and belief.

Date Surveyed

June, 16, 1992

Signature & Seal of Professional Surveyor

REGISTRATION NO. 2439  
 No. 2439  
 JOHN W. WEST  
 Certificate No. 676

Certificate No. JOHN W. WEST 676

RONALD J. EDSON 3230